

GUARD RAIL REQUIRED
ON LEFT
 STA. 456+47 TO STA. 456+91 LENGTH 40 FT.
 456+47 . . . 456+91 . . . 24 .
ON RIGHT
 454+00 TO STA. 454+17 LENGTH 17 FT.
 454+00 . . . 454+17 . . . 24 .
 463+00 . . . 463+92 . . . 24 .
TOTAL THIS SHEET 129 FT.

NEW GULCHETS REQUIRED
 459+05 15" Conc. Pipe 32 ft.
 Conc. Class B (1-2 1/2 - 5) 1.8 cy.
 456+75 18" Conc. Pipe 33 ft.
 Conc. Class B (1-2 1/2 - 5) 2.3 cy.
 463+80 18" Conc. Pipe 30 ft.
 Conc. Class B (1-2 1/2 - 5) 2.3 cy.

SEE ROAD MAP FOR FEED AND FISCAL SHEET TOTAL
 SHEET NO. 13A NO. 1 SHEETS
 L.V. 172A TH 22 13 177

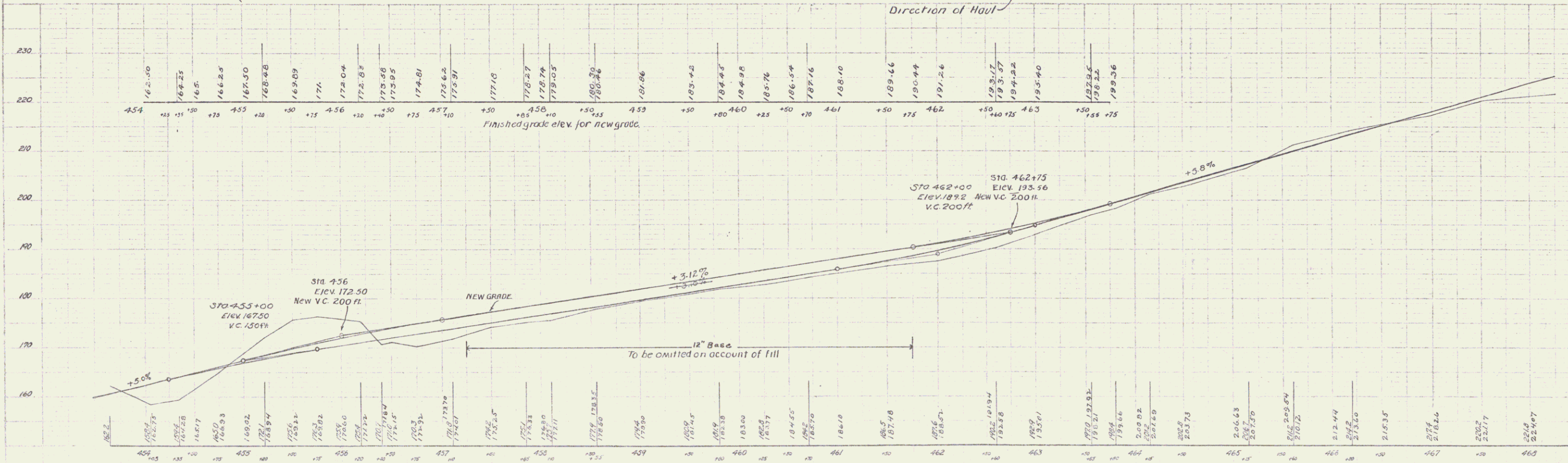
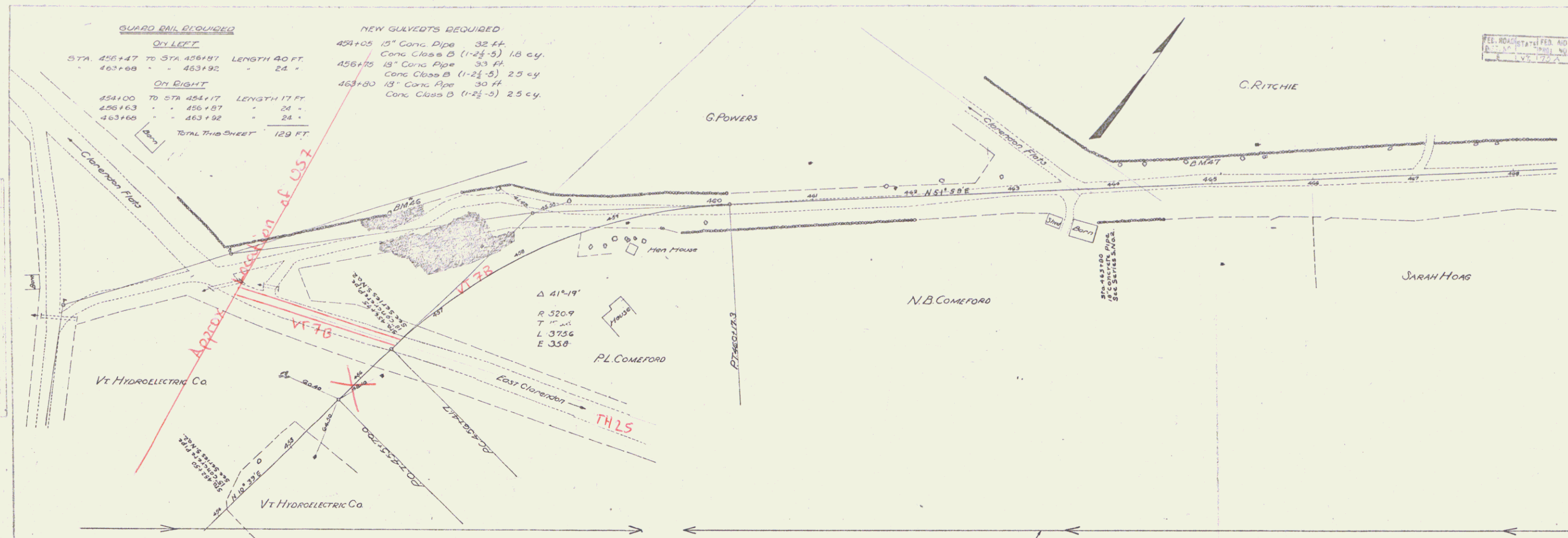

BM #46 Spike in roots of 12" Elm 102' to the left of Sta 457+00 Elev. 173.10
 BM #47 " " " " 14' Elm 225' " " " " 465+75 Elev. 206.76

Series F No. 75A
 Sheet 13 of 57