

GUARD RAIL REQUIRED  
ON LEFT  
Sta 381+00 to 381+20 length 20ft  
" 384+28 " " 384+52 " 24 "  
" 394+60 " " 395+48 " 88 "

GUARD RAIL REQUIRED  
ON RIGHT  
Sta 381+00 to 381+40 length 40ft  
" 384+28 " " 384+52 " 24 "  
" 394+60 " " 395+48 " 88 "  
TOTAL THIS SHEET 304 FT.

NEW CULVERTS REQUIRED  
Sta 384+40 18" Conc. Pipe Length 28 ft.  
Conc. Class B (1-2-5) 1.8 cu yd  
Sta 395+20 4x4' Rein. Conc. Box  
Conc. Class A (1-2-4) 127 cu yd.  
" " B (1-2-5) 22.0 "  
Rein. Steel 1330 lb.

PL. REVISIONS AND FIELD SHEET  
DATE: 11/25/25  
BY: [Signature]

387  
B.M. Station  
B.M. Station  
1-25  
2-25  
3-25

B.M. Station  
B.M. Station  
1-25  
2-25  
3-25

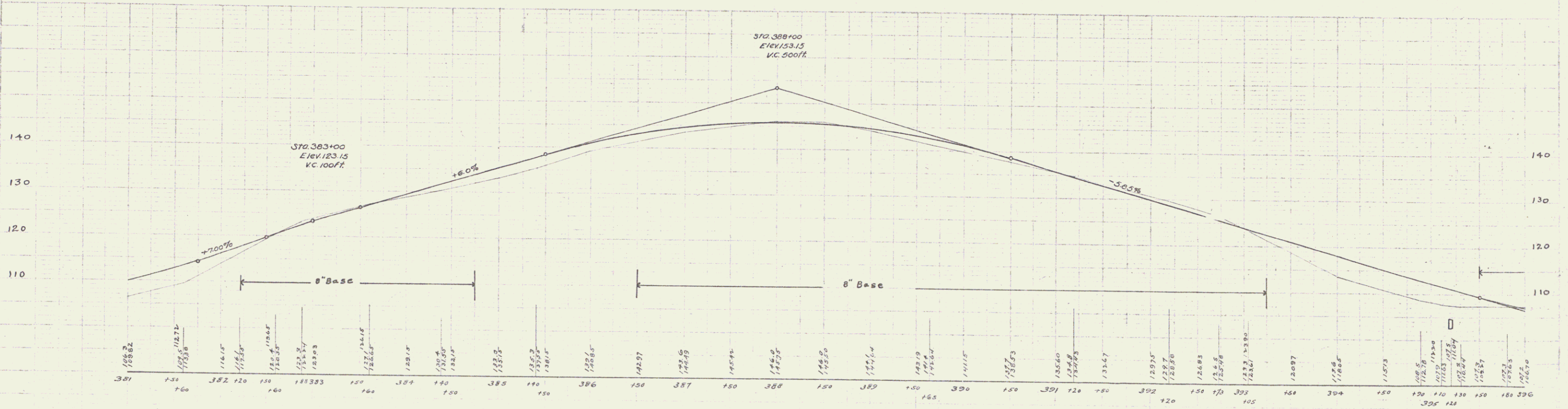
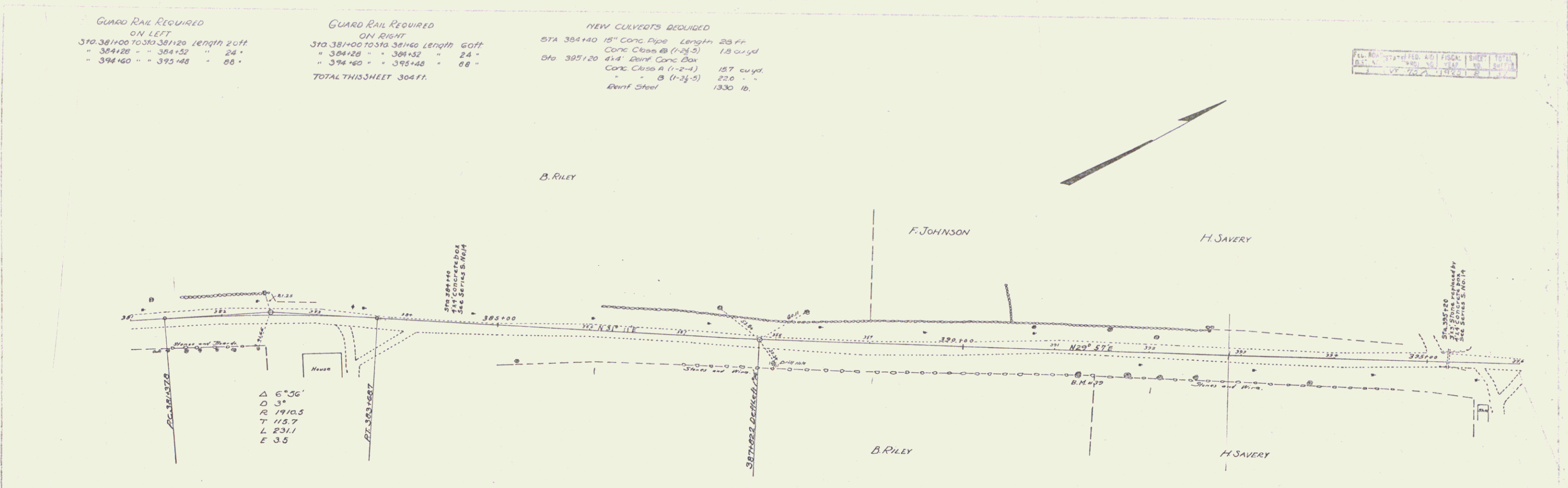

B.M. #39 Spike in roots of 18" Elm 28' to right Sta 391+27 Elev 137.86

Series F No 73A  
Sheet 4 of 57