

Barrett - Griffith  
 5-37  
 No. 1000  
 No. 1000  
 No. 1000

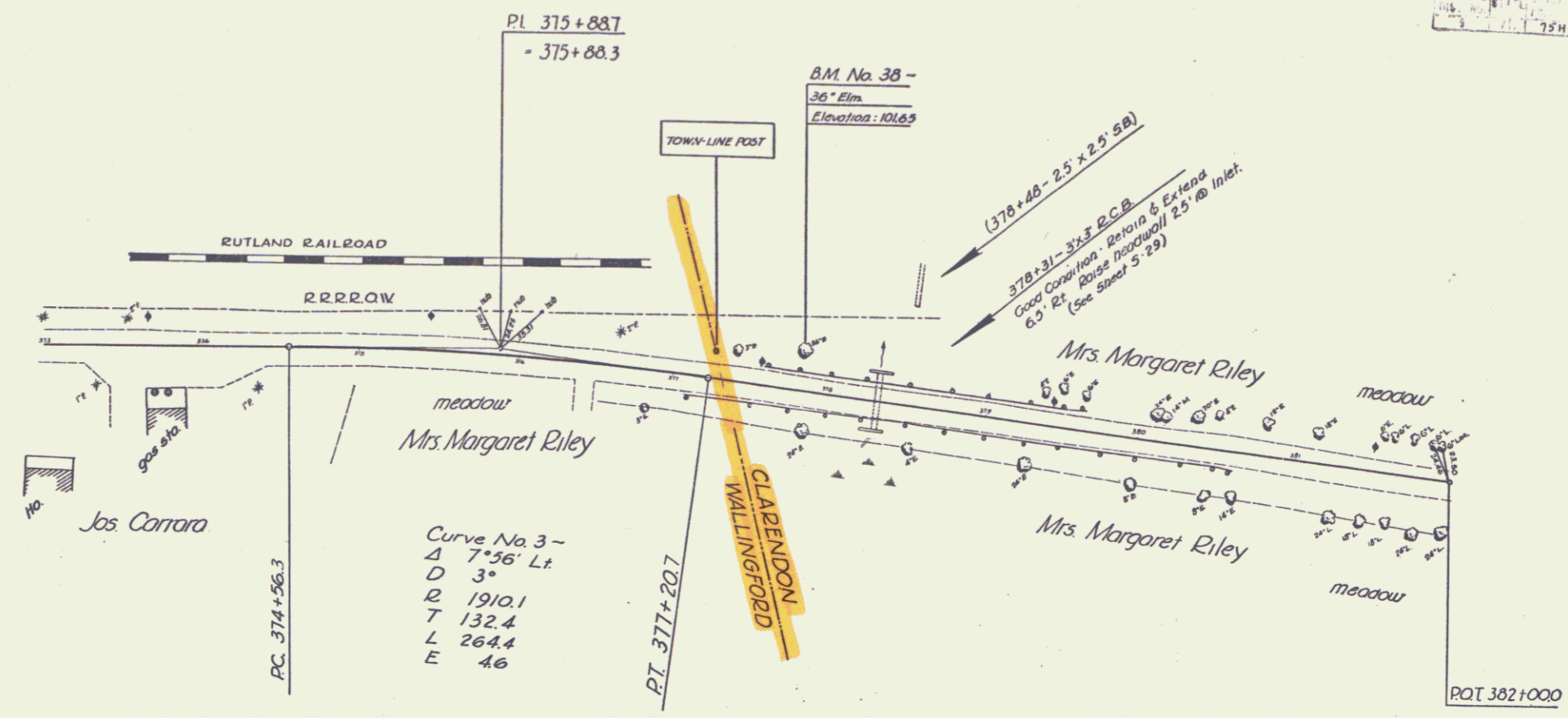

Curve No. 3 -  
 Δ 7°36' Lt.  
 D 3°  
 R 1910.1  
 T 132.4  
 L 264.4  
 E 46

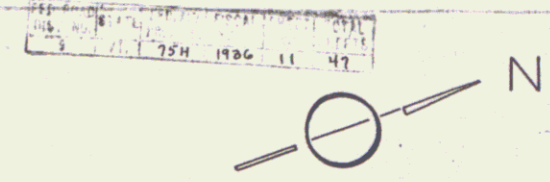
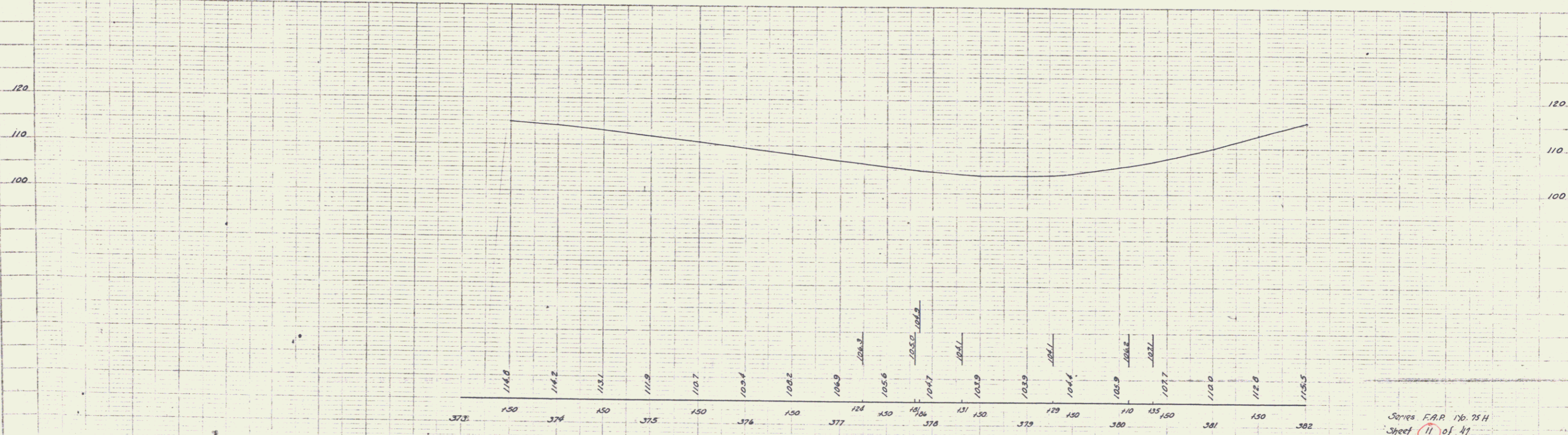

B.M. No. 38. Spot in Root of 36" elm, 25.5 ft left of Sta. 377+81. Elevation: 101.63

Series F.A.P. 176.75 H  
 Sheet 11 of 41

4