

THIS IS PART OF THE SAME LAND ACQUIRED BY THE STATE OF VERMONT AS PART OF THE ORIGINAL US RTE. 4 TAKEN INTO THE STATE HIGHWAY SYSTEM ON APRIL 1, 1931, BY ORDER OF THE STATE HIGHWAY BOARD PURSUANT TO LEGISLATIVE ACT 61 OF 1931.

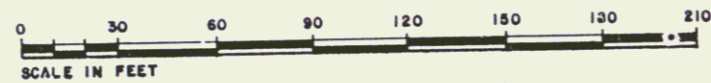
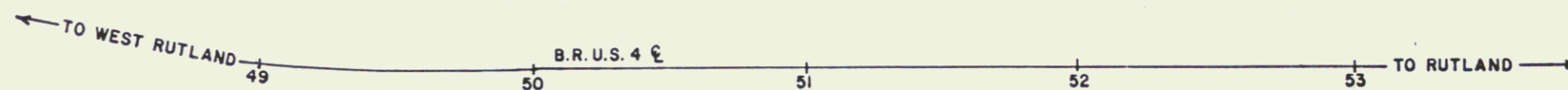
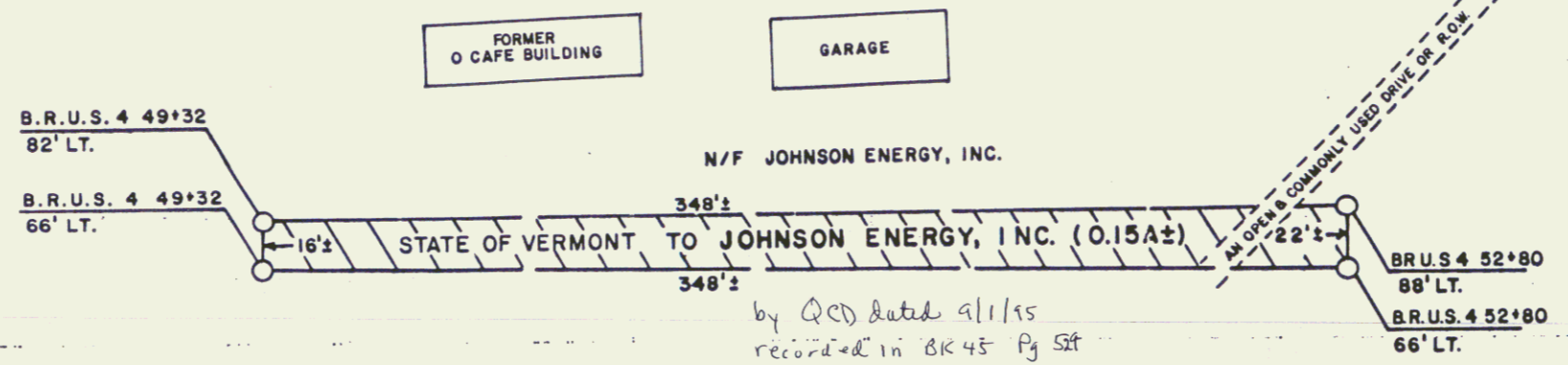
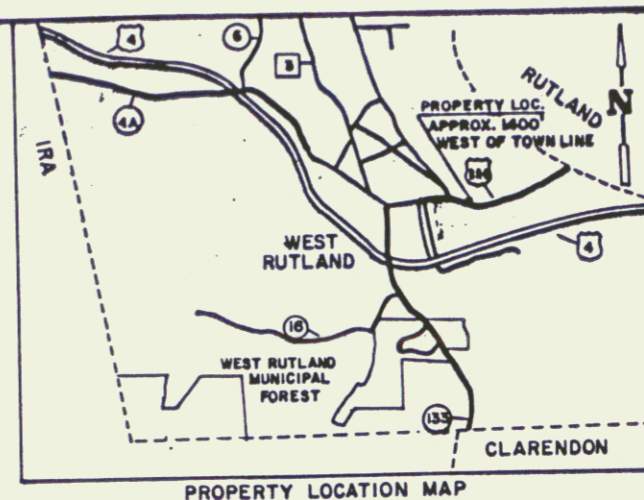
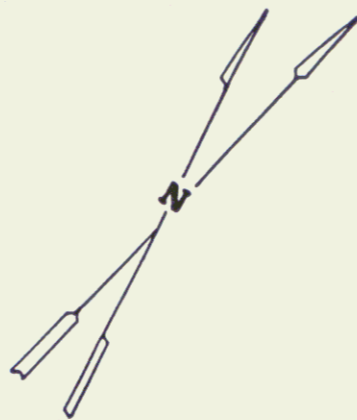

RIGHT-OF-WAY DIVISION
 E O W N F I L E
 PERPETUAL
 Form of _____
 (To Be Returned To R.O.W. Division)

SHEET 14 OF 141
 REF. PROJ.: WEST RUTLAND-RUTLAND ST. 65 L

STATE OF VERMONT AGENCY OF TRANSPORTATION		
TOWN OF WEST RUTLAND		
SCALE: 1" = 30'	DATE: 8-29-95	DRAWN BY: PJH

THIS IS AN ORIGINAL MYLAR

14B

8