

SHEET NO. INDEX OF SHEETS

# BR US 4

## STATE OF VERMONT DEPARTMENT OF HIGHWAYS

### PROPOSED IMPROVEMENT

## TOWNS OF WEST RUTLAND & RUTLAND

### COUNTY OF RUTLAND BR U.S. ROUTE 4 WEST RUTLAND - RUTLAND ROAD

BEGINNING AT A POINT 175 FEET WESTERLY OF THE INTERSECTION OF VERMONT ROUTE 3 AND U.S. ROUTE 4 AND EXTENDING EASTERLY 11,076 FEET TO A POINT 352 FEET EASTERLY OF THE INTERSECTION OF VERMONT ROUTE 3 AND U.S. ROUTE 4.

LENGTH OF ROADWAY 10737.90 FEET = 2.037 MILES  
(DEDUCTING RR. CROSSINGS)

LENGTH OF BRIDGES 263.16 FEET = 0.050 MILES  
LENGTH OF PROJECT 11020.96 FEET = 2.087 MILES

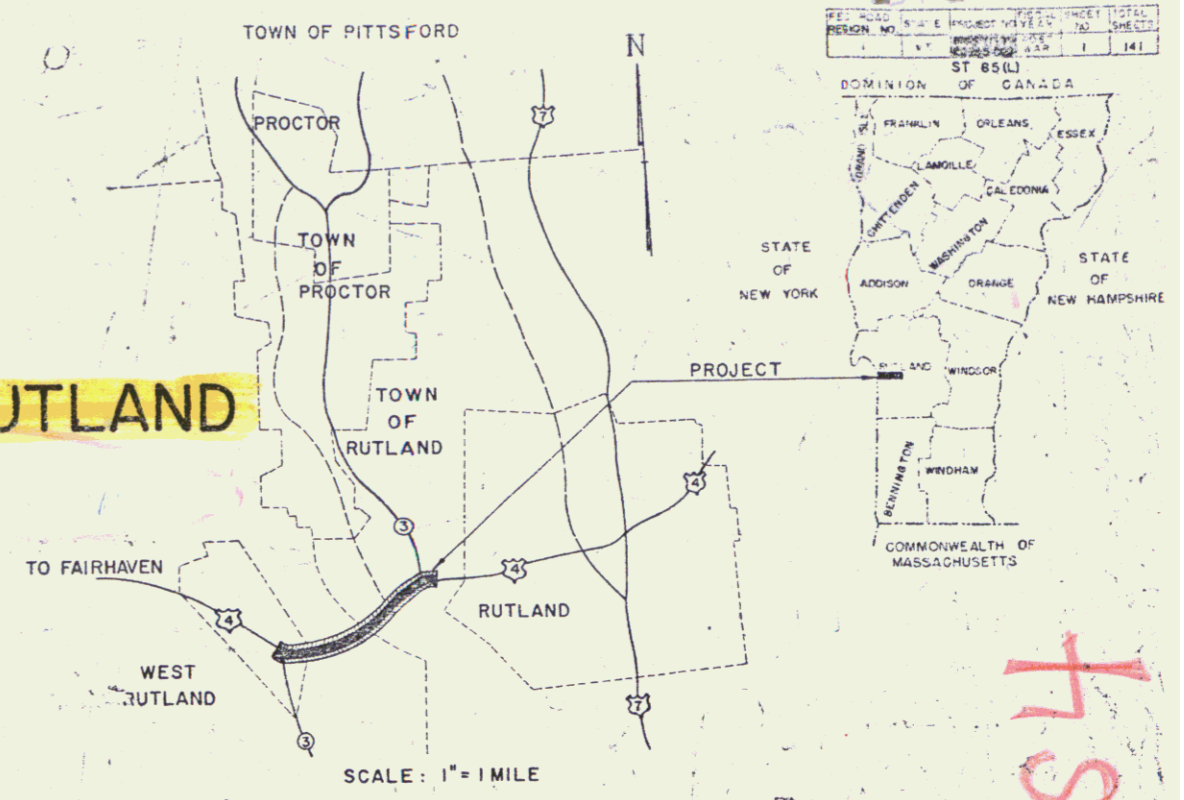

- 1 - TITLE PAGE
- 2 - PROPERTY PLAN
- 3 - TYPICAL CROSS-SECTION OF IMPROVEMENT (2 1/2" BITUMINOUS CONCRETE PAVEMENT-ITEM-361B)
- 4-5 - QUANTITY SHEET (ITEMS)
- 6 - QUANTITY SHEET (DRAINAGE)
- 7-10 - EARTHWORK SHEETS
- 11-19 - PLAN AND PROFILE SHEETS
- 20 - CONSTRUCTION DETAILS (MEDIAN STRIP, MOUNTABLE CURB, METAL END SECTIONS)
- 21-32 - BRIDGE SHEETS (RIVER AND CREEK)
- 32-A & 32-B - PRELIMINARY INFORMATION SHEETS FOR BRIDGES
- 33 - ROADWAY STANDARD SHEET RS 56-1 (BANKING TABLES)
- 34 - ROADWAY STANDARD SHEET RS 56-2 (DROP INLETS)
- 35 - ROADWAY STANDARD SHEET RS 56-3 (MARKERS)
- 36 - ROADWAY STANDARD SHEET RS 56-4 (DRAINAGE)
- 37 - ROADWAY STANDARD SHEET RS 56-5 (CONC. CURB, GRAN. CURB, CONC. S.W.)
- 38 - ROADWAY STANDARD SHEET RS 56-6 (TYPICAL GRADING & TURNOUTS)
- 39 - ROADWAY STANDARD SHEET RS 56-7 (CONC. CATCH BASINS OR M.H.)
- 39-A - 39-B - FLASHING LIGHT SIGNALS STA. 20+79.4 & 89+34
- 40 - TYPICAL SECTION AND PLAN (CLARENDON AND PITTSFORD R.R. CROSSING)
- 40-A - WIRING DIAGRAMS CLARENDON AND PITTSFORD R.R. CROSSING
- 40-B - TYPICAL SECTION AND PLAN (DELAWARE AND HUDSON R.R. CROSSING)
- 40-C - WIRING DIAGRAMS DELAWARE AND HUDSON R.R. CROSSING
- 41 - ROADWAY STANDARD SHEET RS 56-11 (THREE RAIL GUARD RAIL WITH STEEL POSTS)
- 42 - ROADWAY STANDARD SHEET RS 56-12 (BARRICADES, SIGNS, & LIGHTS)
- 43-117 - CROSS SECTIONS
- 118-122 - CHANNEL SECTIONS

#### RAILROAD OVERPASS

- 123 - LOCATION PLAN & BORING LOG
- 124 - FRAMING PLAN
- 125-126 - SUPERSTRUCTURE DETAILS
- 127 - PILING PLAN
- 128 - NORTH ABUTMENT
- 129 - SOUTH ABUTMENT
- 130-134 - FALSEWORK PLANS & DETAILS
- 135-141 - CROSS SECTIONS

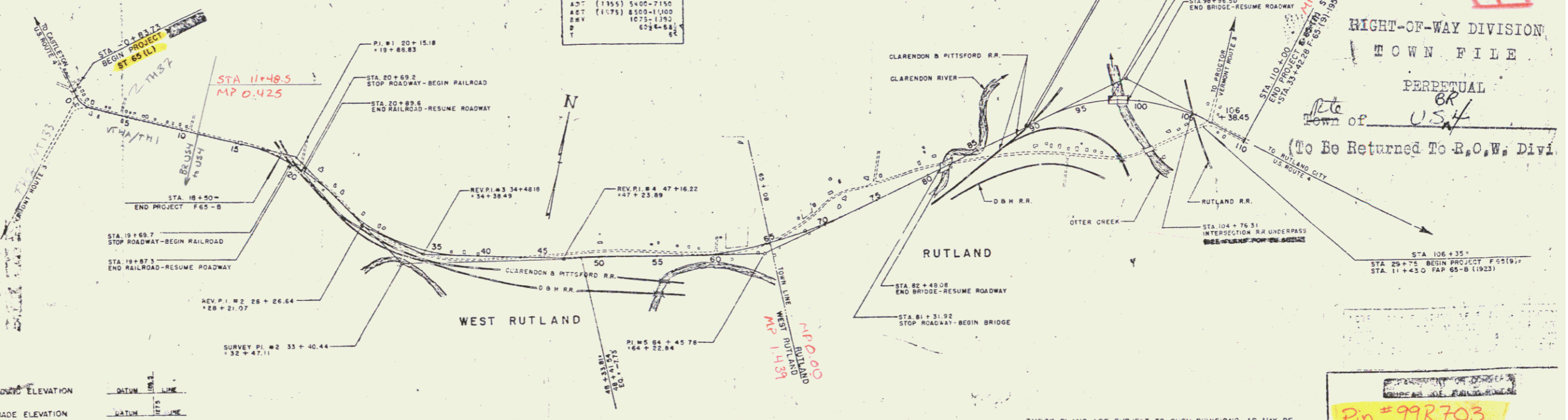

DESIGN DESIGNATION	
A-1	(135) 5400-7150
A-2	(175) 8500-1100
B-1	(175) 1075-1190
P	4284-5284

RIGHT-OF-WAY DIVISION  
TOWN FILE  
PERPETUAL  
BR  
U.S. 4  
(To Be Returned To R.O.W. Div.)

COUNTY OF RUTLAND  
TOWN LINE  
STONE WALL  
UNIMPROVED  
DRAINAGE  
RAILROAD  
CONTAINING  
CENTER LINE  
STOP DIST.  
"HOLE"  
PROJECT IN  
TOWN OF  
WEST RUTLAND

PROJECT: West Rutland - Rutland Road  
NUMBER: ST 65-1  
TYPE: 2 1/2" Bituminous Concrete Pavement  
CONTRACTOR: C. J. O'Neil & Sons, Inc.  
LOCATION: See File Code

WEST RUTLAND - RUTLAND ROAD  
CONSTRUCTION BY F. J. McNEIL'S SUN CONSTR. CO.  
PLANS FILED FOR RECORD  
DATE: NOV. 2, 1957

GRADE ELEVATION	DRAIN LINE
DEFLECTION OF ANGLE.....A	
DEGREE OF CURVE.....D	
RADIUS OF CURVE.....R	
TANGENT DISTANCE.....T	
LENGTH OF CURVE.....L	
EXTERNAL DISTANCE.....E	
POINT OF INTERSECTION.....PI	
POINT OF CURVE.....PC	
POINT OF TANGENT.....PT	
POINT ON TANGENT.....POT	
POINT ON SUB-TANGENT.....POST	
POINT OF COMMENCEMENT.....PCO	

SCALES	
TITLE	1" = 500'
TYPICAL	1" = 4'
PLAN	1" = 50' & 20'
PROFILE HORIZONTAL	1" = 50'
PROFILE VERTICAL	1" = 10'
CROSS-SECTIONS	1" = 5' & 10'

PREPARED AND RECOMMENDED:  
WILLIAM H. McFARLAND CONSULTING ENGINEER  
STATE OF VERMONT, LICENSE NO. 422  
DATE: October 11, 1957

THESE PLANS ARE SUBJECT TO SUCH REVISIONS AS MAY BE REQUIRED BY THE COMMISSIONER OF HIGHWAYS.  
CONSTRUCTION IS TO BE CARRIED ON IN ACCORDANCE WITH THE PLANS AND THE STANDARD SPECIFICATIONS FOR HIGHWAY AND BRIDGE CONSTRUCTION OF JANUARY 1955, WITH THE EXCEPTION OF THE SPECIFICATIONS FOR BRIDGES AS SUPERSEDED BY THIS ORDER, INCLUDING ALL SUBSEQUENT APPROVED REVISIONS AND SUCH REVISED SPECIFICATIONS AND SPECIAL PROVISIONS AS ARE SUBMITTED WITH THE PLANS.

APPROVED: [Signatures] DATE: October 11, 1957  
APPROVED: [Signatures] DATE: October 11, 1957  
APPROVED: [Signatures] DATE: October 15, 1957  
APPROVED: [Signatures] DATE: October 14, 1957

Pin # 99R703  
RUTLAND  
RUTLAND 6065  
SHEET 1 OF 1  
Sheet 1