

**GUARD RAIL REQUIRED**  
 ON LEFT  
 Sta 248+57 to 248+81 Length 24 ft  
 • 248+29 - 248+00 - 176 -  
 ON RIGHT  
 Sta 246+72 to 248+00 Length 128 ft  
 • 248+57 - 248+81 - 24 -  
 TOTAL THIS SHEET 352 ft

**NEW CULVERTS REQUIRED**  
 Sta 248+69 16" Corr Iron Pipe 30 ft  
 1-2 1/2" Concrete 1.5 cu yds

**SUB BASE REQUIRED**  
 Sta 241+00 to 246+00 Length 500 ft

**COBBLE GUTTER REQUIRED**  
 Where necessary 3400 lin ft

NO	DATE	BY	FOR	SHEET	TOTAL
1	VF	26	1007	19	33

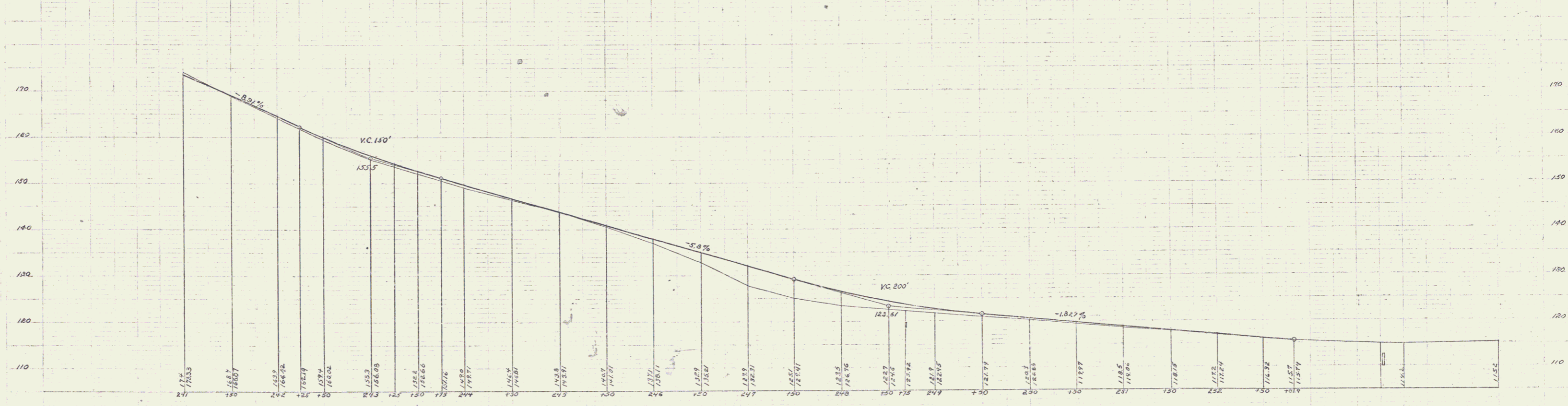
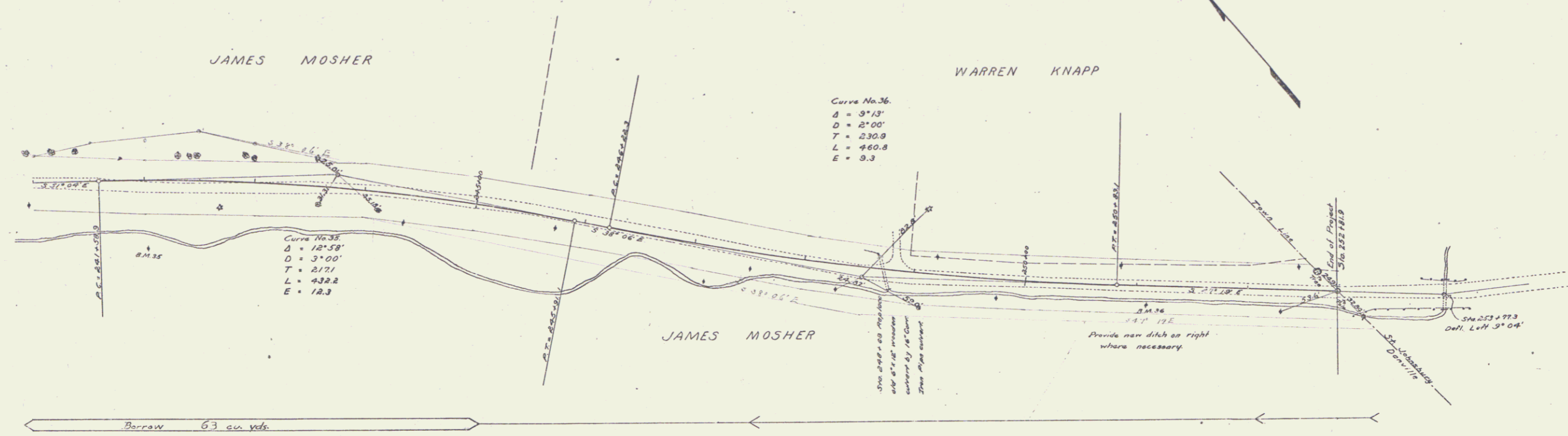

B.M. 35 Spike in telephone pole right of Sta 242+00 Elev. 104.16  
 B.M. 36 Spike in telephone pole right of Sta 251+00 Elev. 118.35

Series of James P. Smith  
 Date 10/11/23