

GUARD RAIL REQUIRED ON LEFT
 Sta 95+28 to Sta 95+52 Length 24 ft
 - 97+76 - 98+00 - 24 -
 At Culvert Sta 103 to 104 - 24 -
ON RIGHT
 Sta 95+28 to Sta 95+52 - 24 -
 - 97+76 - 98+00 - 24 -
 At Culvert Sta 103 to 104 - 24 -
TOTAL THIS SHEET 144'

NEW CULVERTS REQUIRED
 Sta. 95+40 16" Cor.I.P. 26 ft.
 1-26" Concrete 1.0 cu yds.
 Sta. 97+85 16" Cor.I.P. 28 ft.
 1-26" Concrete 1.0 cu yds.
 Sta. 103= 16" Cor.I.P. 38 ft.
 1-26" Concrete 1.5 cu yds.

SUB BASE REQUIRED
 Sta. 95+25 to Sta 101+50 Length 625 ft

PRO. AREA	PRO. AD	FISCAL YEAR	TOTAL		
DATE	NO. PLS	PER	AMOUNT		
0	VT	26	1/32	0	5.9

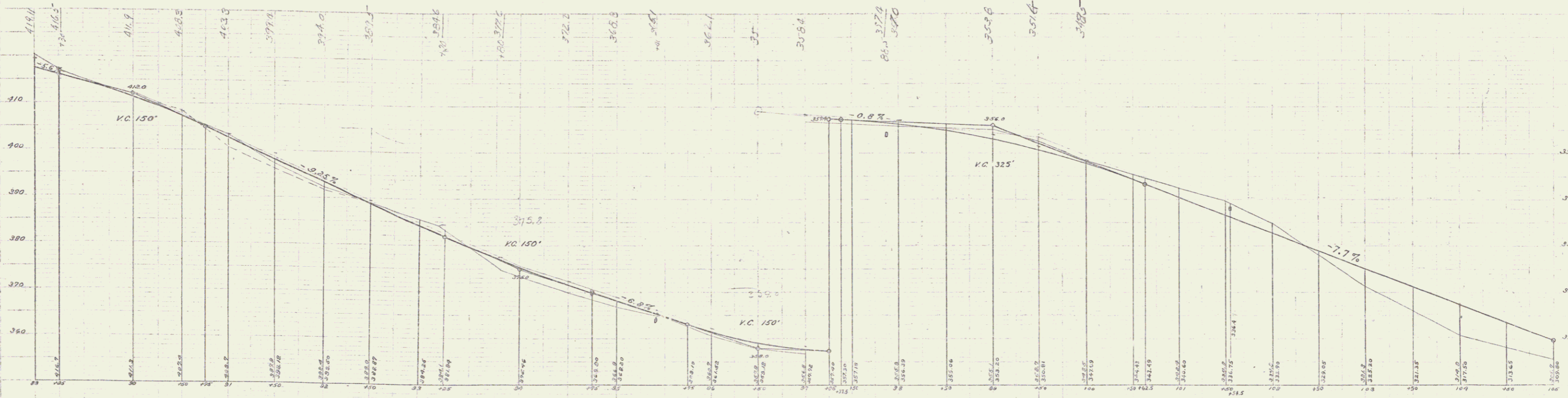
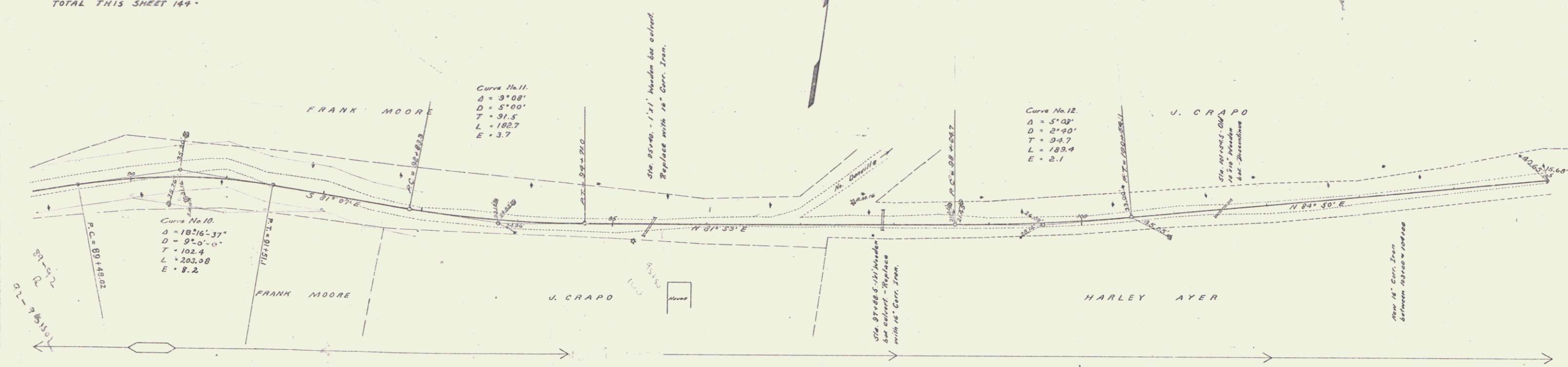

B.M. 15 Spike in maple tree right of 95+55 Elev. 414.80
 B.M. 16 Spike in pine tree left of 97+35.5 Elev. 355.38

CHAS. F. MOSE ENGINEER