

FED. ROAD DIST. NO.	STATE	FED. AID PROJ. YEAR	FISCAL YEAR	SHEET NO.	TOTAL SHEETS
0	VT.	36	1937	1	53

INDEX OF SHEETS

SHEET NO.	TITLE PAGE
2	TYPICAL CROSS-SECTION OF IMPROVEMENT
3	PLAN AND PROFILE STA. 0+00 - 13+00
4	" " " " 13+00 28+00
5	" " " " 28+00 43+00
6	" " " " 43+00 58+00
7	" " " " 58+00 74+00
8	" " " " 74+00 87+00
9	" " " " 87+00 105+00
10	" " " " 105+00 121+00
11	" " " " 121+00 137+00
12	" " " " 137+00 150+00
13	" " " " 150+00 164+00
14	" " " " 164+00 182+00
15	" " " " 182+00 196+00
16	" " " " 196+00 211+00
17	" " " " 211+00 226+00
18	" " " " 226+00 241+00
19	" " " " 241+00 253+77.3
20	BRIDGE AT STA. 264+57
21	" " " " 110+17
22	" " " " 183+79
23	SPECIAL CULVERTS
24 to 53	CROSS-SECTIONS

STATE OF VERMONT
STATE HIGHWAY DEPARTMENT

PLAN AND PROFILE OF PROPOSED
STATE HIGHWAY
FEDERAL AID PROJECT

TOWN OF DANVILLE
HILL ROAD
FROM DANVILLE GREEN TO ST. JOHNSBURY LINE

Pin# 992697
Route #2B
Project FAP26

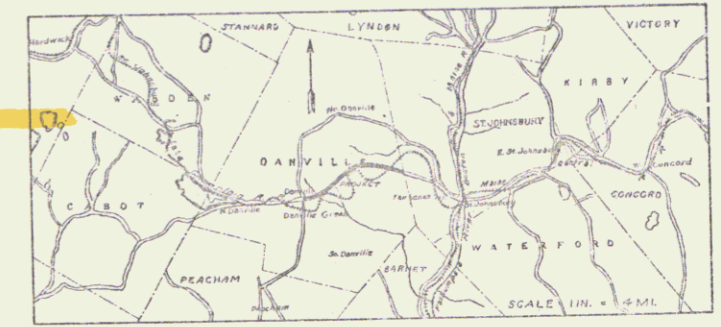

Plan 1 in = 30 ft.
Profile Horizontal 1 in = 30 ft. Vert. 1 in = 10 ft.
Cross-sections 1 in = 5 ft.

Formerly US 2
MP 4.48
Vt. 2B MP.
00.26 ±

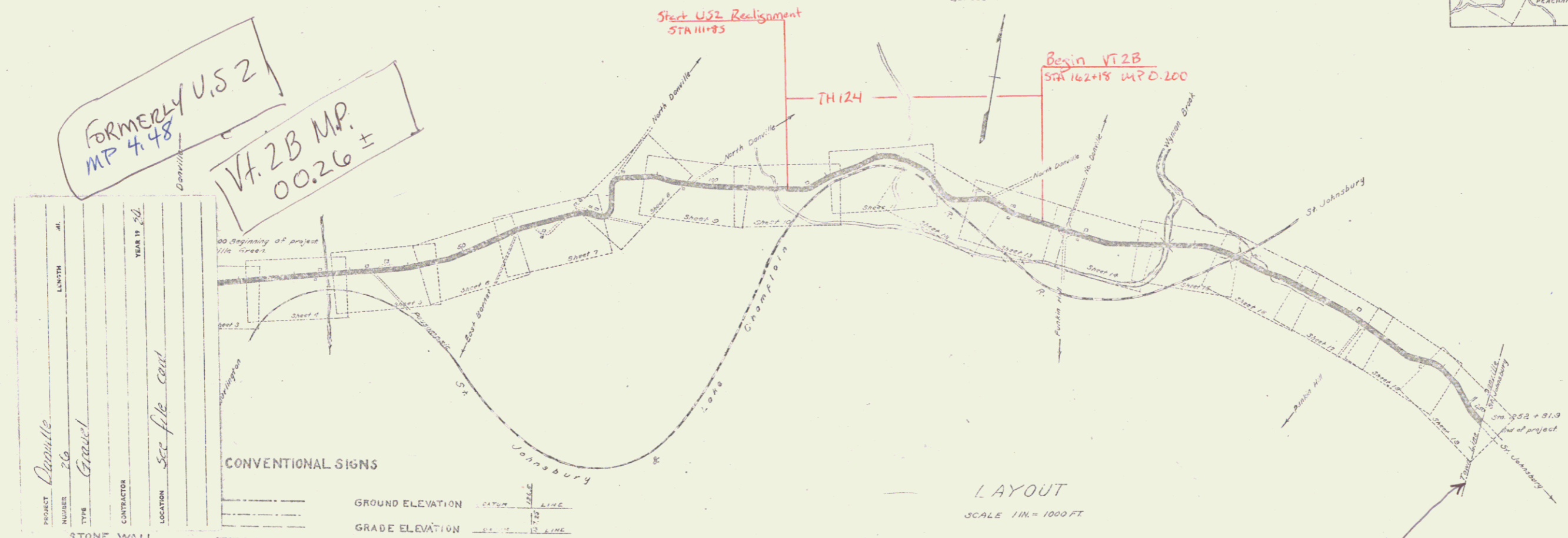

RIGHT-OF-WAY DIVISION
TOWN FILE
PERPETUAL
Pte of US 2B
(To Be Returned To R.O.W. Division)

- PROJECT: Danville
NUMBER: 26
TYPE: Grade
CONTRACTOR: Sec file cont.
LOCATION: Hill Rd
- STONE WALL
 - UNFENCED PROPERTY
 - GUARD RAIL
 - TRAVELED WAY
 - RAIL ROAD
 - RETAINING WALL
 - RAIL OR SURVEY LINE
 - CULVERT
 - DROP INLET
 - TROLLEY POLE
 - POWER POLE
 - TELEPHONE POLE
 - TREE
 - HEDGE

- CONVENTIONAL SIGNS
- GROUND ELEVATION - 12 FT. LINE
GRADE ELEVATION - 12 FT. LINE
- CURVE DATA
- DEFLECTION ANGLE Δ
 - DEGREE OF CURVE D
 - RADIUS OF CURVE R
 - TANGENT DISTANCE T
 - LENGTH OF CURVE L
 - EXTERNAL DISTANCE E
 - POINT OF INTERSECTION P.I.
 - POINT OF CURVE P.C.
 - POINT OF TANGENT P.T.

LAYOUT
SCALE 1 in = 1000 ft.

Vt. 2B
M.P. 1:916

1/1/21

RECOMMENDED: [Signature]

STATE ENGINEER: [Signature]

APPROVED: [Signature]

GOVERNOR: [Signature]

SUBMITTED BY ORDER OF THE STATE HIGHWAY BOARD: [Signature]

COMMISSIONER OF HIGHWAYS: [Signature]

RECOMMENDED: [Signature]

DISTRICT ENGINEER: [Signature]

RECOMMENDED: [Signature]

CHIEF ENGINEER: [Signature]

APPROVED: [Signature]

DIRECTOR: [Signature]

Series # 1-53

STEARNS R. JENNINS

US 2