

WOOD GUARD RAIL REQUIRED

CULVERT STATION	LEFT	RIGHT
231+35	24'	24'
236+05	24'	24'

CONCRETE CURB REQUIRED

STATIONS	LEFT	RIGHT	CHORD	ARC LENGTH
236+40-237+50	40'	40'	08'	90'

DIMENSIONAL MACADAM GUTTER REQUIRED

STATIONS	LEFT	RIGHT	CHORD	ARC LENGTH	DEPTH	THICKNESS	SURFACE COURSE
236+40-237+50	40'	40'	08'	90'	1.5 CY.	2.0 CY.	

CULVERT DEPIKED REQUIRED

STATION	NATURE OF DEPIKED	CONC. SIZE	LENGTH	CONC. A	CONC. C	STEEL
231+35	New Headwalls	18"	24'	3.5	3.5	33"
236+05	"	18"	24'	3.5	3.5	33"
236+75	Extension	24"	20'	3.3	3.3	1.3" 71"

DRIVEWAY PIPE CULVERTS REQUIRED

STATION	LEFT	RIGHT	DIAM.	LENGTH	CEMENT	PILE	MOORWAY
236+28	24'	24'	24"	20'			
236+75	24'	24'	24"	20'			

GRAUTED COBBLE GUTTER REQUIRED

Stations	L-R	Length	Width	Area
238+00-241+25	N+T	225'	3'6"	130 sq. yds.

FED. ROAD DIST. NO.	STATE	FED. AID	TOTAL SHEET	TOTAL SHEETS
2	VT.	D-26	1931	1937

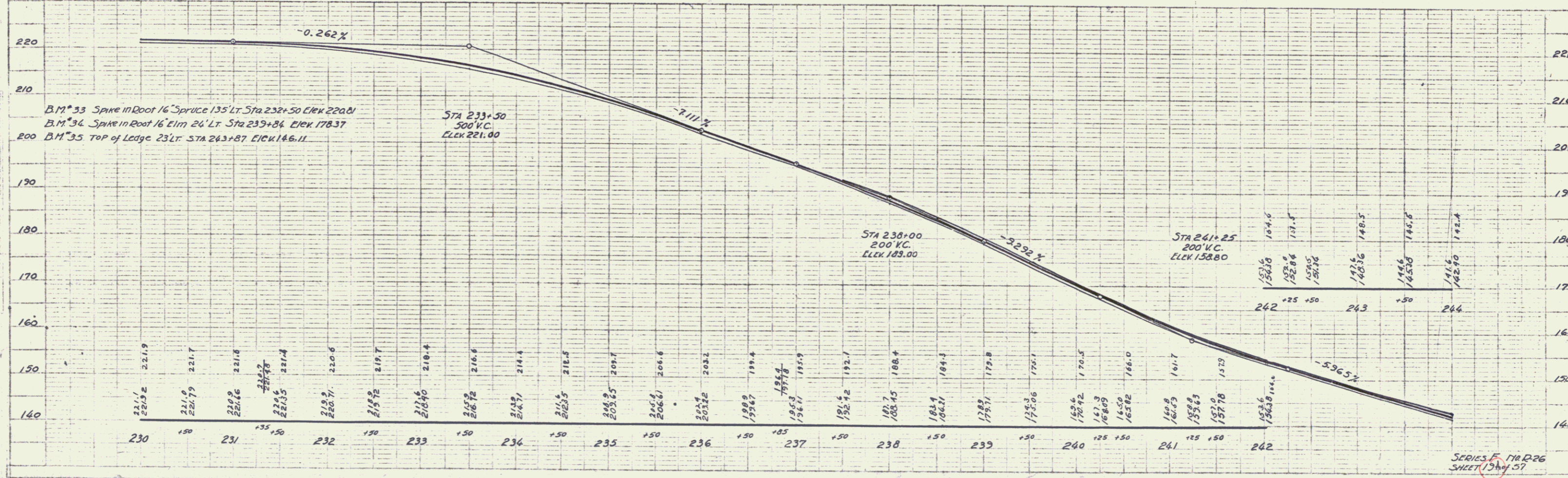
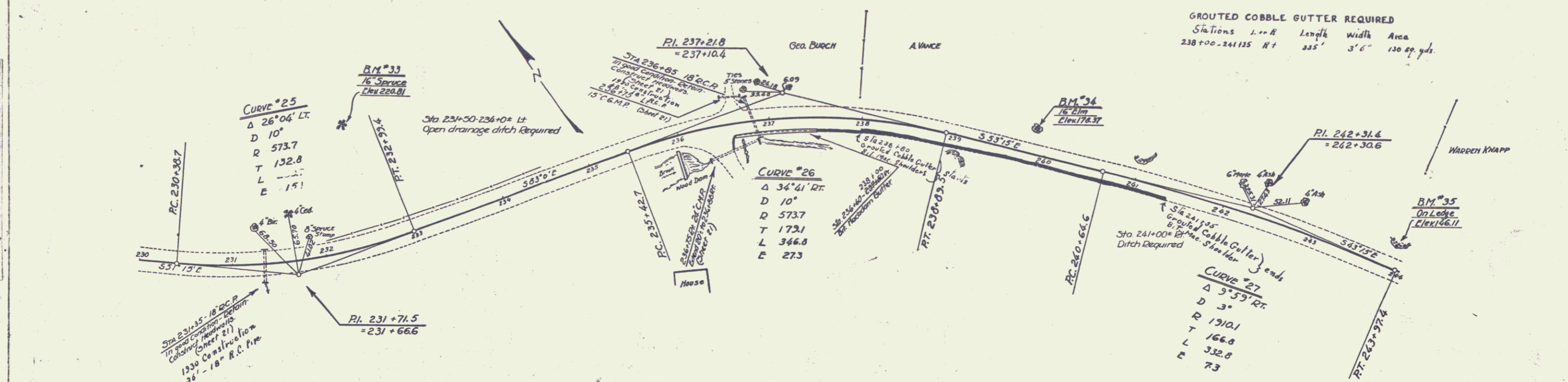

SERIES F No. D26 SHEET 15 of 37