

CULVERT REPAIRS REQUIRED  
 STATION NATURE OF REPAIRS - C.G.M.P.  
 214+33 (Extend 4' Lt. 1.6 cy)

Hand been  
 Extended  
 Order for this

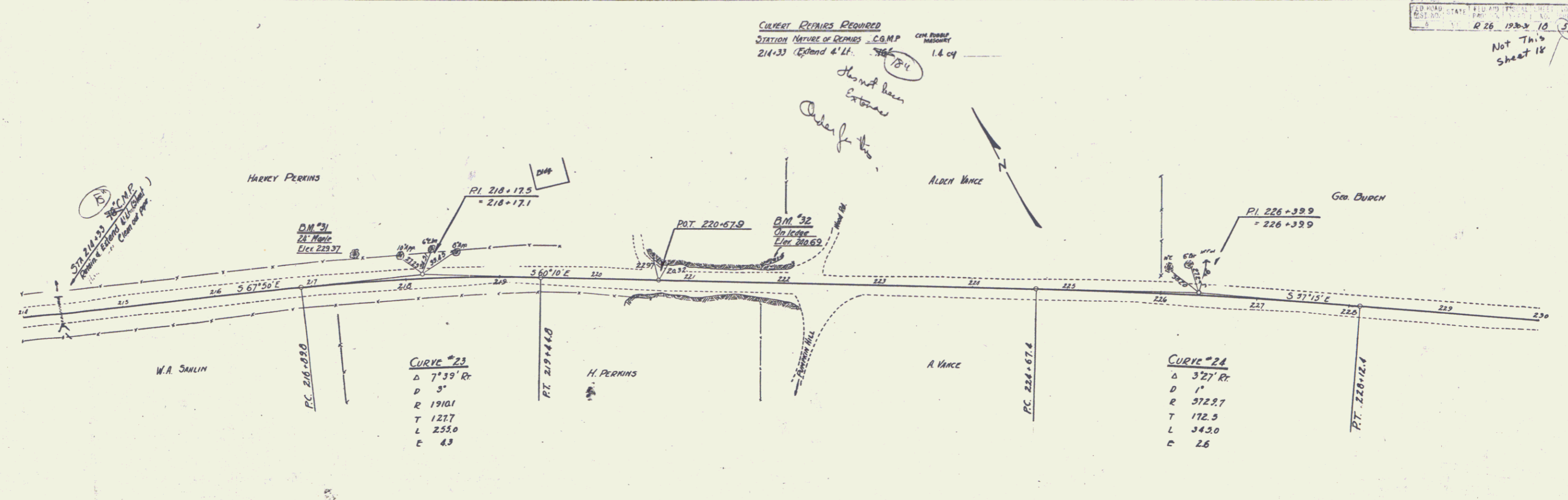

**CURVE #23**  
 $\Delta$  7°39' Rt  
 D 5'  
 R 19101  
 T 1277  
 L 253.0  
 E 4.3

**CURVE #24**  
 $\Delta$  3°21' Rt  
 D 1'  
 R 3722.7  
 T 172.5  
 L 34.30  
 E 2.6

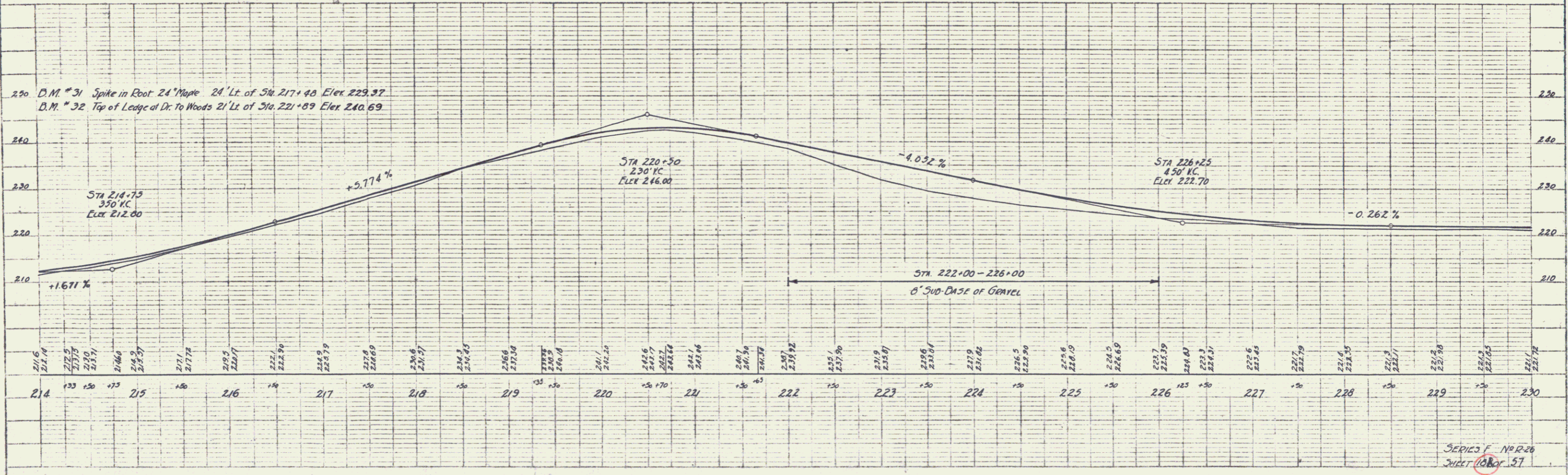

250 D.M. #31 Spike in Root 24 Maple 24' Lt. of Sta 217+98 Elev 229.37  
 D.M. #32 Top of Ledge at Dr. To Woods 21' Lt. of Sta 221+89 Elev 240.69

SERIES F No. R 26  
 SUBJECT 1087 57