

WOOD GUARD RAIL REQUIRED	
CULVERT STATION	LEFT RIGHT
214+33	24' 24'

DRIVEWAY PIPE CULVERTS REQUIRED			
Stations	Length	Material	Notes
219+60	LT 30'	concrete	J.T.C.Y.

CULVERT REPAIRS REQUIRED		
STATION	NATURE OF REPAIRS	CONCRETE
214+33	Extend 4' LT	18" 16.4'

FED. ROAD DIST. NO. 26 1931 18 57

NOTE: STA 216+50 - 220+50 LK+RT USE 1 ON 2 1/2 SLOPE.

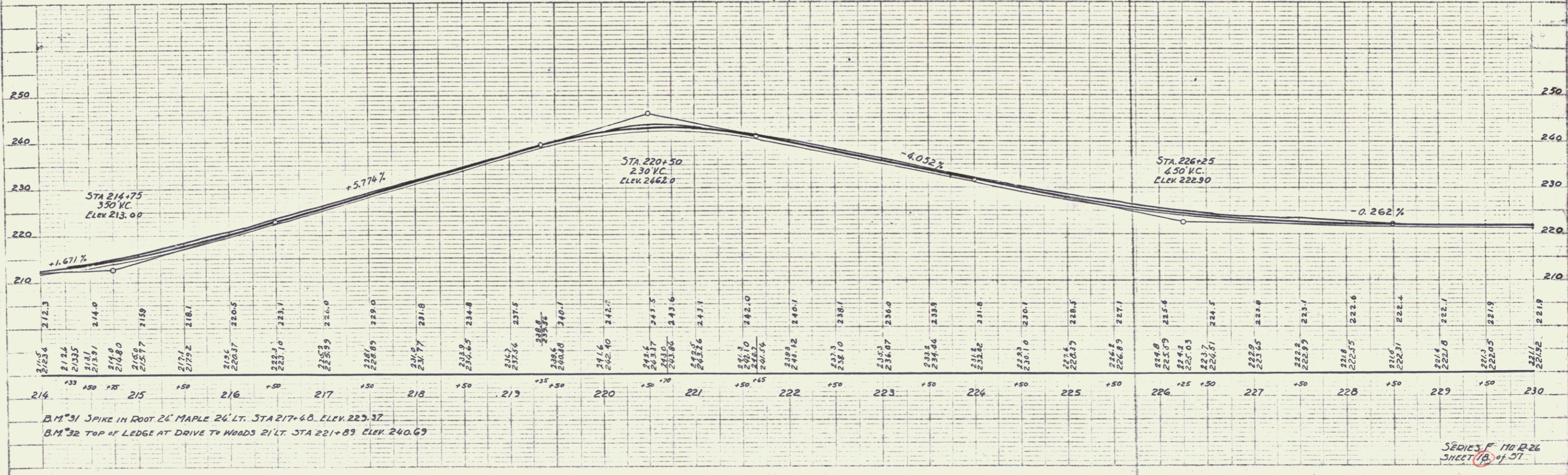
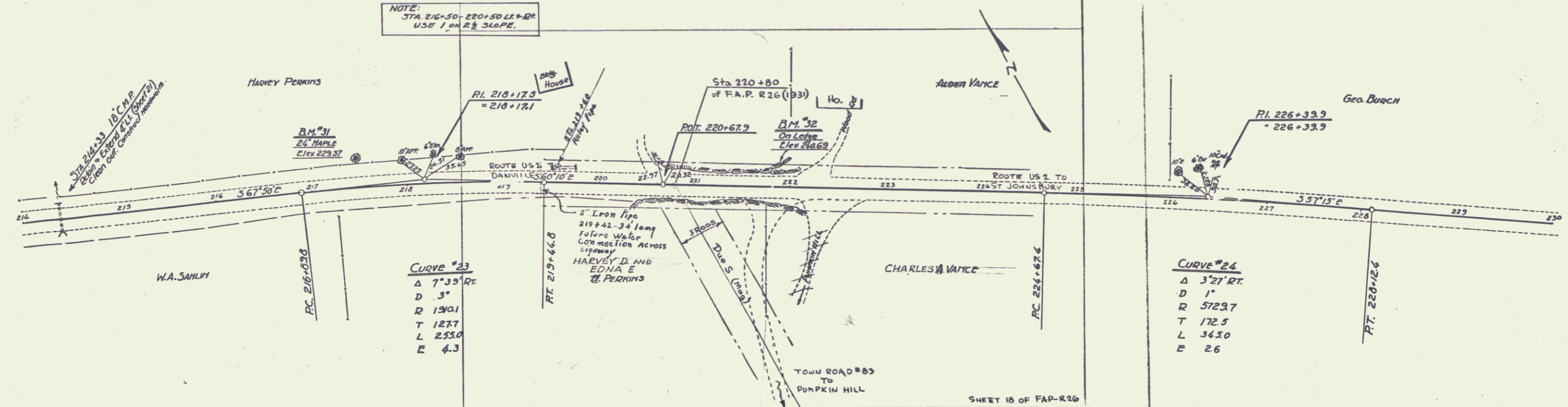

B.M. #31 SPIKE IN ROOT 24' MAPLE 24' LT. STA 217+60. ELEV. 223.37
 B.M. #32 TOP OF LEDGE AT DRIVE TO WOODS 21' LT. STA 221+89. ELEV. 240.69

SERIES F No. B-26 SHEET 18 of 57