

FED. ROAD DIST. NO.	STATE	PROJ. NO.	FISCAL YEAR	SHEET NO.	TOTAL SHEETS
9	Vt.	67(2)	1947	4	37

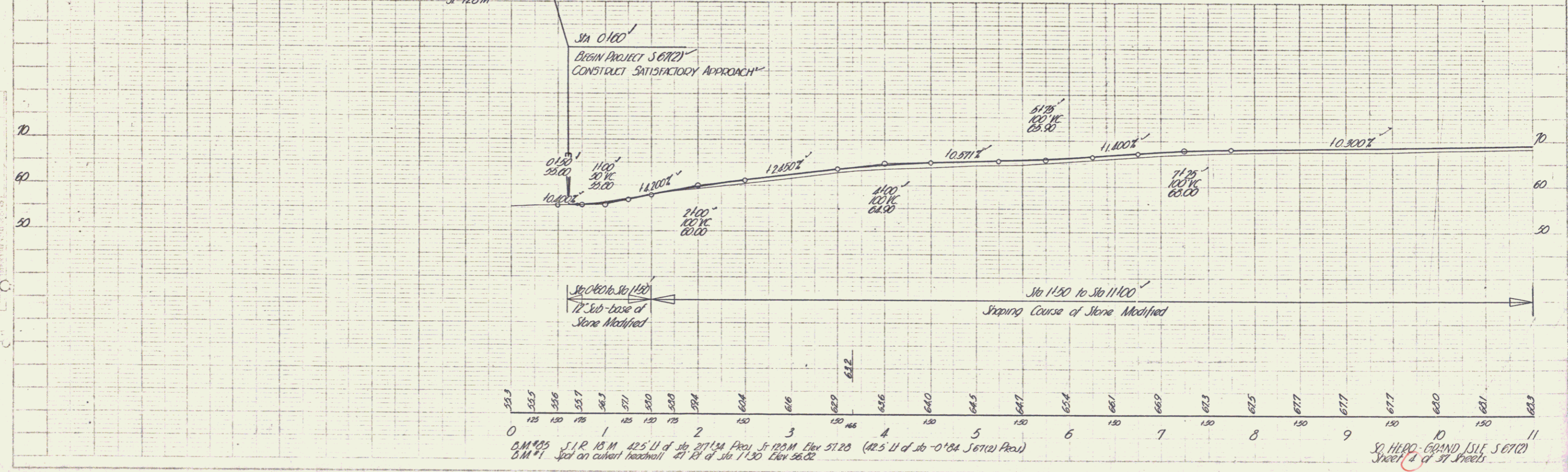
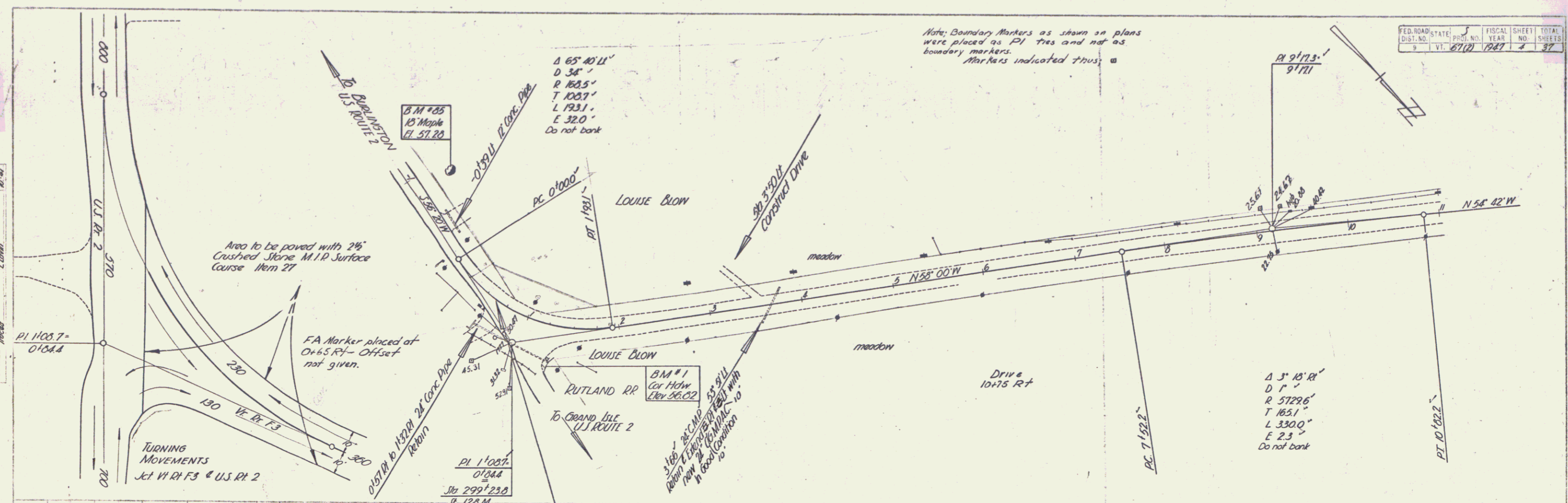

0 B.M. #25 S.I.R. 10 M. 42.5' U of Sta 277.34 Prec. Jt. 128.0 M Elev. 57.20 (42.5' U of Sta -0+84 S 67(2) Prec.)  
 B.M. #1 Jct on culvert headwall 27' R of Sta 1+30 Elev. 56.02

SO. HEAD - GRAND ISLE S 67(2)  
 Sheet 4 of 37 Sheets