

(To Be Returned To R.O.W. Division)
 TOWN FILE
 PERMANENT
 GILBERT A. VAUGHN
 HIGHWAY DIVISION
 Mrs. S. H. WATKINS

PWA 1939 2 19
 RWA DOC No. VT 1092 F-2 B2

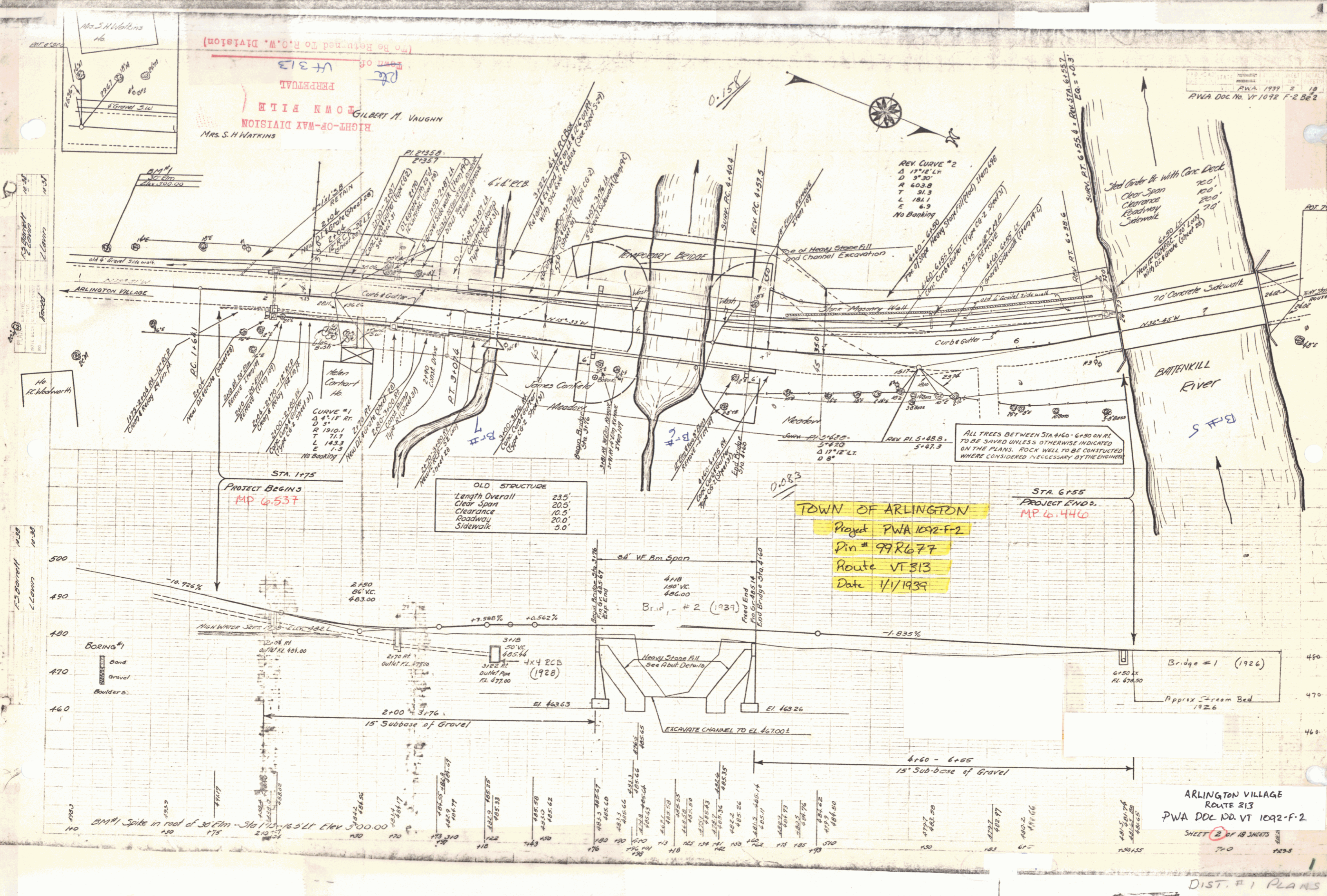

REY CURVE #2
 Δ 17°12' LT
 D 5°30'
 A 403.8
 T 31.3
 L 18.1
 E 6.9
 No Banking

OLD STRUCTURE	
Length Overall	235'
Clear Span	205'
Clearance	10.5'
Roadway	20.0'
Sidewalk	5.0'

TOWN OF ARLINGTON
 Project PWA 1092-F-2
 Pin # 99R677
 Route VT 313
 Date 1/1/1939

ALL TREES BETWEEN STA 6160 - 6150 ON R/L TO BE SAVED UNLESS OTHERWISE INDICATED ON THE PLANS. ROCK WILL TO BE CONSTRUCTED WHERE CONSIDERED NECESSARY BY THE ENGINEER.

ARLINGTON VILLAGE
 ROUTE 213
 PWA DOC NO. VT 1092-F-2
 SHEET 2 OF 18 SHEETS

DIST. # 1 PLANS