

INDEX OF SHEETS

SHEET NO. 1	TITLE PAGE
2	TYPICAL CROSS-SECTION OF IMPROVEMENT STABILIZED GRAVEL BASE COURSE OF OUTBACK ASPHALT WITH SAND SEAL, ITEM 303-B
3	BANKING AND WIDENING TABLES
4	CONSTRUCTION DETAILS DRAINAGE AND MARKERS
5	CONSTRUCTION DETAILS C&I (DITCHES)
6	QUANTITY SHEET (ITEMS AND DRAINAGE)
7-9	EARTHWORK SHEETS
10-17	PLAN AND PROFILE SHEETS
18	STANDARD STRUCTURE SHEET S 40 (BARRICADES, SIGNS AND LIGHTS)
19-40	CROSS SECTIONS

STANDARD STRUCTURE SHEET APPROVED BY THE CHIEF ENGINEER, VERMONT STATE DEPARTMENT OF HIGHWAYS.
S 40 JUNE 10 1950

**STATE OF VERMONT
STATE HIGHWAY DEPARTMENT**

**PLAN AND PROFILE OF PROPOSED
STATE HIGHWAY**

SECONDARY PROJECT
TOWNS OF TINMOUTH-IRA
COUNTY OF RUTLAND
VERMONT ROUTE 2
MIDDLETOWN SPRINGS-WEST RUTLAND ROAD

BEGINNING AT THE MIDDLETOWN SPRINGS-TINMOUTH TOWN LINE AND EXTENDING NORTHERLY 10,425.4 FEET.
LENGTH OF PROJECT 10,425.4 FT. = 1.975 MILES

FED. ROAD DIV. NO.	STATE	PROJ. NO.	FISCAL YEAR	SHEET NO.	TOTAL SHEETS
1	VT.	9 211(4)	POST WAR	1	40

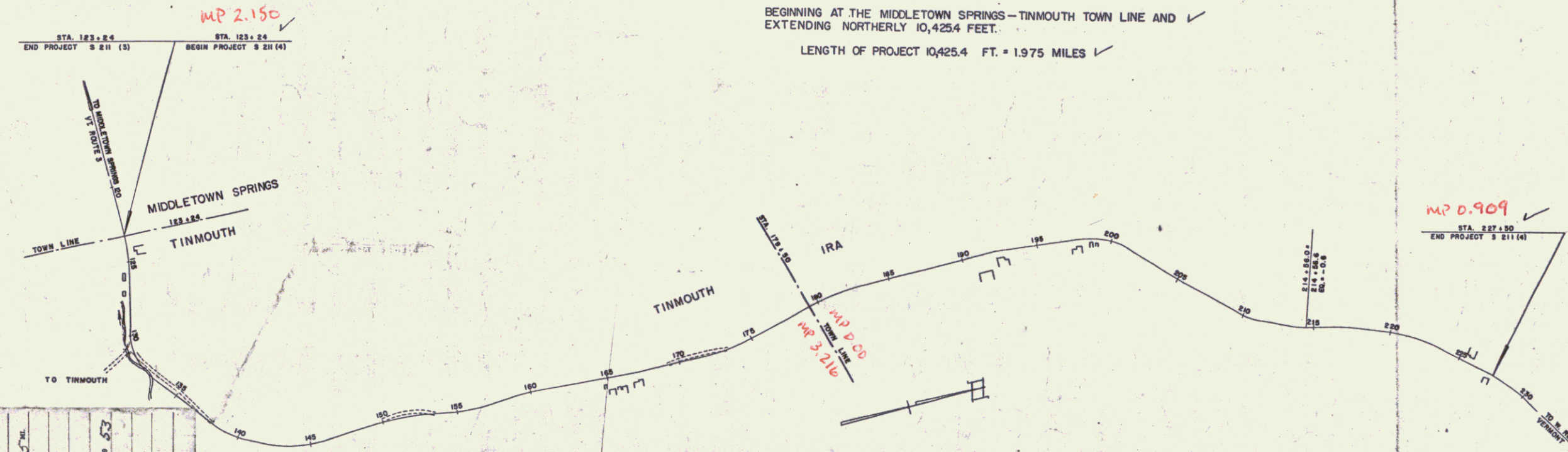
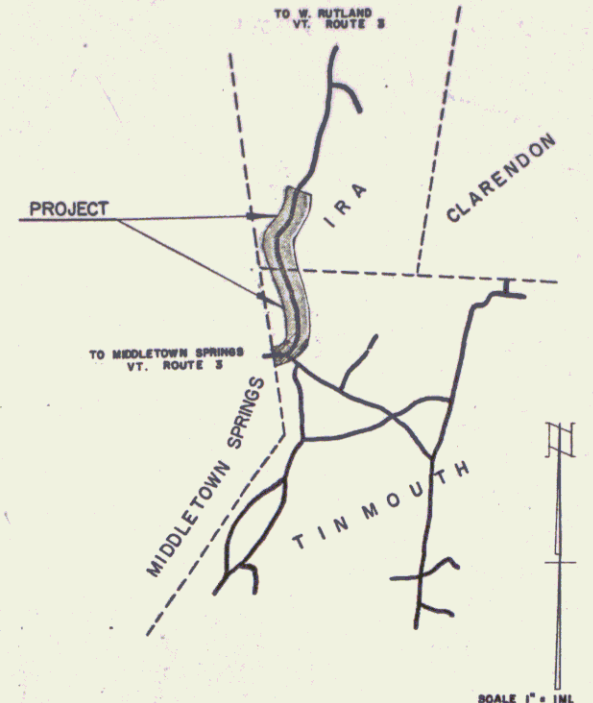

RIGHT-OF-WAY DIVISION
TOWN FILE
PERPETUAL
Town of **IRA**
(To Be Returned To R.O.W. Division)

APPROVED: *[Signature]*
CHIEF ENGINEER
SUBMITTED BY ORDER OF THE STATE HIGHWAY BOARD

PROJECT: Tinmouth-Ira
SHEET: S-211(4)
TYPE: Stab. Gr. Base.
CONTRACTOR: W.H. Morse Const. Co.
LOCATION: See Title Sheet.

GROUND ELEVATION DATUM: IRRA LINE
GRADE ELEVATION DATUM: STATE LINE

CURVE DATA

DEFLECTION ANGLE	Δ
DEGREE OF CURVE	D
RADIUS OF CURVE	R
TANGENT DISTANCE	T
LENGTH OF CURVE	L
EXTERNAL DISTANCE	E
POINT OF INTERSECTION	P. I.
POINT OF CURVE	P. C.
POINT OF TANGENT	P. T.
POINT ON TANGENT	P. O. T.

SCALES

TITLE	1" = 400'
TYPICAL	1" = 2'
PLAN	1" = 50'
PROFILE HORIZONTAL	1" = 80'
PROFILE VERTICAL	1" = 10'
CROSS SECTIONS	1" = 5'

PROJECT NAME & NUMBER	TYPE	PAVEMENT AREA
TINMOUTH-IRA S 211 (4)	STAB. GR. BASE	23,280 S.Y.
RECORD PLANS		
MATERIALS:		
RCP HUDSON FALLS BUILDING & SUPPLY CO.	ACCGMP BERGER MET CULV. CO, WESTMINSTER STA.	
SUB-BASE OF GRAVEL WALLACE & NORTON PITS	ASPHALT SOCCONY VACUUM, RIVERSIDE, R. I.	
GUIDE POSTS WARNER-GRISWOLD CORP, ESSEX VT.		
CONTRACTOR W. H. MORSE CONST. CO, BENNINGTON, VT.	CONTRACT DATED	OCT. 14, 1952
RES. ENGINEER W. V. KALLIO	CONTRACT STARTED	OCT. 13, 1952
INSPECTOR R. F. NICHOLSON	CONTRACT COMPLETED	AUG. 28, 1953
RECORD PLANS H. A. HEALD	CONTRACT ACCEPTED	AUG. 28, 1953

THESE PLANS ARE SUBJECT TO SUCH REVISIONS AS MAY BE REQUIRED BY THE BUREAU OF PUBLIC ROADS OR THE COMMISSIONER OF HIGHWAYS.
CONSTRUCTION IS TO BE CARRIED ON IN ACCORDANCE WITH THE PLANS AND THE STANDARD ROAD AND BRIDGE SPECIFICATIONS OF 1948, AS APPROVED JULY 25 1949 BY THE BUREAU OF PUBLIC ROADS INCLUDING ALL SUBSEQUENT APPROVED REVISIONS AND SUCH REVISED SPECIFICATIONS AND SPECIAL PROVISIONS AS ARE SUBMITTED WITH THE PLANS.

NOTE: ANY FURTHER INFORMATION CONCERNING FINAL QUANTITIES, RECORD PLANS, OR DETAILS RELATIVE TO THIS PROJECT CAN BE OBTAINED EITHER IN THE FIELD OFFICE OR IN THE ESTIMATE FILE.

DEPARTMENT OF COMMERCE
BUREAU OF PUBLIC ROADS
RECOMMENDED FOR APPROVAL

DISTRICT ENGINEER DATE
APPROVED

APPROVED: *[Signature]* 10/15/52 SECONDARY ENGINEER
APPROVED: *[Signature]* CONSTRUCTION ENGINEER
APPROVED: *[Signature]* HIGHWAY ENGINEER
APPROVED: *[Signature]* DISTRICT ENGINEER

DIVISION ENGINEER DATE
PROJECT S No. 211(4) FILED
SHEET 1 OF 40