

INDEX OF SHEETS	
SHEET NO.	1 TITLE PAGE
	2 TYPICAL CROSS SECTION OF IMPROVED DOUBLE END-CURT OF RIVER (SEE NOTE PER STATE ROAD, FROM 31-54 (1957-58))
	3 BANKING AND SIDING TABLES
	4 QUANTITY SHEET (ITEMS AND DRAINAGE)
5-6	EARTHWORK SHEETS
7	CONSTRUCTION DETAILS CO (DRAINAGE AND MARKERS)
8	CONSTRUCTION DETAILS ONE-T (DITCHES)
9	STANDARD STRUCTURE SHEET S-40 (BARRICADES SIGNS AND LIGHTS)
10	STANDARD STRUCTURE SHEET S-53-40 (PRECAST REINFORCED CONC. PIPE DROP INLETS)
11-15	PLAN AND PROFILE SHEETS
16-24	CROSS SECTIONS

STANDARD STRUCTURE SHEET APPROVED BY THE CHIEF ENGINEER, VERMONT STATE DEPARTMENT OF HIGHWAYS.  
S-40 JUNE 10, 1950

STATE OF VERMONT  
DEPARTMENT OF HIGHWAYS

PROPOSED IMPROVEMENT

TOWN OF MIDDLETOWN SPRINGS  
COUNTY OF RUTLAND  
VERMONT ROUTE X  
MIDDLETOWN SPRINGS - TINMOUTH ROAD

BEGINNING AT A POINT 10,463.2 FT. WESTERLY OF THE MIDDLETOWN SPRINGS - TINMOUTH TOWN LINE AND EXTENDING EASTERLY (6,412.2) FT. = (1.214) MILES  
LENGTH OF PROJECT 6,412.2 FT. = 1.214 MILES

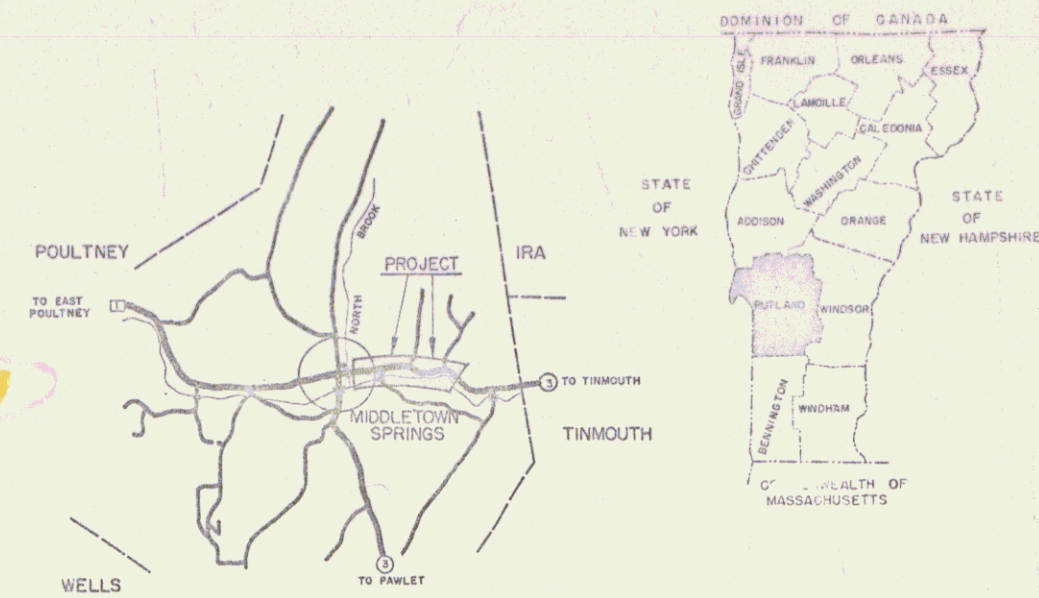

RIGHT-OF-WAY DIVISION  
TOWN FILE  
PERPETUAL  
Town of U433  
(To Be Returned To R.O.W. Division)

PROJECT NAME & NUMBER	TYPE	PAVEMENT AREA
MIDDLETOWN SPRINGS S 211 (5)	DEL. TK. COAT	1-612 S.Y.
RECORD PLANS		
MATERIALS		
SUB-BASE OF GRAVEL	MIDDLETOWN SPRINGS	RCP VT. CONCRETE PIPE CORP. WINDSOR
REFINED TARKOPPERS	PROD. CO. EVERETT, MASS.	ACCGMP BERGER MET. OULV. CO. BOSTON, MASS.
PEASTONE FOR SEAL	CLARK & HAYNES, POULTNEY	CABLE FOR G.R. BETHLEHEM STEEL CO.
CONTRACTOR	FRANK J. FABIAN FAIRHAVEN, VT.	CONTRACT DATED DECEMBER 22, 1953
RESIDENT ENGR.	R. FUNK - B. M. BLANCHARD	CONTRACT STARTED JANUARY 11, 1954
INSPECTORS	A. SYLVESTER	CONTRACT COMPLETED NOVEMBER 17, 1954
RECORD PLANS	JOHN M. TURNER, FEB. 24, 1955	CONTRACT ACCEPTED NOVEMBER 17, 1954

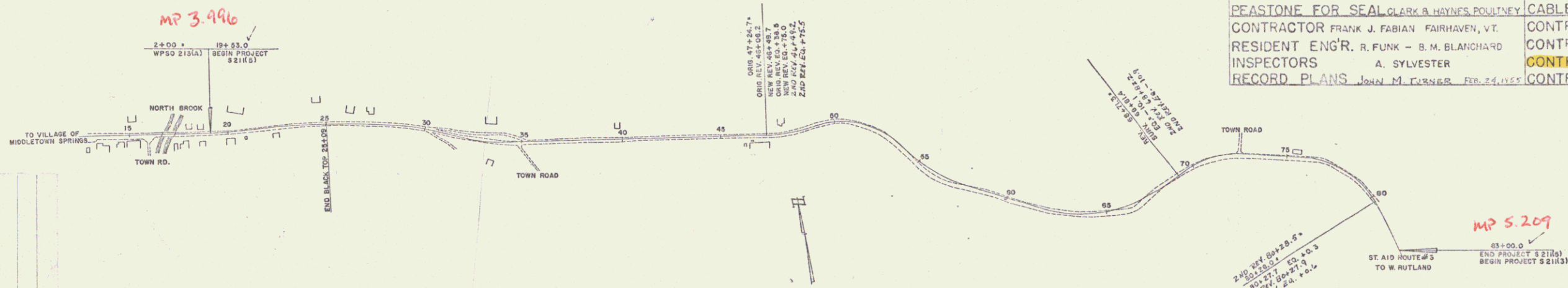

PROJECT: MIDDLETOWN SPRINGS  
NUMBER: S-211(5)  
TYPE: DEL. TK. COAT  
CONTRACTOR: F. J. FABIAN  
LOCATION: MIDDLETOWN SPRINGS - TINMOUTH RD.

CURVE DATA	
DEFLECTION OF ANGLE	Δ
DEGREE OF CURVE	D
RADIUS OF CURVE	R
TANGENT DISTANCE	T
LENGTH OF CURVE	L
EXTERNAL DISTANCE	E
POINT OF INTERSECTION	P.I.
POINT OF CURVE	P.C.
POINT OF TANGENT	P.T.
POINT ON TANGENT	P.O.T.
POINT ON SUB-TANGENT	P.O.S.T.

SCALES	
TITLE	1" = 300'
TYPICAL	1" = 2'
PLAN	1" = 50'
PROFILE HORIZONTAL	1" = 10'
PROFILE VERTICAL	1" = 10'
CROSS-SECTIONS	1" = 6'

APPROVED: *[Signature]* DISTRICT ENGINEER DATE: NOV 2 1953  
 APPROVED: *[Signature]* BRIDGE ENGINEER DATE: NOV 2 1953  
 APPROVED: *[Signature]* DISTRICT ENGINEER DATE: NOV 2 1953  
 APPROVED: *[Signature]* DISTRICT ENGINEER DATE: NOV 2 1953

THESE PLANS ARE SUBJECT TO SUCH REVISIONS AS MAY BE REQUIRED BY THE BUREAU OF PUBLIC ROADS OR THE COMMISSIONER OF HIGHWAYS.  
CONSTRUCTION IS TO BE CARRIED ON IN ACCORDANCE WITH THE PLANS AND THE STANDARD ROAD AND BRIDGE SPECIFICATIONS OF 1948, AS APPROVED JULY 25, 1949 BY THE BUREAU OF PUBLIC ROADS, INCLUDING ALL SUBSEQUENT APPROVED REVISIONS AND SUCH REVISED SPECIFICATIONS AND SPECIAL PROVISIONS AS ARE SUBMITTED WITH THE PLANS.

DEPARTMENT OF COMMERCE  
BUREAU OF PUBLIC ROADS  
APPROVED: \_\_\_\_\_ DISTRICT ENGINEER DATE: \_\_\_\_\_  
PROJECT: S NO. 211 (5)  
SHEET 1 OF SHEETS 34



PLAN	Profile	Shells	167
Sheet	Surface		
Traced			

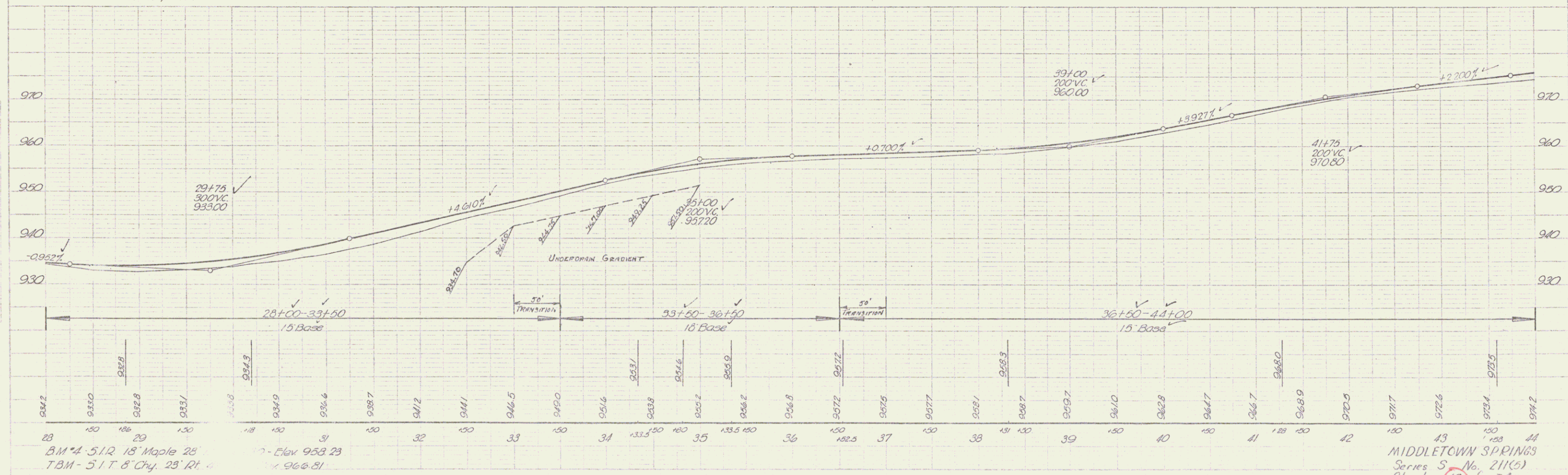
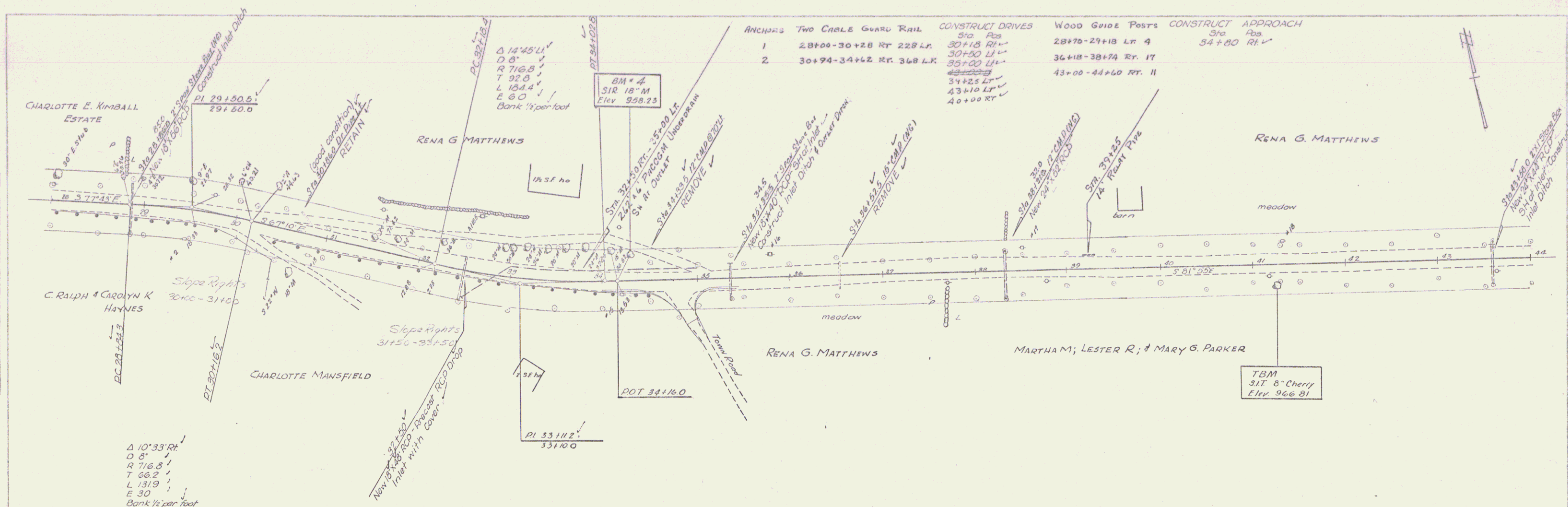

MIDDLETOWN SPRINGS  
 Series S No. 211(5)  
 Sheet 12 of 34



