

MIDDLETOWN SPRINGS
CURVE #10

$\Delta = 34^{\circ}23'16''$
 $D = 8^{\circ}08'11''$
 $R = 704.19'$
 $T = 217.90'$
 $L = 422.64'$
 $E = 32.94'$

MIDDLETOWN SPRINGS
CURVE #11

$\Delta = 111^{\circ}08'$
 $D = 0^{\circ}36'43''$
 $R = 3554.69'$
 $T = 348.09'$
 $L = 693.98'$
 $E = 17.00'$

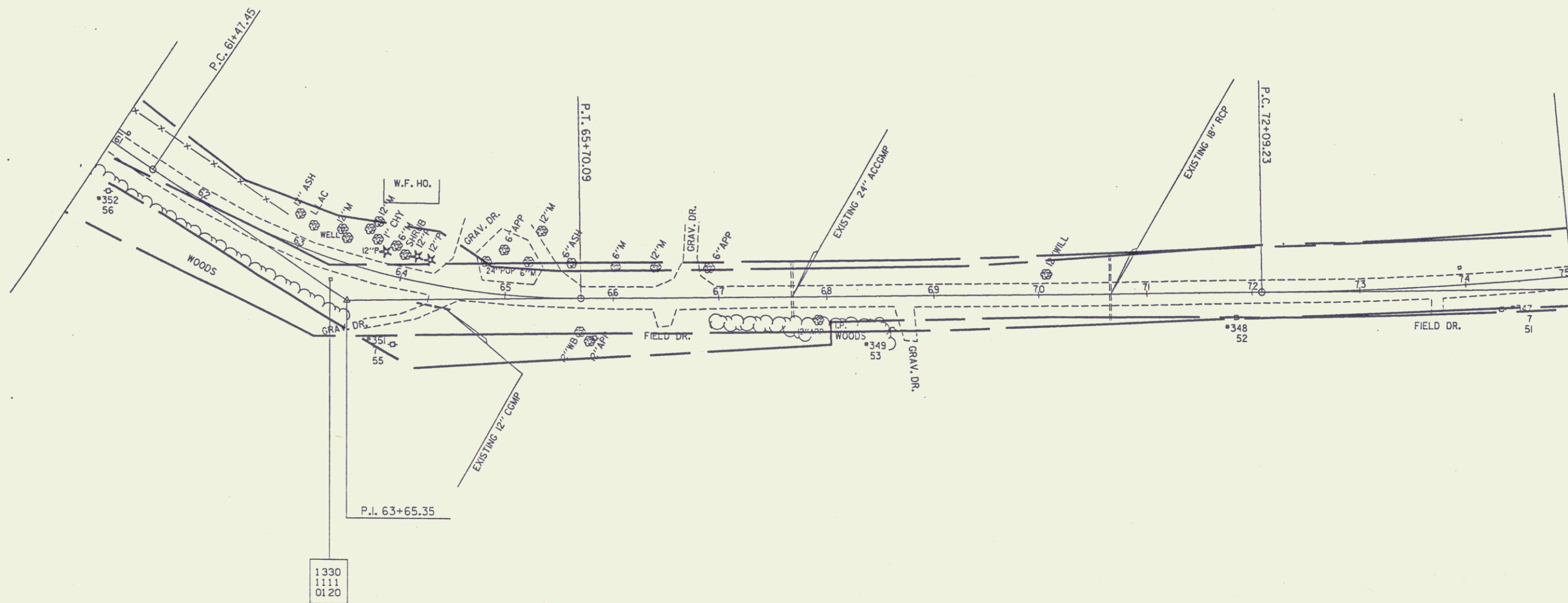

Sheet 63
 SURVEYED BY MOREAU DA
 DRAWN BY DAYE DA
 SQUAD LEADER 32