

INDEX OF SHEETS

1. Title Sheet
2. Drainage and Item Quantity Sheet
3. Earthworks
4. L&P Detail
- 5-6. Plan-Profile
- 7-8. Typical Slope Grading
9. B-10 Embankment on a Slope
10. B-12 Side Road Intersection
11. B-13 Drive Intersection
- 11-12. C-1 & In Curbs & Sit. Conc. Sidewalk
13. U-2 Gut, Manhole & Underdrain
14. D-4 Underdrain Flowing Basin
15. C-8 10:1:1
16. D-9 R&D Top w/Granite Curbs
17. D-10 Grades for R&D's
18. E-1 Barricades, Signs & Lights (For Roadway)
19. E-31 Federal Aid Construction Identification Signs
- 20-21. Cross Sections (Vt. 111 & Vt. 1132)

Vt 132

STATE OF VERMONT
DEPARTMENT OF HIGHWAYS

PROPOSED IMPROVEMENT

TOWN OF SHARON
COUNTY OF WINDSOR
VERMONT ROUTE 132
SHARON-SO. STRAFFORD ROAD

Pin# 99R650

BEGINNING AT THE INTERSECTION OF VERMONT ROUTES
14 AND 132 AND EXTENDING NORTHERLY 0.094 MILE
LENGTH OF ROADWAY 498.75 FEET=0.094 MILE
LENGTH OF PROJECT 498.75 FEET=0.094 MILE

ADT 1962	865
ADT 1986	2000
DHV 1986	295
D 1986	56
T 1986	8.5 %
V	30 MPH

PROJECT NAME & NUMBER	TYPE PAVEMENT	AREA BY
SHARON S. 0177 (1)	BITUMINOUS CONCRETE	
RECORD PLANS		
MATERIALS		
SUB-BASE OF GRAVEL	ANDREWS PT., SHARON, VT.	
SUB-BASE OF SAND		
GRAVEL		
CRUSHED GRAVEL		
REFINED TAR		
CUTBACK ASPHALT	MOBIL OIL CORP., B. PROVIDENCE, R.I.	
SAND OR PEASTONE		
FOR SEAL		
CONCRETE CLASS 'B'	MILLER READY-MIX, ROYALTON, VT.	
BIT. CON. PAVEMENT	L. M. PIKE & SON, INC., WILSONVILLE, N.H.	
REINFORCING STEEL	BETHLEHEM STEEL CORP., BETHLEHEM, PA.	
METAL PIPE CULVERT	METAL CLAY CO., WHITE RIVER JCT., VT.	
P.C.P.	T. H. WOLFE & CO. INC., WILLISTON, VT.	
CAST IRON SPATES	GRAY FOUNDRY, INC., FOUNTNEY, VT.	
DROP INLETS		
SHARD RAIL ITEMS	S. T. GRONWOLD, WILLISTON, VT.	
STRUCTURAL STEEL		
CAST IRON COVER FOR F.I.		
EXTENSION CURBS & CURB STOP	MUEBLER CO., DECATUR, GA.	
STEEL WARE LINE		
SLEEVES FOR WATER PIPE		

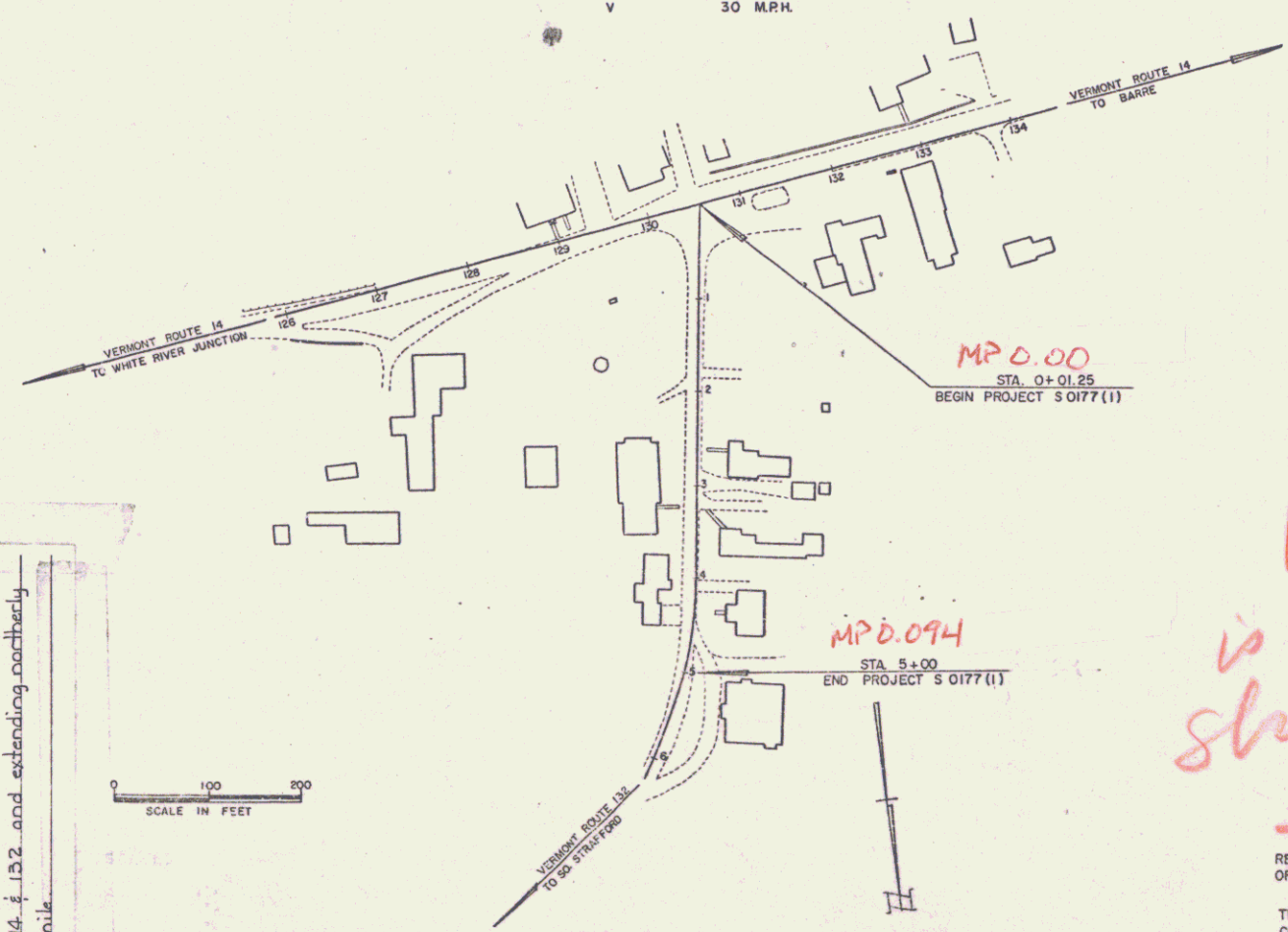
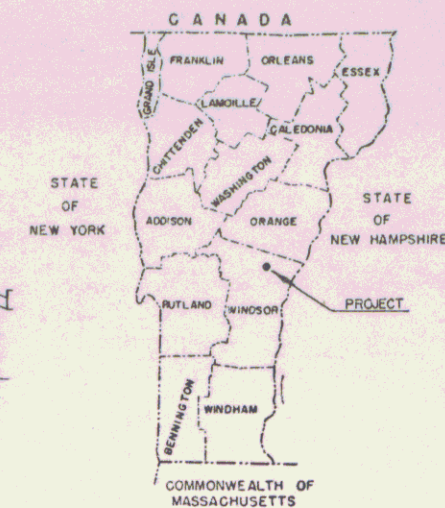
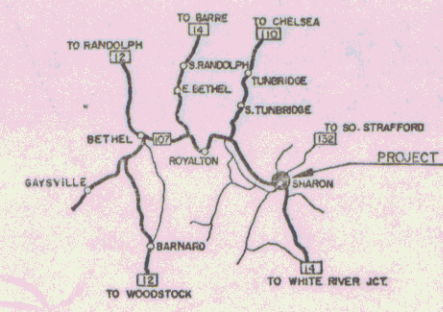

CONVENTIONAL SIGNS

COUNTY LINE	-----
TOWN LINE	-----
FENCE LINE	-----
STONE WALL	-----
UNFENCED PROPERTY	-----
GUARD RAIL	-----
TRAVELED WAY	-----
RAILROAD	-----
RETAINING WALL	-----
CENTER LINE	-----
SURVEY LINE	-----
CULVERT	-----
DROP INLET	-----
TRULLEY POLE	-----
POWER POLE	-----
TELEPHONE POLE	-----
TREES	-----
HEDGE	-----

GROUND ELEVATION
GRADE ELEVATION
CURVE C
DEFLECTION OF ANGLE
DEGREE OF CURVE
RADIUS OF CURVE
TANGENT DISTANCE
LENGTH OF CURVE
EXTERNAL DISTANCE
POINT OF INTERSECT
POINT OF CURVE
POINT ON TANGENT
POINT ON SUB-TANGENT

PROJECT: SHARON
NUMBER: S. 0177 (1)
TYPE: BITUMINOUS CONCRETE PAVEMENT
CONTRACTOR: PERINI CORPORATION
LOCATION: Beginning of the intersection of Vermont Routes 14 & 132 and extending northerly 0.094 mile

APPROVED: <i>[Signature]</i> DATE: 12/1/64	APPROVED: <i>[Signature]</i> DATE: 12-1-64	APPROVED: <i>[Signature]</i> DATE: 12/3/64	APPROVED: <i>[Signature]</i> DATE: 12-1-64	APPROVED: <i>[Signature]</i> DATE: Dec 5, 1964
---	---	---	---	---

Vt 132
is 0.22 mi
Sharon
only

THESE PLANS ARE SUBJECT TO SUCH REVISIONS AS MAY BE REQUIRED BY THE BUREAU OF PUBLIC ROADS OR THE COMMISSIONER OF HIGHWAYS.
CONSTRUCTION IS TO BE CARRIED ON IN ACCORDANCE WITH THESE PLANS AND THE STANDARD SPECIFICATIONS FOR HIGHWAY AND BRIDGE CONSTRUCTION, DATED APRIL, 1964 AS APPROVED BY THE BUREAU OF PUBLIC ROADS ON OCTOBER 12, 1964 INCLUDING ALL SUBSEQUENT APPROVED REVISIONS AND SUCH REVISED SPECIFICATIONS AND SPECIAL PROVISIONS AS ARE INCORPORATED IN THESE PLANS.

PERINI CORP., FRAMINGHAM, MASS.	9/13/66
JOHN WOOD	7/12/66
PHILIP R. ROLLER, FRASCOLO & AREY, R.F. WOOD	7/12/66

RIGHT-OF-WAY DIVISION
TOWN FILE
PERPETUAL
Town of Vt 132
(To Be Returned To R.O.W. Division)

DEPARTMENT OF COMMERCE
BUREAU OF PUBLIC ROADS

APPROVED: _____
DIVISION ENGINEER DATE _____

PROJECT S No. 0177 (1)
SHEET 1 OF 24 SHEETS

DEMOLITION & REMOVAL OF BUILDING
4100 Ft.

GRANITE CURB, ITEM 556-B
or
PRECAST REINF. CEM. CONC. CURB
ITEM 556-D TYPE A
131+13.21 (Vt #14) - 0+40 Lt (Vt #132)

BIT. CONC. SIDEWALK, ITEM 562
131+13.21 (Vt #14) - 4+73 Lt (Vt #132)

CONSTRUCT DRIVES

DATE	BY	CHKD
REVISED	BY	CHKD
NOT DRAWN	BY	CHKD
ALIGNED	BY	CHKD
CHECKED	BY	CHKD
DESIGNED	BY	CHKD
BY	BY	CHKD
BY	BY	CHKD
BY	BY	CHKD
BY	BY	CHKD

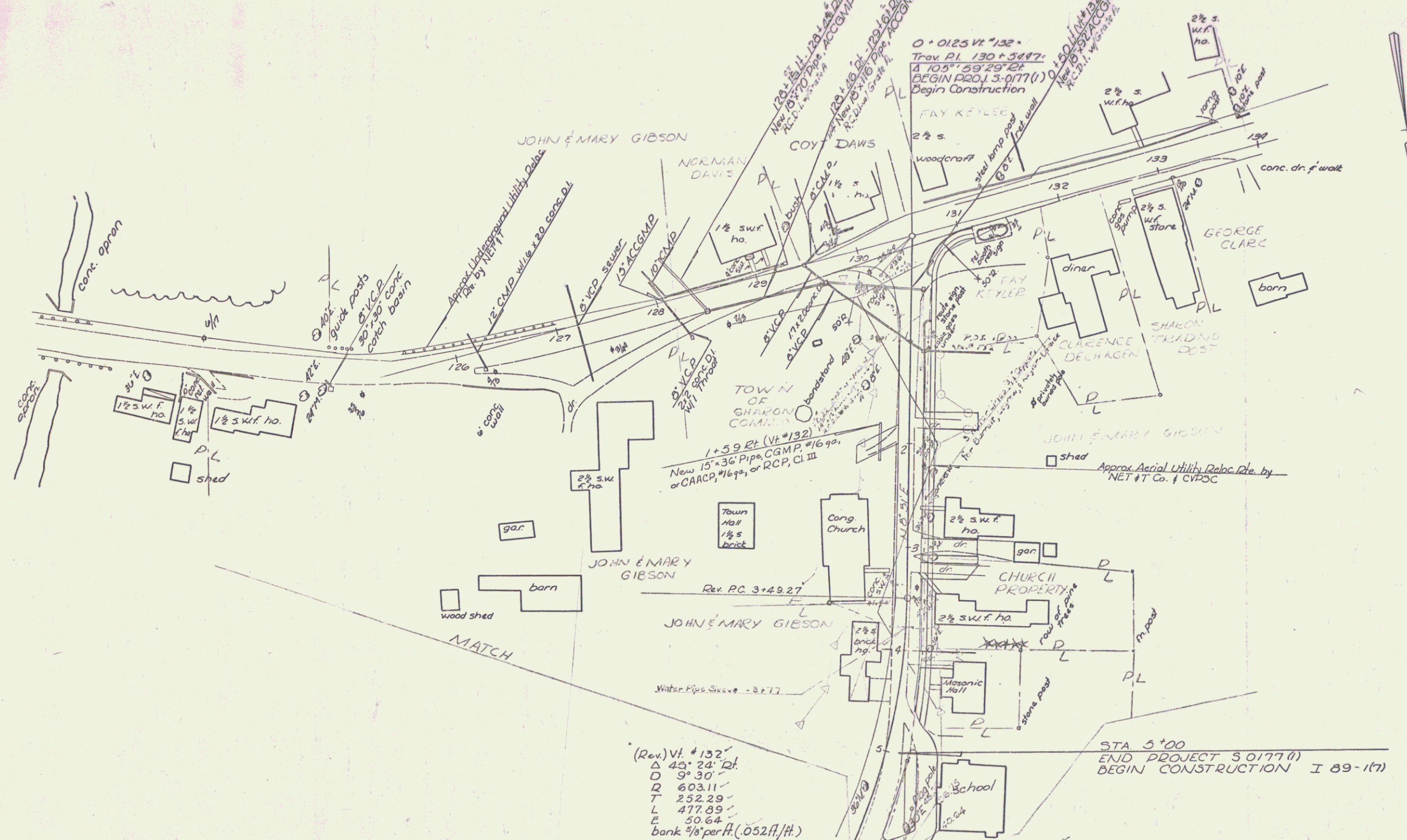

(Rev.) Vt. # 132
 Δ 43° 28' 24"
 D 57° 30'
 R 603.11
 T 252.29
 L 477.89
 E 50.64
 bank $\frac{2}{3}$ per ft. (.052 ft./ft.)

STA 5+00
 END PROJECT 5 0177 (1)
 BEGIN CONSTRUCTION I 89-1(7)

Vt 132 (Surv) PL 6+01.56
 Δ 45° 24' 24"
 D 12° 00'

JCT Rts 14 & 132
 Contract # 2
 HARTFORD SHARON
 I 89-1(7)
 sheet 5 of 24

TYPICAL SECTIONS
 1 1/2" Bituminous Concrete, Item 316-A, Type III
 18" Subbase of Gravel, Item 201
 Tack Coat - Type II-B, Item 316-B

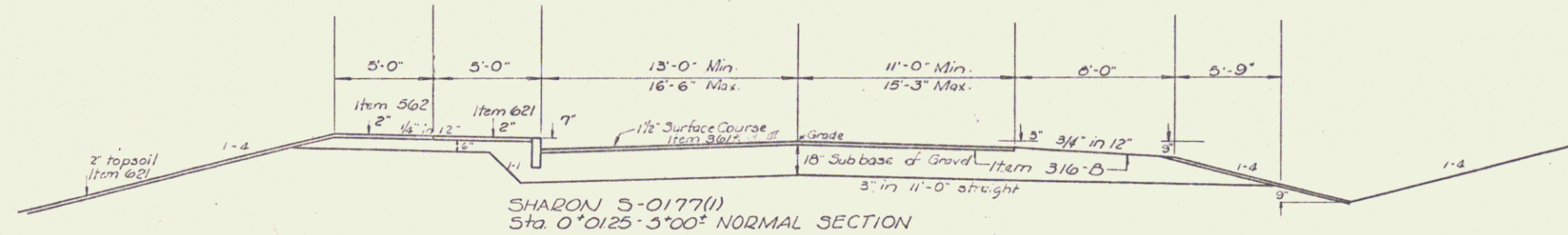

VT. ROUTE 132

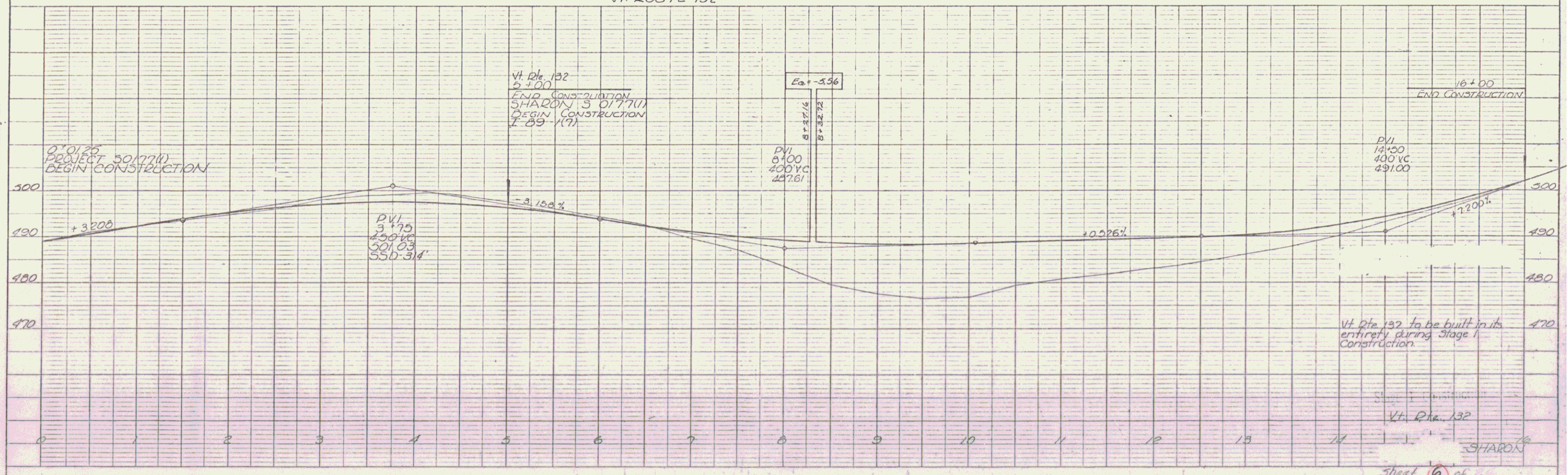

PLAN

DATE	BY	CHKD

NOTE: REVISIONS TO BE CHECKED BY THE ENGINEER.

PROFILE

DATE	BY	CHKD

NOTE: REVISIONS TO BE CHECKED BY THE ENGINEER.

GRANITE CONC. ITEM 500-A
 PRECAST CONCRETE CURB
 ITEM 500-L 75' x 2' x 1'
 0+40-1+60 LF
 1+60-2+10 LF
 2+10-3+40 LF
 3+40-4+00 LF
 4+00-4+60 LF

WHITE RIVER
 POOR ORIGINAL COPY

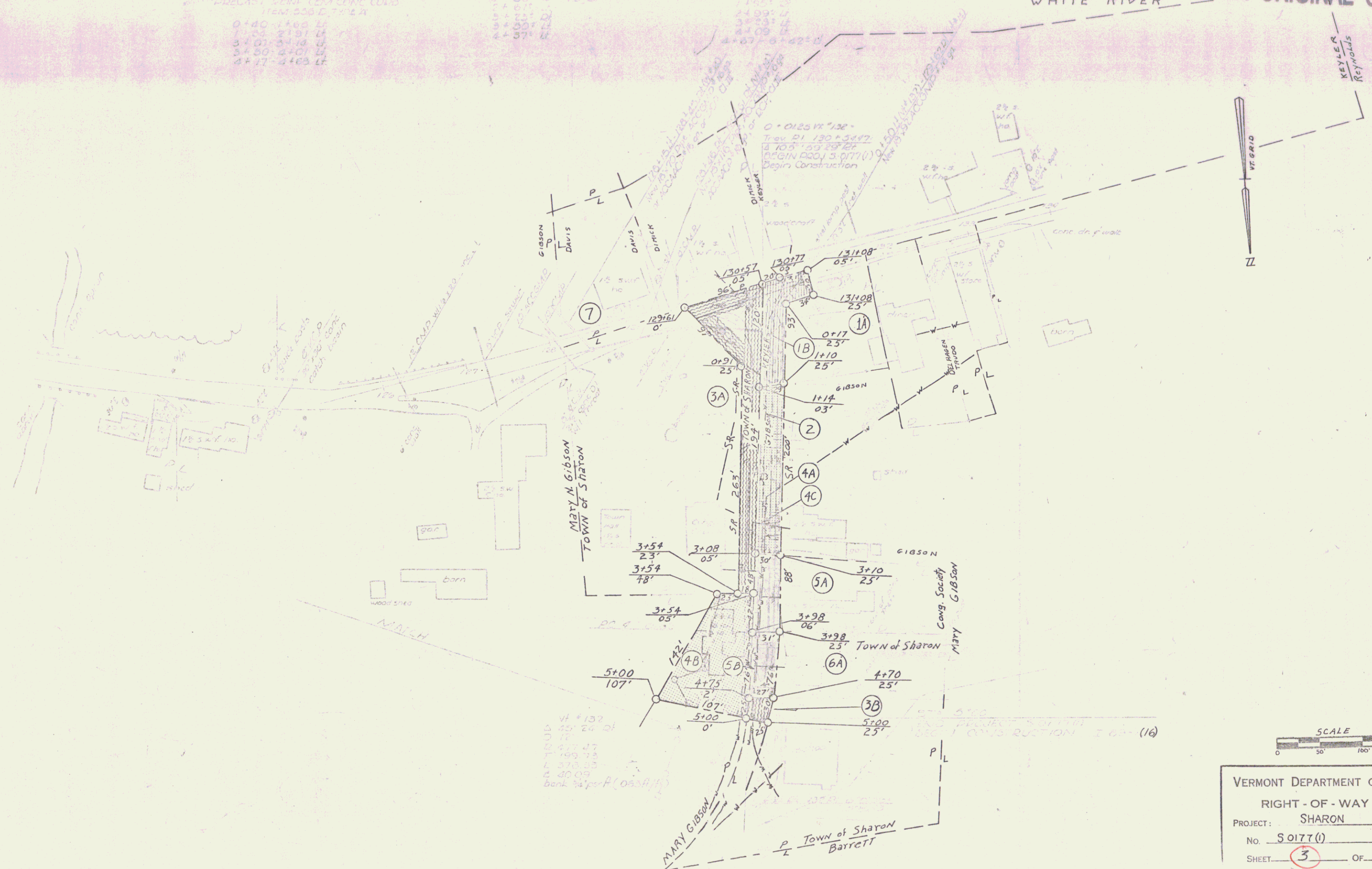

SCALE
 0 50 100 150

VERMONT DEPARTMENT OF HIGHWAYS
 RIGHT-OF-WAY PLANS
 PROJECT: SHARON
 No. S 0177 (1)
 SHEET 3 OF 4



- ⊖ I 89-(1A)
- ⊖ 5 0177(1)

REVISED WATER LINE LOCATIONS
SHARON VILLAGE

VERMONT DEPARTMENT OF HIGHWAYS	
RIGHT-OF-WAY PLANS	
PROJECT	SHARON
NO.	5 0177(1)
SHEET	3A OF 4