

POOR ORIGINAL COPY

**STEEL GUIDE POSTS**  
 Const Drives  
 183+71 Lt. - 185+83 Lt. - 15 ea. 191+25  
 185+70 R. 186+27  
 187+00 187+50

PERCY E. & CYNTHIA N. FOLMSBEE

Sta. 192+25 - 195+23 Lt.  
 Limits of Excavation Channel for Item 543

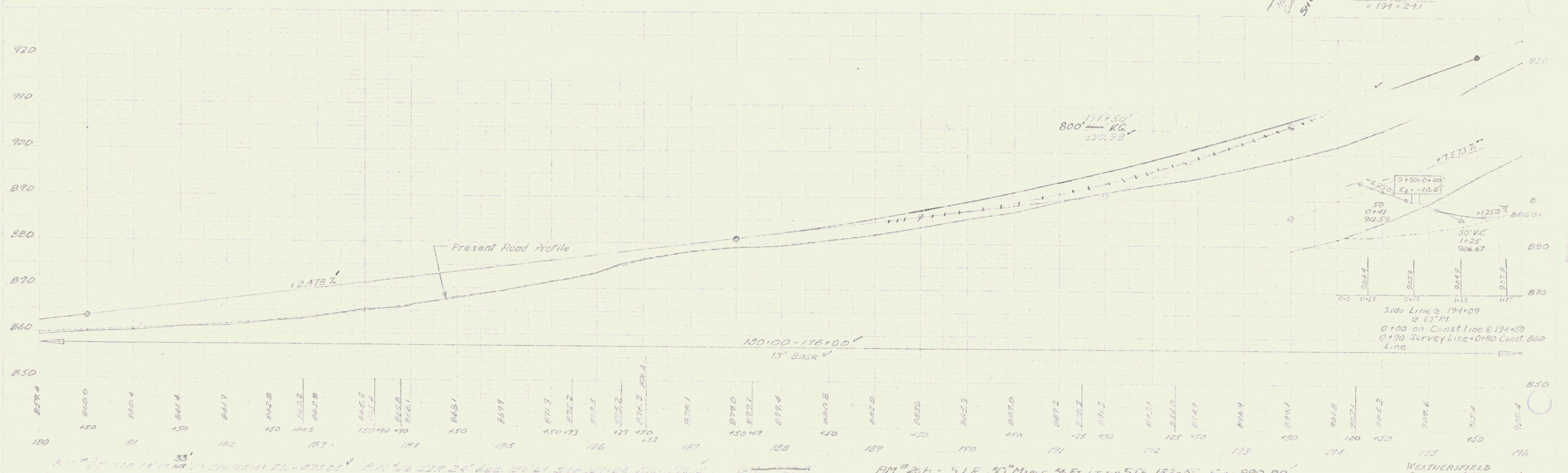
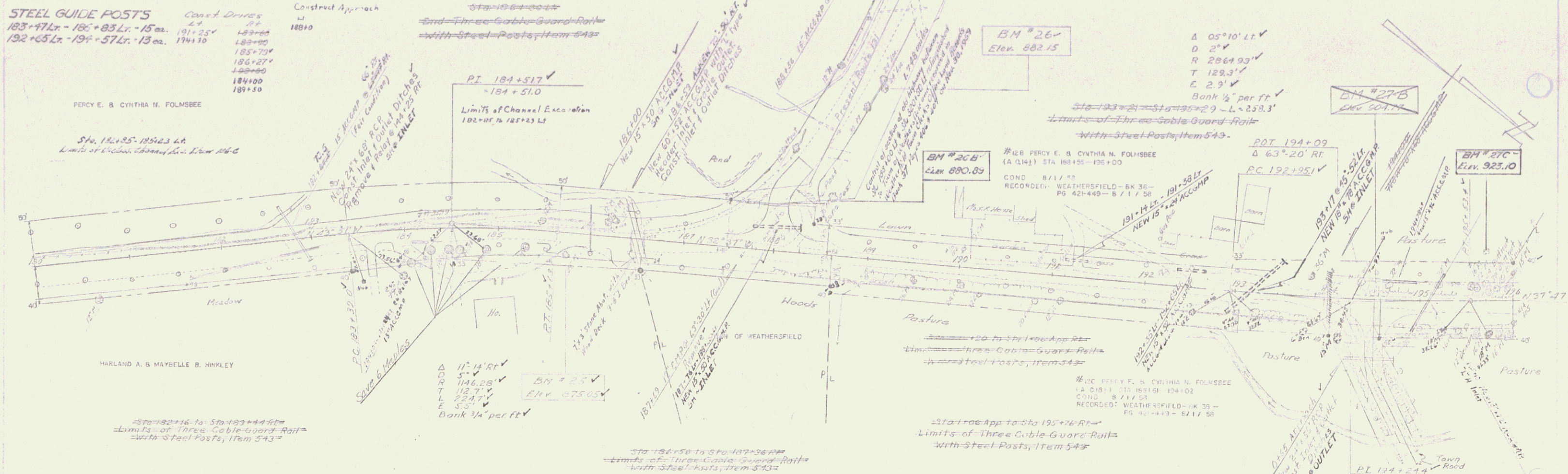

BM # 26B - S.I.R. 30" MAPLE 36 Ft. Lt. of STA. 183+33 Elev. 880.89  
 BM # 27C - S.I.R. 10" ELM 50 Ft. Lt. of STA. 195+70 Elev. 923.10  
 WEATHERSFIELD PROJECT - No. 01-26(1) Sheet 17 of 119 Sheets