

INDEX OF SHEETS

SHEET NO.	1	TITLE PAGE
	2	TYPICAL CROSS-SECTION OF IMPROVEMENT WITH TACK COAT OF REFINED TAR
	3	BANKING & WIDENING TABLES
	4	UTILITY SHEET (ITEMS & DRAINAGE)
	5-6	ESTIMATOR SHEETS
	7	CONSTRUCTION DETAILS (DRAINAGE & MARKERS)
	8	CONSTRUCTION DETAILS (DITCHES)
	9	STANDARD STRUCTURE SHEET (SIGNPOSTS, STONS, & LIGHTS)
	10	STANDARD STRUCTURE SHEET (TWO CALE GRAPD RAIL)
	11	STANDARD STRUCTURE SHEET (PIPE CULVERT DROP INLETS)
	12-16	PLAN & PROFILE SHEETS
	17-31	CROSS SECTIONS

STANDARD STRUCTURE SHEETS APPROVED BY THE CHIEF ENGINEER, VERMONT STATE DEPARTMENT OF HIGHWAYS 5-40 JUNE 10, 1950

PROJECT NAME & NUMBER		TYPE	PAVEMENT AREA
WEATHERSFIELD S 29 (4)		OBL. TACK COAT	12,835 S.Y.
RECORD PLANS MATERIALS			
SUB-BASE OF CRAVEL BROWN PIT, WEATHERSFIELD	ACC.M.P. N.E. METAL CULVERT CO, BOSTON, MASS.		
REFINED TAR BARRETT CO, EDGEWATER, N.J.	CABLE FOR G. R. BETHLEHEM STEEL CO., SPARROWS POINT, MD.		
PEASTONE SEAL WHITCOMB PL., GELLOWS FALLS	GUARD RAIL PAINT MASURY CO.		
S.C.P. VT CONC. PIPE CORP., WINDSOR			
CONTRACTOR	FABI & SONS, LTD.	CONTRACT DATED	SEPT. 3, 1954
RESIDENT ENGR.	JOHN HUGHES	CONTRACT STARTED	SEPT. 18, 1954
INSPECTORS		CONTRACT COMPLETED	JULY 12, 1955
RECORD PLANS	A. ALDRICH	CONTRACT ACCEPTED	JULY 12, 1955

STATE OF VERMONT
DEPARTMENT OF HIGHWAYS
PROPOSED IMPROVEMENT
SECONDARY PROJECT
TOWN OF WEATHERSFIELD
COUNTY OF WINDSOR
VERMONT ROUTE 131 Pin# 992645
CAVENDISH-ASCUTNEY ROAD

BEGINNING AT THE INTERSECTION OF VERMONT ROUTES 106 AND 131 AND EXTENDING NORTHEASTERLY 5624.0 FEET, EXCLUDING BRIDGE (42+18 - 42+92) 5622.3 IN
LENGTH OF PROJECT 5550.0 FEET = 10.51 MILES 5548.3

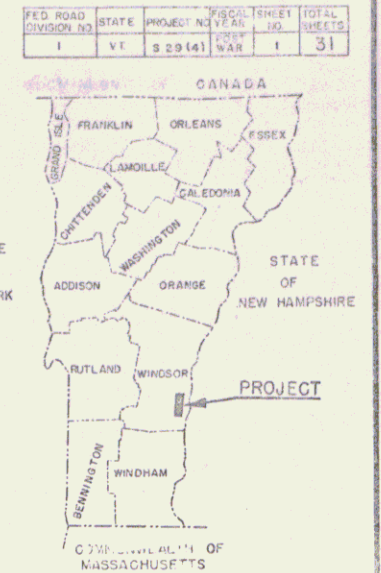

WEATHERSFIELD, VT
TOWN OF WEATHERSFIELD
CAVENDISH-ASCUTNEY
CONTRACTOR: FABI & SONS, LTD.
RESIDENT ENGINEER: JOHN HUGHES
INSPECTOR: A. ALDRICH

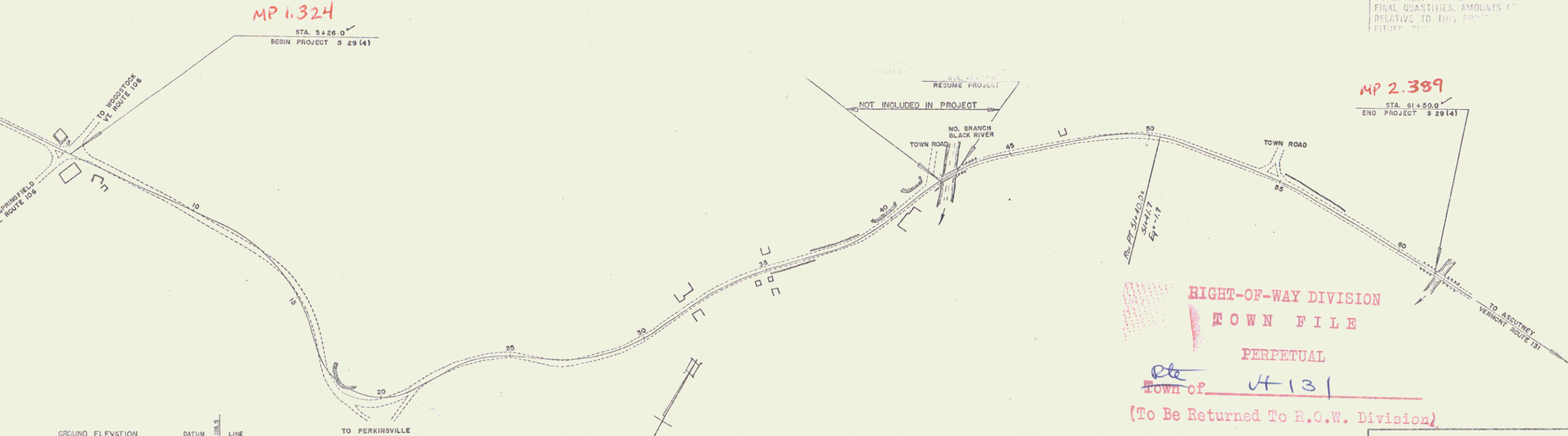
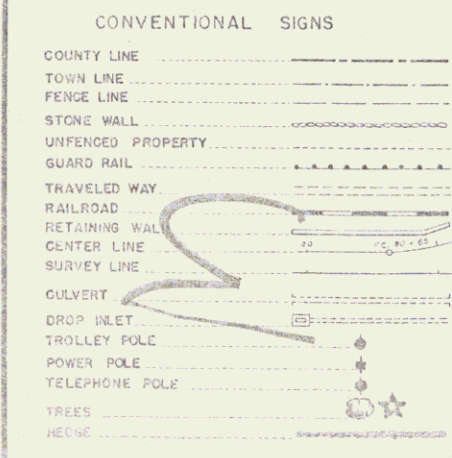

SCALES

- PLAN 1" = 200'
- PROFILE HORIZONTAL 1" = 50'
- PROFILE VERTICAL 1" = 10'
- CROSS-SECTIONS 1" = 5'

CURVE DATA

DEFLECTION OF ANGLE A
DEGREE OF CURVE D
RADIUS OF CURVE R
TANGENT DISTANCE T
LENGTH OF CURVE L
EXTERNAL DISTANCE E
POINT OF INTERSECTION P.I.
POINT OF CURVE P.C.
POINT OF TANGENT P.T.
POINT ON TANGENT P.O.T.
POINT ON SUB-TANGENT P.O.S.T.

RIGHT-OF-WAY DIVISION
TOWN FILE
PERPETUAL
Town of Weatherfield
(To Be Returned To R.O.W. Division)

THESE PLANS ARE SUBJECT TO SUCH REVISIONS AS MAY BE REQUIRED BY THE BUREAU OF PUBLIC ROADS OR THE COMMISSIONER OF HIGHWAYS.
CONSTRUCTION IS TO BE CARRIED ON IN ACCORDANCE WITH THE PLANS AND THE STANDARD ROAD AND BRIDGE SPECIFICATIONS OF 1948, AS APPROVED JULY 25, 1949 BY THE BUREAU OF PUBLIC ROADS, INCLUDING ALL SUBSEQUENT APPROVED REVISIONS AND SUCH REVISED SPECIFICATIONS AND SPECIAL PROVISIONS AS ARE SUBMITTED WITH THE PLANS.

APPROVED: <i>[Signature]</i> DATE: Feb 18, 1954	APPROVED: <i>[Signature]</i> DATE: Feb 17, 1954	APPROVED: <i>[Signature]</i> DATE: Mar 31, 1954	APPROVED: <i>[Signature]</i> DATE: Feb 18, 1954	APPROVED: <i>[Signature]</i> DATE: Feb 12, 1954
--	--	--	--	--

DEPARTMENT OF COMMERCE
BUREAU OF PUBLIC ROADS

APPROVED: _____
DISTRICT ENGINEER

DATE: _____

PROJECT: 5 NO. 29 (4)
SHEET: 1 OF 31 SHEETS

STEARNS R. JENKINS
41131

1/10/08
 12/28
 H. Hurley
 4 TR
 12/15/08
 2/04

12/15/08
 2/04
 4 TR
 12/15/08
 2/04

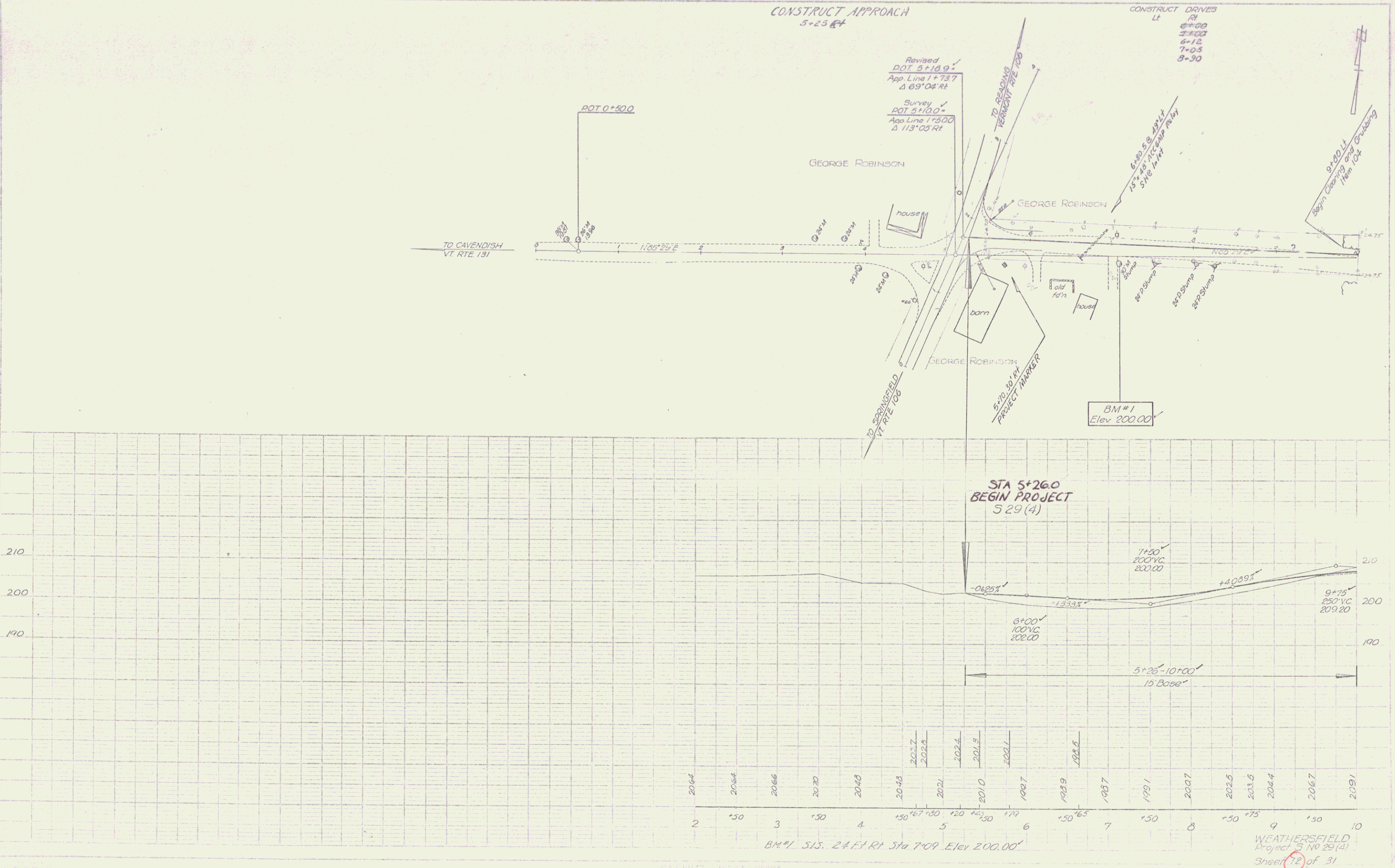

BM #1 SLS. 2+41 RT Sta 7+09 Elev 200.00'

WEATHERSFIELD
 Project 5 No 28(4)
 Sheet 12 of 31

1/1/88
12/88
C.A. Murray
4 Tr.

1/1/88
6/88
C.A. Murray
4 Tr.

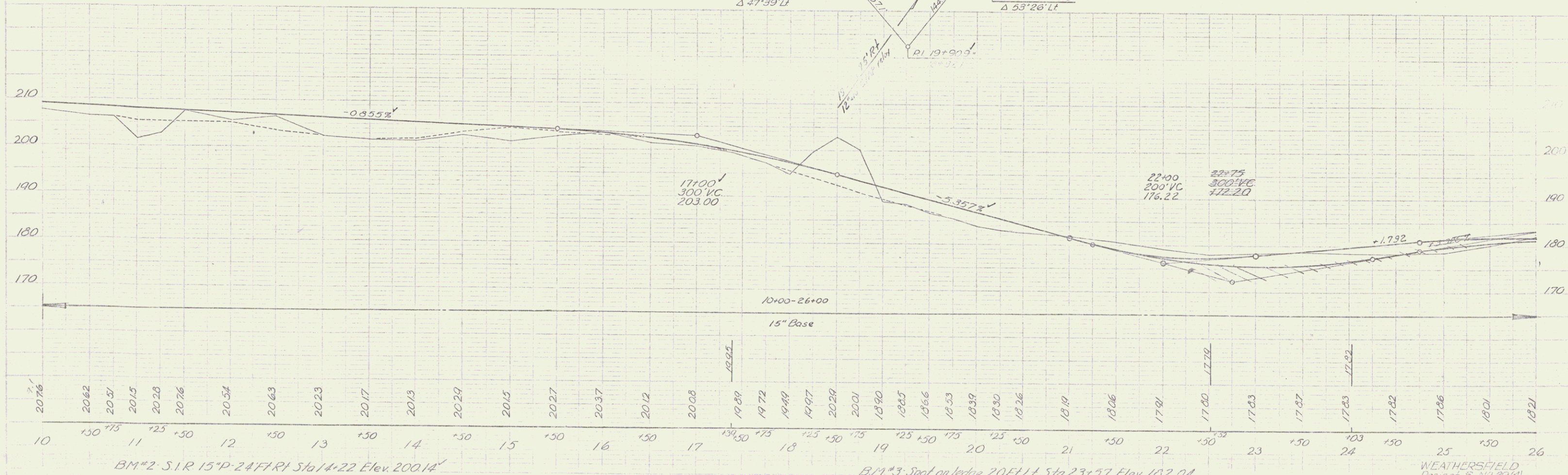
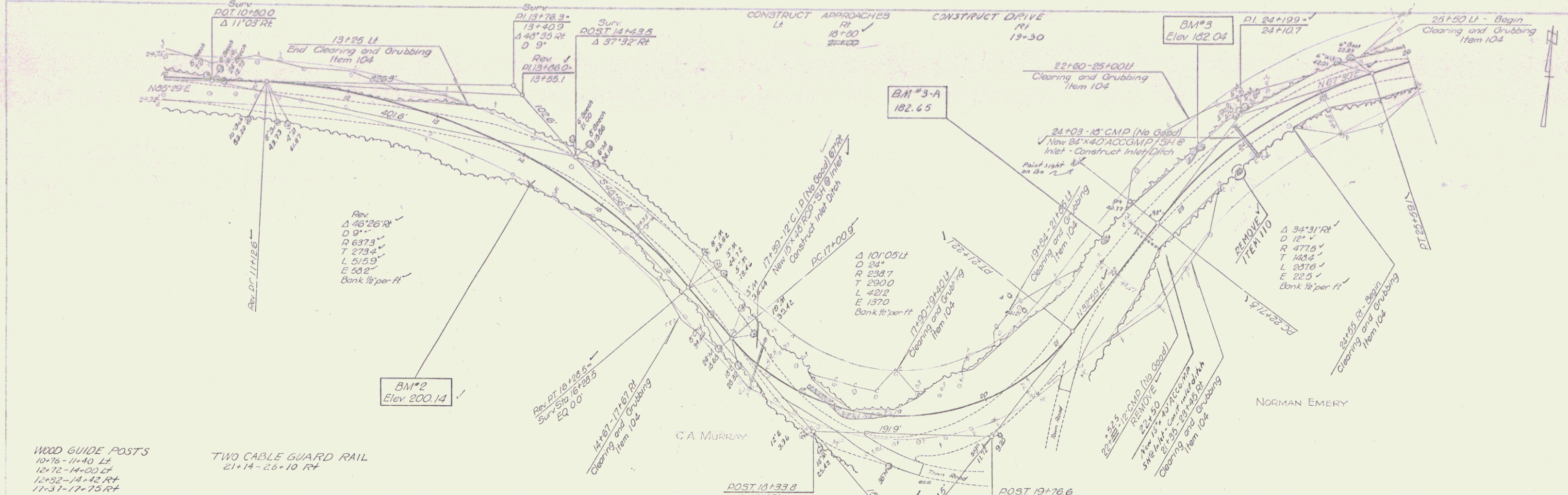

WOOD GUIDE POSTS
10+18-11+40 Lt
12+12-14+00 Lt
12+32-14+42 Rt
17+31-17+75 Rt

TWO CABLE GUARD RAIL
21+14-26+10 Rt

BM#2 Elev 200.14

BM#3 Elev 182.04

BM#3-A Elev 182.65

POST 18+33.8 Δ 47.39 Lt

POST 19+76.6 Δ 53.26 Lt

10+00-26+00
15" Base

BM#2 S.I.R. 15°P-24°F.I.R. Sta 14+22 Elev 200.14

BM#3 Spot on ledge 20 Ft Lt Sta 23+57 Elev 182.04

BM#3-A Spot on Do 28 Ft Lt Sta 22+20 Elev 182.65

WEATHERSFIELD
Project 3 N4 23(4)
Sheet 13 of 31

PLAN
 DATE: 11/23/11
 DRAWN BY: L.A. Hurley
 CHECKED BY: J. D. [unclear]
 PROJECT: WEATHERSFIELD
 SHEET: 16 of 31

