

1/1/88
12/88
C.A. Murray
4 Tr.

1/1/88
6/88
C.A. Murray
4 Tr.

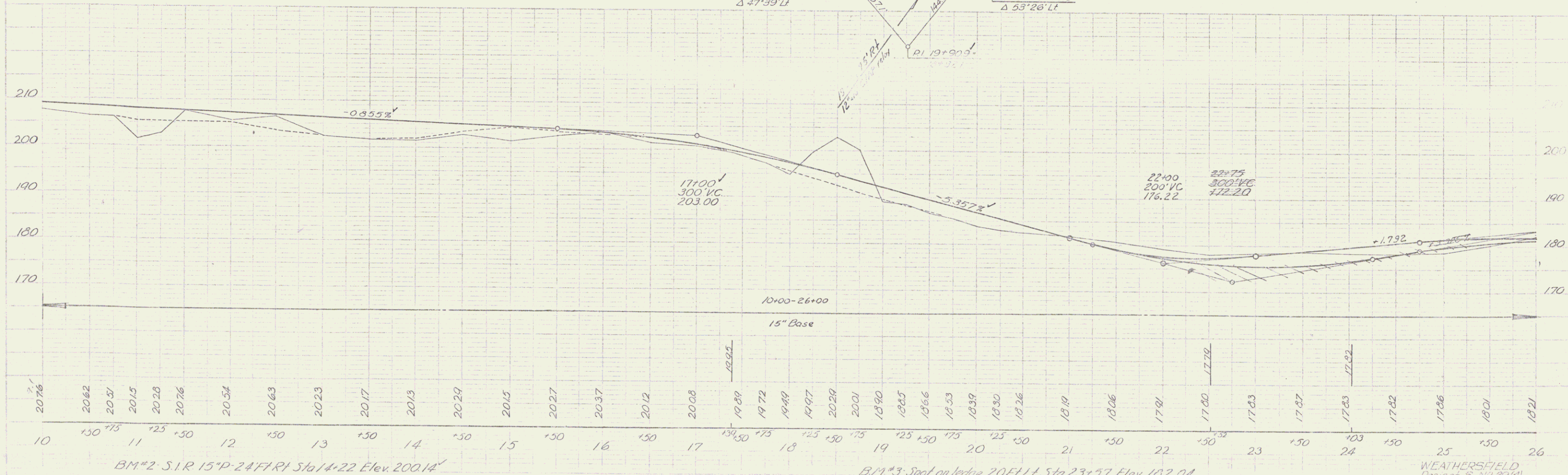
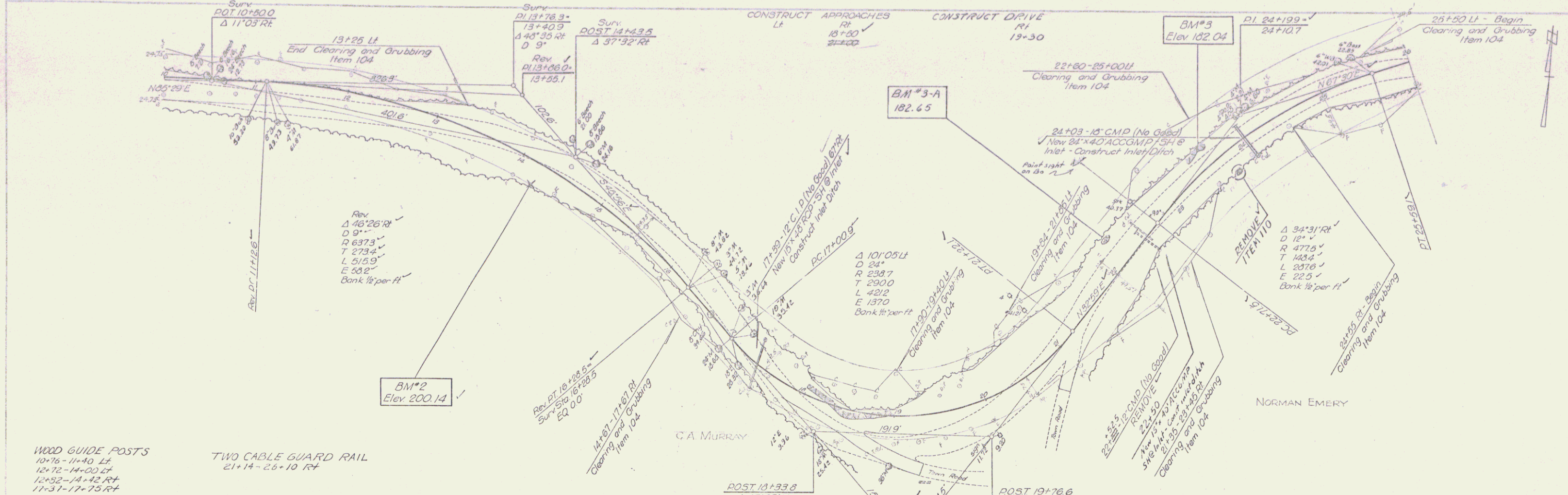

BM#2 S.I.R. 15" P-24 F.I.R. Sta 14+22 Elev 200.14
 BM#3 Spot on ledge 201' Lt Sta 23+57 Elev 182.04
 BM#3-A Spot on Do. 28" Lt Sta 22+20 Elev 182.65

WEATHERSFIELD
Project 3 N4 23(4)
Sheet 13 of 31