

Stone Fill for Slope Protection  
137+90-141+50 RT  
143+50-152+00 RT

Two Cables Guard Rail  
137+35-141+75 RT  
144+38-153+00 RT

Wood Guide Posts  
141+75-144+38 RT

CLEARING & GRUBBING  
STA. 144+00-146+00 RT.

LAVIN WEBSTER-MARTIN INC. 1954  
WEBSTER-MARTIN INC. 1954  
TRACED

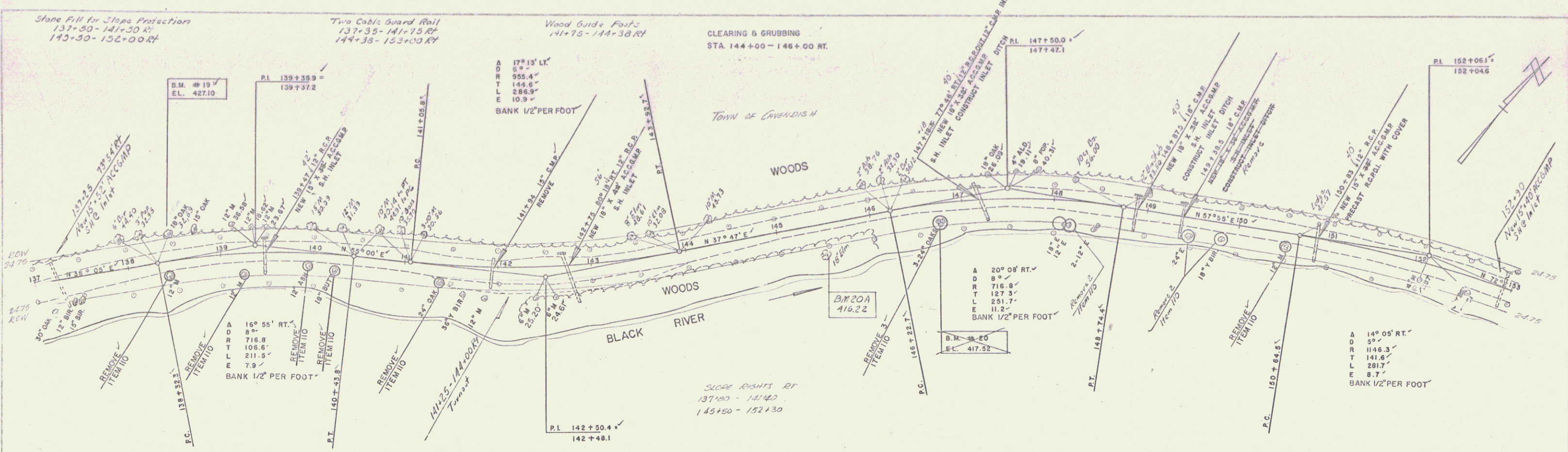

LAVIN WEBSTER-MARTIN INC. 1953  
WEBSTER-MARTIN INC. 1954

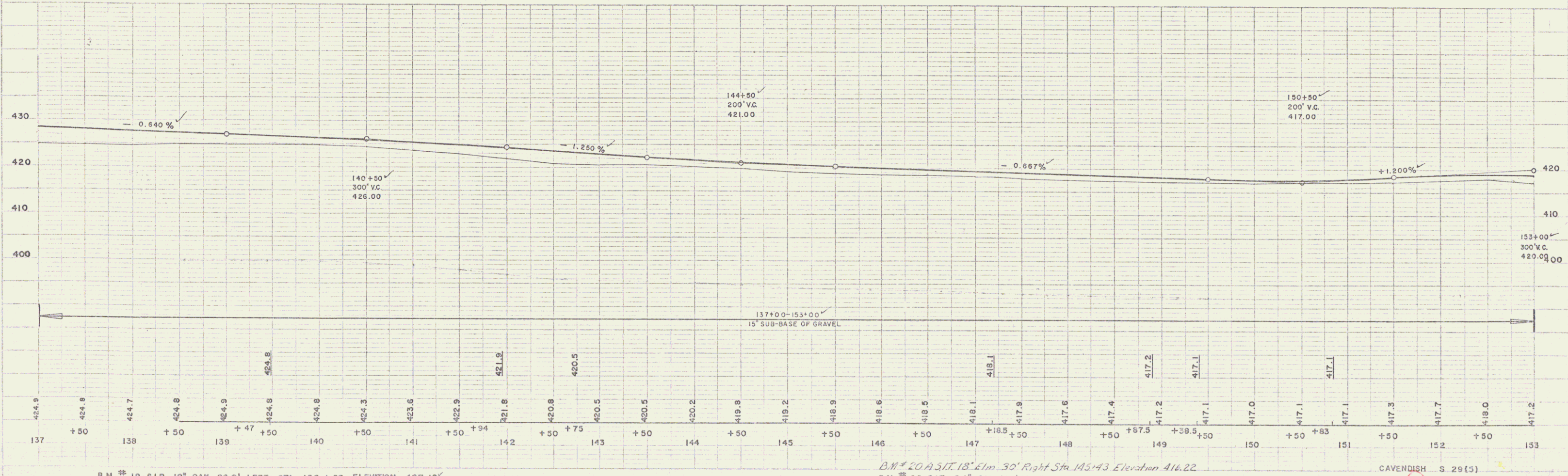

B.M. # 19 S.I.R. 18" OAK 26.0' LEFT STA. 138+50 ELEVATION 427.10'

B.M. # 20 A 3/4" 18" Elm 30' Right Sta. 145+43 Elevation 416.22  
B.M. # 20 S.L.T. 24" OAK 18.5' RIGHT STA. 146+76 ELEVATION 417.52

CAVENDISH S 29(5)  
SHEET 6 OF 43 SHEETS