

INDEX OF SHEETS

SHEET NO. 1	TITLE PAGE
2	TYPICAL CROSS SECTION OF IMPROVEMENT (DOUBLE TACK COAT OF REFINED TAR WITH PEASTONE SEAL, CLASS A ITEM 312-A)
3	BANKING AND WIDENING TABLES
4	QUANTITY SHEET (ITEMS AND DRAINAGE)
5-6	EARTHWORK SHEETS
7-11	PLAN AND PROFILE SHEETS
12	CONSTRUCTION DETAILS - CD (DRAINAGE AND MARKERS)
13	CONSTRUCTION DETAILS - CD (DITCHES)
14	STANDARD STRUCTURE SHEET S-53-48 (PRECAST DROP INLETS)
15	STANDARD STRUCTURE SHEET S-40 (BARRICADES, SIGNS AND LIGHTS)
16	STANDARD STRUCTURE SHEET S-45-45 (GUARD RAIL)
17-43	CROSS SECTIONS

STANDARD STRUCTURE SHEET APPROVED BY THE CHIEF ENGINEER, VERMONT STATE DEPARTMENT OF HIGHWAYS
S-40 JUNE 10, 1950

STATE OF VERMONT
DEPARTMENT OF HIGHWAYS

PROPOSED IMPROVEMENT

FEDERAL AID
SECONDARY PROJECT

TOWN OF CAVENDISH

COUNTY OF WINDSOR

STATE AID ROUTE 1
CAVENDISH-DOWNERS ROAD

Pin# 99R 643

BEGINNING AT POINT 7079.4 FEET
WEST OF THE CAVENDISH-WEATHERS-
FIELD TOWN LINE AND EXTENDING
EASTERLY 7,079.4 FEET.

LENGTH OF PROJECT 7,079.4 FT = 1.341 MI

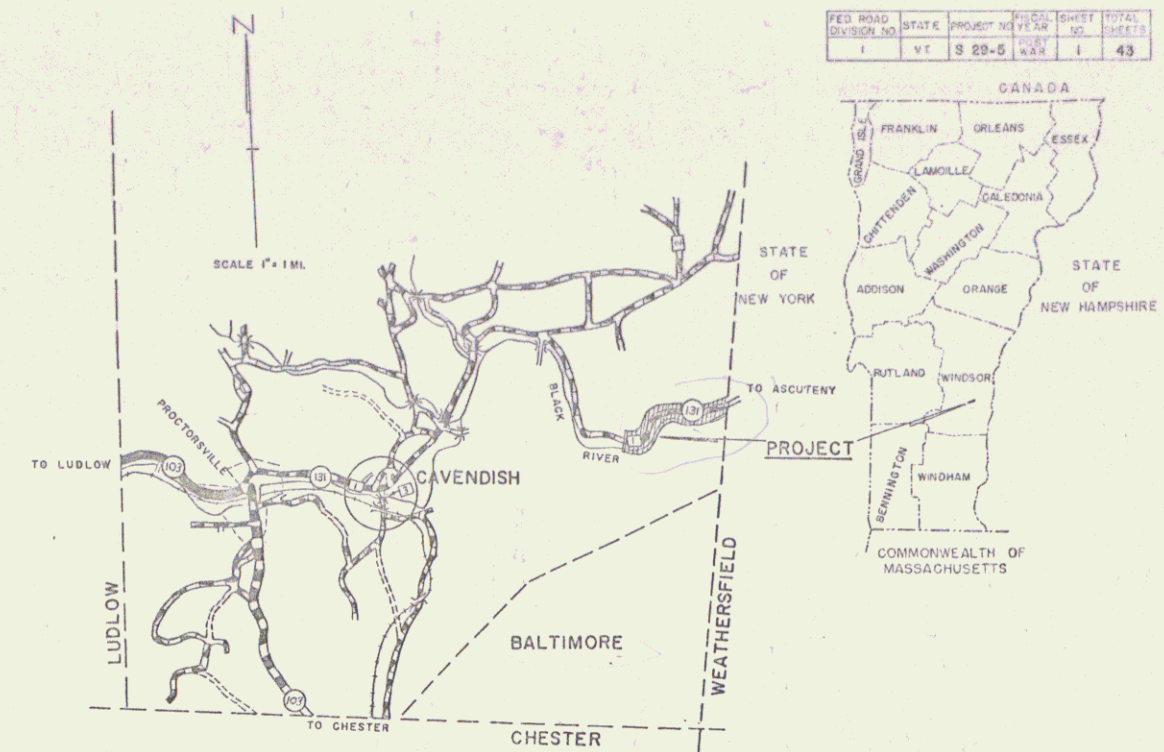

PROJECT NAME & NUMBER	TYPE	PAVEMENT AREA
Cavendish S 29(5)	Double Tack Seal	16,009 SY
RECORD PLANS		
MATERIALS		
SUB-BASE OF GRAVEL	Robinson Ft. Weathersfield	ACCG MP Berger Metal Culvert Co. Westminster
REFINED TAR	Koppers Prod. Co. Everett, Mass	STONE FILL Rock from project
PEASTONE FOR SEAL	Whitcomb Plant, W. Walpole, N.H.	CABLE FOR GUARD RAIL American Steel Wire Co. New Haven, Conn.
CONTRACTOR	Frank W. Whitcomb	CONTRACT DATED August 5, 1955
RESIDENT ENGR	E. H. Latham, D. W. Allen	CONTRACT STARTED August 8, 1955
INSPECTORS		CONTRACT COMPLETED August 22, 1956
RECORD PLANS	A. Abrich	CONTRACT ACCEPTED August 28, 1956

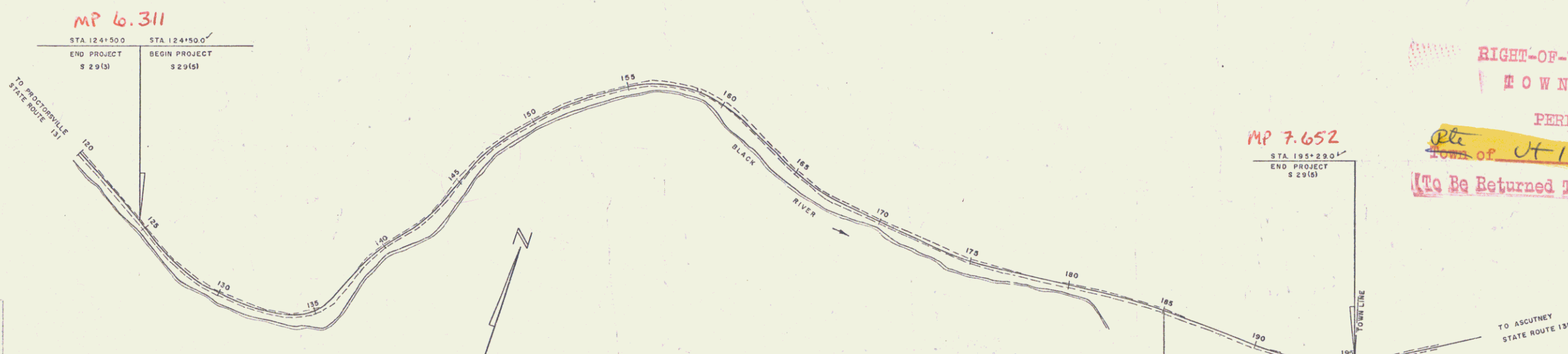

PROJECT: Cavendish
S. 29(5)
TYPE: Dbl. Tack Ref. Tar 7-P. Sln. Seal
CONTRACTOR: Frank W. Whitcomb
YEAR: 1956
LOCATION: Begin 7079.4 ft. west of Cavendish-Weathersfield town line and extend easterly 7,079.4 ft.
CAVENDISH S 29(5)
CONTR. Frank W. Whitcomb
RECORD PLANS - A. Abrich
CONSTRUCTION COMPLETED Aug 22, 1956

GROUND ELEVATION	DATUM	LINE
GRADE ELEVATION	DATUM	LINE

CURVE DATA

DEFLECTION OF ANGLE	Δ
DEGREE OF CURVE	D
RADIUS OF CURVE	R
TANGENT DISTANCE	T
LENGTH OF CURVE	L
EXTERNAL DISTANCE	E
POINT OF INTERSECTION	P.I.
POINT OF CURVE	P.C.
POINT OF TANGENT	P.T.
POINT ON TANGENT	P.O.T.
POINT ON SUB-TANGENT	P.O.S.T.

SCALES

TITLE	1" = 300'
TYPICAL	1" = 2'
PLAN	1" = 50'
PROFILE HORIZONTAL	1" = 10'
PROFILE VERTICAL	1" = 10'
CROSS-SECTIONS	1" = 5'

RIGHT-OF-WAY DIVISION
TOWN FILE
PERPETUAL
Plt. of J-13
(To Be Returned To R.O.W. Division)

NOTE: ANY FURTHER INFORMATION CONCERNING FINAL QUANTITIES, AMOUNTS OR OTHER DETAILS RELATIVE TO THIS PROJECT MAY BE FOUND IN EITHER THE FIELD BOOKS OR THE ESTIMATE FILE.

DEPARTMENT OF COMMERCE
BUREAU OF PUBLIC ROADS

THESE PLANS ARE SUBJECT TO SUCH REVISIONS AS MAY BE REQUIRED BY THE BUREAU OF PUBLIC ROADS OR THE COMMISSIONER OF HIGHWAYS.
CONSTRUCTION IS TO BE CARRIED ON IN ACCORDANCE WITH THE PLANS AND THE STANDARD ROAD AND BRIDGE SPECIFICATIONS OF 1948, AS APPROVED JULY 25, 1949 BY THE BUREAU OF PUBLIC ROADS, INCLUDING ALL SUBSEQUENT APPROVED REVISIONS AND SUCH REVISED SPECIFICATIONS AND SPECIAL PROVISIONS AS ARE SUBMITTED WITH THE PLANS.

APPROVED DATE 16 Feb 1955	APPROVED DATE 16 Feb 1955	APPROVED DATE 16 Feb 1955	APPROVED DATE 16 Feb 1955
------------------------------	------------------------------	------------------------------	------------------------------

APPROVED	DATE
DISTRICT ENGINEER	DATE
PROJECT S NO. 29(5)	
SHEET 1 OF 43 SHEETS	

STEARNS & JENKINS
44131