

INDEX OF SHEETS	
SHEET NO. 1	TITLE PAGE
" 2	TYPICAL CROSS-SECTION OF IMPROVEMENT (DOUBLE TACK COAT OF REFINED TAR WITH SAND & GRAVEL SEAL, ITEM 299)
" 3	BANKING AND WIDENING TABLES
4-9	PLAN AND PROFILE
10	STANDARD STRUCTURE SHEET S-28 PIPE CULVERTS
11	" " " S-30 GUARD RAIL
12	" " " S-30A BOUNDARY MARKERS
13	" " " S-40 BARRICADES, SIGNS & LIGHTS
14	" " " S-41 ROUNDING OF SLOPES
15-34	GROSS SECTIONS

STANDARD STRUCTURE SHEETS APPROVED BY THE CHIEF ENGINEER, VT. STATE DEPT. OF HIGHWAYS

S-28 APRIL 26, 1941
S-30 MAY 12, 1941
S-30A APRIL 19, 1941
S-40 DECEMBER 18, 1945

STATE OF VERMONT
STATE HIGHWAY DEPARTMENT

PLAN AND PROFILE OF PROPOSED
STATE HIGHWAY

SECONDARY PROJECT

TOWN OF CAVENDISH Pin# 99R640

CAVENDISH-ASCUTNEY ROAD

BEGINNING AT THE NORTH END OF CIDER MILL BRIDGE ON ROUTE 131, 1.750 MILES NORTH OF CAVENDISH VILLAGE AND EXTENDING SOUTHEASTERLY 1.505 MILES EXCLUDING BRIDGE.

LENGTH OF PROJECT 7946.6 FEET = 1.505 MILES

FED. ROAD DIST. NO.	STATE	FISCAL YEAR	SHEET NO.	TOTAL SHEETS
9	VT.	2901	2916	34

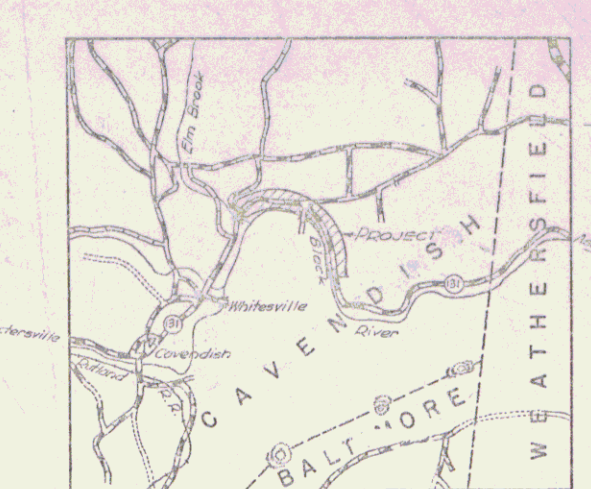

RECORD PLANS

2/22/2000 checked G. Lamm

RIGHT-OF-WAY DIVISION
TOWN FILE
PERPETUAL
Sta. U+131
(To Be Returned To R.O.W. Division)

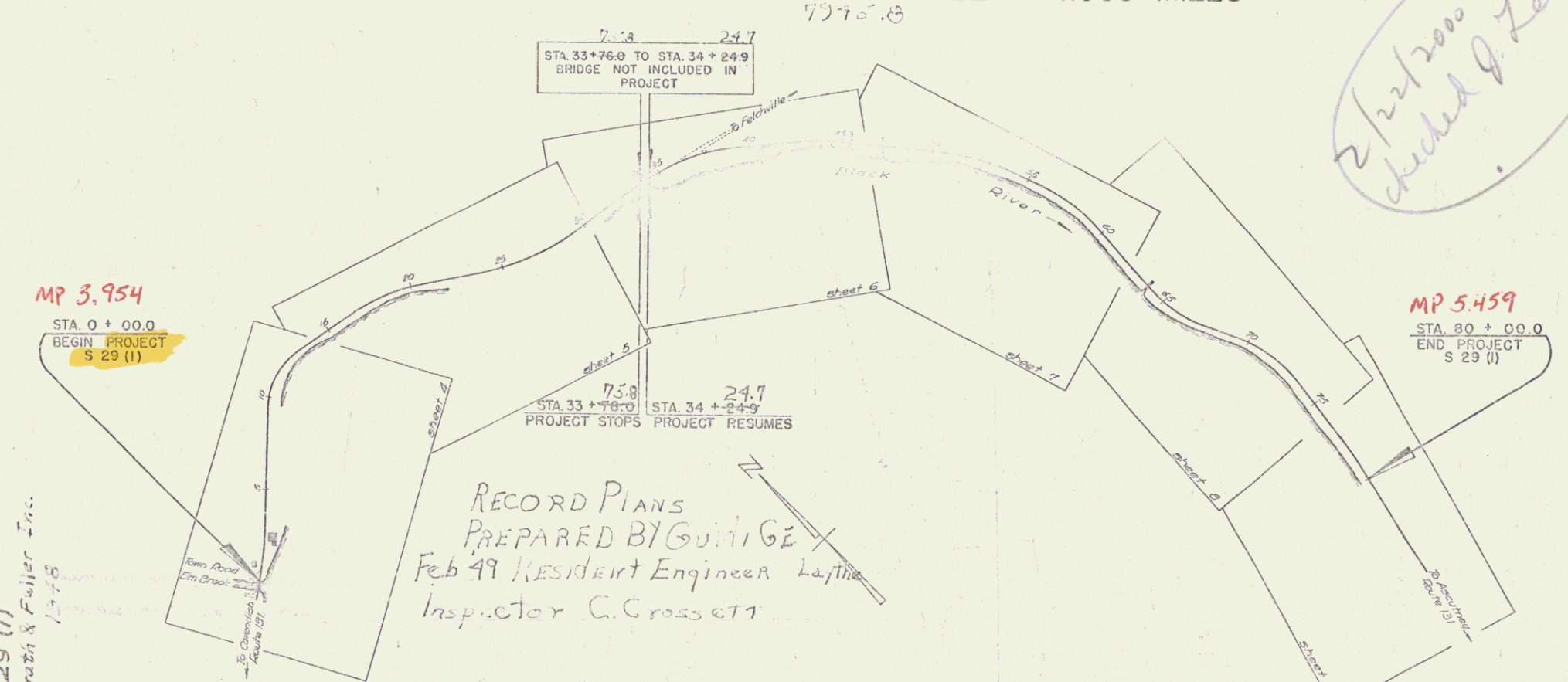

MP 3.954
STA. 0 + 00.0
BEGIN PROJECT
S 29 (1)

MP 5.459
STA. 80 + 00.0
END PROJECT
S 29 (1)

RECORD PLANS
PREPARED BY GUNNIE
Feb 49 Resident Engineer
Inspector C. Cross et al

RECORD PLANS
Cavendish S 29 (1)
Contractor - Drutz & Fowler Inc.

CURVE DATA	
DEFLECTION ANGLE	Δ
DEGREE OF CURVE	D
RADIUS OF CURVE	R
TANGENT DISTANCE	T
LENGTH OF CURVE	L
EXTERNAL DISTANCE	E
POINT OF INTERSECTION	P. I.
POINT OF CURVE	P. C.
POINT OF TANGENCY	P. T.
POINT ON TANGENT	P. O. T.

SCALES	
TYPICAL	1" = 400'
PLAN	1" = 200'
PROFILE HORIZONTAL	1" = 50'
PROFILE VERTICAL	1" = 10'
CROSS SECTIONS	1" = 5'

GROUND ELEVATION DATUM LINE
GRADE ELEVATION DATUM LINE

THESE PLANS ARE SUBJECT TO SUCH REVISIONS AS MAY BE REQUIRED BY THE PUBLIC ROADS ADMINISTRATION OR THE COMMISSIONER OF HIGHWAYS.
CONSTRUCTION IS TO BE CARRIED ON IN ACCORDANCE WITH THE PLANS AND THE STANDARD ROAD AND BRIDGE SPECIFICATIONS OF 1937, AS APPROVED DECEMBER 28TH, 1935 BY THE PUBLIC ROADS ADMINISTRATION, INCLUDING ALL SUBSEQUENT APPROVED REVISIONS AND SUCH REVISED SPECIFICATIONS AND SPECIAL PROVISIONS AS ARE SUBMITTED WITH THE PLANS.

APPROVED: *April 14, 1947*
Thos. August
COMMISSIONER OF HIGHWAYS
SUBMITTED BY ORDER OF THE STATE HIGHWAY BOARD

RECOMMENDED FOR APPROVAL
PUBLIC ROADS ADMINISTRATION
FEDERAL WORKS AGENCY
APPROVED
PUBLIC ROADS ADMINISTRATION
FEDERAL WORKS AGENCY

APPROVED *April 14, 1947*
HIGHWAY ENGINEER
APPROVED *April 24, 1947*
DISTRICT HIGHWAY COMMISSIONER
SERIES 5, No. 29(1) FILED
SHEET 1 OF 34

STEARNS R. JENKINS

U+131