

INDEX OF SHEETS

NOTE - WATERMAIN IN ROAD  
Exact Location & Depth to be  
Determined in The Field.

STONE FILL  
38+17-41+00 RT  
37+30-38+00 RT

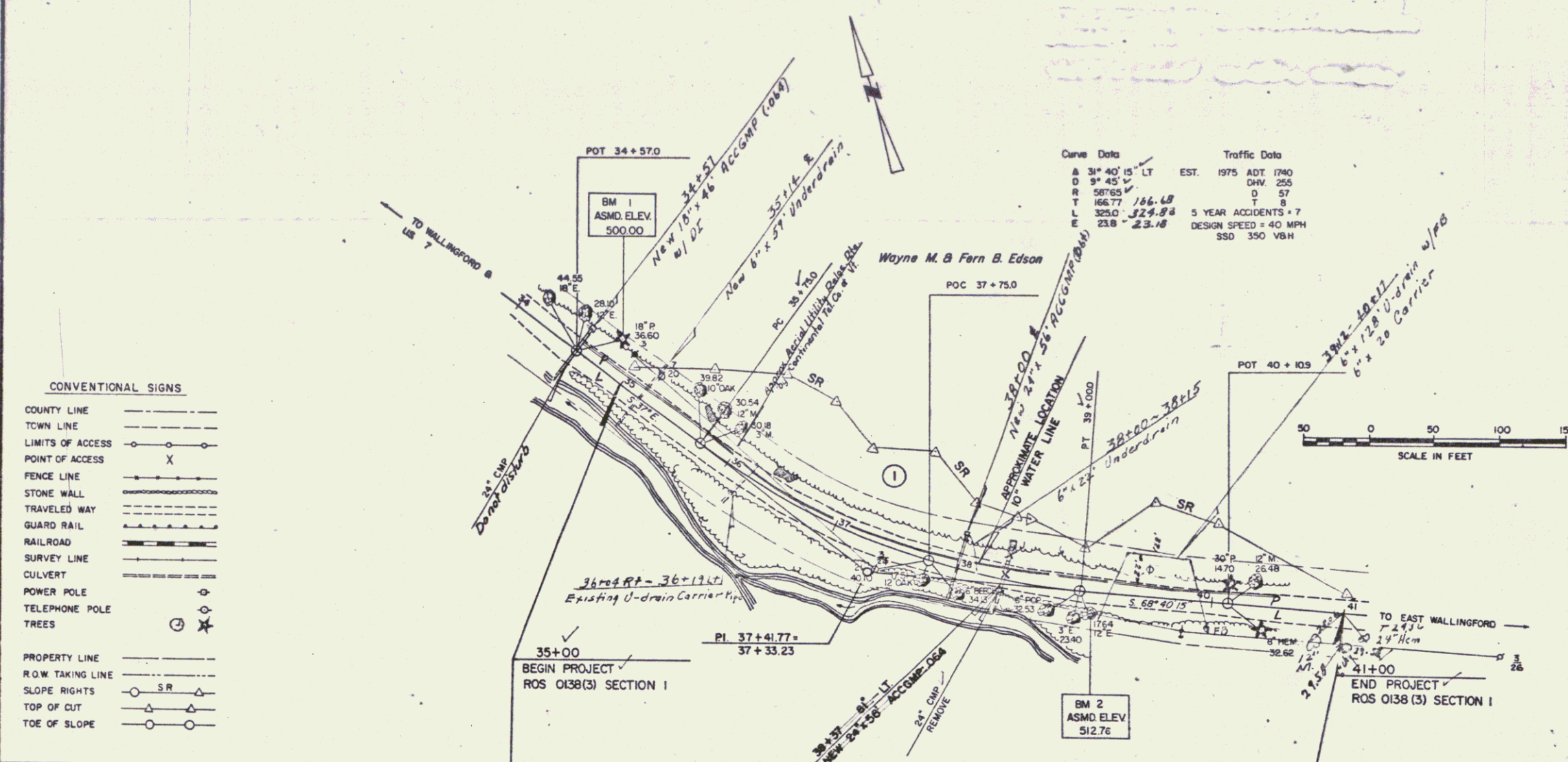

CONVENTIONAL SIGNS

- COUNTY LINE
- TOWN LINE
- LIMITS OF ACCESS
- POINT OF ACCESS
- FENCE LINE
- STONE WALL
- TRAVELED WAY
- GUARD RAIL
- RAILROAD
- SURVEY LINE
- CULVERT
- POWER POLE
- TELEPHONE POLE
- TREES
- PROPERTY LINE
- R.O.W. TAKING LINE
- SLOPE RIGHTS
- TOP OF CUT
- TOE OF SLOPE

Curve Data

A	3° 40' 15" LT	EST.	1975	ADT	1760
D	37' 45"	CHW	255		
R	58765	D	57		
T	16677	5 YEAR ACCIDENTS	7		
L	305.0	DESIGN SPEED	40 MPH		
E	23.8	SSD	350 VBH		

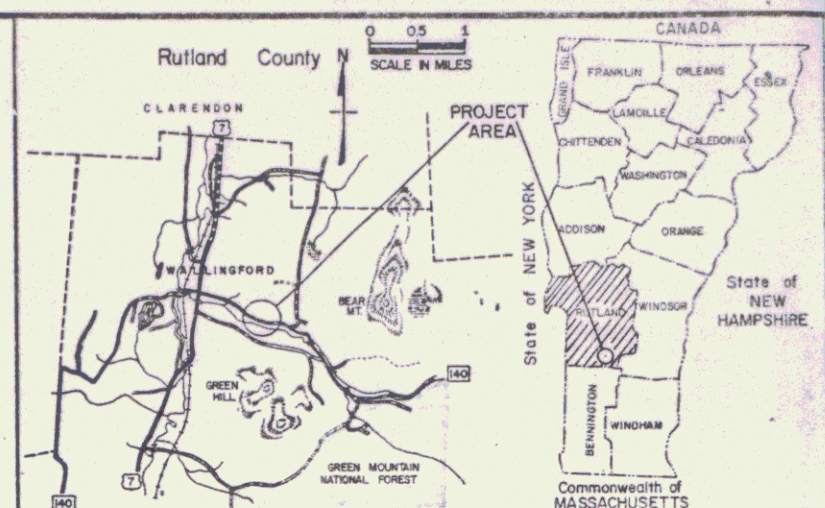
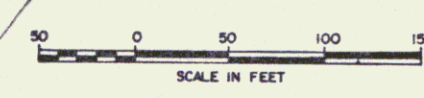

ITEM NO	ITEM	UNIT	ORIGINAL	ROUND	TOTAL	FINAL
201.10	CLEARING & GRUBBING, PLUS IND. TREES	LS	1/3		1/3	
203.15	COMMON EXCAVATION	CY	3382	18	3400	
631.10	FIELD OFFICE - ENGINEERS	CS	1/8		1/8	
204.20	TRENCH EXCAVATION OF EARTH	CY	48	2	50	
204.21	TRENCH EXCAVATION OF ROCK	CY	3	2	5	
301.25	SUBBASE OF CRUSHED GRAVEL (Coarse Graded)	CY	332	18	350	
404.40	BITUMINOUS SURFACE TREATMENT Type 32	CWT	12		12	
406.25	BITUMINOUS CONCRETE PAVEMENT	TON	33.3	0.7	34	
601.572	24" ASPH. CTD. CORR. GAL. MET. PIPE (064)	LF	56		56	
501.25	CONCRETE Class B	CY	2.6	0.4	3	
607.10	ROADWAY PATROL MAINTENANCE	HR	20		20	
609.10	DUST CONTROL W/ WATER Est.	M/GAL	80		80	
502.15	REINFORCING STEEL	LB	251		251	
651.10	SEED	LB	40		40	
651.15	FERTILIZER	TON	300		300	
622.10	Insulation Board	M <sup>2</sup>	0.25		0.25	
651.25	HAY MULCH	TON	1.5		1.5	
604.40	Coat Iron Grate - Type B	Sq	1		1	

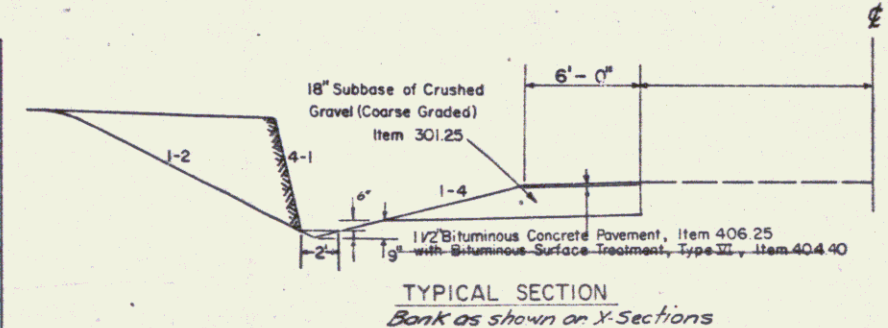
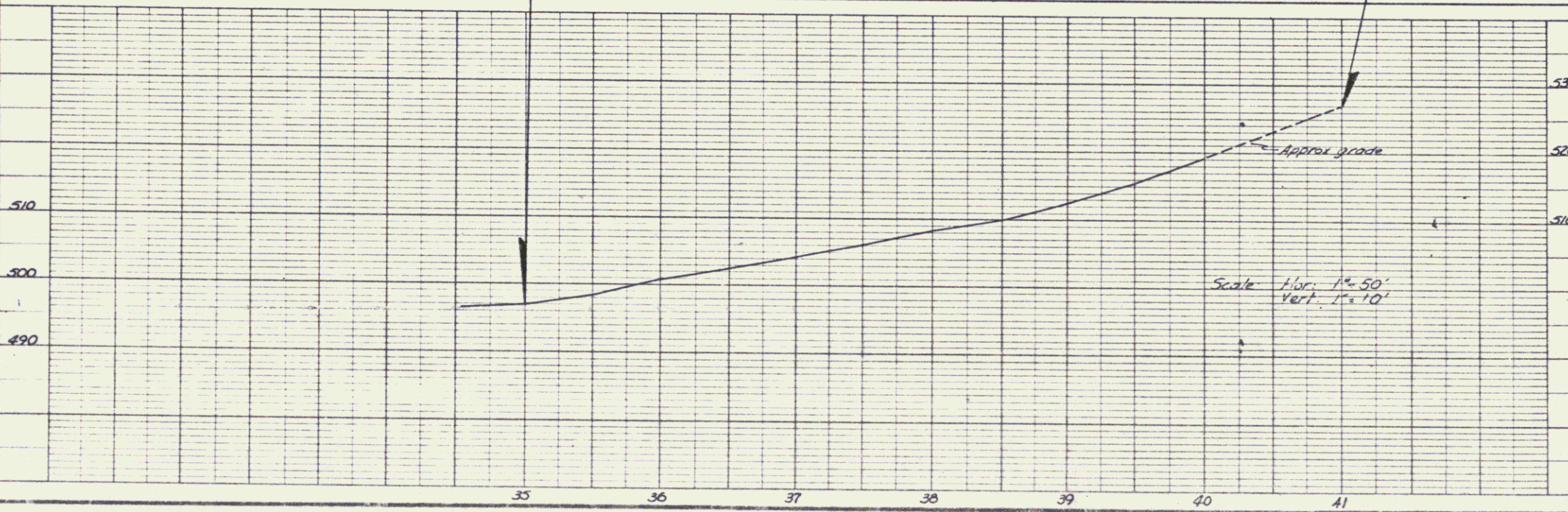

R.O.W. SHEET 3 of 5 SECTION 1

STATE OF VERMONT  
DEPARTMENT OF HIGHWAYS

APPROVED: *[Signature]* DATE: 8-19-75  
TOWN OF WALLINGFORD RTE. NO. 140

SUBMITTED BY ORDER OF THE STATE HIGHWAY BOARD  
BRIDGE NO. \_\_\_\_\_  
LOG STA. 35+00 - 41+00  
SURV. STA. \_\_\_\_\_

APPROVED: \_\_\_\_\_ DATE: \_\_\_\_\_  
DESIGNED BY: \_\_\_\_\_ DATE: 3/75  
DRAWN BY: SHANGRAW  
CHECKED BY: \_\_\_\_\_ DATE: \_\_\_\_\_

APPROVED: \_\_\_\_\_ DATE: \_\_\_\_\_  
DESIGN SUPERVISOR: \_\_\_\_\_  
DIVISION ENGINEER: \_\_\_\_\_

PROJECT ROS PROJ. NO. 0138(3)

SHEET 3 of 3