

POOR ORIGINAL COPY

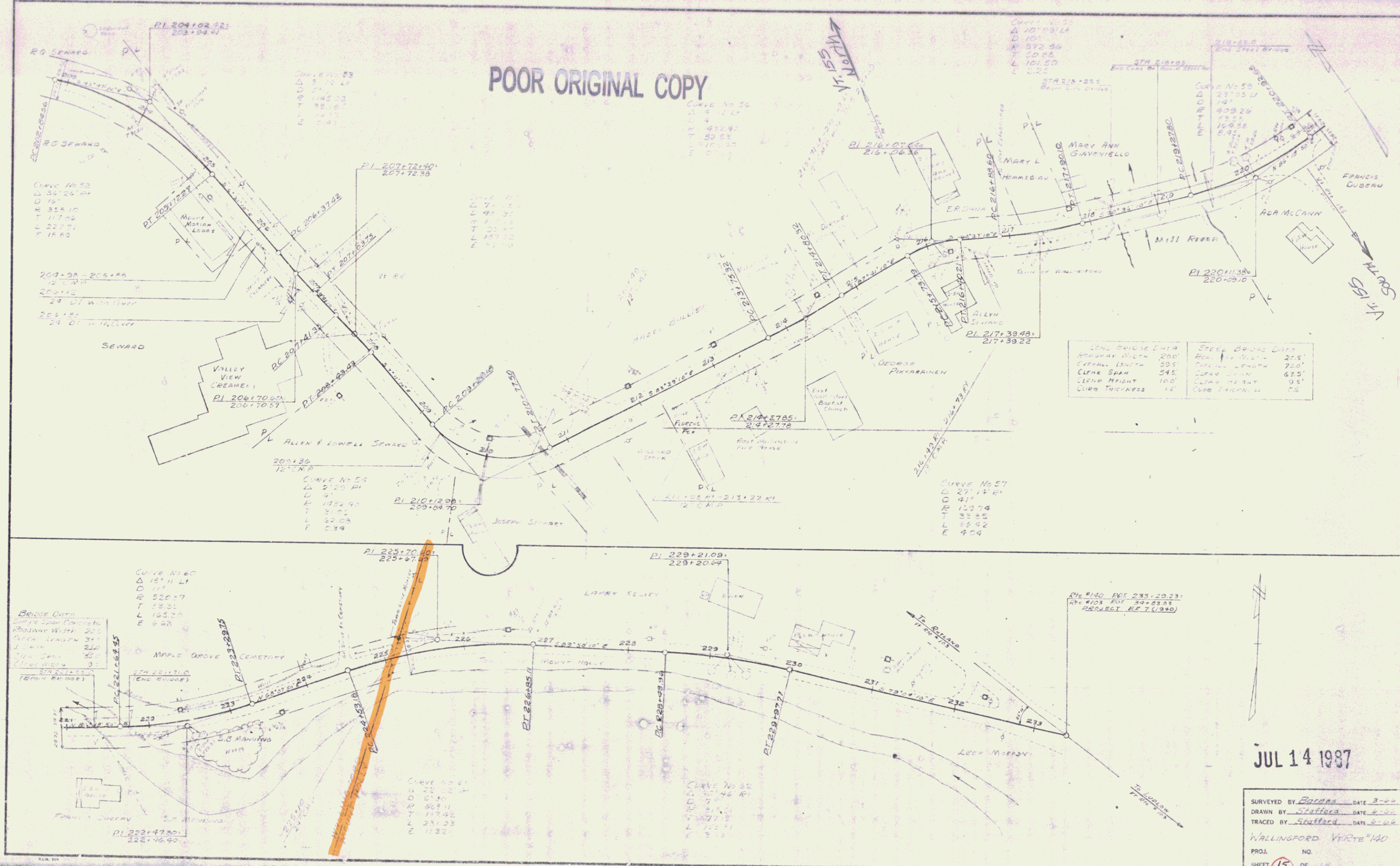

CURVE NO. 53
 Δ 10° 03' 14"
 D 100'
 R 572.96'
 T 50.05'
 L 101.50'
 E 2.22'

CURVE NO. 54
 Δ 12° 11' 11"
 D 111'
 R 520.07'
 T 55.31'
 L 105.25'
 E 0.62'

CURVE NO. 54
 Δ 2° 20' 01"
 D 41'
 R 1352.40'
 T 31.03'
 L 52.08'
 E 0.39'

CURVE NO. 55
 Δ 10° 03' 14"
 D 100'
 R 572.96'
 T 50.05'
 L 101.50'
 E 2.22'

CURVE NO. 57
 Δ 27° 14' 11"
 D 41'
 R 100.74'
 T 35.85'
 L 35.42'
 E 9.04'

BRIDGE DATA
 CURVE SPAN CONCRETE
 ROUTING WIDTH 20'
 OVER LENGTH 30'
 J. SPAN 20'
 CLEARANCE 3'
 CLEARANCE 3'

CONC. BRIDGE DATA	STEEL BRIDGE DATA
SPAN LENGTH 200'	SPAN LENGTH 200'
OVERALL LENGTH 305'	OVERALL LENGTH 220'
CLEAR SPAN 545'	CLEAR SPAN 435'
CLEAR HEIGHT 100'	CLEAR HEIGHT 95'
CURB THICKNESS 15"	CURB THICKNESS 15"

JUL 14 1987

SURVEYED BY Boards DATE 3-80
 DRAWN BY Stafford DATE 4-80
 TRACED BY Stafford DATE 6-80
 WALLINGFORD V.I.R.T.E. #140
 PROJ. NO. _____
 SHEET 15 OF 15

15