

CONSTRUCT DRIVES

LA	RA
25178	25165
26163	26100
28107	27150
28107	27150
29100	28165
29102	28188
31100	29132
31134	30132
30175	30155

TWO CABLE GUARD RAIL
ITEM 54R

LA 24145 to Bridge
RA 24180 to Bridge

LA 25131
RA 25131

CONSTRUCT APPROACHES

LA 26125-27140
RA 23140 - TO RR AD.
TO RAILROAD ST

LA 24100-24130
RA TO FLORENCE ST

SL 21251 18' COMP
RETAIN

SL 21301 35'x35' RCBM STAR
RETAIN

STA 22+50.0
BEGIN PROJECT S.O. 138(1) S.A.
CONSTRUCT SATISFACTORY APPROACH
TO BRIDGE AT STA. 21+27

M.L. PI 26+50.16
Curve No. 3
26+74.15
191.0
37.50
APPROACH LINE
STA. 0+00.0
L 25°26'14"

26+27.58 - UNDER 30'x14' RI
New 24" x 140' ACC SMP BR
Outlet from R.C.D.I. at 26+27.58
And into River at 25+35.58' L.

Curve No. 1
27+00.0
174.592
38.39
L 116.67
L 116.67
Do Not Bank

M.L. POST 24+02.46
SL 5100.0 RR
L 84°52'44"

M.L. PI 24+64.71
24+59.64

APPROACH LINE
STA 0+00.0
L 30°57'34"

STA 32+145
STOP ROADWAY AT
ROUTE U.S. 7

STA 32+156
RESUME ROADWAY

Const. Note: Care shall be taken so
as not to disturb the
existing Drainage System, Water
System, and Sewer System

NOTE: FOR GRANITE CURB - ITEM 556-B, DETAILS
& BURNISHED CONCRETE SIDEWALK - ITEM 562
SEE SHEET 4 of 61 (Item Detail & Drainage Sheet)

PLANT 34 UNITS & JAPANESE BARBED
(BERBERIS THUNBERGII) ITEM 631(A)
Sta. 33+00.0 LA to Sta. 34+00.0 LA, AS
DIRECTED BY THE ENGINEER

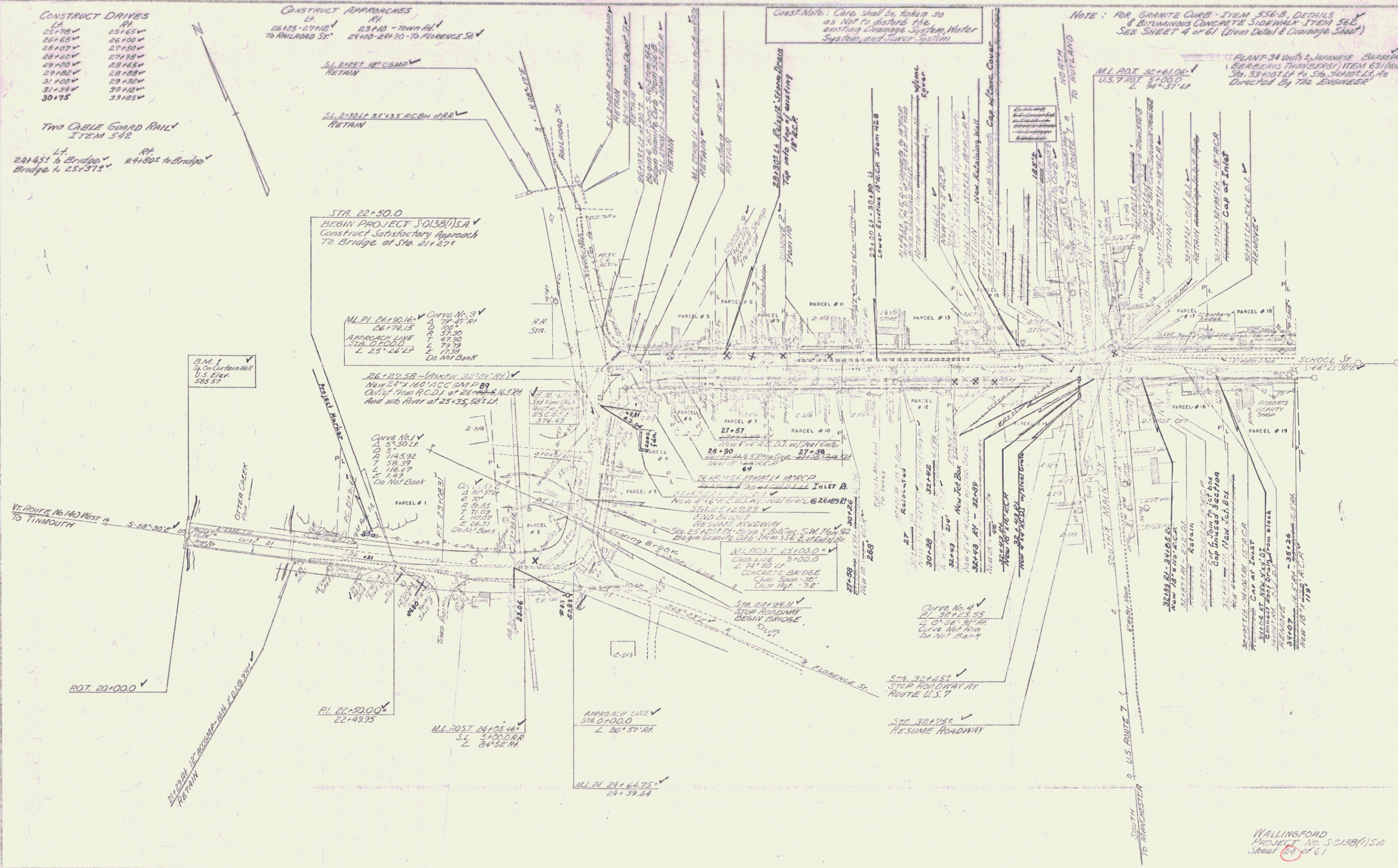

WALLINGFORD
PROJECT NO. S.O. 138(1) S.A.
Sheet 2 of 61