

Sta.	Dist.	LT	RT
104+14.6	104+32	5	7
105+20			
110+15	15	18	2
Sta.	Sta.	Dist.	Dist.
102+0	105+12	212	

SCALE: 1" = 40' HORIZ. 1" = 10' VERT. TOTAL SHEETS: 54 SHEET NO. 11

ADVISOR: A.W. Hammond 5/1/33

ADVISOR: A.W. Hammond 5/1/33

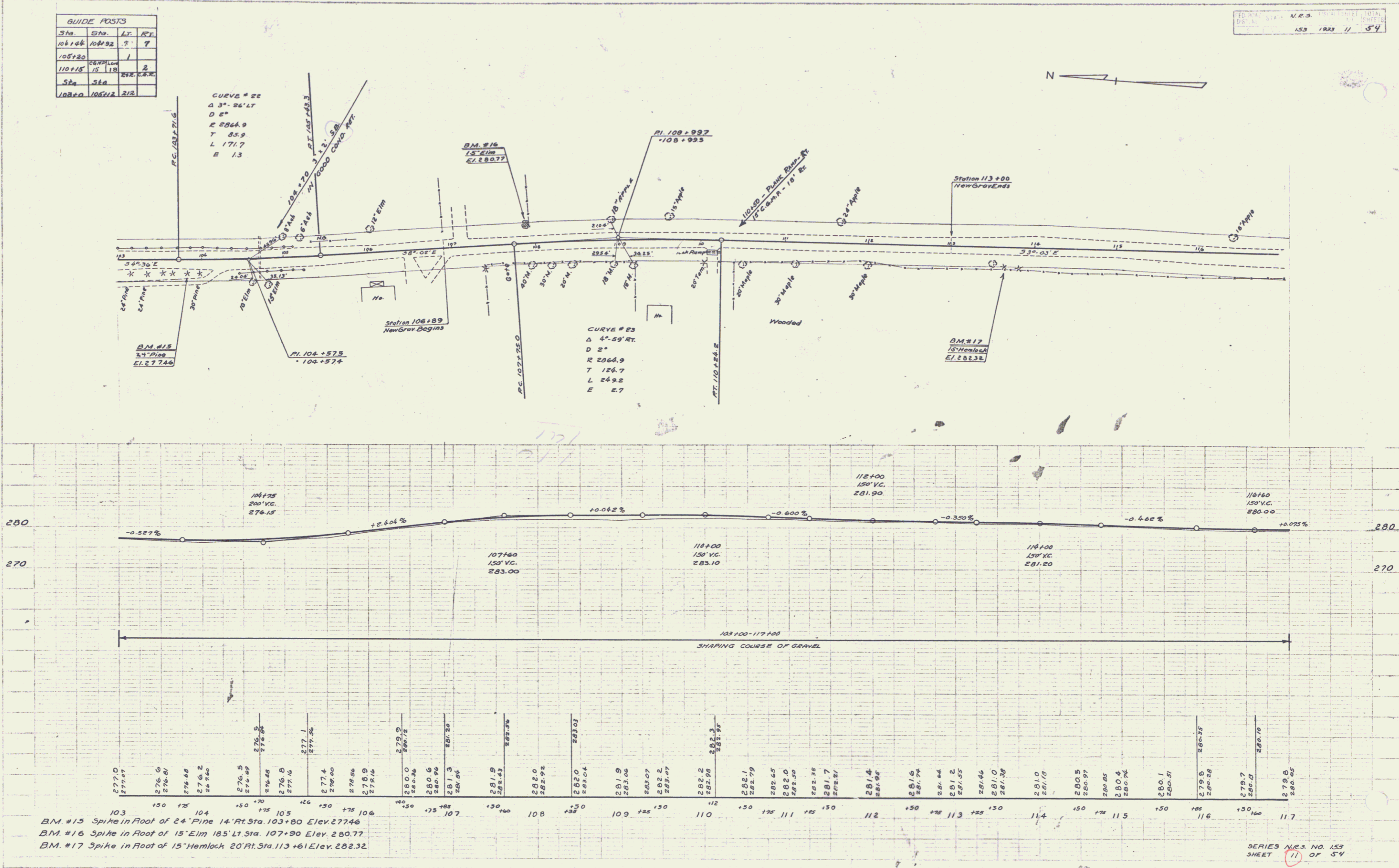

BM #15 Spike in Root of 24" Pine 14' Rt. Sta. 103+80 Elev. 277.46  
 BM #16 Spike in Root of 15" Elm 185' Lt. Sta. 107+90 Elev. 280.77  
 BM #17 Spike in Root of 15" Hemlock 20' Rt. Sta. 113+61 Elev. 282.32

SERIES N.E.S. NO. 153 SHEET 11 OF 54