

STA 1+60.0
BEGIN PROJECT
S08 (1)
TO HARDWICK
VT ROUTE 14

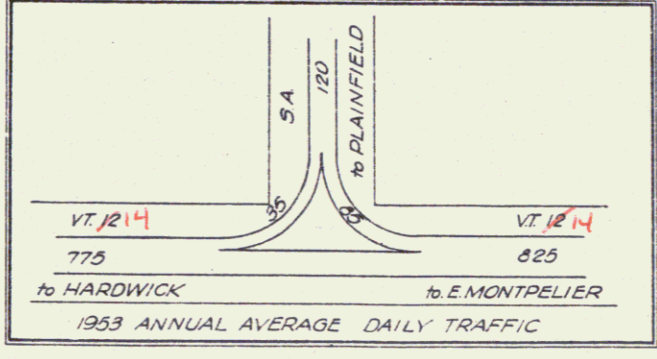

EAST MONTPELIER
MARSHFIELD - PLAINFIELD
SURVEYED BY LAVIN 4/53
PLOTTED BY JR. 5/53
TRACED BY JR. 5/53
PROJECT S No. 88 (1)
SHEET 9 OF 23

PLAN
 DATE: 10/1/00
 DRAWN BY: JAB
 CHECKED BY: JAB
 SCALE: AS SHOWN
 SHEET NO: 12 OF 35

PROFILE
 DATE: 10/1/00
 DRAWN BY: JAB
 CHECKED BY: JAB
 SCALE: AS SHOWN
 SHEET NO: 12 OF 35

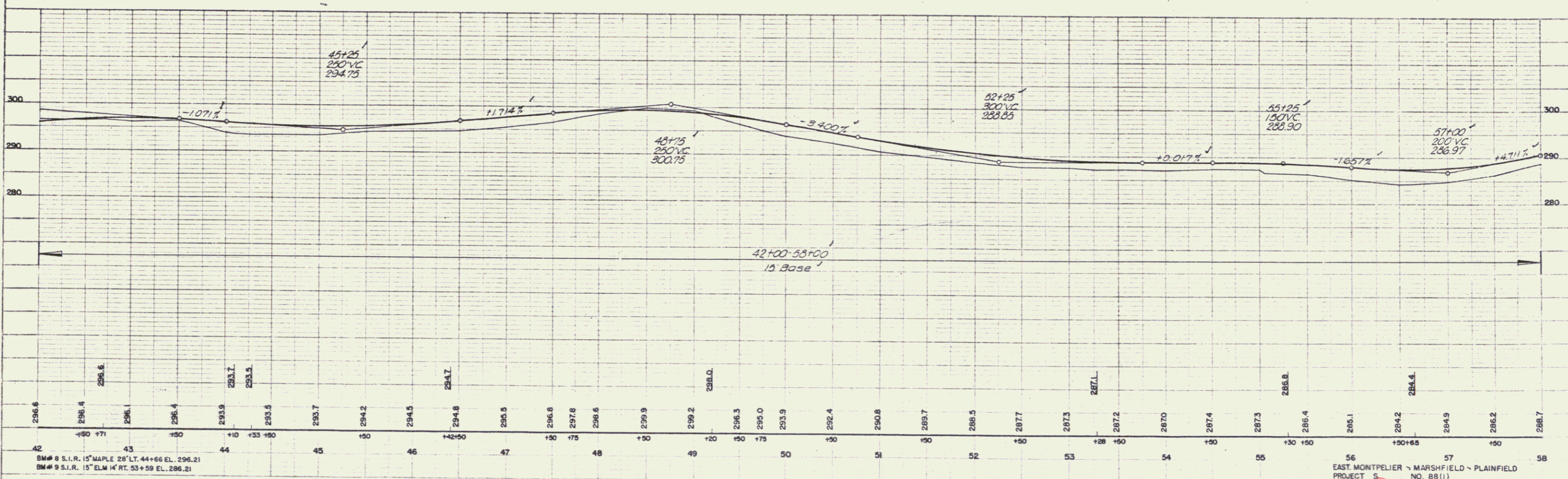
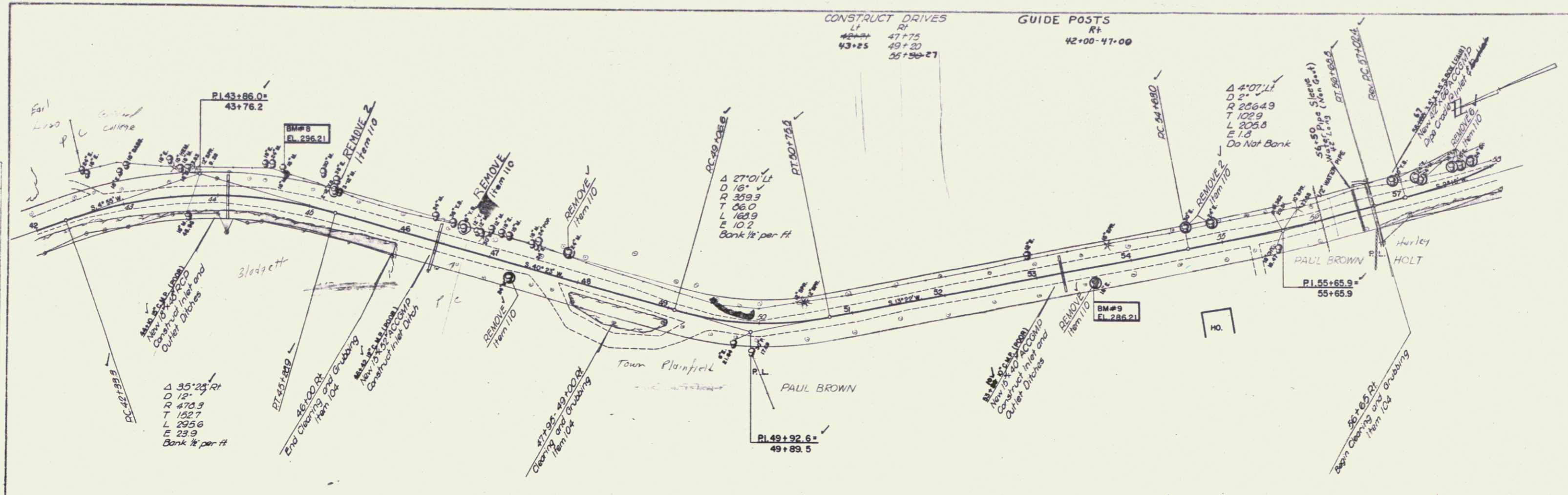

BM# 8 S.I.R. 15" MAPLE 28" LT. 44+66 EL. 296.21
 BM# 9 S.I.R. 15" ELM 14" RT. 53+59 EL. 286.21

EAST MONTPELIER - MARSHFIELD - PLAINFIELD
 PROJECT NO. 88(1)
 SHEET 12 OF 35

5

PLAN	DATE	BY
NO.	DATE	NO.
NO.	DATE	NO.
NO.	DATE	NO.

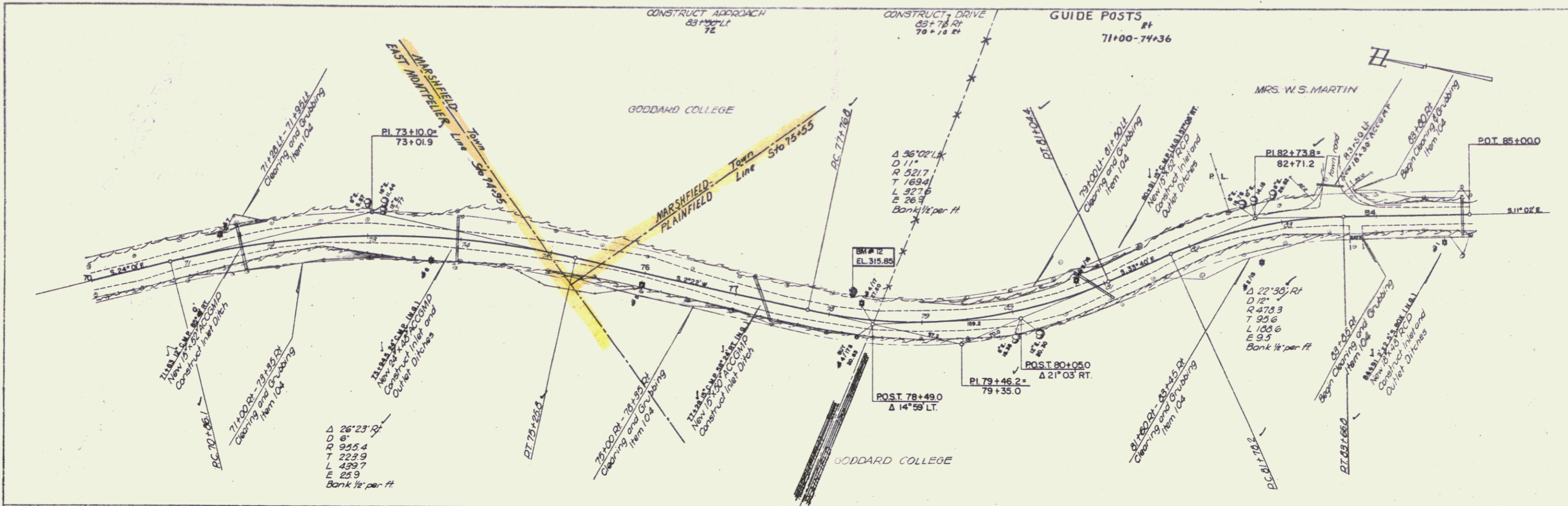

PROFILE	DATE	BY
NO.	DATE	NO.
NO.	DATE	NO.
NO.	DATE	NO.

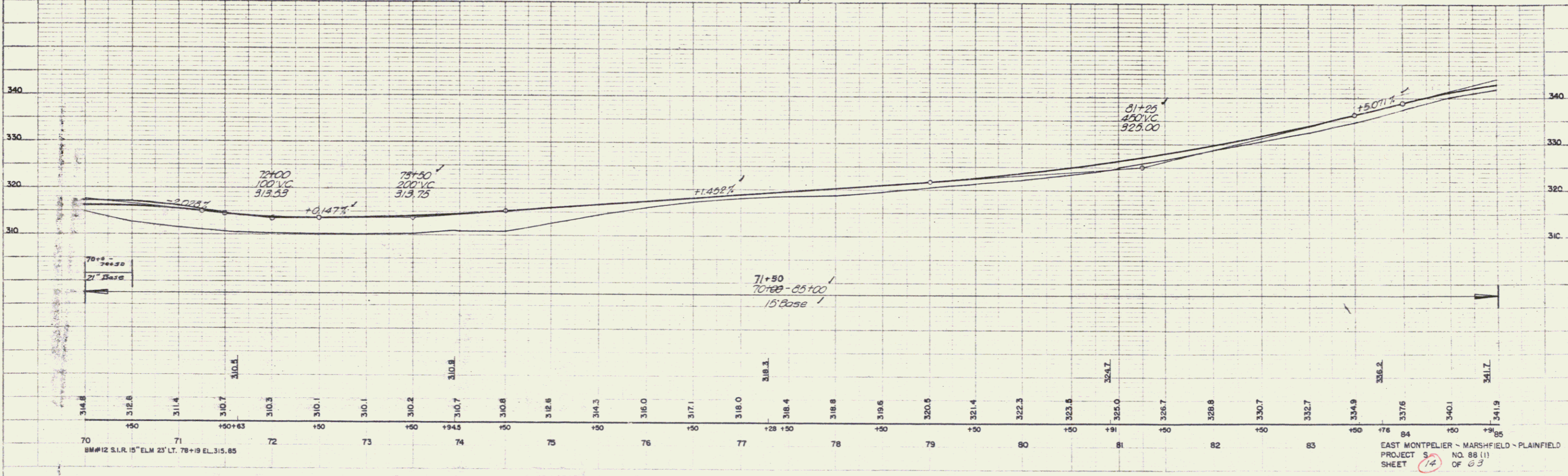

EAST MONTPELIER - MARSHFIELD - PLAINFIELD
 PROJECT 5
 SHEET 14 OF 63

PLAN	DATE	BY
REVISED		
DATE		
BY		
REVISIONS		
NO.	DATE	BY
1		

PROFILE	DATE	BY
REVISED		
DATE		
BY		
REVISIONS		
NO.	DATE	BY
1		

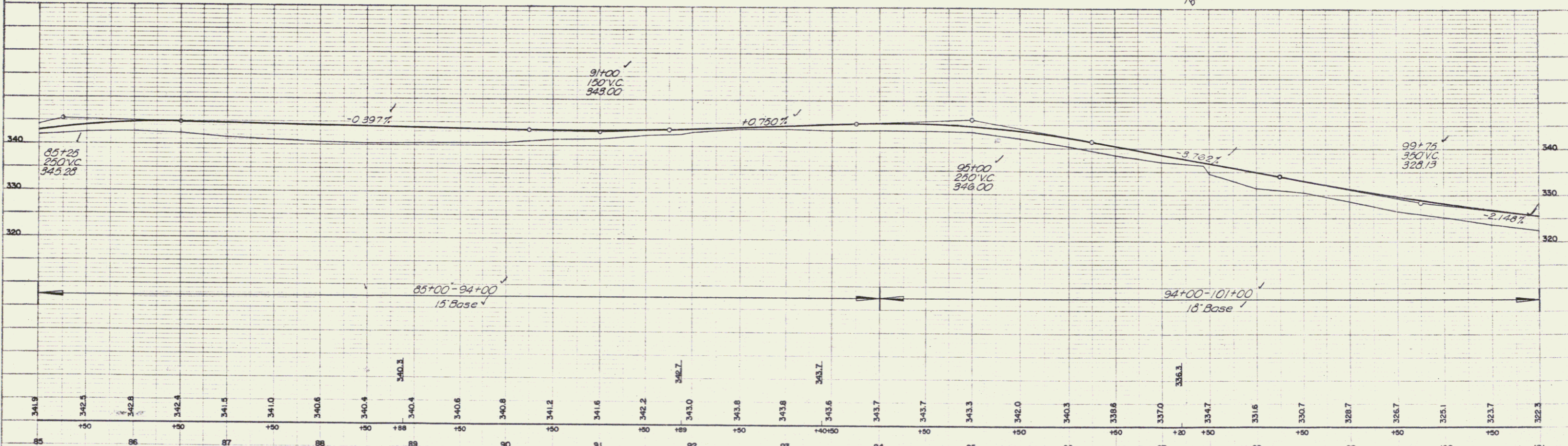
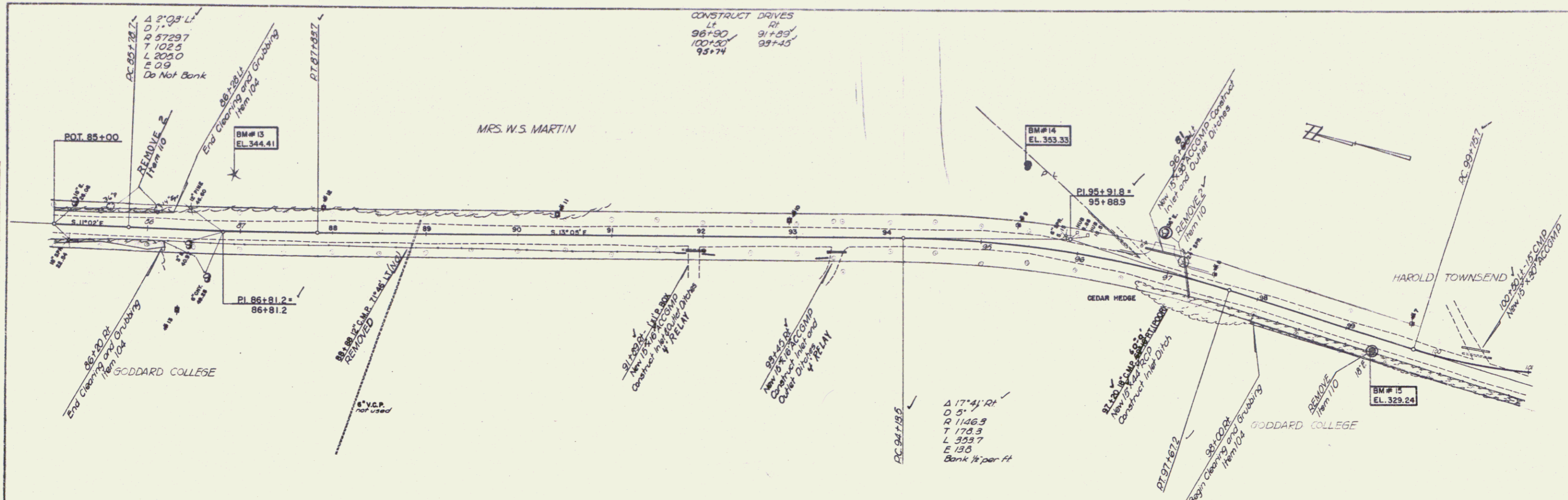

BM# 13 S.I.T. 12" PINE 62' LT. 86+90 EL. 344.41
 BM# 14 S.I.R. 24" ELM. 83' LT. 95+37 EL. 353.33
 BM# 15 S.I.T. 18" ELM. 13' RT. 99+31 EL. 329.24

8

