

INDEX OF SHEETS

STATE OF VERMONT AGENCY OF TRANSPORTATION

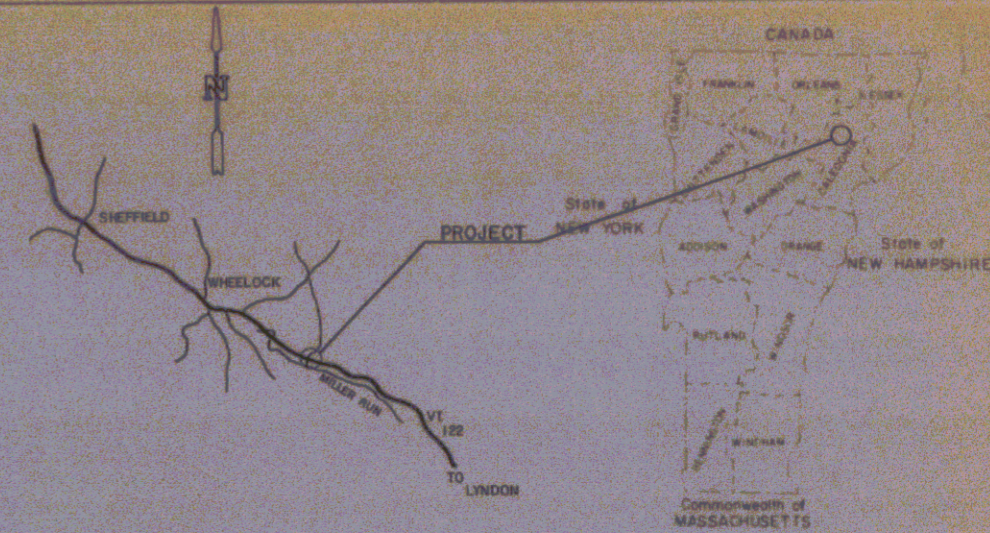

PROPOSED IMPROVEMENT TOWN OF WHEELLOCK COUNTY OF CALEDONIA



R.O.W. PLANS

LENGTH OF R.O.W. PROJECT 25000 FEET

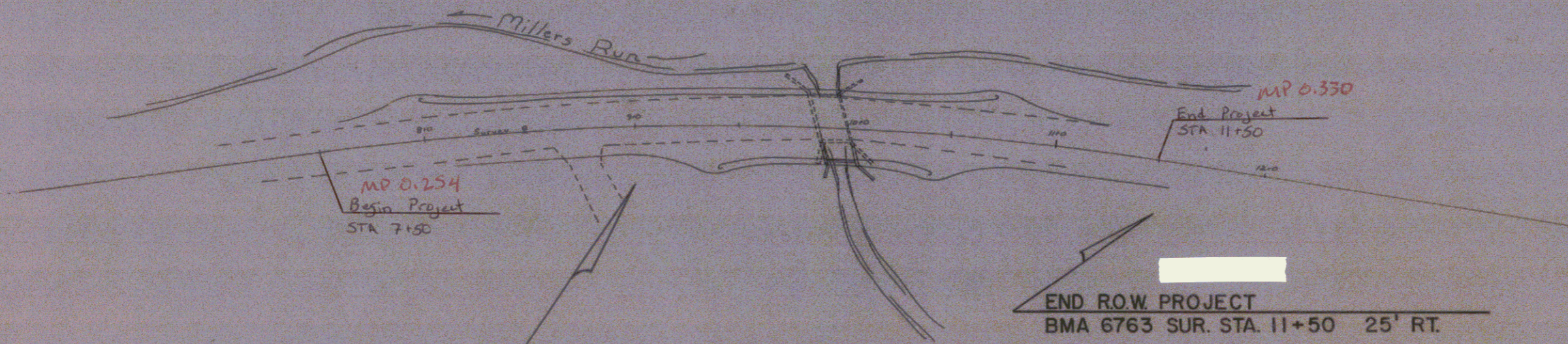

CONVENTIONAL SIGNS

COUNTY LINE	---
TOWN LINE	---
LIMITS OF ACCESS	---
POINT OF ACCESS	X
FENCE LINE	---
STONE WALL	---
TRAVELED WP	---
GUARD RAIL	---
RAILROAD	---
SURVEY LINE	---
CULVERT	---
POWER POLE	○
TELEPHONE POLE	○
TREES	○
CONTROL OF ACCESS	---
PROPERTY LINE	---
R.O.W. TAKING LINE	---
SLOPE RIGHTS	○
TOP OF CUT	○
TOE OF SLOPE	○

BEGIN R.O.W. PROJECT
BMA 6763 SUR. STA. 9+00 24' RT.

SCALE 1" = 30'

END R.O.W. PROJECT
BMA 6763 SUR. STA. 11+50 25' RT.

THESE PLANS ARE SUBJECT TO SUCH ENGINEERING CHANGES AS MAY BE REQUIRED BY THE FEDERAL HIGHWAY ADMINISTRATION OR THE CHIEF ENGINEER. CONSTRUCTION IS TO BE CARRIED ON IN ACCORDANCE WITH THESE PLANS AND THE STANDARD SPECIFICATIONS FOR CONSTRUCTION DATED 1986. FOR USE ON THESE PROJECTS, INCLUDING ALL SUBSEQUENT PROVISIONS AS ARE INDICATED IN THESE PLANS.

APPROVED: *[Signature]* DATE: 2/20/87
Acting Dir., Dept. of Planning & Preconstruction

APPROVED: *[Signature]* DATE: 2/20/87
Chief, Property Administration

WHEELLOCK
BMA 6763
SHEET 1 OF 3

Pin # 99R597
Route VT122

DATE: 12/1/86

STATE OF VERMONT
AGENCY OF TRANSPORTATION
RIGHT-OF-WAY PLANS
DETAIL SHEET

TABLE OF PROJECT PROPERTY ACQUISITION

PARCEL NO.	GRANTOR	SHEET NO.	BEGINNING STATION	ENDING STATION	TAKING	REM.	RIGHTS	TITLE TAKEN	DATE	TOWN OR CITY RECORDED	BK.	PG.	REMARKS
1	GREGORY, DANIEL J. & MARJORIE M.	3	SURSTA. 9 + 00 RT. SURSTA. 9 + 80 RT. SURSTA. 9 + 90 RT.	SURSTA. 9 + 97 RT. SURSTA. 10 + 05 RT. SURSTA. 10 + 00 RT.	0.01 A ±		CONST. EASE. (T) (300 SF. ±) CHANNEL (P) (120 SF. ±)	NONE		WHEELOCK			1565 SF. ±
2	DEGRENA, PAUL & BERTHA	3	SURSTA. 9 + 55 RT. SURSTA. 9 + 97 RT. SURSTA. 10 + 05 RT.	SURSTA. 10 + 50 RT. SURSTA. 10 + 30 RT. SURSTA. 10 + 18 RT.	0.02 A ±		CONST. EASE. (T) (100 A ±) CHANNEL (P) (150 SF. ±)	NONE		WHEELOCK			1050 SF. ± 1850 SF. ±

TABLE OF REVISIONS

REVISION NO.	SHEET NO.	DESCRIPTION OF REVISION	DATE	MADE BY	APPROVED BY

MADE BY: MJA DATE: 2-19-87
CHECKED BY: FJM DATE: 2-19-87

DR. RT. — DRAINAGE RIGHT
DT. RT. — DITCHING RIGHT
CH. RT. — CHANNEL RIGHT
DRIVE RT. — DRIVE RIGHT
CUL. RT. — CULVERT RIGHT
⊙ — DEMOLITION OR REMOVAL
W — WATER SOURCES

————— PRESENT R.O.W.
// —// —// TAKING WITHOUT ACCESS
// — P —// TAKING WITHOUT ACCESS ALONG PROPERTY LINES
————— TAKING WITH ACCESS
(P) — PERMANENT EASEMENT
(T) — TEMPORARY EASEMENT

LEGEND
- - - - - CONST. EASE. ——— CONST. EASEMENT
SR — SR — SLOPE RIGHTS
P — P — PROPERTY LINE
△ — △ — △ — TOP OF CUT
○ — ○ — ○ — TOE OF SLOPE

APPROVED: [Signature] DATE: 2-20-87
CHIEF OF PLANS & TITLES

APR 9 1987
PROJECT: WHEELOCK
NO. BMA 6763
SHEET 2 OF 3

Quadrant, Henry Day Co. Inc. Type 2
 SURV STA. 8600 - 11+75 RT
 SURV STA. 9+00 - 11+75 RT

REVISIONS
 NO. DATE BY
 1 10-15-84
 2 11-27-85
 3 1-28-86
 4 1-18-87
 5 1-28-89

DATE	BY	REVISIONS

DATE	BY	REVISIONS

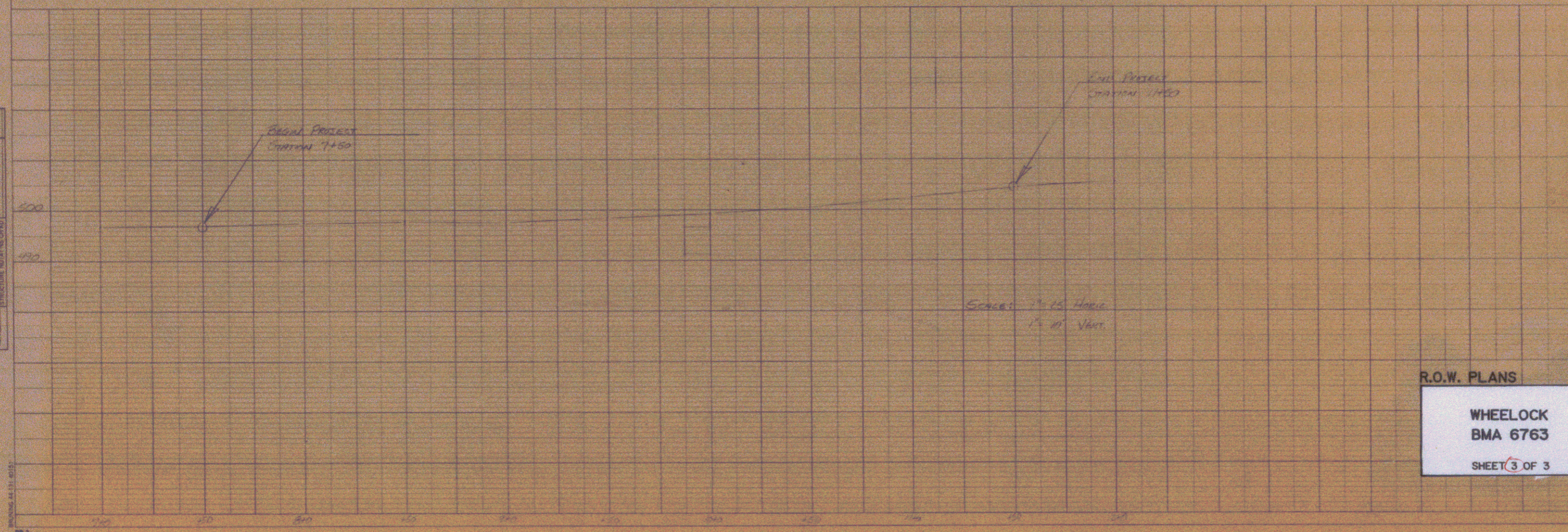
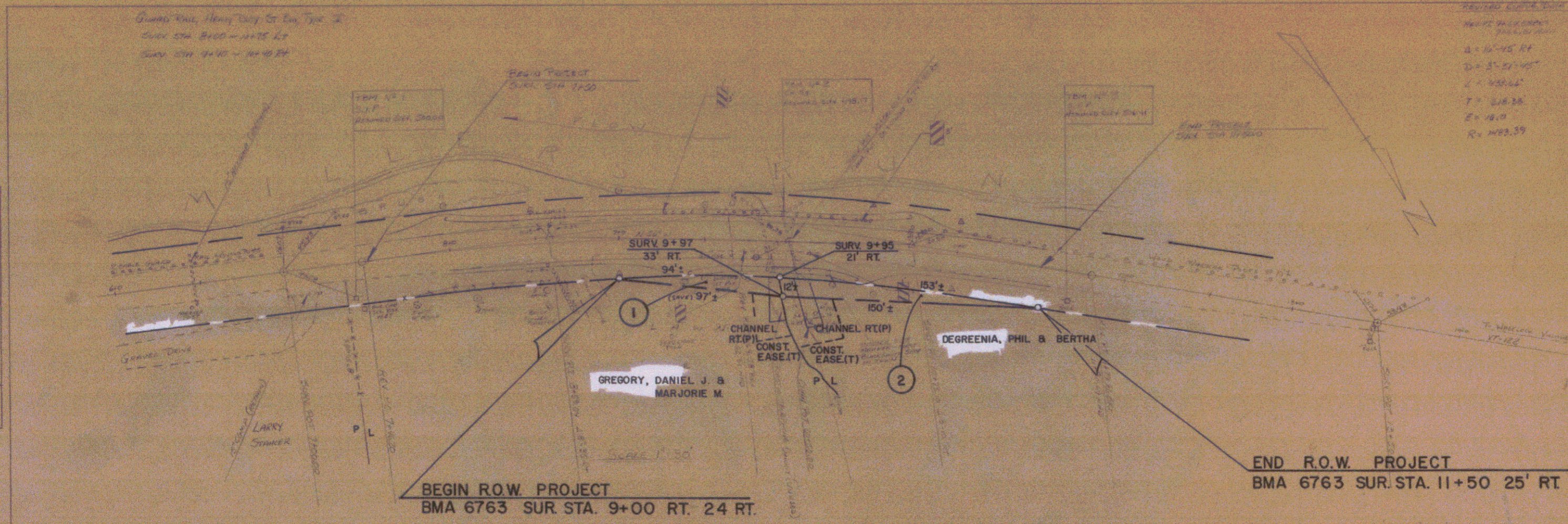

R.O.W. PLANS
WHELOCK
BMA 6763
 SHEET 3 OF 3

3