

INDEX OF SHEETS

SHEET NO. 1	TITLE PAGE
" 2	TYPICAL CROSS-SECTION OF IMPROVEMENT STARLIZED GRAVEL BASE COURSE OF OUTBACK ASPHALT WITH SAND SEAL, ITEM 303-B
" 3	BANKING AND WIDENING TABLES
" 4	CONSTRUCTION DETAILS (DRAINAGE AND MARKERS)
" 5	CONSTRUCTION DETAILS CD-1 (DITCHES)
" 6	STANDARD STRUCTURE SHEET S 40 BARRICADES, SIGNS & LIGHTS
" 7	QUANTITY SHEET (ITEMS & DRAINAGE)

8-9 EARTHWORKS
 10-15 PLAN AND PROFILE
 16-27 CROSS SECTIONS

STANDARD STRUCTURE SHEET APPROVED BY THE CHIEF ENGINEER, VERMONT STATE DEPARTMENT OF HIGHWAYS
 S-40 JULY 10, 1950

STATE OF VERMONT
 STATE HIGHWAY DEPARTMENT

PLAN AND PROFILE OF PROPOSED
 STATE HIGHWAY

SECONDARY PROJECT
TOWN OF FRANKLIN Pin # 99R586
 COUNTY OF FRANKLIN
 FRANKLIN STATE AID ROUTE 1
 FRANKLIN-EAST FRANKLIN ROAD

BEGINNING AT A POINT APPROXIMATELY 118.0 FEET SOUTH-ERLY OF THE INTERSECTION OF VERMONT ROUTE 120 AND FRANKLIN STATE AID ROUTE 1, AND EXTENDING EASTERLY 1.070 MILE.

LENGTH OF PROJECT 5650.0 FEET = 1.070 MILE

FED. ROAD DIV. NO.	STATE	PROJ. NO.	FISCAL YEAR	SHEET NO.	TOTAL SHEETS
1	Vt.	S 81(1)	1952	1	27

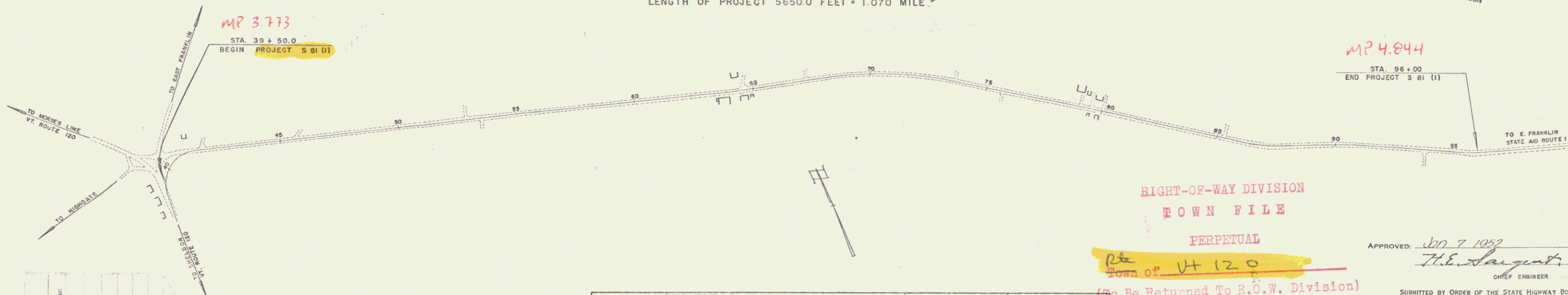
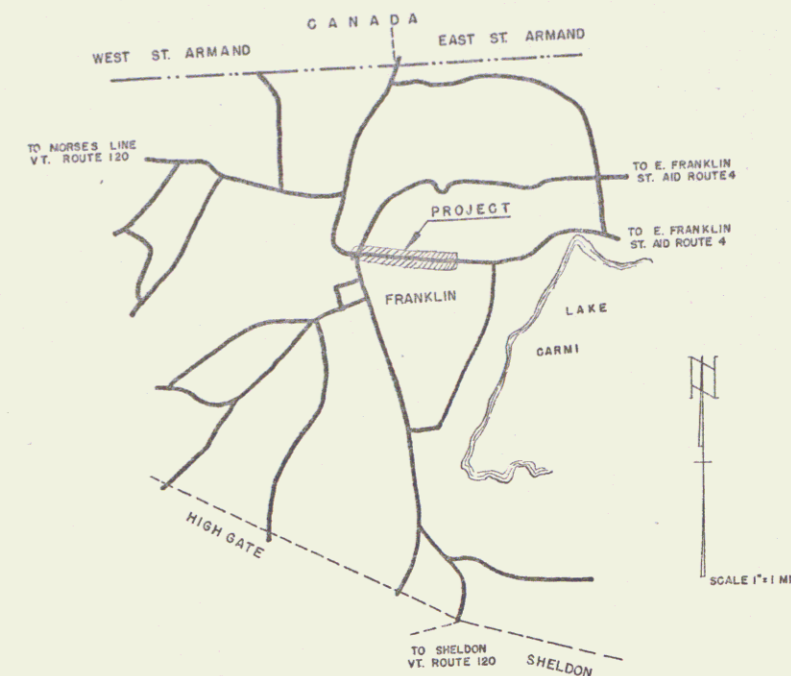

RIGHT-OF-WAY DIVISION
 TOWN FILE
 PERPETUAL

APPROVED: *John T. Sargent*
 CHIEF ENGINEER

TO BE RETURNED TO R.O.W. DIVISION

PROJECT NAME & NUMBER	TYPE	PAVEMENT AREA
FRANKLIN S 81(1)	STAR GR. BASE CR.	14279 S.Y.
RECORD PLANS		
MATERIALS		
SUB-BASE OF GRAVEL MOSIER PIT, WEST BERKSHIRE	ACOGMP NEW ENG. MET. PIPE CO. PALMER, MASS.	
ASPHALT SOCCNY VAGUUM E. PROVIDENCE R.I.	BIT. DRAIN PIPE ENCW I. CO. BURLIN, N.H.	
RCP VT. CONC. PIPE CO. WINDSOR, VT.		
CONTRACTOR RAY DUBOIS, SWANTON, VT.	CONTRACT DATED DEC. 23, 1952	
RES. ENGINEER H. G. BAREIS	CONTRACT STARTED APR. 3, 1953	
DIRECTOR HORACE RAYMOND	CONTRACT COMPLETED JULY 22, 1953	
RECORD PLANS BY FRANKLIN B. ROJING	CONTRACT ACCEPTED JULY 22, 1953	

NOTE: ANY FURTHER INFORMATION CONCERNING FINAL QUANTITIES, AMOUNTS OR OTHER DETAILS RELATIVE TO THIS PROJECT MAY BE FOUND IN EITHER THE FIELD BOOKS OR THE ESTIMATE FILE.

DEPARTMENT OF COMMERCE BUREAU OF PUBLIC ROADS	
RECOMMENDED FOR APPROVAL	
DISTRICT ENGINEER	DATE
APPROVED	
DIVISION ENGINEER	DATE

THESE PLANS ARE SUBJECT TO SUCH REVISIONS AS MAY BE REQUIRED BY THE BUREAU OF PUBLIC ROADS OR THE COMMISSIONER OF HIGHWAYS.

CONSTRUCTION IS TO BE CARRIED ON IN ACCORDANCE WITH THE PLANS AND THE STANDARD ROAD AND BRIDGE SPECIFICATIONS OF 1948 AS APPROVED JULY 25, 1949 BY THE BUREAU OF PUBLIC ROADS INCLUDING ALL SUBSEQUENT APPROVED REVISIONS AND SUCH REVISED SPECIFICATIONS AND SPECIAL PROVISIONS AS ARE SUBMITTED WITH THE PLANS.

SCALES

TITLE	1" = 200'
TYPICAL	1" = 2'
PLAN	1" = 50'
PROFILE HORIZONTAL	1" = 50'
PROFILE VERTICAL	1" = 10'
CROSS SECTIONS	1" = 5'

CURVE DATA

DEFLECTION ANGLE	Δ
DEGREE OF CURVE	D
RADIUS OF CURVE	R
TANGENT DISTANCE	T
LENGTH OF CURVE	L
EXTERNAL DISTANCE	E
POINT OF INTERSECTION	P. I.
POINT OF CURVE	P. C.
POINT OF TANGENT	P. T.
POINT ON TANGENT	P. O. T.

PROJECT	LENGTH	YEAR 19
FRANKLIN S 81(1)		
CONTRACTOR RAY DUBOIS		
RECORD PLANS BY FRANKLIN B. ROJING		
CONTRACT COMPLETED 7/22/53		

APPROVED <i>John T. Sargent</i> SECONDARY ENGINEER	APPROVED <i>John T. Sargent</i> HIGHWAY ENGINEER	APPROVED <i>John T. Sargent</i> DISTRICT ENGINEER	PROJECT S NO. 81(1) FILED SHEET 1 OF 27
---	---	--	--

PLAN
 11-51
 Sounding
 22.4

PLAN
 11-51
 Sounding
 22.4

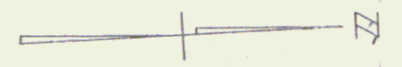

VILLAGE OF FRANKLIN

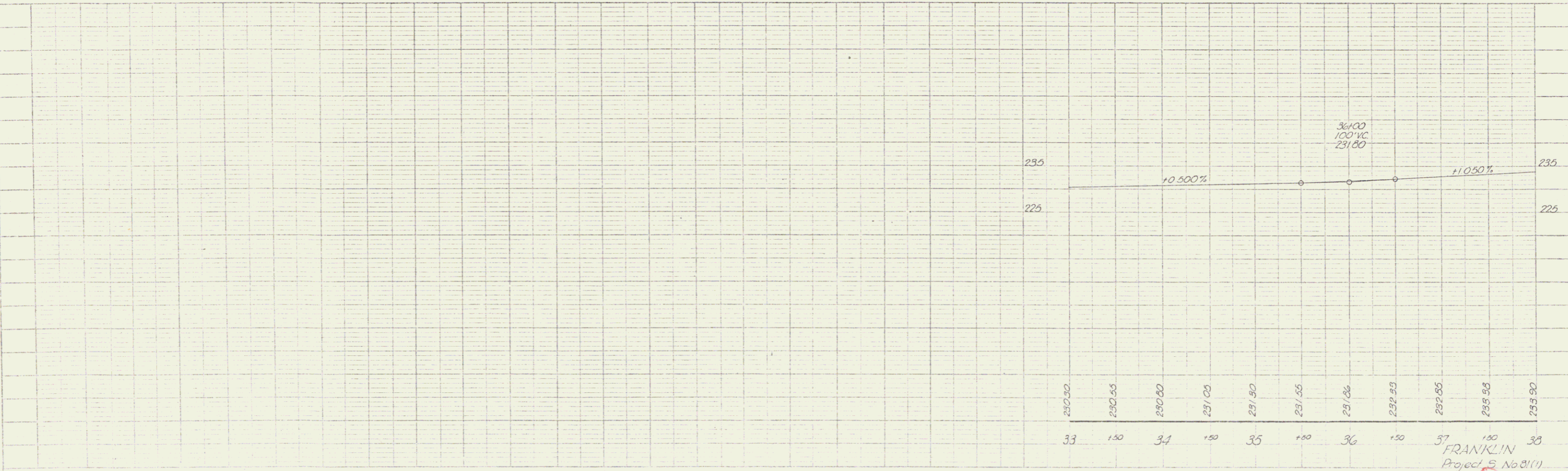
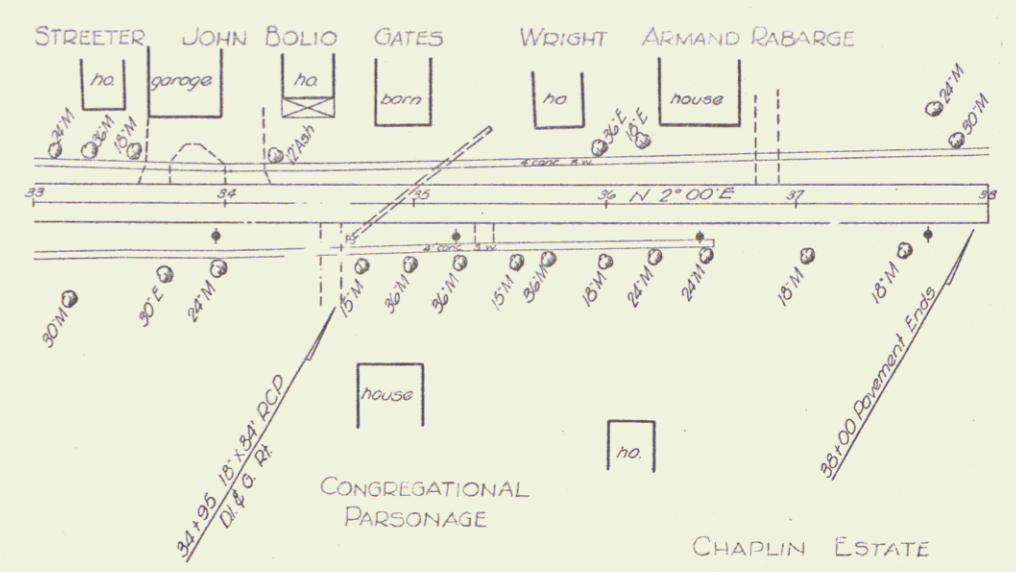

FRANKLIN
 Project S No 81(1)
 Sheet 10 of 27

PLAN
 10-31
 Polimen
 10-31

PLAN
 10-31
 Polimen
 10-31

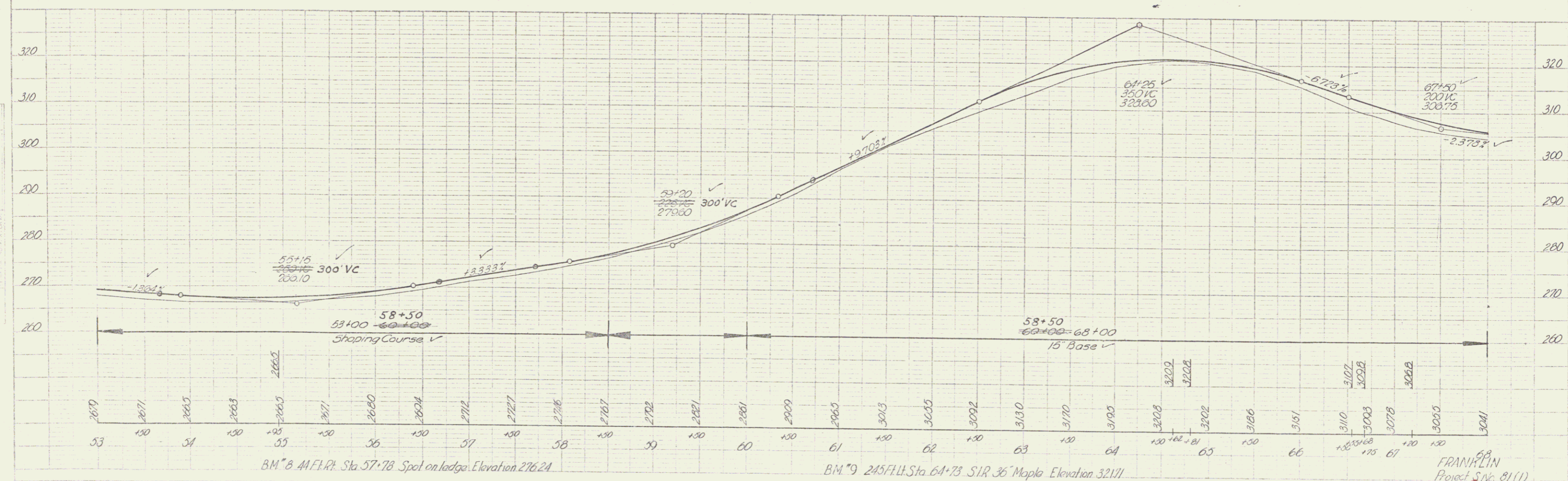
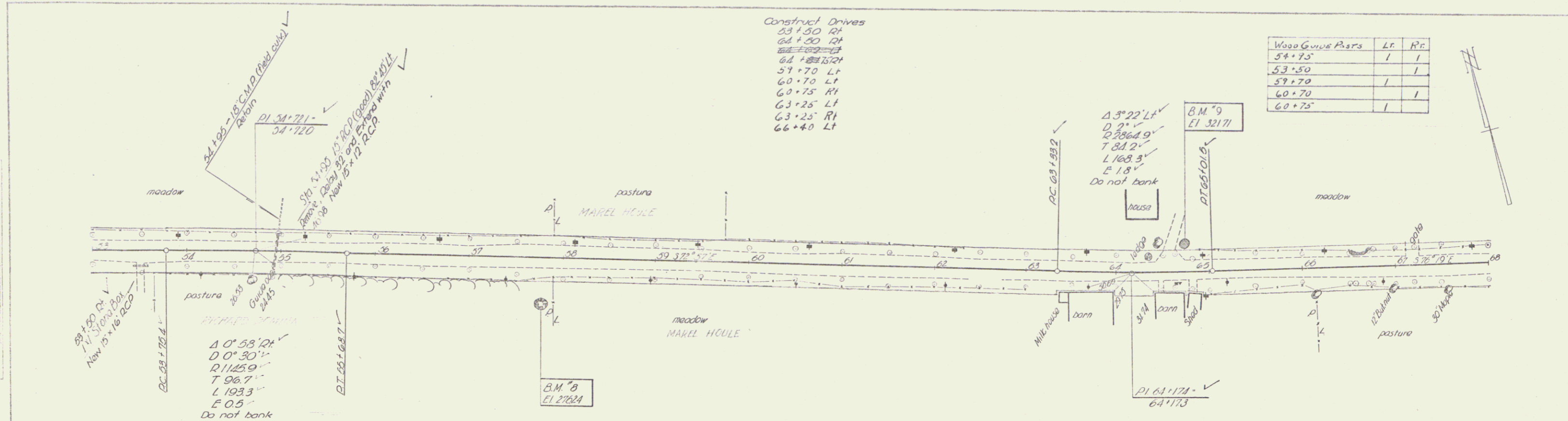

FRANKLIN
 Project No. 81(1)
 Sheet 12 of 27

10-30
 10-31
 10-32
 10-33
 10-34
 10-35
 10-36
 10-37
 10-38
 10-39
 10-40
 10-41
 10-42
 10-43
 10-44
 10-45
 10-46
 10-47
 10-48
 10-49
 10-50
 10-51
 10-52
 10-53
 10-54
 10-55
 10-56
 10-57
 10-58
 10-59
 10-60
 10-61
 10-62
 10-63
 10-64
 10-65
 10-66
 10-67
 10-68
 10-69
 10-70
 10-71
 10-72
 10-73
 10-74
 10-75
 10-76
 10-77
 10-78
 10-79
 10-80
 10-81
 10-82
 10-83
 10-84
 10-85
 10-86
 10-87
 10-88
 10-89
 10-90
 10-91
 10-92
 10-93
 10-94
 10-95
 10-96
 10-97
 10-98
 10-99
 11-00

Construct Drives
 69+00
 73+58 Lt
 75+65 Rt
 77+00 Lt
 79+50 Lt
 82+00 Lt
 85+00 Lt
 88+00 Lt
 91+00 Lt
 94+00 Lt

Wood Guide Posts	LR	RR
71+13	1	1
73+53	1	1
83+70	1	1
75+65	1	1

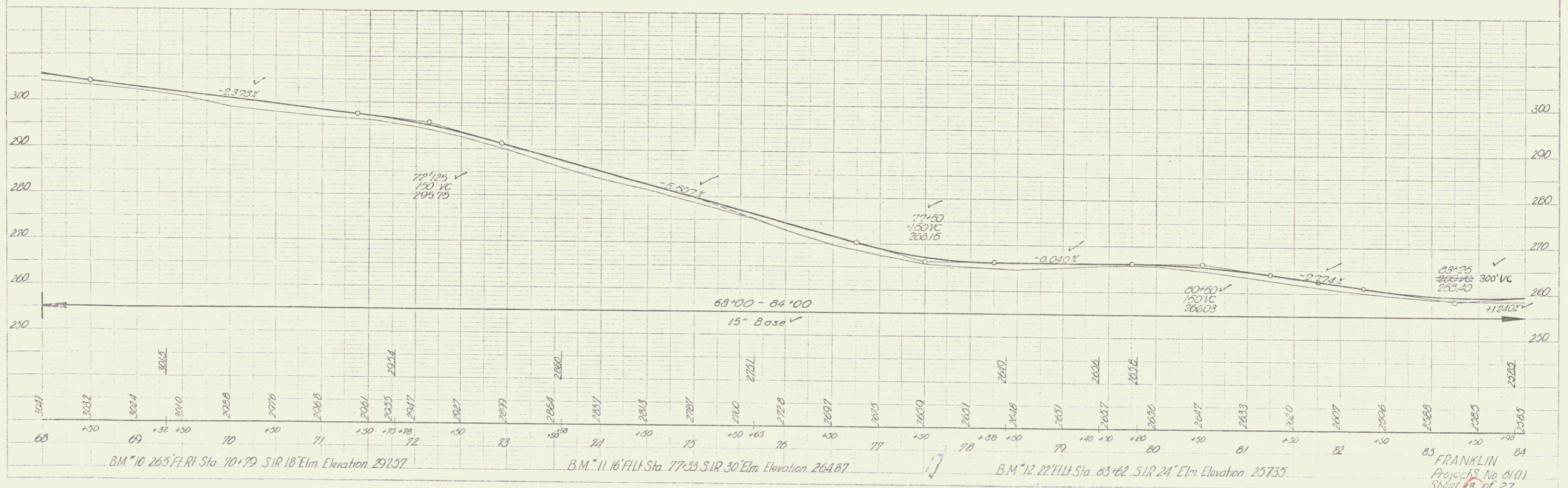
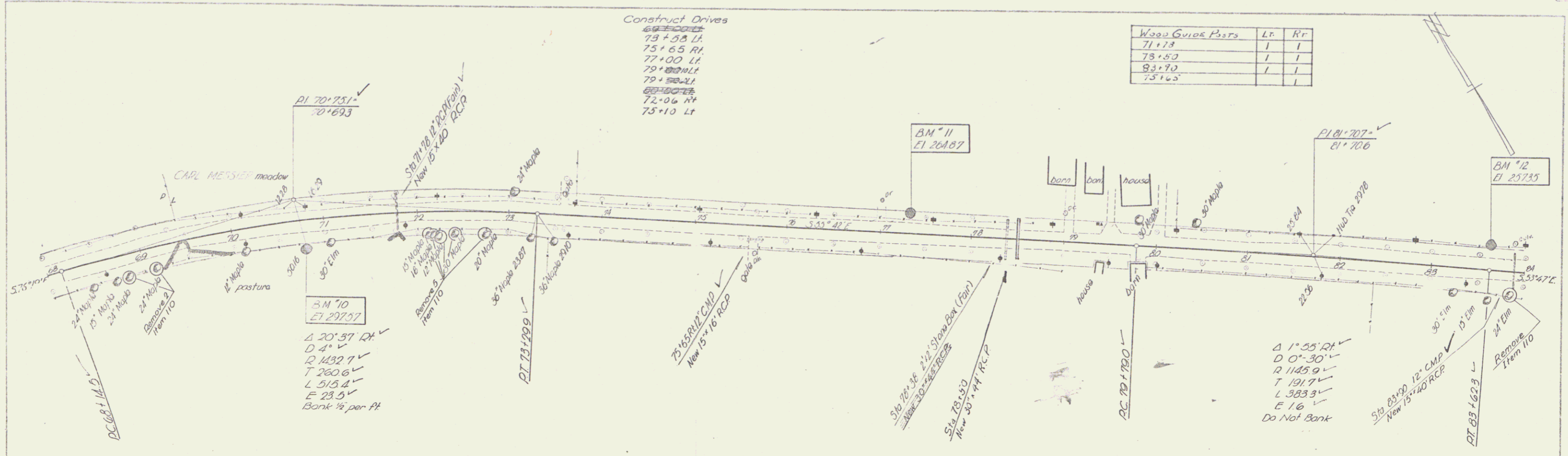

B.M. 10 265 FT RI Sta. 70+79 SIR 18' Elm Elevation 297.57

B.M. 11 16 FT RI Sta. 77+35 SIR 30' Elm Elevation 264.87

B.M. 12 22 FT RI Sta. 83+62 SIR 24' Elm Elevation 257.35

FRANKLIN
 Project No. 81(1)
 Sheet 13 of 27

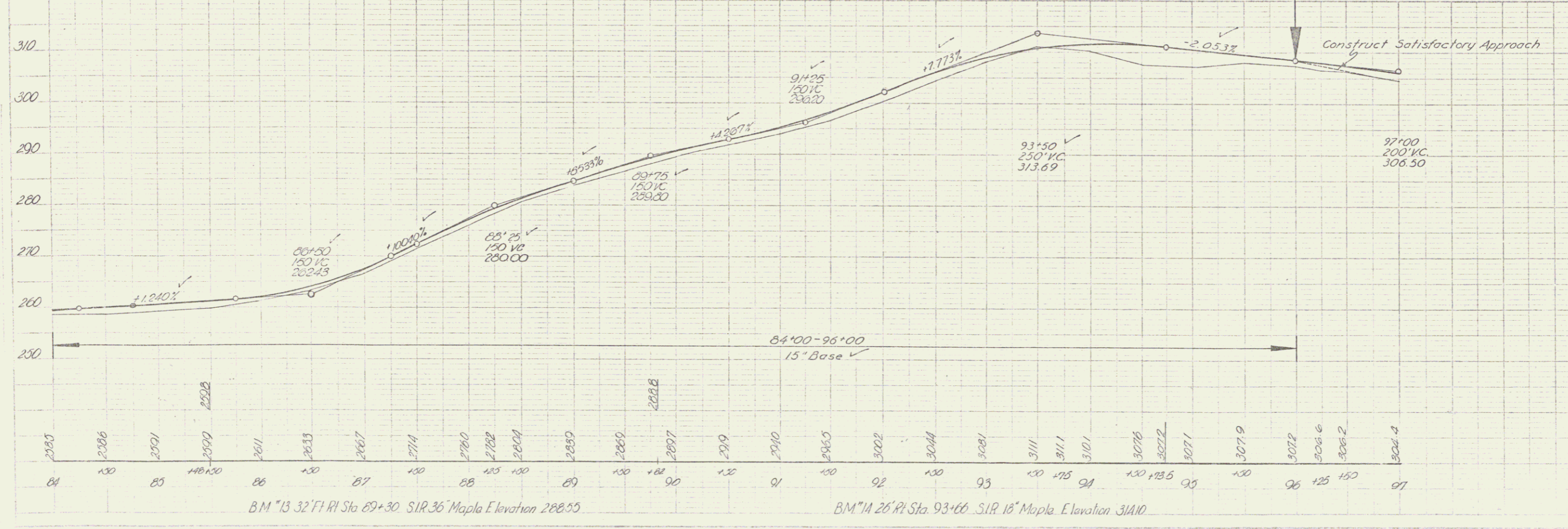
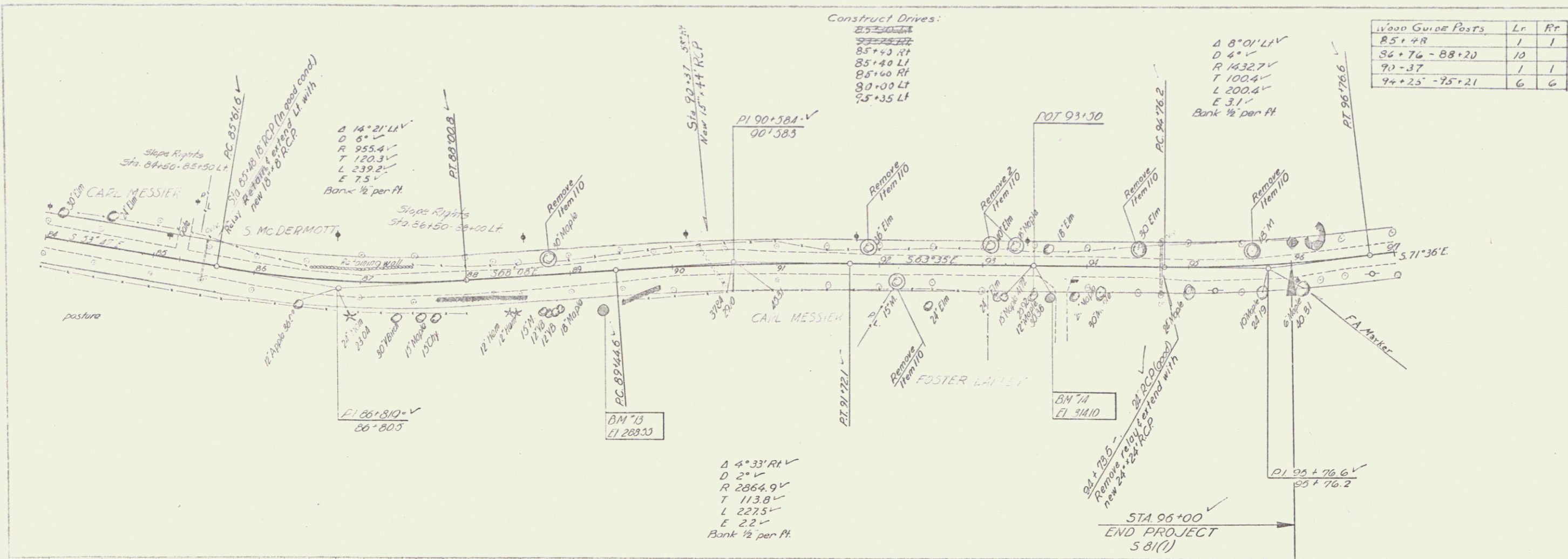

FRANKLIN
 Project S. No. 81(1)
 Sheet 24 of 27

DATE	Aug 28
SCALE	1" = 40'
PROJECT	Franklin
NO.	5
SHEET	15
TOTAL SHEETS	27

