

INDEX OF SHEETS

SHEET NO. 1	TITLE PAGE
2	TYPICAL CROSS SECTION OF IMPROVEMENTS - SINGLE TRACK COAT OF CUTBACK ASPHALT WITH CRUSHED PEA STONE, ITEM 316
3	BANKING AND WIDENING TABLES
4	QUANTITY SHEETS (ITEM & DRAINAGE)
5-6	EARTHWORK SHEETS
7-9	PLAN & PROFILE SHEETS
10	CONSTRUCTION DETAILS (DRAINAGE & MARKERS)
11	CONSTRUCTION DETAILS (CD-1) DITCHES
12	STANDARD STRUCTURE SHEET 5-40 BARRICADES, SIGNS & LIGHTS
13-18	CROSS SECTIONS

STANDARD STRUCTURE SHEET APPROVED BY THE CHIEF ENGINEER VERMONT STATE DEPARTMENT OF HIGHWAYS.

5-40 JUNE 10 1950

STATE OF VERMONT
DEPARTMENT OF HIGHWAYS
PROPOSED IMPROVEMENT

TOWN OF SHELDON
COUNTY OF FRANKLIN
VERMONT ROUTE 120
SHELDON-FRANKLIN ROAD

BEGINNING AT A POINT APPROXIMATELY 0.947 MILES NORTHERLY OF THE INTERSECTION OF VERMONT ROUTES 105 AND 120 AND EXTENDING NORTHERLY 0.784 MILES.

LENGTH OF PROJECT 442 FEET = 0.784 MILES

FED. ROAD DIVISION NO.	STATE	PROJECT NO.	VEH. DIST. NO.	SHEET NO.	TOTAL SHEETS
1	VT.	5 52 (3)	W&V	1	18

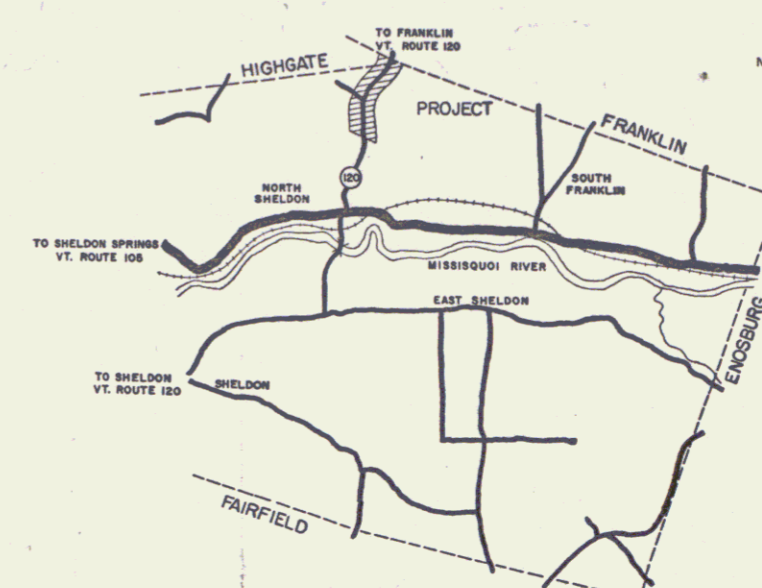
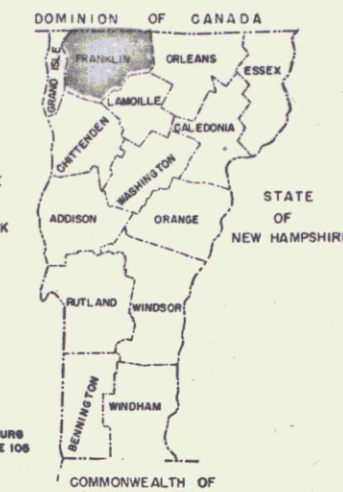

Pin # 9912584

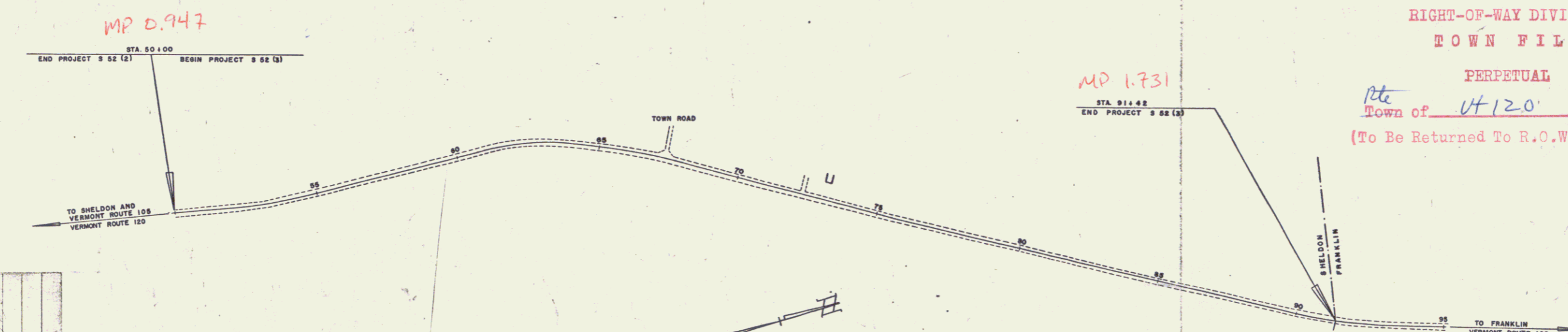

RIGHT-OF-WAY DIVISION
TOWN FILE
PERPETUAL
pte
Town of VT 120
(To Be Returned To R.O.W. Division)

COU	FRANKLIN
TOW	SHELDON
FEW	
STO	
UNP	
GUA	
TRA	
RAIL	
RET	
GEN	
SUR	
GUL	
DRO	
TRO	
POB	
TEL	
TRE	
HED	

GROUND ELEVATION	DATUM	LINE
GRADE ELEVATION	DATUM	LINE
CURVE DATA		
DEFLECTION OF ANGLE	Δ	
RADIUS OF CURVE	R	
TANGENT DISTANCE	T	
LENGTH OF CURVE	L	
EXTERNAL DISTANCE	E	
POINT OF INTERSECTION	P.I.	
POINT OF CURVE	P.C.	
POINT OF TANGENT	P.T.	
POINT ON TANGENT	P.O.T.	
POINT ON SUB-TANGENT	P.O.S.T.	

SCALES

TITLE	1" = 200'
TYPICAL	1" = 8'
PLAN	1" = 80'
PROFILE HORIZONTAL	1" = 10'
PROFILE VERTICAL	1" = 10'
CROSS-SECTIONS	1" = 4'

PROJECT NAME & NUMBER	SHELDON S 52 (3)	TYPE	PAVEMENT AREA
			ANGLE TK. CT. 9204.4 S. Y.
RECORD PLANS			
MATERIALS			
ASPHALT	SHELL OIL CO., FALL RIVER, MASS.	RCP	VT. CONC. PIPE CO., WINDSOR, VT.
GRAVEL	GREEN MOUNTAIN, SHELDON, VT.	BORROW	NOISEAU PIT, SHELDON, VT.
CONTRACTOR	KENNETH REED	CONTRACT DATED	AUG. 6, 1953
RES. ENGINEER	H. G. GARDES	CONTRACT STARTED	AUG. 17, 1953
INSPECTOR		CONTRACT COMPLETED	NOV. 25, 1953
RECORD PLANS	K. EASTMAN	CONTRACT ACCEPTED	NOV. 25, 1953

THESE PLANS ARE SUBJECT TO SUCH REVISIONS AS MAY BE REQUIRED BY THE BUREAU OF PUBLIC ROADS OR THE COMMISSIONER OF HIGHWAYS.

CONSTRUCTION IS TO BE CARRIED ON IN ACCORDANCE WITH THE PLANS AND THE STANDARD ROAD AND BRIDGE SPECIFICATIONS OF 1948, AS APPROVED JULY 25, 1949 BY THE BUREAU OF PUBLIC ROADS, INCLUDING ALL SUBSEQUENT APPROVED REVISIONS AND SUCH REVISED SPECIFICATIONS AND SPECIAL PROVISIONS AS ARE SUBMITTED WITH THE PLANS.

NOTE: FOR FURTHER INFORMATION REFER TO THE ORIGINAL QUANTITY SHEETS OR TO THE RECORD PLANS RELATIVE TO THE PROJECTS WHICH MAY BE LOCATED EITHER IN THE FIELD BOOKS OR THE RECORD PLANS.

APPROVED	<i>K. Eastman</i>	APPROVED	<i>H. G. Garde</i>	APPROVED	<i>H. E. Laughton</i>
DATE	July 9, 1953	DATE	July 9, 1953	DATE	July 9, 1953

DEPARTMENT OF COMMERCE	BUREAU OF PUBLIC ROADS
APPROVED	
DISTRICT ENGINEER	DATE

PROJECT S NO. 52 (3)
SHEET 1 OF 18 SHEETS

PLAN	DATE	BY
DESIGNED	3/25	Lavin
CHECKED		Hurley
IN CHARGE		Hurley
DATE		
NO.		

PROFILE	DATE	BY
DESIGNED	3/25	Lavin
CHECKED		Hurley
IN CHARGE		Hurley
DATE		
NO.		

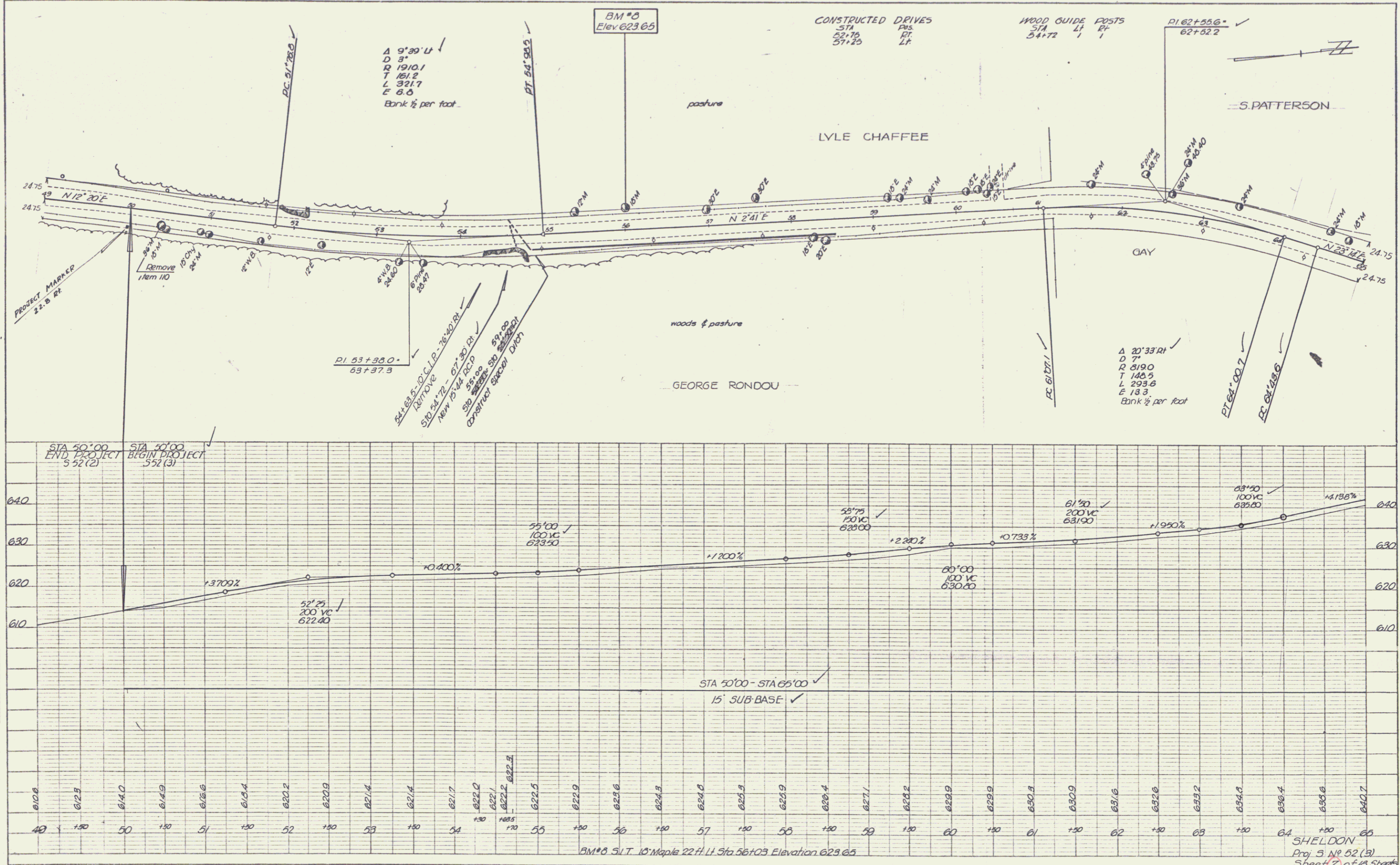

SHELDON
 Proj. 5 No 52 (3)
 Sheet 7 of 13 Sheets

