

STATE OF VERMONT
DEPARTMENT OF HIGHWAYS

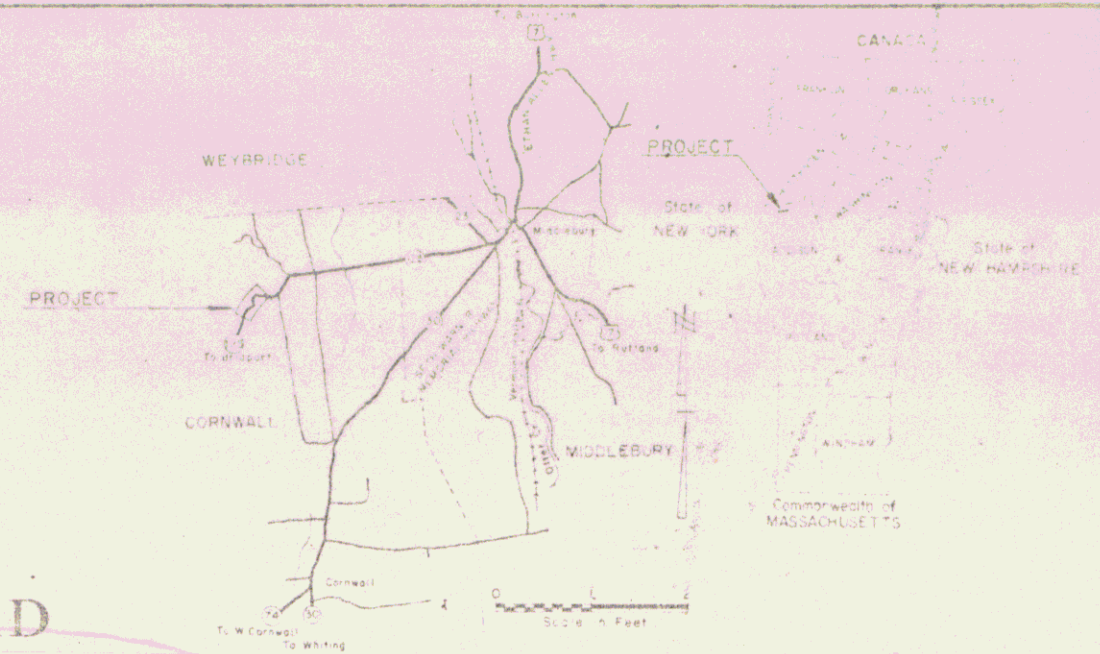

PROPOSED IMPROVEMENT
TOWN OF CORNWALL
COUNTY OF ADDISON
BRIDPORT - MIDDLEBURY ROAD
VT Route 105



BEGINNING AT A POINT APPROXIMATELY 2.244 MILES
NORTHEASTERLY FROM THE BRIDPORT-CORNWALL TOWN
AND EXTENDING 0.360 MILES NORTHEASTERLY

LENGTH OF PROJECT 1900.00 FEET = 0.360 MILES
LENGTH OF ROW PROJECT 2150.00 FEET = 0.407 MILES
1975 ADT 855
1995 ADT 1335
1995 DHV 200
D 54%
T 0.5%
V 40 MPH

BEGIN ROW PROJECT HHS 0172(1)
STA. 117+00 C

BEGIN MAINT. AGREE. AREA NO.1
STA 123+00 11' RT.

END MAINT. AGREE. AREA NO.1
BEGIN RELINQUISHMENT NO.1
STA 123+50 90' RT.

END RELINQUISHMENT NO.1
STA 130+60 91' RT.

118+50
END PROJECT
HHS 0172(1)
MP 2.236

137+50
END PROJECT
HHS 0172(1)
MP 2.596

END ROW PROJECT HHS 0172(1)
STA. 138+50 C

R.O.W. PLANS

Pin # 99R575
Date 4/22/1975

HHS 0172 (1)

V-125

CORNWALL

These R.O.W. plans are subject to the approval of the State Highway Department by the Chief Engineer. The State Highway Department is authorized to issue a permit for the construction of the project, provided that the project complies with the Federal Highway Administration's requirements for the construction of the project, and that the project complies with the State Highway Department's requirements for the construction of the project.

APPROVED: *[Signature]*
R.G.W. DIRECTOR
DATE: 4-22-75

CORNWALL
MAY 5 1975
STATE OF VERMONT
FEDERAL HIGHWAY ADMINISTRATION

26

ALL DRIVES AS INDICATED ON PLANS ARE SUBJECT TO PERMITS PURSUANT TO TITLE 19, SECTION 43, V.S.A.

BEGIN R.O.W. PROJECT HHS 0172 (I)
STA. 117+00 CL.

CONST. DRIVE
115+25 RT
122+07 LT

DEVELOPING AND RAISING OF
SOLID ROCK CURBGRADE
FROM 209.10

CONSTRUCT. DRIVEWAY
123+00 RT.

BINGHAM, ROBERT B. & MAROLYN B.
BEGIN MAINT. AGREE. AREA NO. 1
STA. 123+00 II' RT. (95')

POST 124+15.36
Chord 0+00.00
Δ 30° 52' RT

PLAN

PROFILE

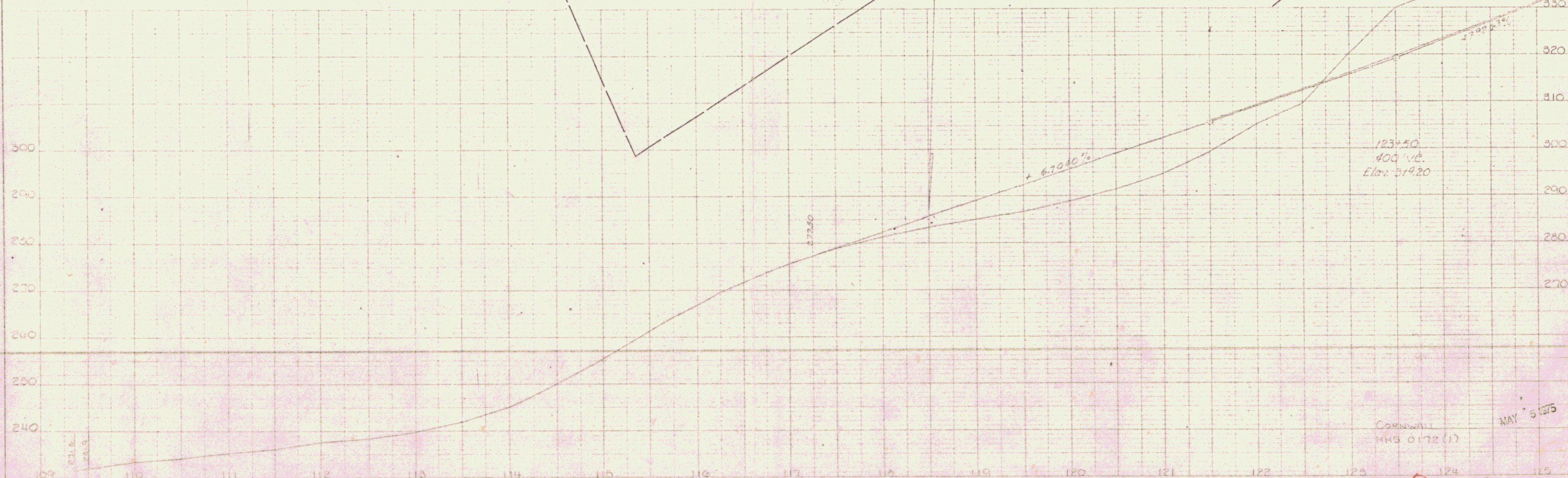
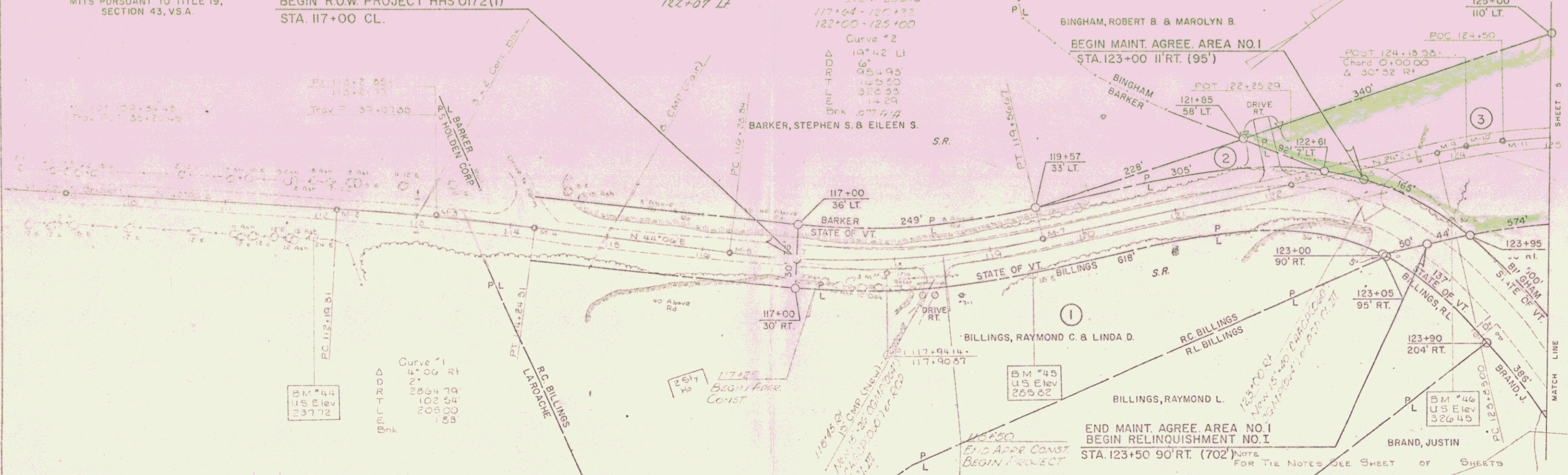

K-E PLATE 1, PLAN/PROFILE
SCALE 1/4" = 1'-0"

Cornwall
HHS 0172 (I)

MAY 5 1973

SHEET 4 OF 6 SHEETS

2

WELLS INC. BLASTING
 SPLIT ROCK 15' SIDE
 ITEM 702
 125+00 - 126+80
 128+80 - 134+80

ALL DRIVES AS INDICATED ON
 PLANS ARE SUBJECT TO PER-
 MITS PURSUANT TO TITLE 19,
 SECTION 43, V.S.A.

GUARD RAIL THREE CABLE
 W/IT STEEL POSTS
 ITEM 621.21
 125+82 - 129+18 CL
 126+23 - 129+27 LT

GUARD RAIL PLANK W/ WOOD POSTS
 ITEM 621.10
 130+80 - 130+84 RT (SERRICA P)

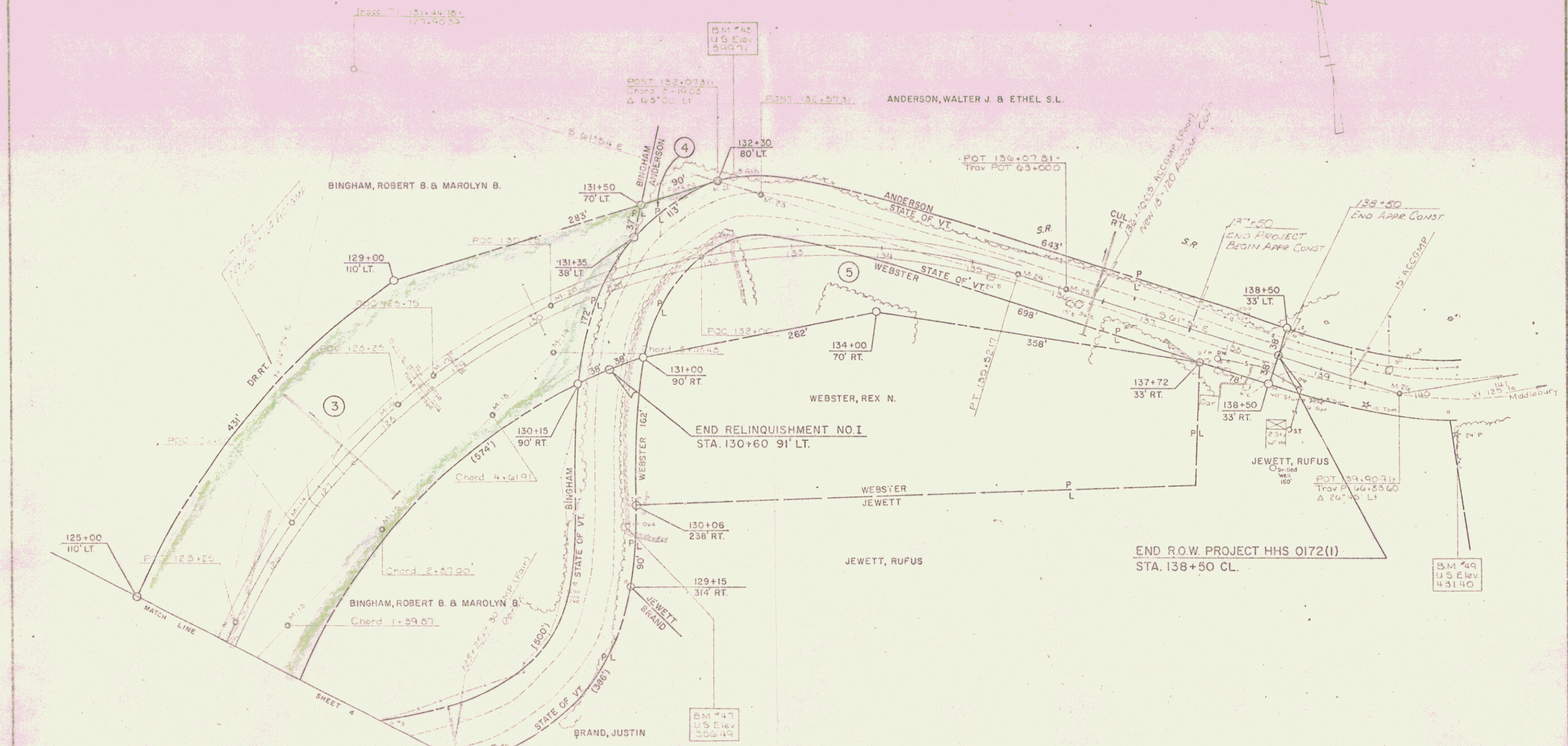

Curve #3
 93° 32' RT
 6'
 716.20'
 721.75'
 1169.17'
 329.34'
 Bk. 0.000/1.1

NOTE FOR THE NOTES
 SEE SHEET 4 OF SHEETS
 MAY 5 1975

CORNWALL
 SUPPLIED BY: Fall DATE 12/74
 DRAWN BY: D.J. Gilman DATE 1/75
 TRACED BY: Duffy DATE 1/75
 PROJ. HHS NO. 0172(1)
 SHEET 5 OF 6
 0-7

3