

PART OF THE LAND ACQUIRED BY THE STATE OF VERMONT FROM
LAWRENCE H. BAKER BY W.D. DATED DEC. 21, 1955 RECORDED IN BK.
46 PG. 193 OF THE TOWN OF NEWBURY LAND RECORDS.

STATE OF VERMONT TO L. & L. LASSEIGNE
BY CORRECTIVE GCD REC'D 6/19/91
IN BK 90/152-5A

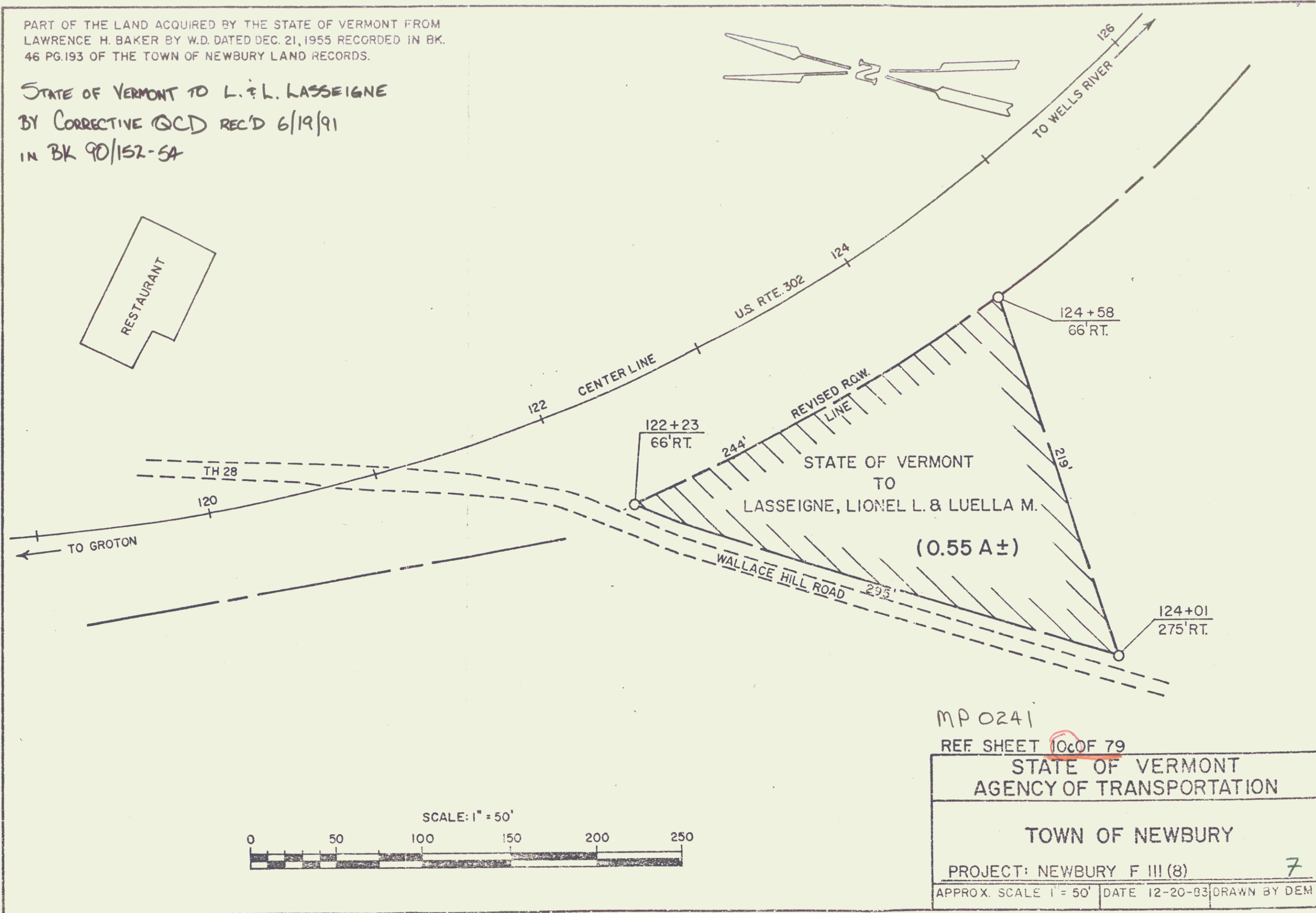

MP 0241
REF SHEET 10 OF 79
STATE OF VERMONT
AGENCY OF TRANSPORTATION
TOWN OF NEWBURY
PROJECT: NEWBURY F III (8) 7
APPROX. SCALE 1" = 50' DATE 12-20-83 DRAWN BY DEM