

PART OF THE LAND ACQUIRED BY THE STATE OF VERMONT FROM LAWRENCE H. BAKER BY W.D. DATED DEC. 21, 1955. RECORDED IN BK. 46 PG. 193 OF THE TOWN OF NEWBURY LAND RECORDS

STATE TO WARNER BY QCD
ON 1/8/86 IN BK 40/310-314
MP 0235

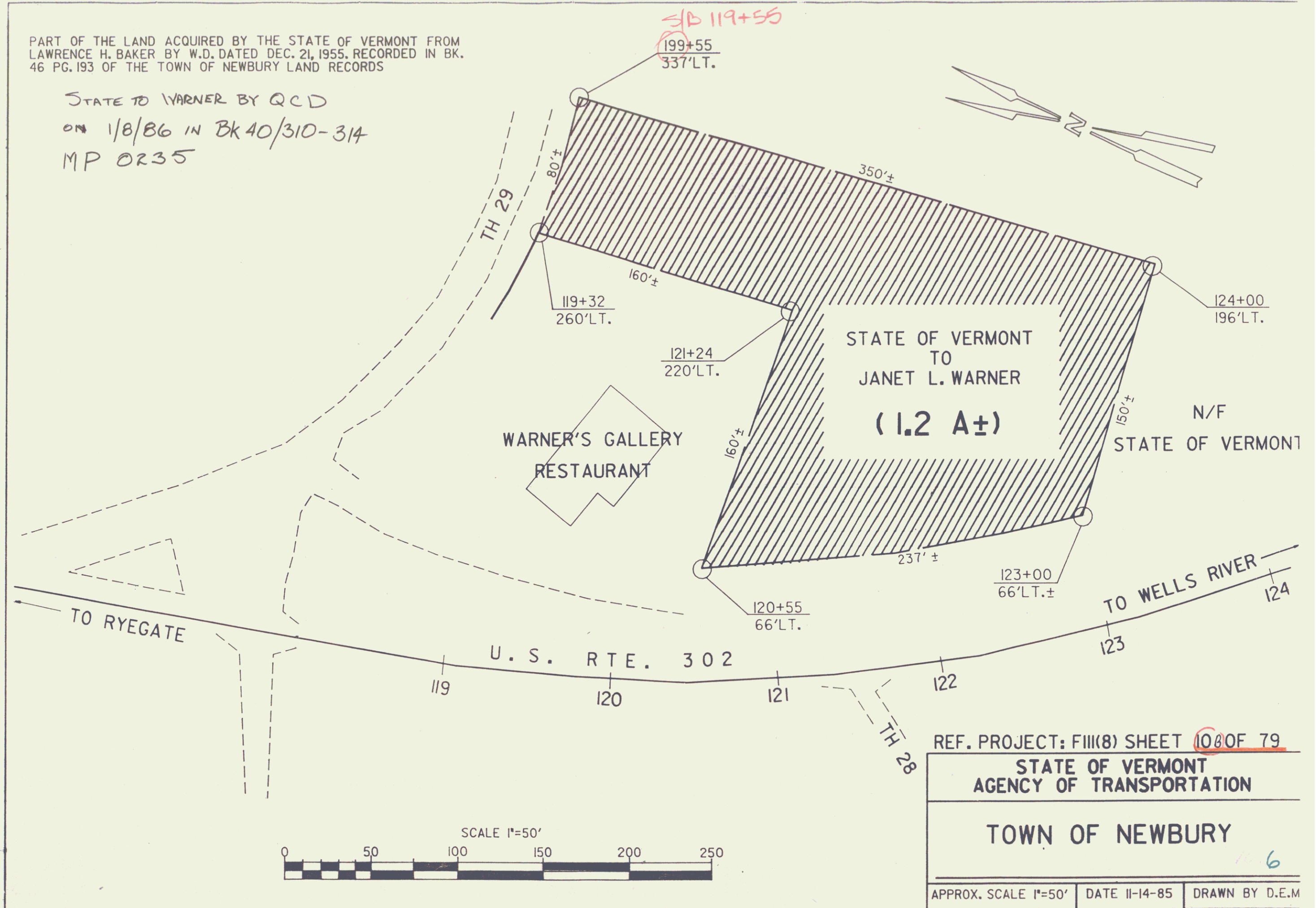

REF. PROJECT: F111(8) SHEET 100 OF 79
STATE OF VERMONT
AGENCY OF TRANSPORTATION
TOWN OF NEWBURY
APPROX. SCALE 1"=50' | DATE 11-14-85 | DRAWN BY D.E.M