

SHEET NO. 1, TITLE PAGE.  
 " " 2, TYPICAL CROSS-SECTION OF IMPROVEMENT  
 " " 2, QUANTITIES.

$\frac{1}{2}$ " Bituminous Concrete  
 Pavement, Hem 36LB (Mod)

PROJECT NAME & NUMBER NEWBURY DF 026-1(3)	TYPE $\frac{1}{2}$ " BITUMINOUS CONCRETE PAVEMENT	SURFACE AREA 28,363 sy.
RECORD PLANS		
MATERIALS		
ASPHALT - SOCONY-E. PROVIDENCE, R. I.	TAR - OLD COLONY TAR CO.	
BITUMINOUS CONCRETE	WORCESTER, MASS.	
WELLS-LANSON QUARRY CO. BARRE, VT.	GRAVEL - RIVER	
CONTRACTOR - COOLEY CONST. CO. INC.	CONTRACT DATED - SEPT. 3, 1958.	
RES. ENG. - J. A. MCCREA	CONTRACT STARTED - SEPT. 23, 1958.	
INSPECTOR - C. HELFRICH	CONTRACT COMPLETED OCT. 14, 1958.	
RECORD PLANS - E. GLYSSON	CONTRACT ACCEPTED OCT. 14, 1958.	

STATE OF VERMONT  
 DEPARTMENT OF HIGHWAYS  
**PROPOSED IMPROVEMENT**

FEDERAL AID PROJECT

TOWN OF NEWBURY  
 COUNTY OF ORANGE  
 U.S. ROUTE 302  
 WELLS RIVER - SO. RYEGATE ROAD

BEGINNING AT A POINT 13,951 FEET WEST OF THE INTERSECTION  
 OF ROUTES U.S. 302 AND U.S. 5 IN THE VILLAGE OF WELLS RIVER  
 AND EXTENDING EASTERLY 13,934.1 FEET (EXCLUDING  
 STA. 143+00.0 TO STA. 175+00.0 = 3,297.5 FEET)  
 TOTAL LENGTH OF PROJECT 10,636.3 FEET = 2.014 MILES.

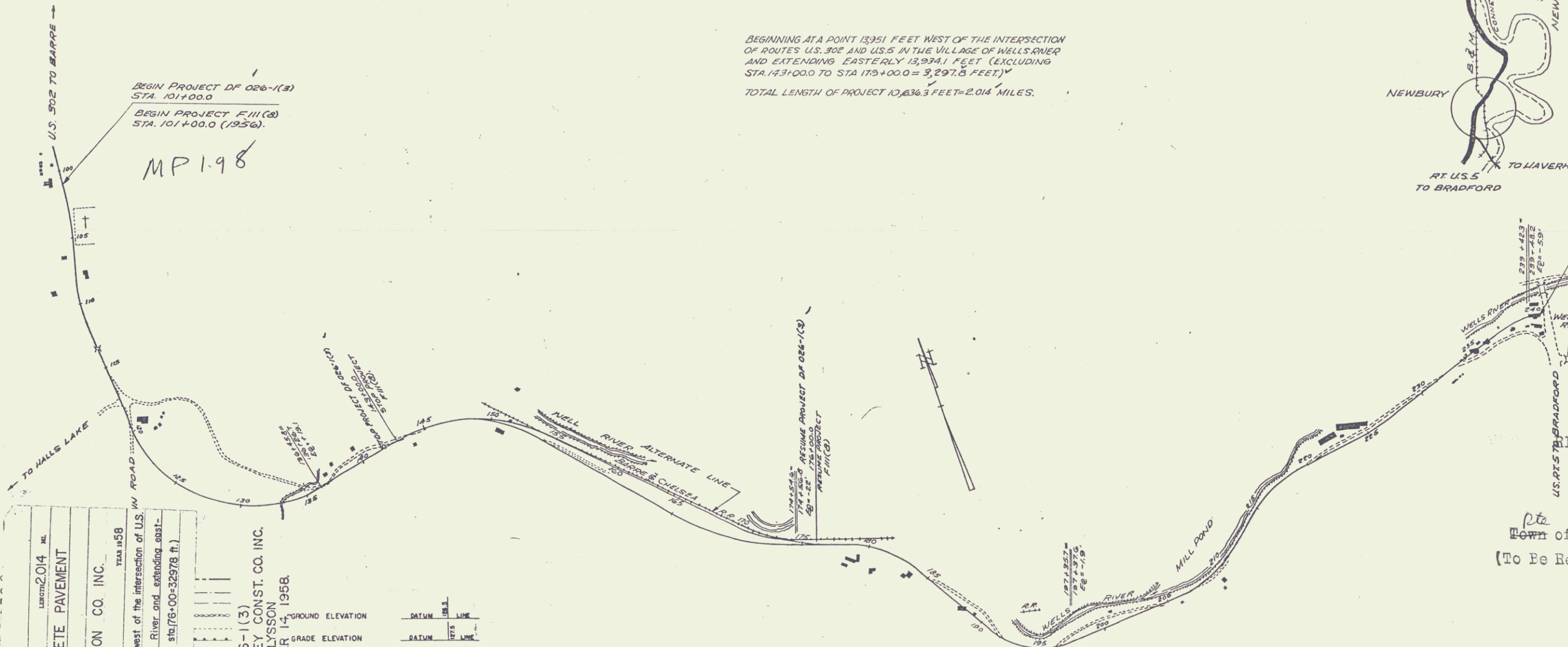
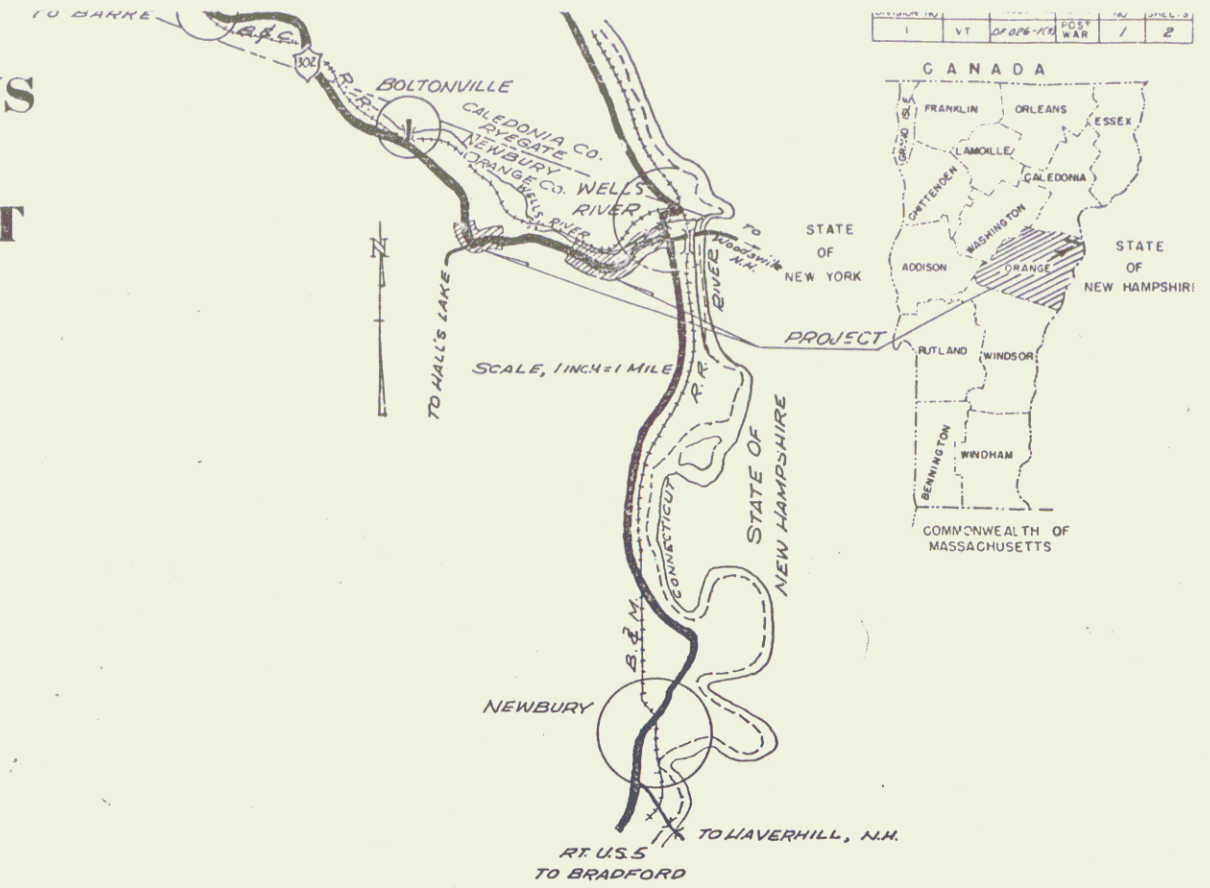

PROJECT NEWBURY, VT.  
 DISTRICT 2014  
 TYPE  $\frac{1}{2}$ " BITUMINOUS CONCRETE PAVEMENT  
 CONTRACTOR COOLEY CONSTRUCTION CO. INC.  
 BARRE, VT.  
 LOCATION Beginning at a point 13,951 ft. west of the intersection of U.S. 302 and U.S. 5 in the Village of Wells River, and extending easterly 13,934.1 ft. (excluding Sta. 143+00.0 to Sta. 175+00.0 = 3,297.5 ft.)

NEWBURY DF 026-1(3)  
 CONTRACTOR - COOLEY CONST. CO. INC.  
 RECORD PLANS - E. GLYSSON  
 COMPLETED - OCTOBER 14, 1958.

GROUND ELEVATION	DATUM	LINE
GRADE ELEVATION	DATUM	LINE
CURVE DATA		
DEFLECTION OF ANGLE	.....	A
DEGREE OF CURVE	.....	D
RADIUS OF CURVE	.....	R
TANGENT DISTANCE	.....	T
LENGTH OF CURVE	.....	L
EXTERNAL DISTANCE	.....	E
POINT OF INTERSECTION	.....	P.I.
POINT OF CURVE	.....	P.C.
POINT OF TANGENT	.....	P.T.
POINT ON TANGENT	.....	P.O.T.
POINT ON SUB-TANGENT	.....	POST

SCALES

TITLE	1" = 400'
TYPICAL	3" = 8'
PLAN	1" = 100'
PROFILE HORIZONTAL	1" = 100'
VERTICAL	1" = 10'
CROSS-SECTIONS	1" = 10'

THESE PLANS ARE SUBJECT TO SUCH REVISIONS AS MAY BE  
 REQUIRED BY THE BUREAU OF PUBLIC ROADS OR THE COMMISSIONER  
 OF HIGHWAYS.  
 CONSTRUCTION IS TO BE CARRIED ON IN ACCORDANCE WITH  
 THE PLANS AND THE STANDARD SPECIFICATIONS FOR HIGHWAY AND BRIDGE  
 CONSTRUCTION OF JANUARY 1956 SUBMITTED TO THE BUREAU OF  
 PUBLIC ROADS AS APPROVED JULY 5, 1958, INCLUDING ALL SUBSEQUENT  
 APPROVED REVISIONS AND SUCH REVISED SPECIFICATIONS AND SPECIAL  
 PROVISIONS AS ARE SUBMITTED WITH THE PLANS.

END PROJECT DF 026-1(3)  
 STA. 240+25.0  
 END PROJECT FIN(3)  
 STA. 240+25.0 (2956)  
 RT. U.S. 5 TO ST. JOHNSBURY  
 MP 4.917  
 RIGHT-OF-WAY DIVISION  
 TOWN FILE  
 PERPETUAL  
 Town of US 302  
 (To Be Returned To R.O.W. Division)

NOTE: ANY FURTHER INFORMATION CONCERNING  
 FINAL QUANTITIES, AMOUNTS OR OTHER DETAILS  
 RELATIVE TO THIS PROJECT MAY BE FOUND IN  
 EITHER THE FIELD BOOKS OR THE ESTIMATE  
 FILE.

DEPARTMENT OF COMMERCE  
 BUREAU OF PUBLIC ROADS  
 APPROVED \_\_\_\_\_  
 DISTRICT ENGINEER  
 DATE \_\_\_\_\_

APPROVED _____ SECONDARY ENGINEER DATE _____	APPROVED <i>T. C. Curtis</i> CONSTRUCTION ENGINEER DATE <i>May 26, 1958</i>	APPROVED _____ BRIDGE ENGINEER DATE _____	APPROVED _____ DISTRICT ENGINEER DATE _____	APPROVED <i>G. M. Lane</i> HIGHWAY ENGINEER DATE <i>May 26, 1958</i>	APPROVED <i>H. E. August</i> DISTRICT ENGINEER DATE <i>May 26, 1958</i> SUBMITTED BY ORDER OF THE STATE HIGHWAY BOARD
--	---	---	---	--	--

PROJECT DF NO. 026-1(3)  
 SHEET 1A OF 2 SHEETS