

INDEX OF SHEETS	
SHEET NO. 1	TITLE PAGE
2	TYPICAL CROSS-SECTION OF IMPROVEMENT HOT MIXED MACADAM WITH CRUSHED GRAVEL AND ASPHALT CEMENT ITEM 344-B
3	ROADWAY STANDARD SHEET RS 56-1 (BANKING)
4	QUANTITY SHEET (ITEMS)
5	QUANTITY SHEET (DRAINAGE)
6-8	EARTHWORK SHEETS
9-11 A	PLAN AND PROFILE SHEETS
13-18	PLAN AND PROFILE SHEETS
19	DETAIL OF 14" X 8" 9" CORR. GALV. METAL PLATE PIPE ARCH STA. 113+43
20	DETAIL OF 7" X 5" 5" CORR. GALV. METAL PLATE PIPE ARCH STA. 133+18
21	DETAIL OF 60" CORR. GALV. METAL PLATE PIPE STA. 191+67
22	ROADWAY STANDARD SHEET RS 56-2 (P.O. DROP INLET & GRATE)
23	ROADWAY STANDARD SHEET RS 56-3 (PLANK GUARD RAIL & MARKERS)
24	ROADWAY STANDARD SHEET RS 56-4 (DRAINAGE)
25	ROADWAY STANDARD SHEET RS 56-5 (TYPICAL SLOPE GRADING)
26	ROADWAY STANDARD SHEET RS 56-6 (CONC. BLOCK CATCH BASIN)
27	ROADWAY STANDARD SHEET RS 56-11 (THREE CASTLE GUARD RAIL W/STEEL POSTS)
28	ROADWAY STANDARD SHEET RS 56-14 (PRECAST ROP DROP INLET)
29-44	CROSS SECTIONS
45-51	CROSS SECTIONS (SEE NEWBURY F III (12))

STATE OF VERMONT
DEPARTMENT OF HIGHWAYS

PROPOSED IMPROVEMENT

TOWN OF NEWBURY
COUNTY OF ORANGE
U.S. ROUTE 302
WELLS RIVER-SO. RYEGATE ROAD

FEDERAL AID PROJECT

PROJECT	NUMBER	TYPE	SURFACE AREA
NEWBURY	F III (8)	SINGLE TK. CT. REF. TAR	47,272 S.Y.

RECORD PLANS

MATERIALS

GRAVEL - LEETE FARM, CONN. RIVER	ASPHALT - SOCONY, RIVERSIDE, R.I.
CRUSHED GRAVEL - CONN. RIVER	TAR - KOPPERS, EVERETT, MASS.
SAND - WOODVILLE SAND & GRAVEL CO. & CONN. RIVER	METAL CULVERTS - N.E. METAL CULVERT CO.
CRUSHED STONE - CONN. RIVER	CONC. CULVERTS - VT. CONCRETE PIPE CORP.
GUARD RAIL - AMER. ST. & WIRE CO.	GUIDE POSTS - BETHLEHEM STEEL CO.
CONTRACTOR - LAMBERT CONSTR. CO.	CONTRACT DATED - JUNE 28, 1956
RES. ENGR. - JOHN A. SMYRSKI	CONTRACT STARTED - JULY 16, 1956
INSP. - DAVIS, DRATH, LABELL	CONTRACT COMPLETED - AUG. 12, 1958
RECORD PLANS - R.C. HOLMES	CONTRACT ACCEPTED - AUG. 12, 1958

BEGINNING AT A POINT 13,951 FEET WEST OF THE INTERSECTION OF ROUTES U.S. 302 AND U.S. 5 IN THE VILLAGE OF WELLS RIVER, AND EXTENDING EASTERLY 13,934.1 FEET. (EXCLUDING STA. 143+00.0 TO STA. 176+00.0 = 3,297.8 FEET.)

TOTAL LENGTH OF PROJECT 10,636.3 FEET = 2.014 MILES.

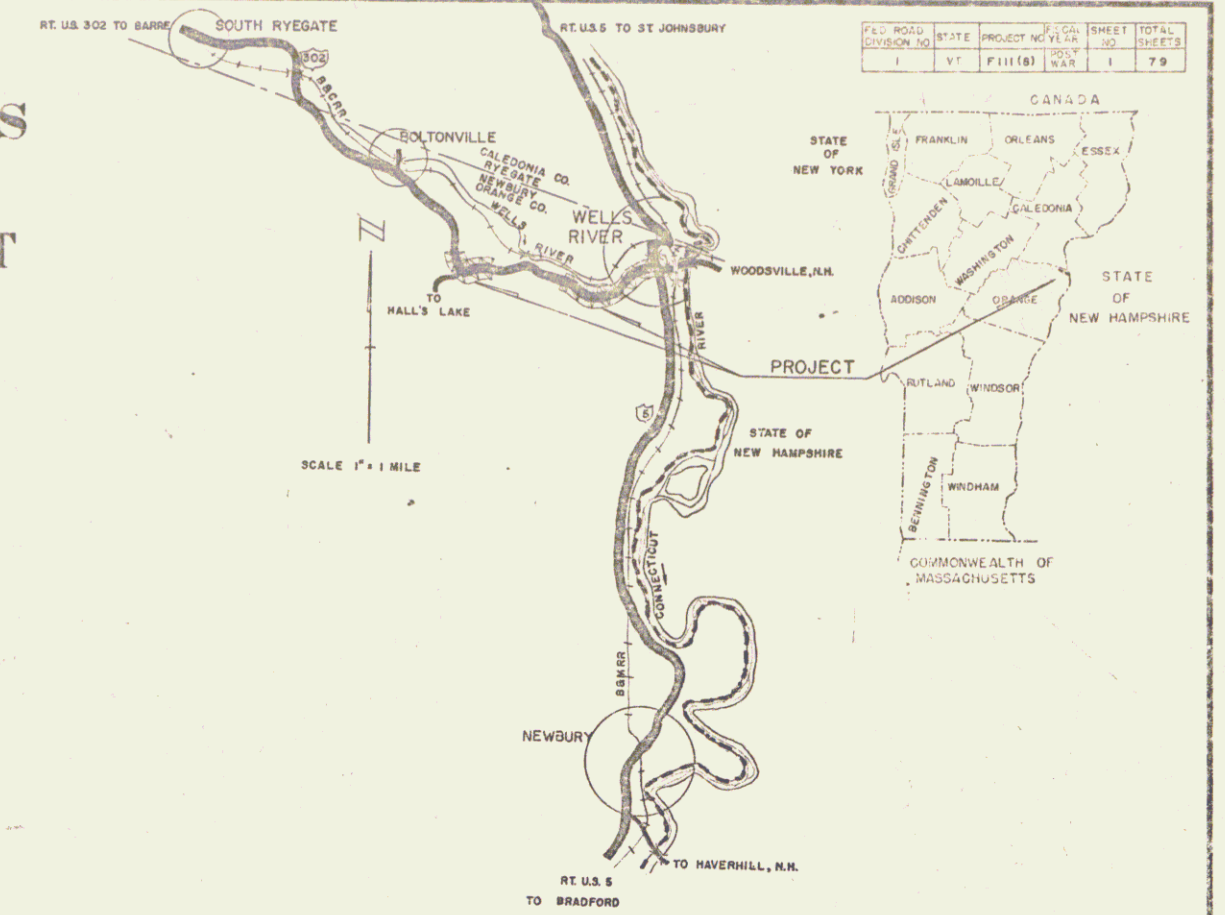

Newbury 58

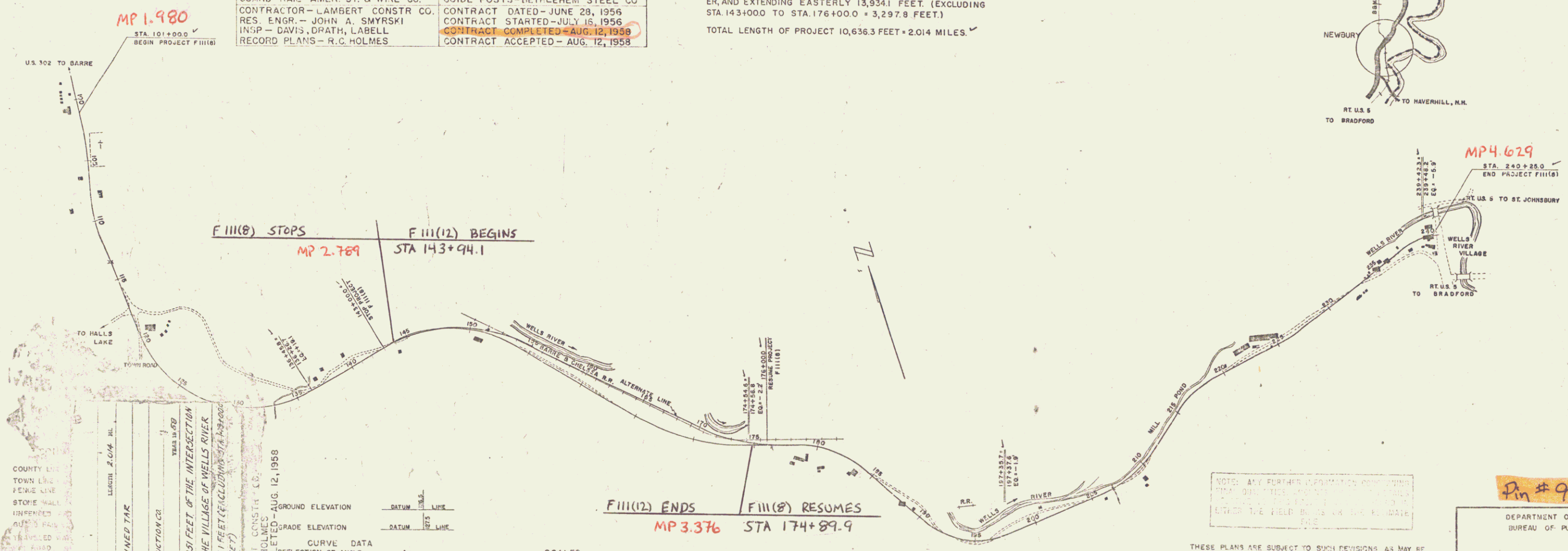

U.S. 302 TO BARRE
STA. 101+00.0
BEGIN PROJECT F III (8)

U.S. 302 TO BRADFORD
STA. 240+25.0
END PROJECT F III (8)

F III (8) STOPS
MP 2.789

F III (12) BEGINS
STA 143+94.1

F III (12) ENDS
MP 3.376

F III (8) RESUMES
STA 174+89.9

NOTE: ANY FURTHER INFORMATION CONCERNING THESE PLANS SHOULD BE OBTAINED FROM THE DISTRICT ENGINEER, VERMONT DEPARTMENT OF HIGHWAYS, 100 STATE STREET, MONTPELIER, VERMONT 05602.

LEGEND

- COUNTY LINE
- TOWN LINE
- FERME LINE
- STONE WALL
- UNDEVELOPED
- RAILROAD
- UNIMPROVED ROAD
- ROAD
- TRAIL
- POW. LINE
- TELE. LINE
- TRAIL
- RAILROAD

SCALE 1" = 400'

TITLE 1" = 400'

TYPICAL 5" = 8'

PLAN 1" = 50'

PROFILE HORIZONTAL 1" = 60'

VERTICAL 1" = 10'

CROSS-SECTIONS 1" = 6'

APPROVED: *[Signature]* DATE: MAY 28, 1956

APPROVED: *[Signature]* DATE: MAY 28, 1956

APPROVED: *[Signature]* DATE: MAY 1, 1956

APPROVED: *[Signature]* DATE: MAY 1, 1956

APPROVED: *[Signature]* DATE: JUNE 1, 1956

THESE PLANS ARE SUBJECT TO SUCH REVISIONS AS MAY BE REQUIRED BY THE BUREAU OF PUBLIC ROADS OR THE COMMISSIONER OF HIGHWAYS.

CONSTRUCTION IS TO BE CARRIED ON IN ACCORDANCE WITH THE PLANS AND THE STANDARD SPECIFICATIONS FOR HIGHWAY AND BRIDGE CONSTRUCTION OF JANUARY 1956, SUBMITTED TO THE BUREAU OF PUBLIC ROADS FOR APPROVAL ON APRIL 9, 1956, INCLUDING ALL SUBSEQUENT APPROVED REVISIONS AND SUCH REVISIONS, SPECIFICATIONS AND SPECIAL PROVISIONS AS ARE SUBMITTED WITH THE PLANS.

Pin # 99R567

DEPARTMENT OF COMMERCE
BUREAU OF PUBLIC ROADS

APPROVED: *[Signature]*

DISTRICT ENGINEER

PROJECT: F III (8), (12)

SHEET 1 OF 79

STEARNES R. JENKINS