

INDEX OF SHEETS

SHEET NO.	TITLE	PAGE
1	TYPICAL CROSS-SECTION OF IMPROVEMENT BITUMINOUS CONCRETE PAVEMENT AND QUANTITY SHEET	1
2	TYPICAL CROSS-SECTION OF IMPROVEMENT BITUMINOUS CONCRETE PAVEMENT AND QUANTITY SHEET	2

PROJECT NAME & NUMBER	TYPE	PAVEMENT AREA
NEWBURY F 026-1(5)	3" BITUMINOUS CONCRETE PAVEMENT	24,761 S.Y.
RECORD PLANS MATERIALS		
BIT. MATERIAL: TRIMOUNT BITUMINOUS PRODUCTS, EVERETT, MASS. CUTBACK ASPHALT: ESSO, EVERETT, MASS. REFINED TAR: KOPPERS CO., EVERETT, MASS.		
CONTRACTOR: L.M. PIKE & SON, INC., LACONIA, N.H.		CONTRACT: JULY 31, 1959
RESIDENT ENGINEER: C.C. HELFRICH		STARTED: AUG. 12, 1959
RECORD PLANS: WASHBURN		COMPLETED: NOV. 3, 1959
		ACCEPTED: NOV. 3, 1959

STATE OF VERMONT  
DEPARTMENT OF HIGHWAYS

PROPOSED IMPROVEMENT

FEDERAL AID PROJECT

TOWN OF NEWBURY

COUNTY OF ORANGE

U.S. ROUTE 302

BARRE - WELLS RIVER ROAD

BEGINNING AT A POINT APPROXIMATELY 1,236 FEET  
SOUTHEAST OF THE RYEGATE - NEWBURY TOWN  
LINE AND EXTENDING SOUTHEASTERLY 9,285.3 FEET.

LENGTH OF PROJECT 9,285.3 FEET = 1.758 MILES

DESIGN DESIGNATION  
ADT 1958 800-985  
ADT 1980 1300-2800  
V 60 M.P.H.

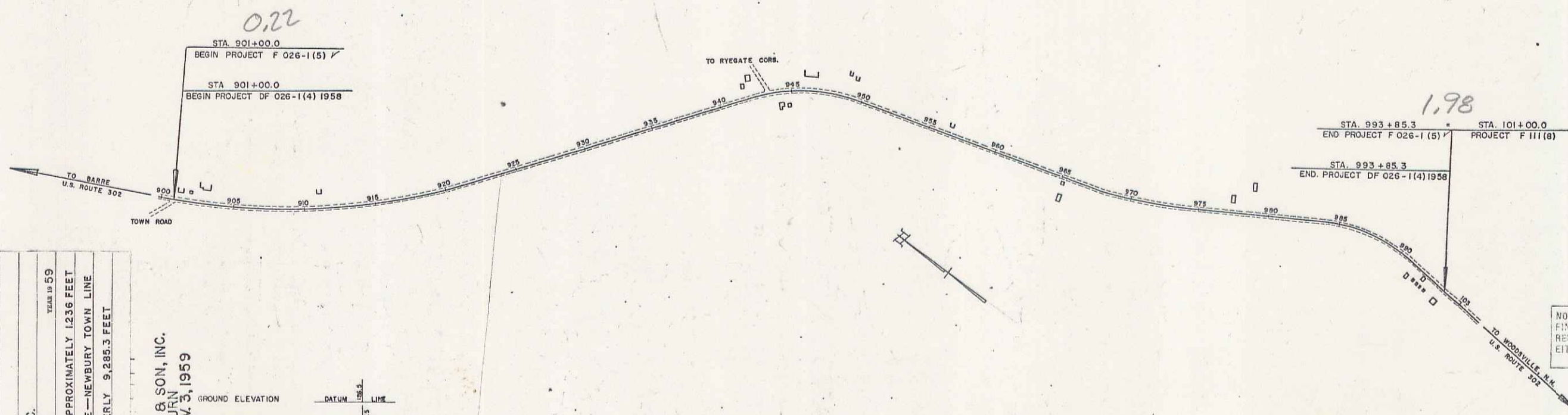
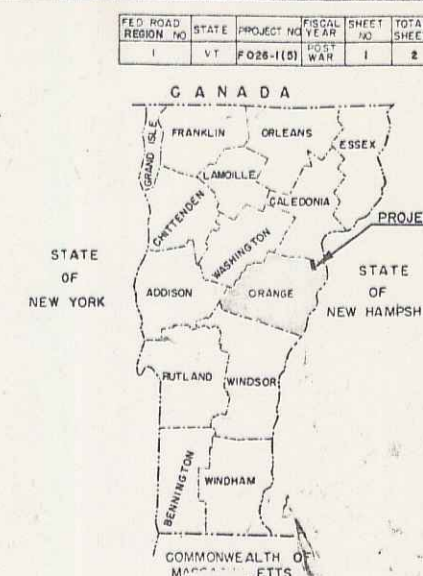
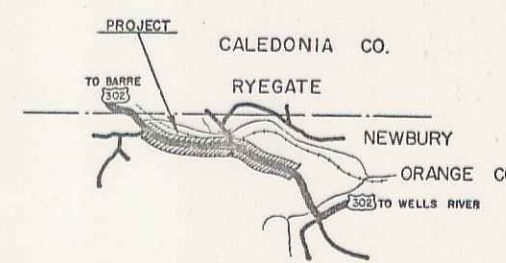

COUNTY	NEWBURY
TOWN	NEWBURY
FENCE	LI
STONE	W
URFENCE	GUARD R
TRAVEL	RAILROAD
RETAIN	CENTER
SURVEY	GULVERT
DROP	TRIGLLET
POWER	TELEPHO
TREES	HEDGE

CONTRACTOR: L.M. PIKE & SON, INC.  
LACONIA, N.H.  
LOCATION BEGINNING AT A POINT APPROXIMATELY 1,236 FEET  
SOUTHEAST OF THE RYEGATE - NEWBURY TOWN LINE  
AND EXTENDING SOUTHEASTERLY 9,285.3 FEET

GROUND ELEVATION	DATUM	LINE
GRADE ELEVATION	DATUM	REF. LINE

TITLE	SCALE
TYPICAL	1" = 400'
PLAN	1" = 200'
PROFILE	HORIZONTAL 1" = 100'
VERTICAL	1" = 10'
CROSS-SECTIONS	1" = 10'

CURVE DATA	DEFLECTION OF ANGLE	DEGREE OF CURVE	RADIUS OF CURVE	TANGENT DISTANCE	LENGTH OF CURVE	EXTERNAL DISTANCE	POINT OF INTERSECTION	POINT OF CURVE	POINT OF TANGENT	POINT ON TANGENT	POINT ON SUB-TANGENT
Δ	D	R	T	L	E	P.I.	P.C.	P.T.	P.O.T.	POST	

THESE PLANS ARE SUBJECT TO SUCH REVISIONS AS MAY BE  
REQUIRED BY THE BUREAU OF PUBLIC ROADS OR THE COMMISSIONER  
OF HIGHWAYS.

CONSTRUCTION IS TO BE CARRIED ON IN ACCORDANCE WITH  
THE PLANS AND THE STANDARD SPECIFICATIONS FOR HIGHWAY AND BRIDGE  
CONSTRUCTION OF JANUARY 1956 SUBMITTED TO THE BUREAU OF  
PUBLIC ROADS AS APPROVED JULY 5, 1956, INCLUDING ALL SUBSEQUENT  
APPROVED REVISIONS AND SUCH REVISED SPECIFICATIONS AND SPECIAL  
PROVISIONS AS ARE SUBMITTED WITH THE PLANS.

DEPARTMENT OF COMMERCE BUREAU OF PUBLIC ROADS	
APPROVED	DATE
DIVISION ENGINEER	DATE
PROJECT F NO. 026-1(5)	SHEET 1 OF 2 SHEETS

APPROVED SECONDARY ENGINEER DATE	APPROVED CONSTRUCTION ENGINEER DATE June 29, 1959	APPROVED BRIDGE ENGINEER DATE	APPROVED DISTRICT ENGINEER DATE June 29, 1959	APPROVED HIGHWAY ENGINEER DATE June 29, 1959	APPROVED DATE June 29, 1959 SUBMITTED BY ORDER OF THE STATE HIGHWAY BOARD
--	---	-------------------------------------	---	--	---