

INDEX OF SHEETS

SHEET NO. 1	TITLE PAGE
" 2	TYPICAL CROSS-SECTION OF IMPROVEMENT } GRAVEL MIXED IN
" 3	BANKING AND WIDENING TABLES } PLACE SURFACE COURSE
4-16	PLAN & PROFILE SHEETS
17	STANDARD STRUCTURE SHEET 5-28 PIPE CULVERTS
18	" " " 5-29 BOX CULVERTS
19	" " " 5-30 GUARD RAIL
20	STANDARD CULVERT SHEET 5C-1
21	BARRICADES, SIGNS & LIGHTS 5B-II
22-28	CROSS SECTIONS

Standard sheets 5-28, 5-29 & 5-30 submitted to the Chief Engineer on May 16, 1933.

(To Be Returned to R.O.W. Division)
 TOWN OF GROTON
 PERPETUAL
 RIGHT-OF-WAY DIVISION

STATE OF VERMONT
 STATE HIGHWAY DEPARTMENT

PLAN AND PROFILE OF PROPOSED
 STATE HIGHWAY

FEDERAL AID PROJECT

TOWNS OF RYEGATE-GROTON
 WELLS RIVER-BARRE ROAD

Pin # 992562

FEET WEST OF 8X5 STONE BOX CULVERT NEAR SO. RYEGATE VILLAGE LINE WESTERLY 3355 FEET TO A POINT 625 FEET BEYOND SCHOOL IN GROTON VILLAGE

LENGTH OF PROJECT = 17,7194 FEET = 3.355 MILES

FED. ROAD DIST. NO.	STATE	FED. AID PROJ. NO.	FISCAL YEAR	SHEET NO.	TOTAL SHEETS
9	VT.	E-III-B	1933	1	22

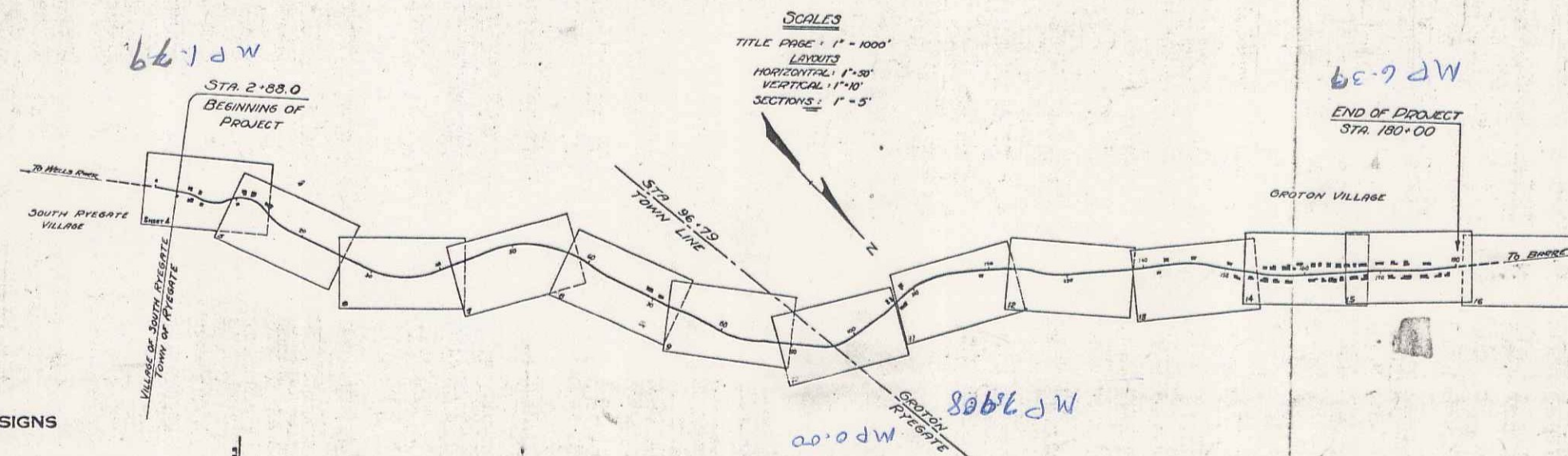
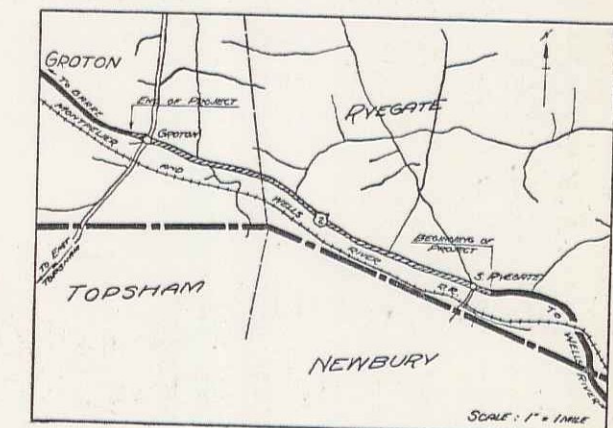

CONVENTIONAL SIGNS

COUNTY LINE	GROUND ELEVATION	DATE	LINE
TOWN LINE	GRADE ELEVATION	DATE	LINE
FENCE LINE			
STONE WALL			
UNFENCED PROPERTY			
GUARD RAIL			
TRAVELED WAY			
RAILROAD			
RETAINING WALL			
CENTER LINE			
SURVEY LINE			
CULVERT			
DROP INLET			
TROLLEY POLE			
POWER POLE			
TELEPHONE POLE			
TREES			
HEDGE			

CURVE DATA	
DEFLECTION ANGLE	Δ
DEGREE OF CURVE	D
RADIUS OF CURVE	R
TANGENT DISTANCE	T
LENGTH OF CURVE	L
EXTERNAL DISTANCE	E
POINT OF INTERSECTION	P. I.
POINT OF CURVE	P. C.
POINT OF TANGENT	P. T.
POINT ON TANGENT	P. O. T.

These plans are subject to such revisions as may be required by the Bureau of Public Roads, or the Commissioner of Highways. Construction is to be carried on in accordance with the Standard Road & Bridge Specifications of 1930, with such revised Specifications and special provisions as are submitted with these plans.

APPROVED: June 19, 1933
 H. E. August
 COMMISSIONER OF HIGHWAYS
 SUBMITTED BY ORDER OF THE STATE HIGHWAY BOARD

RECOMMENDED: [Signature]
 DISTRICT ENGINEER BUREAU OF PUBLIC ROADS
 RECOMMENDED FOR APPROVAL: [Signature]
 CHIEF ENGINEER BUREAU OF PUBLIC ROADS
 APPROVED: [Signature]
 DIRECTOR BUREAU OF PUBLIC ROADS

R/O US 302
 Project No. F.E-III-B

CORRECTED: June 18, 1933
 ROAD ENGINEER
 SERIES F. No. E-III-B FILED
 SHEET 1 OF 22