

GUARD RAIL REQUIRED

ON LEFT

Sta 228+65 to 228+85	Length 20 ft
228+85 to 229+05	20 "
229+05 to 229+25	20 "
229+25 to 229+45	20 "
229+45 to 229+65	20 "
229+65 to 229+85	20 "
229+85 to 230+05	20 "

ON RIGHT

Sta 228+85 to 229+05	Length 20 ft
229+05 to 229+25	20 "
229+25 to 229+45	20 "
229+45 to 229+65	20 "
229+65 to 229+85	20 "
229+85 to 230+05	20 "

TOTAL THIS SHEET 1004.71

NEW CULVERTS REQUIRED

Sta 228+77	16" Cor. I. P.	34 ft
1-2-5	Concrete	733 cu yds
Sta 236+82	2x2' Concrete Culvert with Drop Inlet	
1-2-4	Concrete	156 cu yds
1-2-5	Concrete	782 "
Sta 239+09	3'x3' Reinforced Concrete Culvert	
1-2-4	Concrete	458 cu yds
1-2-5	Concrete	978 "
	Reinforcing Steel	186 lbs.
Sta 239+50	16" Cor. I. P.	38 ft
1-2-5	Concrete	10 cu yds

CULVERT REPAIRS REQUIRED

Sta 242+03 16" Cor. I. P. Extend 6/4
1-2-5 Concrete 15 cu yds

RELAYING PIPE CULVERTS

SUB BASE REQUIRED

Sta 220+00 to 230+75 Length 215 ft.

FED. ROAD DIST. NO.	STATE	FED. AID PROJ. NO.	YEAR	CONTRACT NO.	SHEET NO.
3	V7	32	1921	16	63

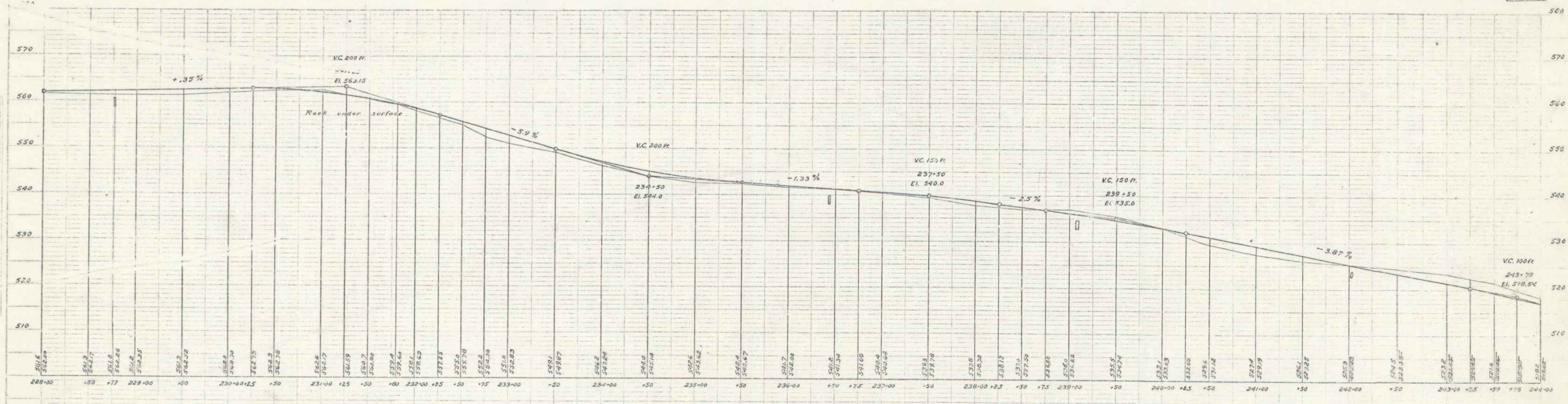
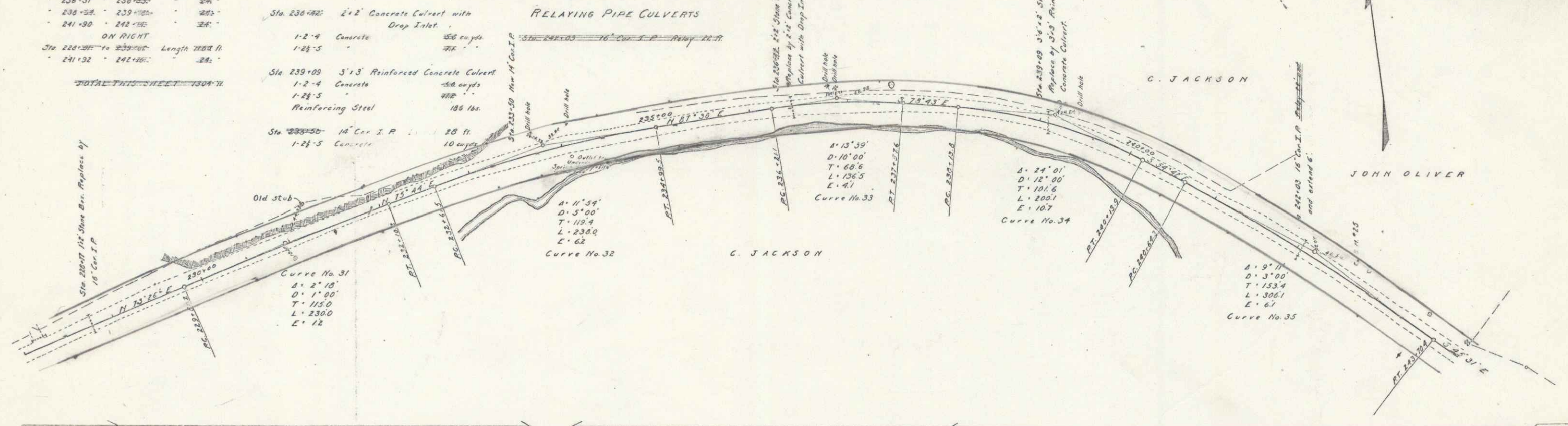

E. J. JACKSON
 A. C. JACKSON
 C. JACKSON
 JOHN OLIVER