

ON LEFT				ON RIGHT			
Sta 214+03 to 214+27	Length 24 ft.	Sta 214+03 to 214+27	Length 24 ft. 27"	Sta 214+03 to 214+27	Length 24 ft. 27"	Sta 214+03 to 214+27	Length 24 ft. 27"
215+26	215+28 1/2	216+22	216+23 1/2	218+02	218+03 1/2	219+09	219+10 1/2
218+02	218+03 1/2	220+62	220+63 1/2	221+62	221+63 1/2	224+98	224+99 1/2

NEW CULVERTS REQUIRED		
Sta 214+15	12' Con. I. P.	28 ft.
	1-2 1/2-5 Concrete	10 cu yds.
Sta 215+38	12' Con. I. P.	28 ft.
	1-2 1/2-5 Concrete	10 cu yds.
Sta 218+34	12' Con. I. P.	30 ft.
	1-2 1/2-5 Concrete	10 cu yds.
Sta 220+01	12' Con. I. P.	34 ft.
	1-2 1/2-5 Concrete	17 3/4 cu yds.
Sta 221+745	12' Con. I. P.	32 ft.
	1-2 1/2-5 Concrete	17 3/4 cu yds.
Sta 225+10	16' Con. I. P.	32 ft.
	1-2 1/2-5 Concrete	15 cu yds.

SUB BASE REQUIRED		
Sta 221+745 to 225+00	Length 322 ft.	7 1/2' - 4'

FED. ROAD DIST. NO.	STATE	FED. AID DIST. NO.	PROJECT NO.	SHEET NO.
0	VT	32	1921	17

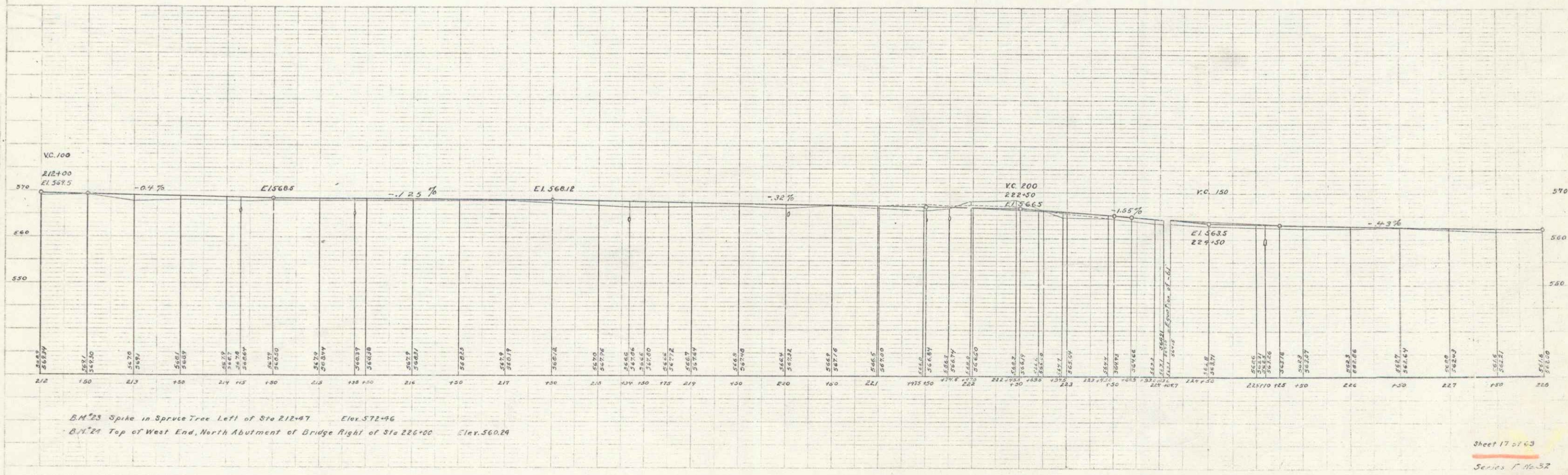
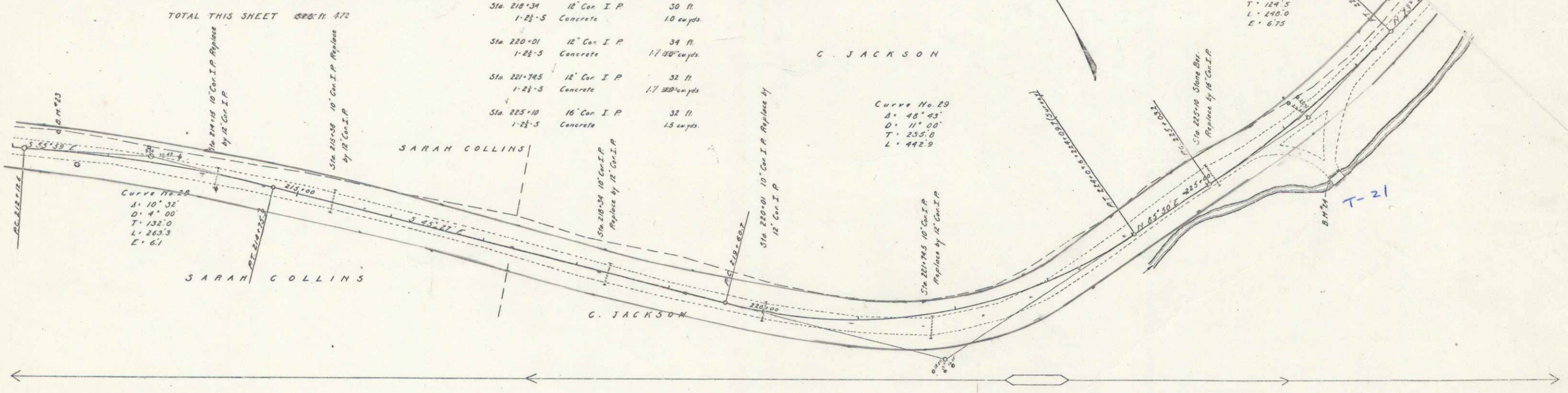

BM 25 Spike in Spruce Tree Left of Sta 212+47 Elev. 572+96  
 B.M. 21 Top of West End, North Abutment of Bridge Right of Sta 226+00 Elev. 560+24