

**GUARD RAIL REQUIRED ON LEFT**

Sta 201+00 to 201+32 Length 32 ft  
 201+17 - 201+27 40'  
 200+84 - 200+105 21'

**ON RIGHT**

Sta 201+19 to 201+32 Length 13 ft  
 201+00 - 201+27 28'  
 200+84 - 200+105 21'

**TOTAL THIS SHEET 224 ft 173**

**NEW CULVERTS REQUIRED**

Sta 201+26 16" Con. I. P. with Drop Inlet 34 ft  
 1-2 1/2 - 5 Concrete 1.7 1/2 cu yds.

Sta 200+96 16" Con. I. P. 32 ft  
 1-2 1/2 - 5 Concrete 1.1 1/2 cu yds.

**SUB. BASE REQUIRED**

Sta 197+00 to 200+25 Length 325 ft 2 1/2"

PER ROAD DIST. PD.	STATE	DESIGN YEAR	DESIGN SPEED	DESIGN TYPE
3	VT	1927	16	28

E. P. Smith  
 F. L. Erickson  
 J. H. ...  
 ...  
 ...

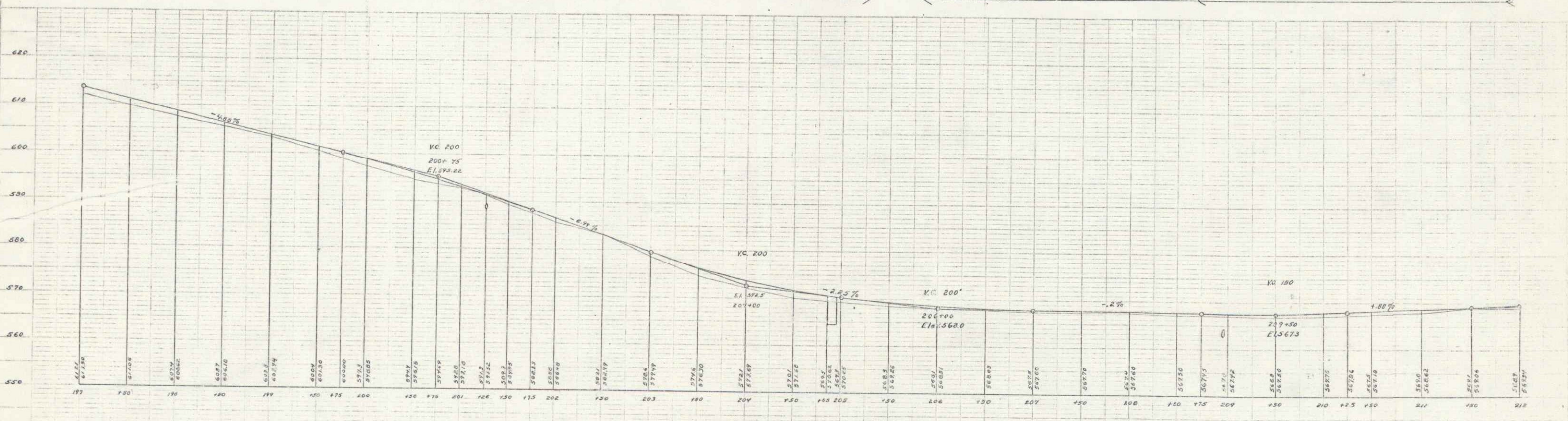
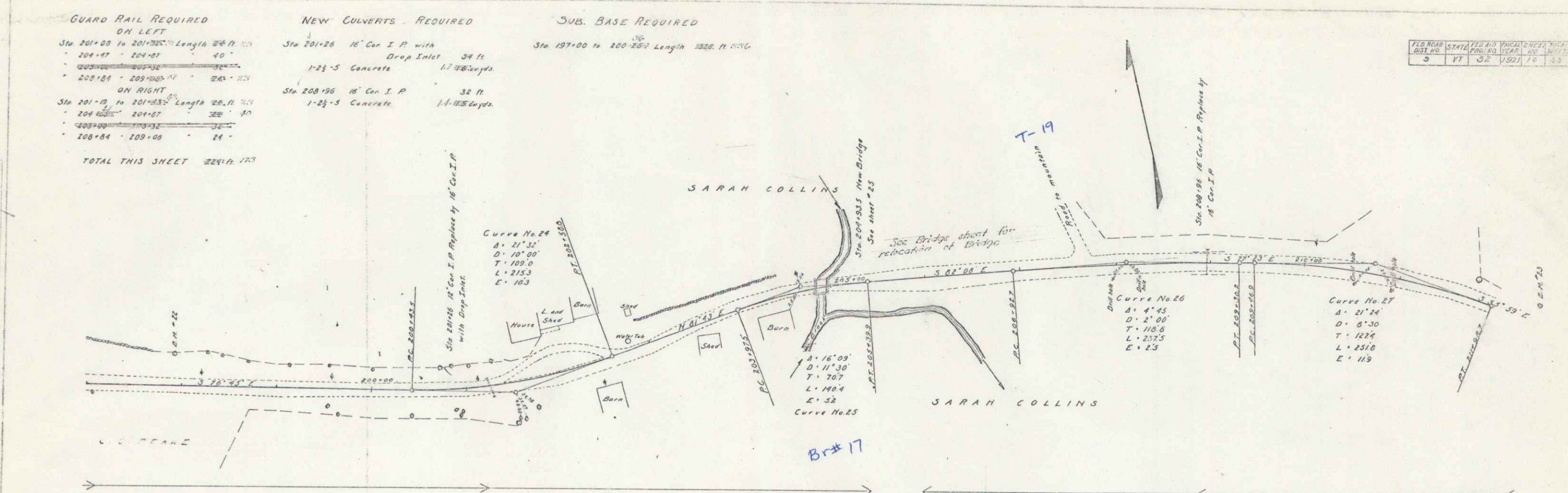

B.M. 22 Spike in Elm Tree Left of Sta. 197+33 Elev. 610.19