

NEW CULVERTS REQUIRED + A Replacement
 STA 92+32 15" Rein. Conc. Pipe Length 36 ft
 Concrete Class B (1500-5) Sp. 40 yds. 7.1
 Reinf. Steel - #1 @ 18" 1-2-4

CULVERT REPAIRS REQUIRED
 STA 94+00 Extensions of current rubble masonry length to be determined by the engineer
 Concrete rubble required, 20 cu yds. 4-0.7
 STA 10+125 Cement rubble masonry extension on left length 55 ft
 Concrete rubble required, 20 cu yds. 6.7

CURVE # 21
 Δ 0° 05' LT
 D 22° 30'
 R 2292.0
 T 161.9
 L 323.3
 E 5.7

WOOD GUARD RAIL REQUIRED
 RIGHT
 STA 92+23-92+37 Length 24 ft
 104+63-104+87 Length 24 ft

CABLE GUARD RAIL REQUIRED
 LEFT
 STA 92+00-101+00 Length 100 ft
 RIGHT
 STA 98+22-102+00 Length 432 ft
 STA 92+00-95+00 Long 300 ft

CURVE # 22
 Δ 39° 36' LT
 D 15°
 R 322.0
 T 137.5
 L 264.0
 E 21.0

FOR ROAD STATE ILLINOIS DIST. NO. 3 COUNTY FRAD 1926 16 43

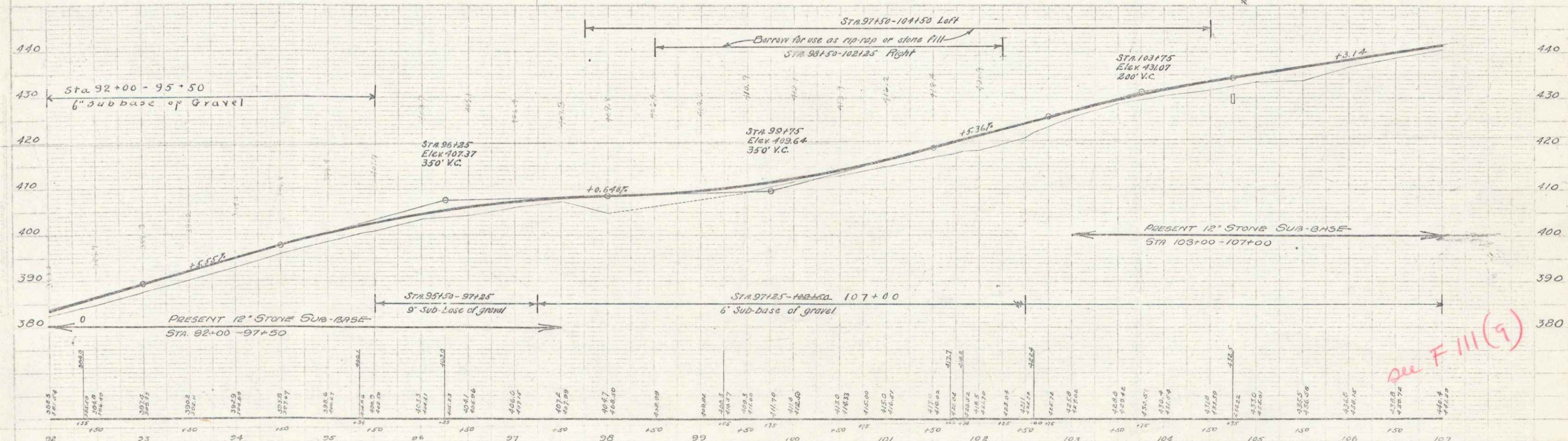
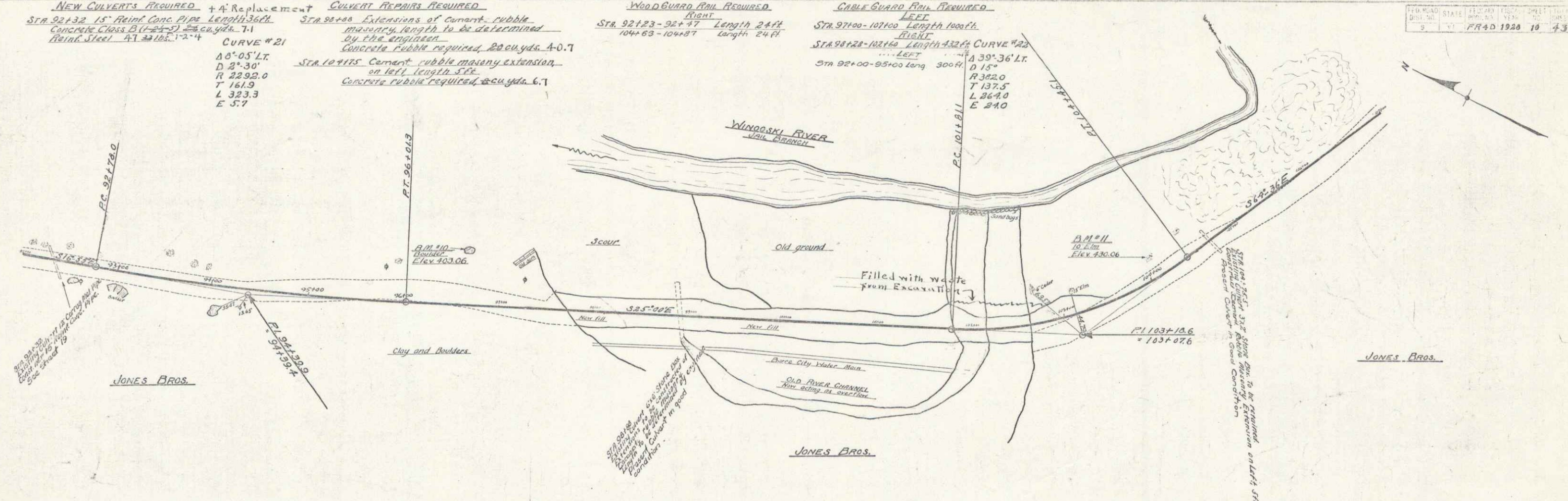

B.M. #10 Boulder, 56' Lx Sta. 96+63, Elev. 403.06
 B.M. #11 Spike in trunk of 18' Elm, 15' Lx Sta. 104+07, Elev. 430.06

SERIES FR No. 4D
 SHEET 10 OF 43