

- BRIDGE**  
 Sta. 53+30 - 56+03 (Face to face of abutments)  
 53+28.5 - 56+04.5 (Length over all)
- Sheets to be Used**
- |                 |   |
|-----------------|---|
| SHEET 14 Series | S.B. No. 35 (2 Soans) Square                          |
| 15              | S.B. No. 2 Typical Details                            |
| 16              | S.B. No. 5 Cable Rail                                 |
| 17              | S.A. No. 10 Height T Beam with Piles                  |
| 18              | S.P. No. 1 Standard Pier with Piles - 13' high T Beam |

**Summary of Quantities**

Item 15 - Structure Excavation	900 Cu Yds. 3.67
34A - Concrete Class A (1:2:4)	226 Cu Yds. 83.2
34B - Concrete Class B (1:2:5)	265 Cu Yds. 357.1
35 - Reinforcing Steel	29,150 Lbs. 23.52
36 - Timber Piling	2,450 Lin. Ft.
62 - Rip-rap for Bank Protection	175 Cu Yds.
Rip-rap built as Stone Fill	
Length of Piles 25' 0" for Estimating Purposes Only	
74 - 4 yds. Special Structure Excavation	

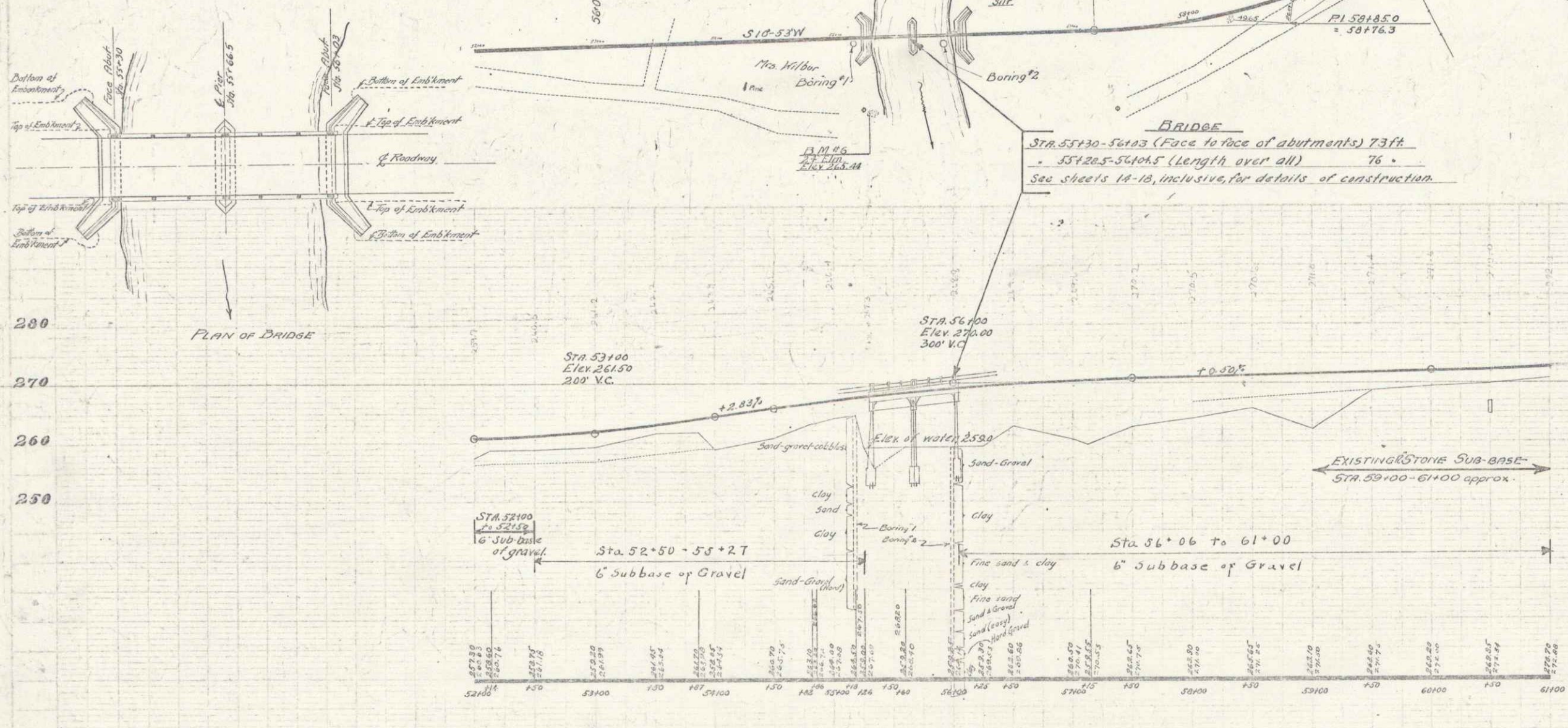

B.M. #6 Spike in 24' Elm, 61 ft Rt. Sta. 53+30 Elev 268.44

SEE BP 026-1-7101

6