

**CABLE GUARD RAIL REQUIRED**  
 ON RIGHT  
 STA. 0+00 - 8+00 800 LINEAR FEET.  
 STA. 12+00 - 13+00 100 LINEAR FEET.  
 TOTAL FOR SHEET 900 LINEAR FEET.

**WOOD GUARD RAIL REQUIRED**  
 ON LEFT  
 1+38 - 1+62 24 LINEAR FEET.  
 3+38 - 3+62 24 LINEAR FEET.  
 6+48 - 6+72 24 LINEAR FEET.  
 7+73 - 7+97 24 LINEAR FEET.  
 8+38 - 9+62 24 LINEAR FEET.  
 ON RIGHT  
 9+38 - 9+62 24 LINEAR FEET.  
 TOTAL FOR SHEET 144 LINEAR FEET.

**NEW CULVERTS REQUIRED**  
 STA. 1+50 24" REINFORCED CONCRETE PIPE LENGTH 32 FT. WITH DI. CONCRETE CLASS A (1-2-4) 5.33 CU YDS. REINFORCING STEEL 134.23 LBS.  
 STA. 3+50 4"x2 3/4" CONCRETE BOX CONCRETE CLASS A (1-2-4) 22.4189 CU YDS. REINFORCING STEEL 1175.7249 LBS.  
 STA. 6+58 24" REINFORCED CONCRETE PIPE LENGTH 32 FT. CONCRETE CLASS A (1-2-4) 3.6388 CU YDS. REINFORCING STEEL 59.8480 LBS.  
 STA. 7+85 24" REINFORCED CONCRETE PIPE LENGTH 32.0 FT. CONCRETE CLASS A (1-2-4) 3.1300 CU YDS. REINFORCING STEEL 57.1880 LBS.  
 STA. 9+58 18" REINFORCED CONCRETE PIPE LENGTH 32.0 FT. CONCRETE CLASS A (1-2-4) 1.1723 CU YDS. REINFORCING STEEL 41.5400 LBS.

REVISIONS  
 1. 11/15/28  
 2. 11/15/28  
 3. 11/15/28  
 4. 11/15/28  
 5. 11/15/28  
 6. 11/15/28  
 7. 11/15/28  
 8. 11/15/28  
 9. 11/15/28  
 10. 11/15/28  
 11. 11/15/28  
 12. 11/15/28  
 13. 11/15/28  
 14. 11/15/28  
 15. 11/15/28  
 16. 11/15/28  
 17. 11/15/28  
 18. 11/15/28  
 19. 11/15/28  
 20. 11/15/28  
 21. 11/15/28  
 22. 11/15/28  
 23. 11/15/28  
 24. 11/15/28  
 25. 11/15/28  
 26. 11/15/28  
 27. 11/15/28  
 28. 11/15/28  
 29. 11/15/28  
 30. 11/15/28  
 31. 11/15/28  
 32. 11/15/28  
 33. 11/15/28  
 34. 11/15/28  
 35. 11/15/28  
 36. 11/15/28  
 37. 11/15/28  
 38. 11/15/28  
 39. 11/15/28  
 40. 11/15/28  
 41. 11/15/28  
 42. 11/15/28  
 43. 11/15/28  
 44. 11/15/28  
 45. 11/15/28  
 46. 11/15/28  
 47. 11/15/28  
 48. 11/15/28  
 49. 11/15/28  
 50. 11/15/28  
 51. 11/15/28  
 52. 11/15/28  
 53. 11/15/28  
 54. 11/15/28  
 55. 11/15/28  
 56. 11/15/28  
 57. 11/15/28  
 58. 11/15/28  
 59. 11/15/28  
 60. 11/15/28  
 61. 11/15/28  
 62. 11/15/28  
 63. 11/15/28  
 64. 11/15/28  
 65. 11/15/28  
 66. 11/15/28  
 67. 11/15/28  
 68. 11/15/28  
 69. 11/15/28  
 70. 11/15/28  
 71. 11/15/28  
 72. 11/15/28  
 73. 11/15/28  
 74. 11/15/28  
 75. 11/15/28  
 76. 11/15/28  
 77. 11/15/28  
 78. 11/15/28  
 79. 11/15/28  
 80. 11/15/28  
 81. 11/15/28  
 82. 11/15/28  
 83. 11/15/28  
 84. 11/15/28  
 85. 11/15/28  
 86. 11/15/28  
 87. 11/15/28  
 88. 11/15/28  
 89. 11/15/28  
 90. 11/15/28  
 91. 11/15/28  
 92. 11/15/28  
 93. 11/15/28  
 94. 11/15/28  
 95. 11/15/28  
 96. 11/15/28  
 97. 11/15/28  
 98. 11/15/28  
 99. 11/15/28  
 100. 11/15/28

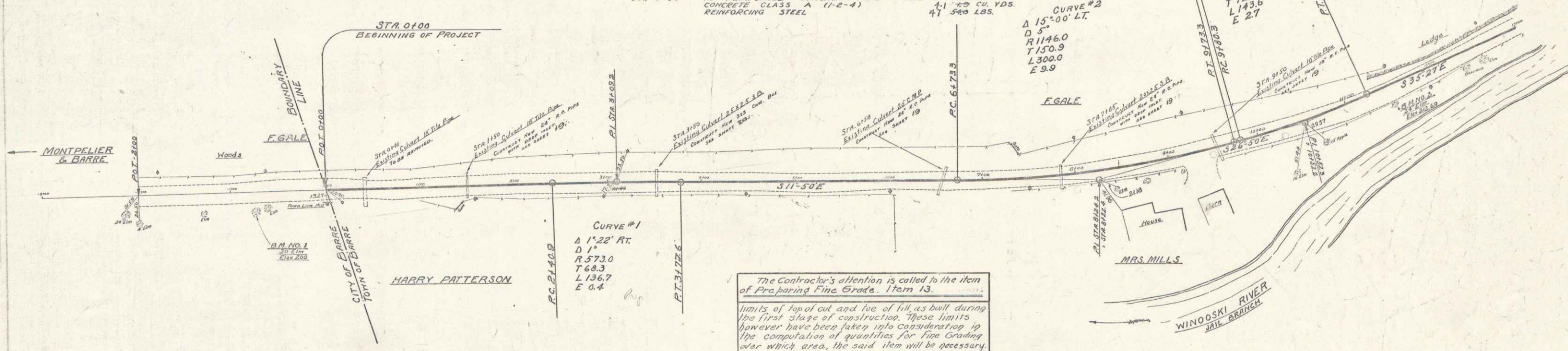

The Contractor's attention is called to the item of preparing Fine Grade, Item 13.  
 limits of top of cut and toe of fill as built during the first stage of construction. These limits however have been taken into consideration in the computation of quantities for Fine Grading over which area, the said item will be necessary.

GRADE ELEVATIONS AS GIVEN ON PROFILE AND BATHWORK SHEETS ARE FOR FINISHED GRADE OF CONCRETE PAVEMENT

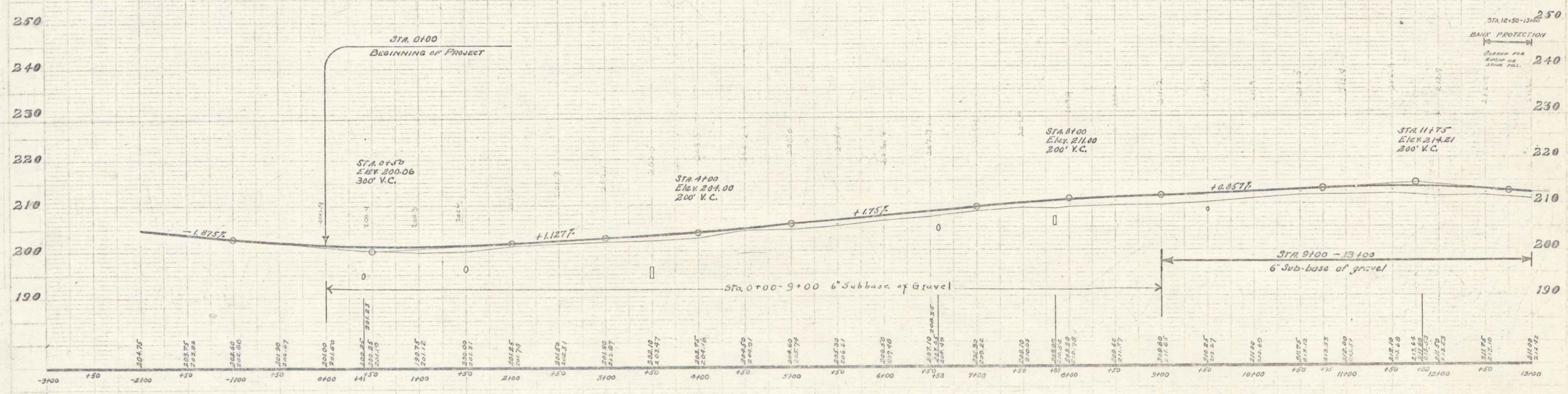

B.M. #1 Spike in trunk of 20 Elm, 17' RI Sta-1126. Elev. 200.00  
 B.M. #2 . . . . . 24 . . . . . 11148 . . . . . 212.69

SERIES FR. No. 10  
 SHEET 3 OF 43