

INDEX OF SHEETS

SHEET NO.	TITLE PAGE	STAGE CONSTRUCTION
2	TYPICAL CROSS-SECTIONS OF IMPROVEMENT	ONE COURSE CEMENT CONCRETE PAVEMENT, TYPE B.
3	PLAN AND PROFILE STA. -3100-13100	
4	13100-27100	
5	27100-40100	
6	40100-52100	
7	52100-61100	
8	61100-76100	
9	76100-92100	
10	92100-107100	
11	107100-121100	
12	121100-133100	
13	133100-	
14	Series S.T.B. 20, No. 35' (3 Spans) Square.	
15	S.B. No. 2 Typical Details.	
16	S.B. No. 5 Cable Rail.	
17	S.A.G. No. 10' Height T Beam with Piles.	
18	S.P. No. 1 Standard Pier with Piles - 13' high T Beam.	
19	STANDARD STRUCTURE SHEET, S-17.	
20	S-18.	
21	S-19.	
22-43	Cross Sections.	

STATE OF VERMONT  
STATE HIGHWAY DEPARTMENT

PLAN AND PROFILE OF PROPOSED  
STATE HIGHWAY

FLOOD RELIEF PROJECT

**TOWN OF BARRE**

Pin# 99R551

**BARRE • WELLS RIVER ROAD**

FROM THE BARRE CITY LINE EASTERLY 2.537 MILES TO EAST BARRE VILLAGE

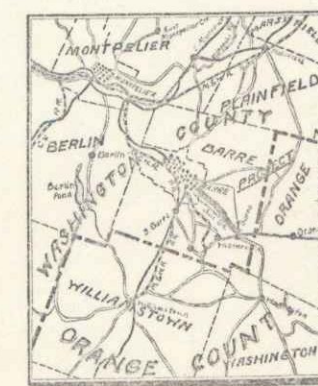

LENGTH OF PROJECT

INCLUDING BRIDGES OVER 20 FT SPAN 13,324.0 FT. - 2.537 MILES  
EXCLUDING BRIDGES OVER 20 FT SPAN 13,324.0 FT. - 2.523 MILES

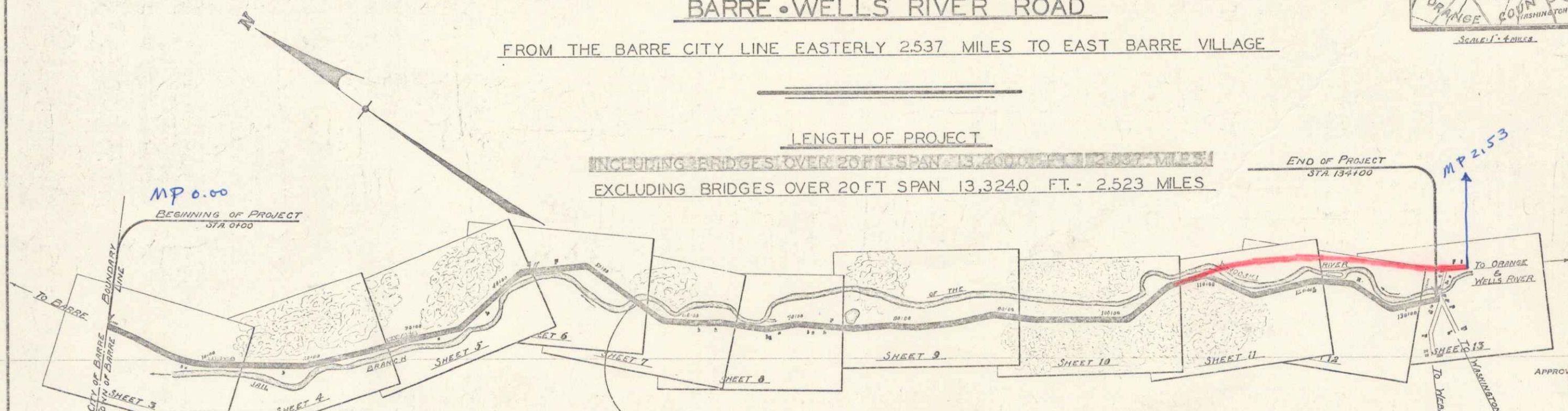

SYMBOL	DESCRIPTION
[Symbol]	COUNTY LINE
[Symbol]	TOWN LINE
[Symbol]	FENCE LINE
[Symbol]	STONE WALL
[Symbol]	UNFENCED PI
[Symbol]	GUARD RAIL
[Symbol]	TRAVELED W/ RAILROAD
[Symbol]	RETAINING W/ CENTER LINE
[Symbol]	SURVEY LINE
[Symbol]	CULVERT
[Symbol]	DROP INLET
[Symbol]	TROLLEY POL
[Symbol]	POWER POLE
[Symbol]	TELEPHONE P
[Symbol]	TREES
[Symbol]	HEDGE

BRIDGE STA. 35+30-36+09  
See sheets 14-18 for details of construction

RECORD PLANS

Rte US 302

NOTE  
Some construction work has been done on this project since the survey was made; therefore the earthwork quantities given are approximate only.

SCALES  
PLAN: 3/32" = 1' HORIZ. 3/32" = 1' VERT.  
PROFILE: 1" = 10' VERT. 1" = 100' HORIZ.  
CROSS SECTIONS: 3/32" = 1' HORIZ.

NOTE  
These plans subject to such revisions as may be required by the Bureau of Public Roads or the Chief Engineer.  
This project to be constructed in accordance with standard specifications on file with the U.S. Bureau of Public Roads as approved July 7, 1926.

APPROVED: July 20, 1928  
H. E. Langford  
CHIEF ENGINEER  
SUBMITTED BY ORDER OF THE STATE HIGHWAY BOARD  
J. B. Bell  
COMMISSIONER OF HIGHWAYS

RECOMMENDED  
DISTRICT ENGINEER BUREAU OF PUBLIC ROADS  
RECOMMENDED FOR APPROVAL  
CHIEF ENGINEER BUREAU OF PUBLIC ROADS  
APPROVED  
DIRECTOR BUREAU OF PUBLIC ROADS

Project No. F.R. 40

STEARNS R. JENKINS

US 302

SERIES F.R. No. 4-D FILED  
SHEET 1 OF 3