

PART OF THE LAND CONVEYED TO MERRILL LEGARE BY W.D. FROM HERBERT W. & JUNE M. JORGENSEN DATED OCT. 4, 1983 AND RECORDED IN BK. 49, PG. 250 OF THE TOWN OF BERLIN LAND RECORDS.

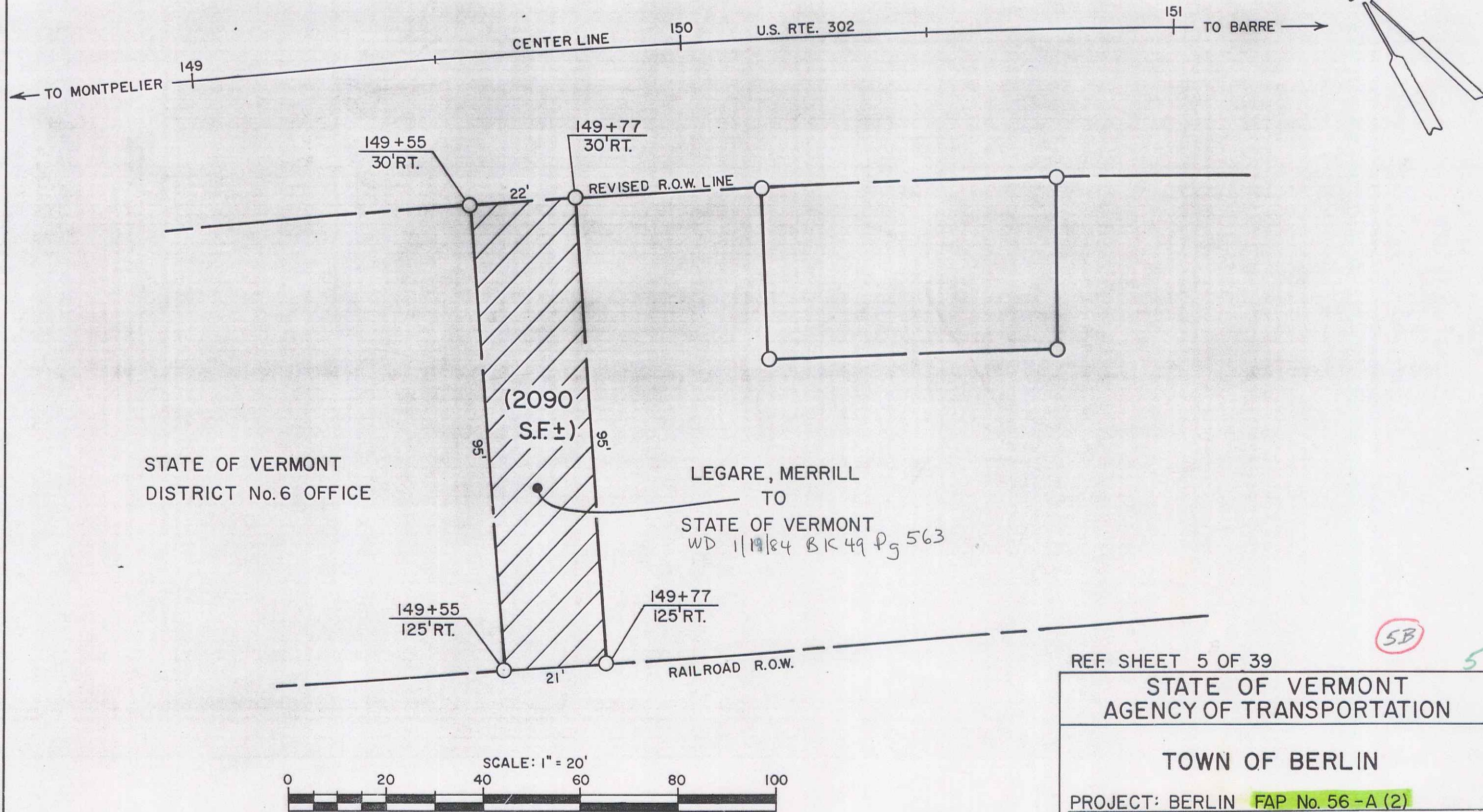

STATE OF VERMONT
DISTRICT No. 6 OFFICE

LEGARE, MERRILL
TO
STATE OF VERMONT
WD 11/19/84 BK 49 PG 563

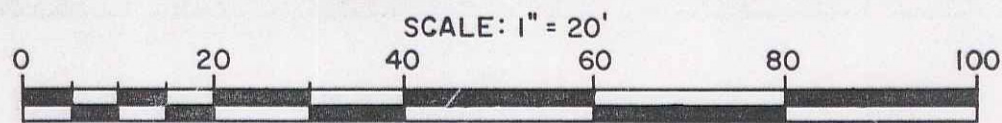

REF SHEET 5 OF 39

STATE OF VERMONT
AGENCY OF TRANSPORTATION

TOWN OF BERLIN

PROJECT: BERLIN FAP No. 56-A (2)

APPROX. SCALE 1" = 20' DATE 12-22-83 DRAWN BY DEM

SB 5