

INDEX OF SHEETS

- 1 Title Sheet
- 2 Typical Sheet
- 3 Drainage & Quantity Sheet
- 4 Blank
- 5-6 Plan Sheets
- 7-10 Culvert & Cross Sections
- 11 Cross Sections
- 12 Signal Plans & Detail
- 13 B-16 Division Island & Storage Lanes
- 14 B-71 Commercial Drives
- 15 C-1 Curb
- 16 D-3 Curb Drains
- 17 D-11 Gates, D.I.'s & Frames
- 18 Blank
- 19 E-1 Federal Aid Construction Ident Signs
- 20 E-6 On-Project Construction Signs
- 21 E-12 US Route Markers & Aux. Signs
- 22 E-13 State Route Markers & Aux. Signs
- 23 Blank
- 24 E-33 Traffic Control Signals

BERLIN TOPICS T 4303(4)
 RECORD PLANS
 MATERIALS
 BITUMINOUS CONCRETE PAVEMENT—COOLEY PLANT—
 BERLIN, VT.
 BITUMINOUS COLORED CONCRETE PAVEMENT—L.M. PIKE PLANT—BURLINGTON, VT.
 CONCRETE CLASS B—A.G. ANDERSON CO., INC.—BERLIN, VT.
 METAL PIPE CULVERT—NEW ENGLAND METAL CULVERT CO.—WHITE RIVER JCT., VT.
 GUARD RAIL—GRISWOLD FENCE CO., INC.—ESSEX JCT., VT.

12/14/71 TRAFFIC LIGHTS & SIGNS—STATE HIGHWAY SIGN SHOP STOCK
 4/20/71
 12/18/71 WORK DONE BY HIGHWAY DISTRICT NO. 6 FORCES
 12/16/71 RESIDENT ENGINEER—CHARLES J. CROSSETT.
 12/16/71 INSPECTOR—RAYMOND J. CYR.
 12/16/71 RECORD PLANS—A.G. SPIELE.

12/14/71 WORK STARTED—JULY 1972
 12/14/71 COMPLETED—NOVEMBER 9, 1973.
 12/11/71
 12/29/71

STATE OF VERMONT
 DEPARTMENT OF HIGHWAYS



PROPOSED IMPROVEMENT
 TOWN OF BERLIN
 COUNTY OF WASHINGTON

BARRE-MONTPELIER ROAD
 TRAFFIC OPERATION PROGRAM TO
 INCREASE CAPACITY AND SAFETY

Pin # 99R540

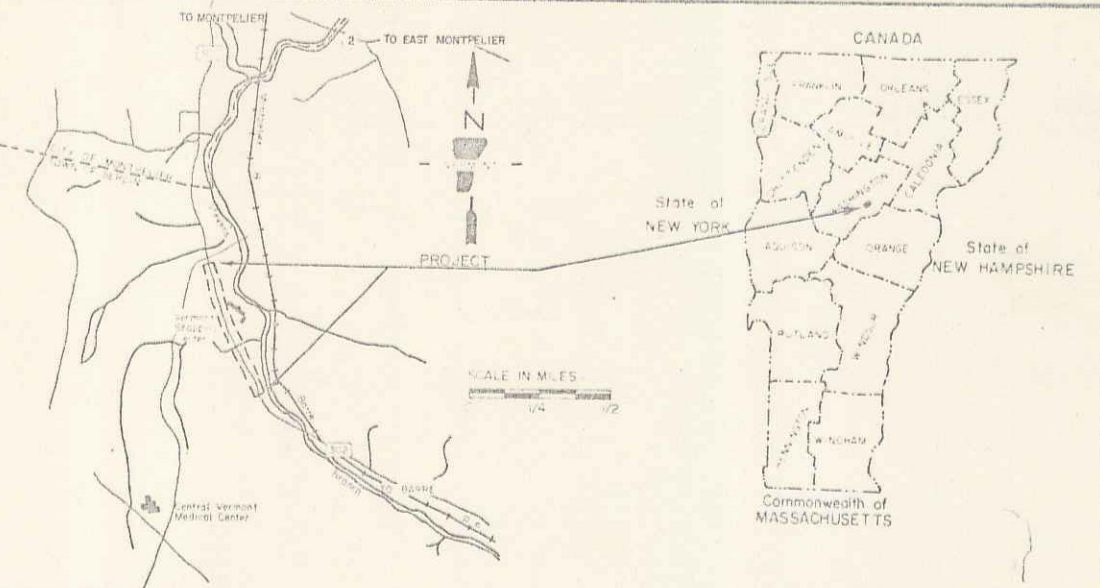

RIGHT-OF-WAY DIVISION
 TOWN FILE

PERPETUAL

R.G.
 Town of US 302
 (To Be Returned To R.O.W. Division)
 STATION 117+55.0
 END PROJECT T 4303(4)

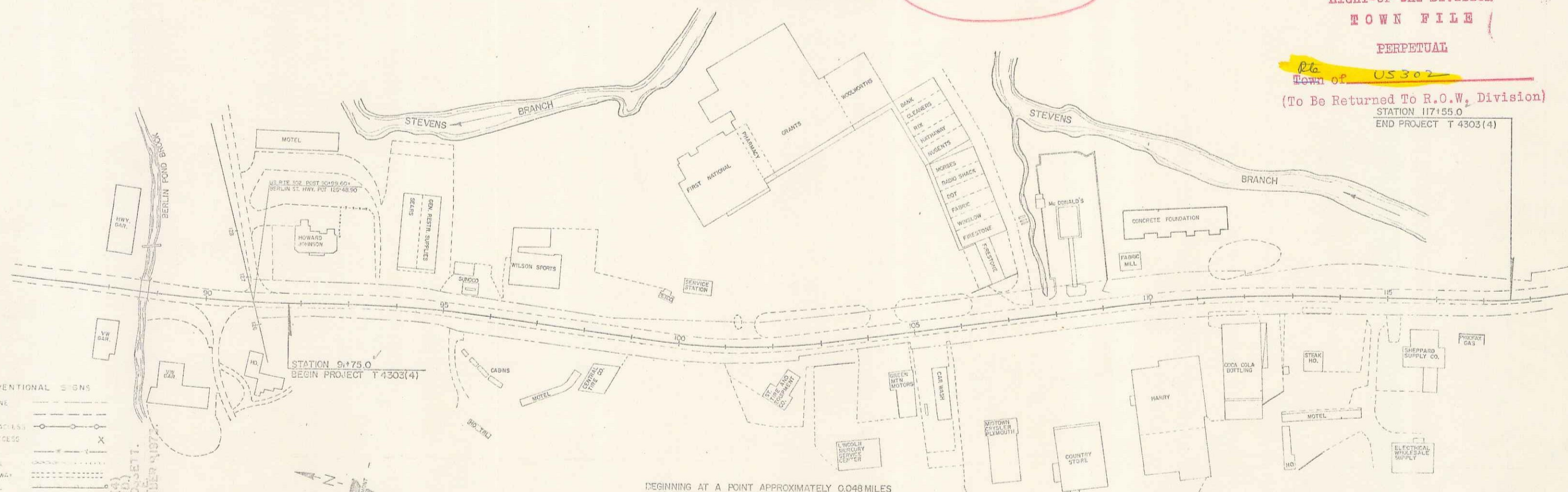

- CONVENTIONAL SIGNS
- COUNTY LINE
 - TOWN LINE
 - POINT OF ACCESS
 - STONE WALL
 - TRAVELLED WAY
 - GUARD RAIL
 - RAILROAD
 - SURVEY LINE
 - SUBVERT
 - POWER POLE
 - TELEPHONE POLE
 - TREES
 - FA CONST IDENTIFICATION SIGNS
 - PROPERTY LINE
 - ROW TAKING LINE
 - SLOPE RIGHTS
 - TOP OF CUT
 - TOP OF SLOPE



BEGINNING AT A POINT APPROXIMATELY 0.048 MILES
 SOUTHEASTERLY OF THE MONTPELIER-BERLIN
 TOWN LINE AND EXTENDING IN A SOUTHEASTERLY
 DIRECTION 0.489 MILES.
 LENGTH OF ROADWAY 2,550 FEET 0.489 MILES
 LENGTH OF PROJECT 2,580 FEET 0.489 MILES

TRAFFIC DATA
 1972 ADT 13,500
 1955 ADT 10,220

These plans are subject to such engineering
 changes as may be required by the Federal Highway
 Administration or the Chief Engineer.
 Construction is to be carried on in accordance
 with these plans and the Standard Specifications
 for Highway and Bridge Construction dated
 January 3, 1972 as approved by the Federal Highway
 Administration on December 23, 1971 for use on
 this project, including all subsequent revisions and
 such revised specification and special provisions as
 are incorporated in these plans.

SUBMITTED BY ORDER OF THE STATE HIGHWAY BOARD

APPROVED: *Chas. J. Crossett* DATE: *1/1/74*
 CHIEF ENGINEER

DEPARTMENT OF TRANSPORTATION
 FEDERAL HIGHWAY ADMINISTRATION

APPROVED: _____ DATE: _____
 DIVISION ENGINEER

BERLIN TOPICS
 PROJECT T 4303(4)

SHEET 1 OF 24 SHEETS