

INDEX OF SHEETS

SHEET NO.	TITLE PAGE
2-3	TYPICAL CROSS-SECTION OF IMPROVEMENT (7" One Course Concrete Pavement, Item 35 A)
4	BANKING AND WIDENING TABLES
5-17	PLAN AND PROFILE
18	Deep Cross Bridge Extension - Plan
19	Detail Sheet - Deck & Approach Slabs (Benjamin Falls Bridge)
20	Detail Sheet - Abutment N#1
21	Detail Sheet - Abutment N#2
22	Detail Sheet - Superstructure (Deep Crossing Bridge)
23	Detail Sheet - Superstructure
24	Detail Sheet - Abutment N#1
25	Detail Sheet - Abutment N#2
26	Standard Structure Sheet SB 20
27	Details D, M, Sarricoades, Signs, Lights
28	Pipe Culverts
29	Guard Rail
30	Standard Underdrain
31	Boundary Markers - Conc. Curb
32	One Course Cement Concrete Pavement
33	Sarricoades, Signs, Lights
34	Regulating of Slopes
35	Box Culverts
36	SCM 23 Wings for Box Culverts
37-74	Cross-sections
75-77	Channel Relocation
78	Roadside Improvement Force Main Items

Standard Structure Sheets
Approved by the Chief Engineer

S28 - July 11, 1933
S30 - Aug. 13, 1934
S31 - July 25, 1934

STATE OF VERMONT
STATE HIGHWAY DEPARTMENT

PLAN AND PROFILE OF PROPOSED
STATE HIGHWAY

FEDERAL AID PROJECT

TOWN OF BERLIN Pin# 99R539

MONTPELIER-BARRE ROAD

BEGINNING AT THE MONTPELIER-BERLIN TOWN LINE, ON ROUTE US302, AND EXTENDING SOUTH-EASTERLY 1.210 MILES

LENGTH OF BRIDGE: 64.1 FEET = 0.012 MILES
LENGTH OF ROADWAY: 6274.3 FEET = 1.188 MILES
LENGTH OF PROJECT: 6338.4 FEET = 1.200 MILES INC. BRIDGE

PREPARED BY	DATE	SCALE	PROJECT NO.	SHEET NO.	TOTAL SHEETS
B. Vt.	56-B-11	1/4" = 1'	7	7	7

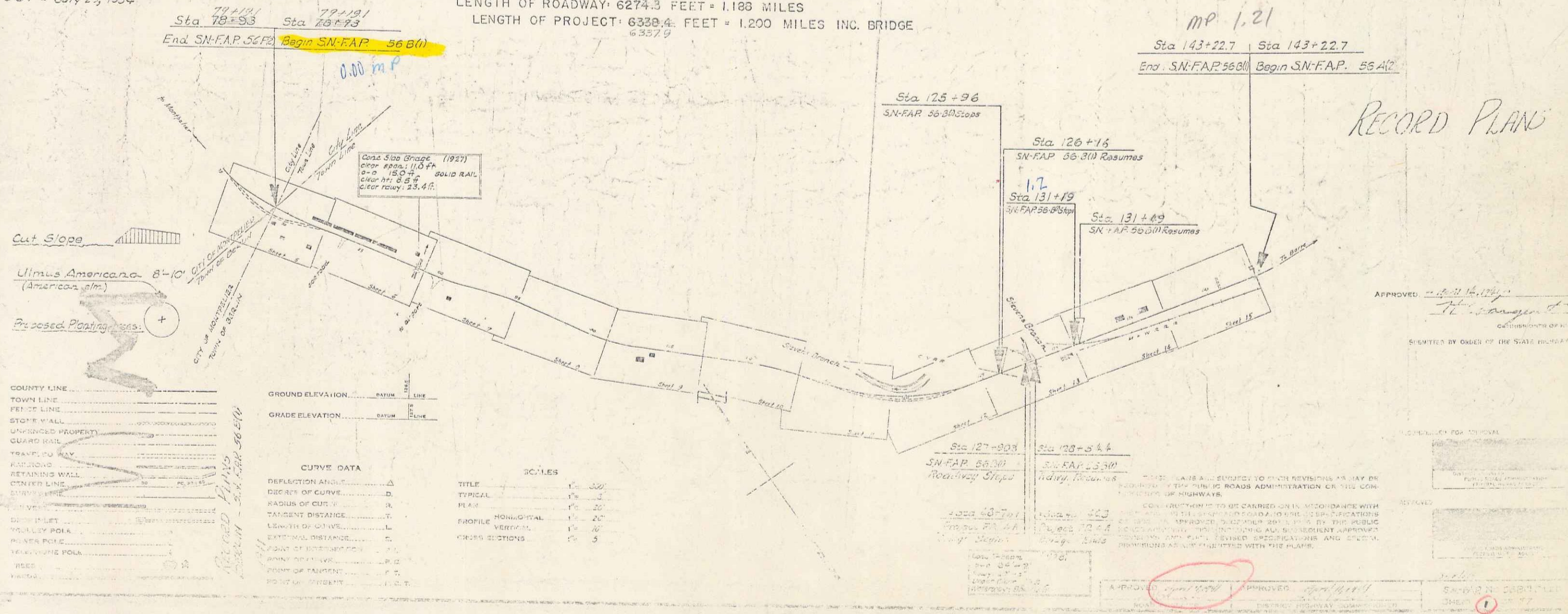
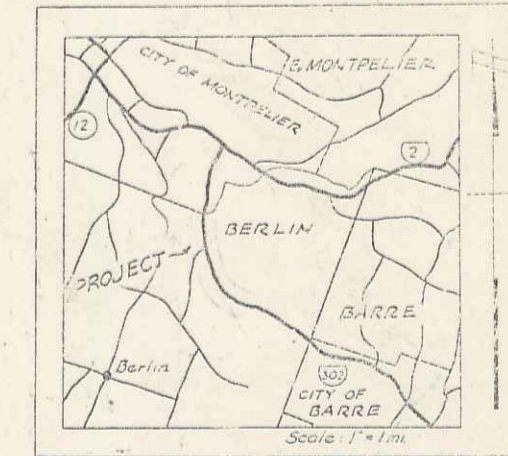

RECORD PLANS

SYMBOL	DESCRIPTION
---	COUNTY LINE
---	TOWN LINE
---	FEET OF LINE
---	STONE WALL
---	UNIMPROVED PROPERTY
---	GUARD RAIL
---	TRAVELER WAY
---	ROADWAY
---	RETAINING WALL
---	CENTER LINE
---	CURVE DATA
---	DEFLECTION ANGLE
---	RADIUS OF CURVE
---	TANGENT DISTANCE
---	LENGTH OF CHORD
---	EXTERNAL DISTANCE
---	POINT OF INTERSECTION
---	POINT OF BEGINNING
---	POINT OF TANGENT
---	POINT OF CURVE
---	POINT OF ENDING

SCALES

TITLE	SCALE
TYPICAL	1" = 20'
PLAN	1" = 20'
PROFILE HORIZONTAL	1" = 20'
PROFILE VERTICAL	1" = 20'
TRANSVERSE SECTIONS	1" = 5'

APPROVED: [Signature]
SUBMITTED BY ORDER OF THE STATE HIGHWAY DEPARTMENT

STEARNS R. JENKINS

US 302