

1. PLAN AND PROFILE STA. 34+66 - 55+00  
 2. STANDARD STRUCTURE SHEET 3-17  
 3. TELEPHONE 8-17

STATE HIGHWAY DEPARTMENT

PLAN AND PROFILE OF PROPOSED  
STATE HIGHWAY

FLOOD RELIEF PROJECT

TOWN OF BERLIN

MONTPELIER - BARRE ROAD

FROM STA. 34+66 TO STA. 55+00 OF PROJECT 56 B

EXCLUDING F.R. 4 A (DODGE-BRIDGE)

LENGTH OF PROJECT 16,118 FT = 0.305 MILES

Rte US 302



SCALE 1 IN = 4 MILES

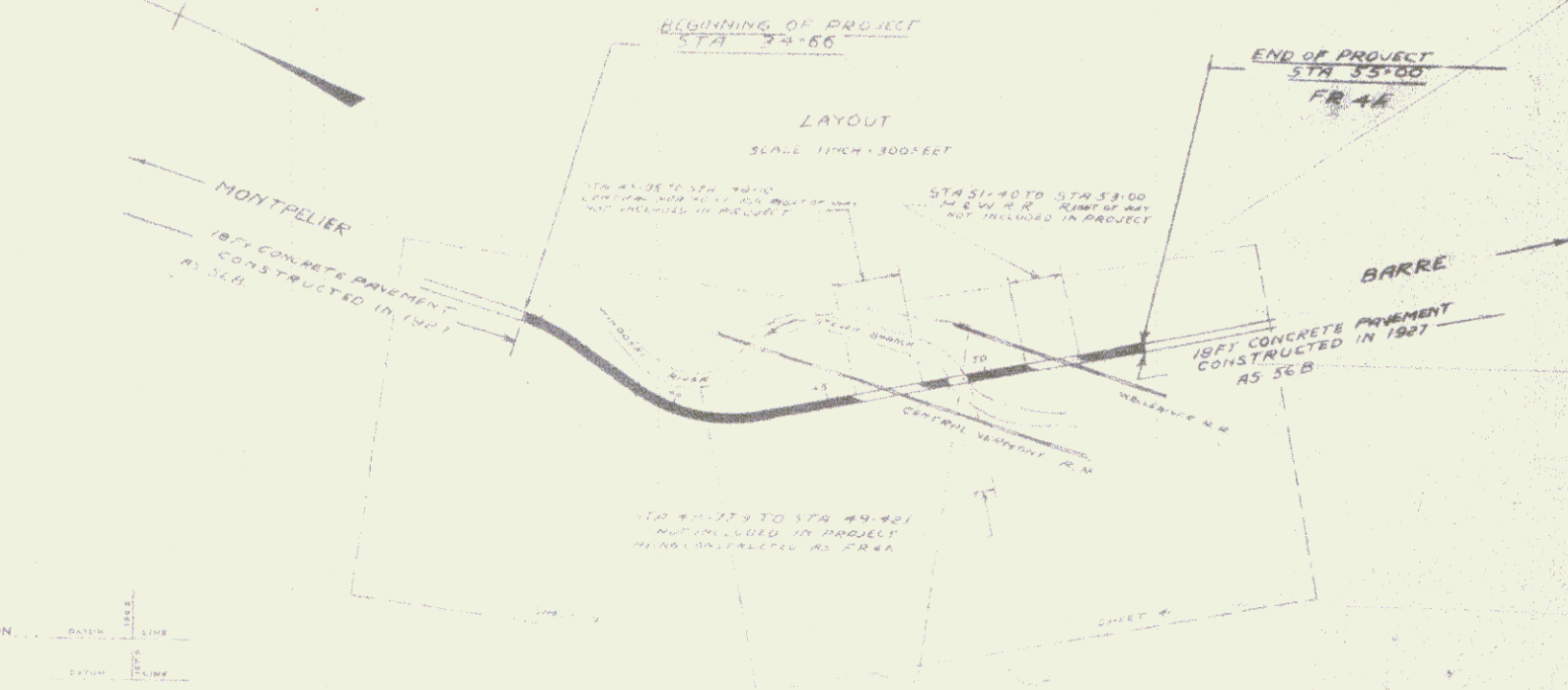

APPROVED: JULY 26, 1928  
 H. C. Sargent  
 CHIEF ENGINEER  
 SUBMITTED BY ORDER OF THE STATE HIGHWAY BOARD  
 JULY 26, 1928  
 R. B. Butler  
 COMMISSIONER OF HIGHWAYS

CONVENTIONAL SIGNS

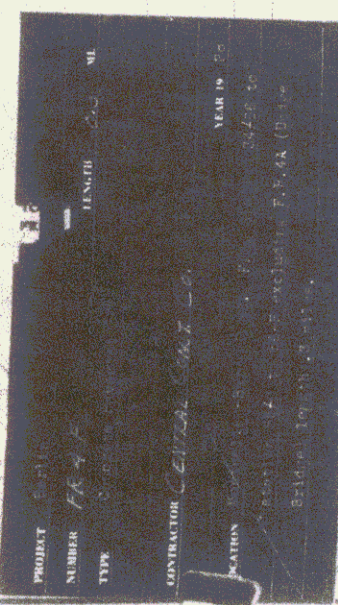

GROUND ELEVATION	IN FEET
GRADE ELEVATION	IN FEET
CURVE DATA	
DEFLECTION ANGLE	D
DEGREE OF CURVE	D
RADIUS OF CURVE	R
TANGENT DISTANCE	T
LENGTH OF CURVE	L
EXTERNAL DISTANCE	E
POINT OF INTERSECTION	P. I.
POINT OF CURVE	P. C.
POINT OF TANGENT	P. T.
POINT ON TANGENT	P. O. T.

PLAN SCALE 1 INCH = 50 FEET  
 PROFILE SCALE 1 INCH = 10 FEET  
 CROSS SECTION 1 INCH = 5 FEET

THIS PROJECT TO BE CONSTRUCTED IN ACCORDANCE WITH STANDARD SPECIFICATIONS ON FILE WITH THE U.S. BUREAU OF PUBLIC ROADS AS APPROVED JULY 7 1926  
 ALL STRUCTURES ON THIS PROJECT TO BE CONSTRUCTED IN ACCORDANCE WITH DETAILS GIVEN BY STANDARD STRUCTURE SHEETS SERIES No. 17, 18  
 THESE PLANS SUBJECT TO SUCH REVISION AS MAY BE REQUIRED BY THE U.S. BUREAU OF PUBLIC ROADS OR THE CHIEF ENGINEER

RECOMMENDED [REDACTED]  
 DISTRICT ENGINEER BUREAU OF PUBLIC ROADS  
 RECOMMENDED FOR APPROVAL [REDACTED]  
 CHIEF ENGINEER BUREAU OF PUBLIC ROADS  
 APPROVED [REDACTED]  
 DIRECTOR - BUREAU OF PUBLIC ROADS