

When the Commonwealth of Massachusetts makes improvement at this location this center line will be used.

Proposed Rev Curve
 Δ 2°00' LT (Approx)
 D 1"
 R 5729.7
 T 100.0
 L 200.0
 E 0.9

Rev Curve
 Δ 4°03' LT
 D 2"
 R 2804.0
 T 101.3
 L 202.5
 E 1.0
 Bank 1/2 cut-ft

IN-CASE CHAD-D-RATE THREE CABLE GUARD RAIL
 5+05 - 6+83 LT.
 5+05 - 6+10 LT.
 5+30 - 12+00 LT.

Drives 5+40 RT
 6+50 RT
 12+45 RT

Width	Sub	Dist	LC	RT
10+50				1
15+13				1

1750
 1.3
 1.4
 1.5
 1.6
 1.7
 1.8
 1.9
 2.0
 2.1
 2.2
 2.3
 2.4
 2.5
 2.6
 2.7
 2.8
 2.9
 3.0
 3.1
 3.2
 3.3
 3.4
 3.5
 3.6
 3.7
 3.8
 3.9
 4.0
 4.1
 4.2
 4.3
 4.4
 4.5
 4.6
 4.7
 4.8
 4.9
 5.0
 5.1
 5.2
 5.3
 5.4
 5.5
 5.6
 5.7
 5.8
 5.9
 6.0
 6.1
 6.2
 6.3
 6.4
 6.5
 6.6
 6.7
 6.8
 6.9
 7.0
 7.1
 7.2
 7.3
 7.4
 7.5
 7.6
 7.7
 7.8
 7.9
 8.0
 8.1
 8.2
 8.3
 8.4
 8.5
 8.6
 8.7
 8.8
 8.9
 9.0
 9.1
 9.2
 9.3
 9.4
 9.5
 9.6
 9.7
 9.8
 9.9
 10.0
 10.1
 10.2
 10.3
 10.4
 10.5
 10.6
 10.7
 10.8
 10.9
 11.0
 11.1
 11.2
 11.3
 11.4
 11.5
 11.6
 11.7
 11.8
 11.9
 12.0
 12.1
 12.2
 12.3
 12.4
 12.5
 12.6
 12.7
 12.8
 12.9
 13.0
 13.1
 13.2
 13.3
 13.4
 13.5
 13.6
 13.7
 13.8
 13.9
 14.0
 14.1
 14.2
 14.3
 14.4
 14.5
 14.6
 14.7
 14.8
 14.9
 15.0
 15.1
 15.2
 15.3
 15.4
 15.5
 15.6
 15.7
 15.8
 15.9
 16.0
 16.1
 16.2
 16.3
 16.4
 16.5
 16.6
 16.7
 16.8
 16.9
 17.0
 17.1
 17.2
 17.3
 17.4
 17.5
 17.6
 17.7
 17.8
 17.9
 18.0
 18.1
 18.2
 18.3
 18.4
 18.5
 18.6
 18.7
 18.8
 18.9
 19.0
 19.1
 19.2
 19.3
 19.4
 19.5
 19.6
 19.7
 19.8
 19.9
 20.0
 20.1
 20.2
 20.3
 20.4
 20.5
 20.6
 20.7
 20.8
 20.9
 21.0
 21.1
 21.2
 21.3
 21.4
 21.5
 21.6
 21.7
 21.8
 21.9
 22.0
 22.1
 22.2
 22.3
 22.4
 22.5
 22.6
 22.7
 22.8
 22.9
 23.0
 23.1
 23.2
 23.3
 23.4
 23.5
 23.6
 23.7
 23.8
 23.9
 24.0
 24.1
 24.2
 24.3
 24.4
 24.5
 24.6
 24.7
 24.8
 24.9
 25.0
 25.1
 25.2
 25.3
 25.4
 25.5
 25.6
 25.7
 25.8
 25.9
 26.0
 26.1
 26.2
 26.3
 26.4
 26.5
 26.6
 26.7
 26.8
 26.9
 27.0
 27.1
 27.2
 27.3
 27.4
 27.5
 27.6
 27.7
 27.8
 27.9
 28.0
 28.1
 28.2
 28.3
 28.4
 28.5
 28.6
 28.7
 28.8
 28.9
 29.0
 29.1
 29.2
 29.3
 29.4
 29.5
 29.6
 29.7
 29.8
 29.9
 30.0
 30.1
 30.2
 30.3
 30.4
 30.5
 30.6
 30.7
 30.8
 30.9
 31.0
 31.1
 31.2
 31.3
 31.4
 31.5
 31.6
 31.7
 31.8
 31.9
 32.0
 32.1
 32.2
 32.3
 32.4
 32.5
 32.6
 32.7
 32.8
 32.9
 33.0
 33.1
 33.2
 33.3
 33.4
 33.5
 33.6
 33.7
 33.8
 33.9
 34.0
 34.1
 34.2
 34.3
 34.4
 34.5
 34.6
 34.7
 34.8
 34.9
 35.0
 35.1
 35.2
 35.3
 35.4
 35.5
 35.6
 35.7
 35.8
 35.9
 36.0
 36.1
 36.2
 36.3
 36.4
 36.5
 36.6
 36.7
 36.8
 36.9
 37.0
 37.1
 37.2
 37.3
 37.4
 37.5
 37.6
 37.7
 37.8
 37.9
 38.0
 38.1
 38.2
 38.3
 38.4
 38.5
 38.6
 38.7
 38.8
 38.9
 39.0
 39.1
 39.2
 39.3
 39.4
 39.5
 39.6
 39.7
 39.8
 39.9
 40.0
 40.1
 40.2
 40.3
 40.4
 40.5
 40.6
 40.7
 40.8
 40.9
 41.0
 41.1
 41.2
 41.3
 41.4
 41.5
 41.6
 41.7
 41.8
 41.9
 42.0
 42.1
 42.2
 42.3
 42.4
 42.5
 42.6
 42.7
 42.8
 42.9
 43.0
 43.1
 43.2
 43.3
 43.4
 43.5
 43.6
 43.7
 43.8
 43.9
 44.0
 44.1
 44.2
 44.3
 44.4
 44.5
 44.6
 44.7
 44.8
 44.9
 45.0
 45.1
 45.2
 45.3
 45.4
 45.5
 45.6
 45.7
 45.8
 45.9
 46.0
 46.1
 46.2
 46.3
 46.4
 46.5
 46.6
 46.7
 46.8
 46.9
 47.0
 47.1
 47.2
 47.3
 47.4
 47.5
 47.6
 47.7
 47.8
 47.9
 48.0
 48.1
 48.2
 48.3
 48.4
 48.5
 48.6
 48.7
 48.8
 48.9
 49.0
 49.1
 49.2
 49.3
 49.4
 49.5
 49.6
 49.7
 49.8
 49.9
 50.0
 50.1
 50.2
 50.3
 50.4
 50.5
 50.6
 50.7
 50.8
 50.9
 51.0
 51.1
 51.2
 51.3
 51.4
 51.5
 51.6
 51.7
 51.8
 51.9
 52.0
 52.1
 52.2
 52.3
 52.4
 52.5
 52.6
 52.7
 52.8
 52.9
 53.0
 53.1
 53.2
 53.3
 53.4
 53.5
 53.6
 53.7
 53.8
 53.9
 54.0
 54.1
 54.2
 54.3
 54.4
 54.5
 54.6
 54.7
 54.8
 54.9
 55.0
 55.1
 55.2
 55.3
 55.4
 55.5
 55.6
 55.7
 55.8
 55.9
 56.0
 56.1
 56.2
 56.3
 56.4
 56.5
 56.6
 56.7
 56.8
 56.9
 57.0
 57.1
 57.2
 57.3
 57.4
 57.5
 57.6
 57.7
 57.8
 57.9
 58.0
 58.1
 58.2
 58.3
 58.4
 58.5
 58.6
 58.7
 58.8
 58.9
 59.0
 59.1
 59.2
 59.3
 59.4
 59.5
 59.6
 59.7
 59.8
 59.9
 60.0
 60.1
 60.2
 60.3
 60.4
 60.5
 60.6
 60.7
 60.8
 60.9
 61.0
 61.1
 61.2
 61.3
 61.4
 61.5
 61.6
 61.7
 61.8
 61.9
 62.0
 62.1
 62.2
 62.3
 62.4
 62.5
 62.6
 62.7
 62.8
 62.9
 63.0
 63.1
 63.2
 63.3
 63.4
 63.5
 63.6
 63.7
 63.8
 63.9
 64.0
 64.1
 64.2
 64.3
 64.4
 64.5
 64.6
 64.7
 64.8
 64.9
 65.0
 65.1
 65.2
 65.3
 65.4
 65.5
 65.6
 65.7
 65.8
 65.9
 66.0
 66.1
 66.2
 66.3
 66.4
 66.5
 66.6
 66.7
 66.8
 66.9
 67.0
 67.1
 67.2
 67.3
 67.4
 67.5
 67.6
 67.7
 67.8
 67.9
 68.0
 68.1
 68.2
 68.3
 68.4
 68.5
 68.6
 68.7
 68.8
 68.9
 69.0
 69.1
 69.2
 69.3
 69.4
 69.5
 69.6
 69.7
 69.8
 69.9
 70.0
 70.1
 70.2
 70.3
 70.4
 70.5
 70.6
 70.7
 70.8
 70.9
 71.0
 71.1
 71.2
 71.3
 71.4
 71.5
 71.6
 71.7
 71.8
 71.9
 72.0
 72.1
 72.2
 72.3
 72.4
 72.5
 72.6
 72.7
 72.8
 72.9
 73.0
 73.1
 73.2
 73.3
 73.4
 73.5
 73.6
 73.7
 73.8
 73.9
 74.0
 74.1
 74.2
 74.3
 74.4
 74.5
 74.6
 74.7
 74.8
 74.9
 75.0
 75.1
 75.2
 75.3
 75.4
 75.5
 75.6
 75.7
 75.8
 75.9
 76.0
 76.1
 76.2
 76.3
 76.4
 76.5
 76.6
 76.7
 76.8
 76.9
 77.0
 77.1
 77.2
 77.3
 77.4
 77.5
 77.6
 77.7
 77.8
 77.9
 78.0
 78.1
 78.2
 78.3
 78.4
 78.5
 78.6
 78.7
 78.8
 78.9
 79.0
 79.1
 79.2
 79.3
 79.4
 79.5
 79.6
 79.7
 79.8
 79.9
 80.0
 80.1
 80.2
 80.3
 80.4
 80.5
 80.6
 80.7
 80.8
 80.9
 81.0
 81.1
 81.2
 81.3
 81.4
 81.5
 81.6
 81.7
 81.8
 81.9
 82.0
 82.1
 82.2
 82.3
 82.4
 82.5
 82.6
 82.7
 82.8
 82.9
 83.0
 83.1
 83.2
 83.3
 83.4
 83.5
 83.6
 83.7
 83.8
 83.9
 84.0
 84.1
 84.2
 84.3
 84.4
 84.5
 84.6
 84.7
 84.8
 84.9
 85.0
 85.1
 85.2
 85.3
 85.4
 85.5
 85.6
 85.7
 85.8
 85.9
 86.0
 86.1
 86.2
 86.3
 86.4
 86.5
 86.6
 86.7
 86.8
 86.9
 87.0
 87.1
 87.2
 87.3
 87.4
 87.5
 87.6
 87.7
 87.8
 87.9
 88.0
 88.1
 88.2
 88.3
 88.4
 88.5
 88.6
 88.7
 88.8
 88.9
 89.0
 89.1
 89.2
 89.3
 89.4
 89.5
 89.6
 89.7
 89.8
 89.9
 90.0
 90.1
 90.2
 90.3
 90.4
 90.5
 90.6
 90.7
 90.8
 90.9
 91.0
 91.1
 91.2
 91.3
 91.4
 91.5
 91.6
 91.7
 91.8
 91.9
 92.0
 92.1
 92.2
 92.3
 92.4
 92.5
 92.6
 92.7
 92.8
 92.9
 93.0
 93.1
 93.2
 93.3
 93.4
 93.5
 93.6
 93.7
 93.8
 93.9
 94.0
 94.1
 94.2
 94.3
 94.4
 94.5
 94.6
 94.7
 94.8
 94.9
 95.0
 95.1
 95.2
 95.3
 95.4
 95.5
 95.6
 95.7
 95.8
 95.9
 96.0
 96.1
 96.2
 96.3
 96.4
 96.5
 96.6
 96.7
 96.8
 96.9
 97.0
 97.1
 97.2
 97.3
 97.4
 97.5
 97.6
 97.7
 97.8
 97.9
 98.0
 98.1
 98.2
 98.3
 98.4
 98.5
 98.6
 98.7
 98.8
 98.9
 99.0
 99.1
 99.2
 99.3
 99.4
 99.5
 99.6
 99.7
 99.8
 99.9
 100.0

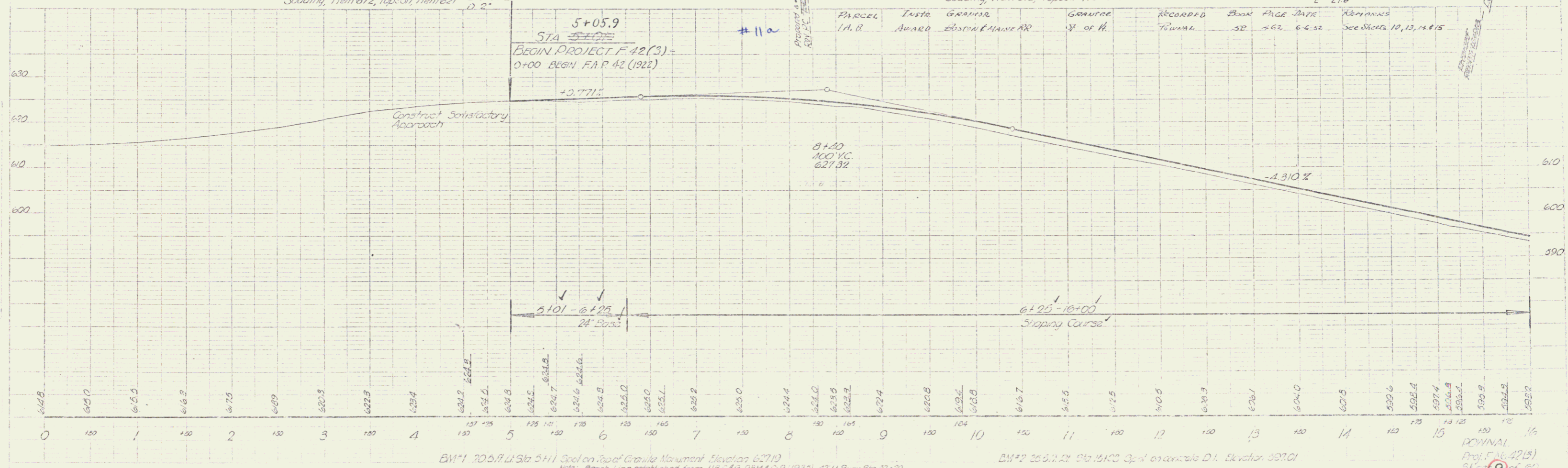
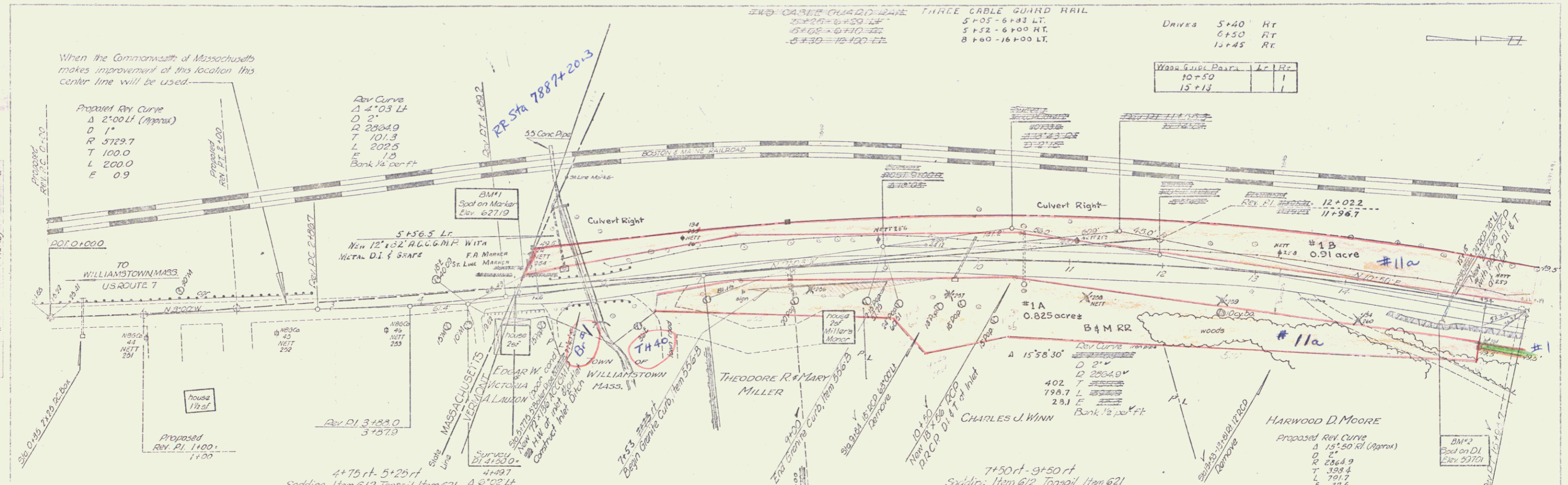

BM#1 70.5 ft. U.S. Sta 5411 Spot on Top of Granite Monument Elevation 6271.0
 Note: Bench Line established from U.S.C.G. BM # C 9 (1933) 42 U.S. Sta 37120

BM#2 26.5 ft. U.S. Sta 15100 Spot on concrete D.I. Elevation 597.01

PCMINAL
 Proj. 5-16-42 (B)
 Sheet 9 of 60